

DUFOUR 520 GL

FREGATE (2018)

Sailing yacht Dufour 520 GL FREGATE, built in 2018 is anchored in the **Kotor, Port of Kotor, Montenegro, Montenegro**. It has **5 cabins**, can accommodate **10 + 2 people** and has **3 toilets**. Bed linen and kitchen equipment are included in the price.

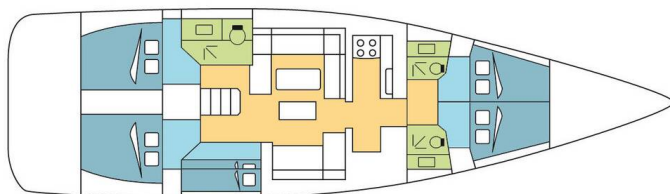

YACHT SPECIFICATIONS

Yacht Base

Kotor, Port of Kotor, Montenegro

Yacht ID

12531

Brands

Dufour

Yacht name

FREGATE

Production year

2018

Length

50 ft

Cabins

5

Berths

10 + 2

Max Persons

12

WC

3

Engine

1 x 110 HP

Fuel tank

450 l



WEBSITE

www.plujeme.cz



PHONE

+420 720 755 085



MOBILE

+420 777 170 276



E-MAIL

info@plujeme.cz



PLUJEME RÁDI S.R.O.

Dlouhá 730/35, 11000 Praha 1 – Staré Město, Czech Republic

STANDARD YACHT EQUIPMENT

Comfort	Cockpit cushions
Deck	Bathing platform, Bimini top, Cockpit table, Cockpit/stern, outside shower, Dinghy, Electric anchor windlass, Outboard engine, Sprayhood, Swimming ladder
Entertainment	Outdoor speakers, Radio
Galley	Hot water
Interior	Convertible table in salon, Electric fans in cabins, Electric toilet
Navigation	Autopilot, Bow thruster, GPS chart plotter - cockpit, Wind instrument/Anemometer
Safety	VHF radio
Sails	Lazy bag, Lazy jacks, Self tailing (manual) winch
Yacht electrics	220V socket, Inverter



WEBSITE

www.plujeme.cz



E-MAIL

info@plujeme.cz



PHONE

+420 720 755 085



MOBILE

+420 777 170 276



PLUJEME RÁDI S.R.O.

Dlouhá 730/35, 11000 Praha 1 – Staré Město, Czech Republic

SERVICES

SELECTED SERVICES	OBLIGATORY	PAYMENT TYPE	PRICE
Handling fees (Payable now) Season: 2026.	Yes	per booking	20,00 €
Local tax (Payable at the base) Season: 2026. Mandatory tourist ID Cardboard / payment by cash only	Yes	per person	1,00 €
Preparation fee (Payable now) Season: 2026. INCLUDED: starter pack – (1 gallon water or 4 bottles of 1.5L, 1 bottle of disinfectant, 1 small bottle of washing up liquid, 1 dish cloth, 1 sponge, garbage bags, 1 roll of paper towels, 1 box of matches, 1 roll of toilet paper in each head) // final cleaning // 1 set of bed sheets / cabin & 1 set of towels / pax, dinghy, outboard engine & initial supply of fuel, gas and water tanks // DYC assistance guarantee // 1st & last night in the marina // NOT INCLUDED: refuelling, gas & water consumption at end of charter, taxes if any, handling fees & additional equipment deposit.	Yes	per booking	335,00 €
Tourist tax (Payable at the base) Season: 2026. Mandatory tourist tax Montenegro / payment by cash only	Yes	per guest/day	0,90 €
Transit log (Payable now) Season: 2026.	Yes	per booking	100,00 €
Crew change (Payable now) Season: 2026. Any crew change during the charter is subject to € 250.- additional cost. The charge includes administration cost, change of bed linen and towels and one night at DYC ponton (marina fee included only if the same base than start base). It doesn't include cleaning, nor new transit log where applicable.	No	per booking	250,00 €
Damage waiver (Payable now) Season: 2026. Damage waiver limits your liability to the reduced Security Deposit . Mandatory when skipper is added. Price is per night of the charter (minimum value of 7 nights & a maximum value of 21 nights). Not applicable for 4+ weeks charters , nor Regattas/Races.	No	per night	50,00 €
Early boarding/check-in (Payable now) Season: 2026. EB (boat only) - 13:00h, starting time of boat's delivery // limited number of early boardings on same departure day	No	per booking	300,00 €

Early boarding/check-in (Payable now)	No	per booking	388,00 €
<i>Season: 2026. EB + extra fee skipper - 13:00h, starting time of boat's delivery // limited number of early boardings on same departure day</i>			
Early boarding/check-in (Payable now)	No	per booking	468,00 €
<i>Season: 2026. EB + extra fee Skipper & Hostess - 13:00h, starting time of boat's delivery // limited number of early boardings on same departure day</i>			
Electric & Water consumption in the Marinas (Payable at the base)	No	per booking	28,00 €
<i>Season: 2026. Electric & Water consumption based on 2 nights on our dock (base will confirm the amount to pay locally depending on nights spent on dock)</i>			
Extra set of linen (choose how many) (Payable now)	No	per booking	15,00 €
<i>Season: 2026. Extra set of linen : 15 € 1 extra set of linen (2 sheets & 2 pillow case) - to be updated manually</i>			
Extra set of towels (choose how many) (Payable now)	No	per booking	10,00 €
<i>Season: 2026. Extra set of towels: 10 € 1 extra set of towels (1 face & 1 bath towel) - to be updated manually</i>			
Full board 1-4 pax (number of guests to update manually) (Payable now)	No	per guest/day	60,00 €
<i>Season: 2026. only available if cook is booked on board as the cook will do the provisioning based on client's preference. Includes breakfast, lunch & dinner + the crew's food. Does not included alcoholic drinks</i>			
Full board 5-12 pax (number of guests to update manually) (Payable now)	No	per guest/day	55,00 €
<i>Season: 2026. only available if cook is booked on board as the cook will do the provisioning based on client's preference. Includes breakfast, lunch & dinner + the crew's food. Does not included alcoholic drinks</i>			
Half board 1-4 pax (number of guests to update manually) (Payable now)	No	per guest/day	50,00 €
<i>Season: 2026. only available if cook is booked on board as the cook will do the provisioning based on client's preference. Includes breakfast & lunch OR dinner + the crew's food. Does not included alcoholic drinks</i>			
Half board 5-12 pax (number of guests to update manually) (Payable now)	No	per guest/day	45,00 €
<i>Season: 2026. only available if cook is booked on board as the cook will do the provisioning based on client's preference. Includes breakfast & lunch OR dinner + the crew's food. Does not included alcoholic drinks</i>			

<p>Hostess/Cook (Payable now)</p> <p>Season: 2026. + provisioning, Crew on board must have their own toilets/showers. If either a skipper or a hostess/cook is on board, 1 double cabin will be required for him/her. If both a skipper and a hostess/cook are on board, 1 double cabin and 1 forepeak cabin will be required for them. Exceptions exists for specific layouts, Sales Agents will provide more details about the different boat models</p>	No	per night	160,00 €
<p>Hostess/Cook (Payable now)</p> <p>Season: 2026. + provisioning, Crew on board must have their own toilets/showers. If either a skipper or a hostess/cook is on board, 1 double cabin will be required for him/her. If both a skipper and a hostess/cook are on board, 1 double cabin and 1 forepeak cabin will be required for them. Exceptions exists for specific layouts, Sales Agents will provide more details about the different boat models</p>	No	per night	160,00 €
<p>Hostess/Cook (Payable now)</p> <p>Season: 2026. + provisioning, Crew on board must have their own toilets/showers. If either a skipper or a hostess/cook is on board, 1 double cabin will be required for him/her. If both a skipper and a hostess/cook are on board, 1 double cabin and 1 forepeak cabin will be required for them. Exceptions exists for specific layouts, Sales Agents will provide more details about the different boat models</p>	No	per night	175,00 €
<p>Regatta surcharge (Payable now)</p> <p>Season: 2026. A special race deposit need to be doubled manually once the regatta surcharge is added.</p>	No	per booking	0,00 €
<p>Skipper (Payable now)</p> <p>Season: 2026. + provisioning, Crew on board must have their own toilets/showers. If either a skipper or a hostess/cook is on board, 1 double cabin will be required for him/her. If both a skipper and a hostess/cook are on board, 1 double cabin and 1 forepeak cabin will be required for them. Exceptions exists for specific layouts, Sales Agents will provide more details about the different boat models</p>	No	per night	175,00 €
<p>Skipper (Payable now)</p> <p>Season: 2026. + provisioning, Crew on board must have their own toilets/showers. If either a skipper or a hostess/cook is on board, 1 double cabin will be required for him/her. If both a skipper and a hostess/cook are on board, 1 double cabin and 1 forepeak cabin will be required for them. Exceptions exists for specific layouts, Sales Agents will provide more details about the different boat models</p>	No	per night	175,00 €

Skipper (Payable now)	No	per night	195,00 €
Season: 2026. + provisioning, Crew on board must have their own toilets/showers. If either a skipper or a hostess/cook is on board, 1 double cabin will be required for him/her. If both a skipper and a hostess/cook are on board, 1 double cabin and 1 forepeak cabin will be required for them. Exceptions exists for specific layouts, Sales Agents will provide more details about the different boat models			
Transfer (Payable now)	No	one-way	90,00 €
Season: 2026. OW - Airport Tivat – Kotor base 1-8 pax			
Transfer (Payable now)	No	round trip	180,00 €
Season: 2026. RT - Airport Tivat – Kotor base 1-8 pax			
Transfer (Payable now)	No	one-way	200,00 €
Season: 2026. OW - Airport Podgorica – Kotor base 1-8 pax			
Transfer (Payable now)	No	one-way	280,00 €
Season: 2026. OW - Airport Dubrovnik – Kotor base 1-8 pax			
Transfer (Payable now)	No	round trip	400,00 €
Season: 2026. RT - Airport Podgorica – Kotor base 1-8 pax			
Transfer (Payable now)	No	round trip	560,00 €
Season: 2026. RT - Airport Dubrovnik – Kotor base 1-8 pax			
WI-FI Internet connection on boat (Payable now)	No	per week	30,00 €
Season: 2026.			



WEBSITE

www.plujeme.cz



PHONE

+420 720 755 085



MOBILE

+420 777 170 276



E-MAIL

info@plujeme.cz



PLUJEME RÁDI S.R.O.

Dlouhá 730/35, 11000 Praha 1 – Staré Město, Czech Republic

ADDITIONAL EXTRAS

EXTRA	OBLIGATORY	PAYMENT TYPE	PRICE
Kayak single (Payable now) Season: 2026. Price per day - Payable now	No	per night	15,00 €
Railing net (Safety net) (Payable now) Season: 2026. net is supplied but not installed - Payable now	No	per booking	230,00 €
Stand up paddle (SUP) (Payable now) Season: 2026. Price per day - Payable now	No	per night	15,00 €



WEBSITE

www.plujeme.cz



E-MAIL

info@plujeme.cz



PHONE

+420 720 755 085



MOBILE

+420 777 170 276



PLUJEME RÁDI S.R.O.

Dlouhá 730/35, 11000 Praha 1 – Staré Město, Czech Republic

PRICE AND AVAILABILITY

25.04. - 02.05.2026 1.500 € 1.795 €	02.05. - 09.05.2026 NOT AVAILABLE	09.05. - 16.05.2026 NOT AVAILABLE	16.05. - 23.05.2026 NOT AVAILABLE
23.05. - 30.05.2026 NOT AVAILABLE	30.05. - 06.06.2026 NOT AVAILABLE	06.06. - 13.06.2026 NOT AVAILABLE	13.06. - 20.06.2026 NOT AVAILABLE
20.06. - 27.06.2026 NOT AVAILABLE	27.06. - 04.07.2026 3.278 € 4.370 €	04.07. - 11.07.2026 3.311 € 3.895 €	11.07. - 18.07.2026 NOT AVAILABLE
18.07. - 25.07.2026 4.072 € 4.790 €	25.07. - 01.08.2026 4.046 € 4.760 €	01.08. - 08.08.2026 4.297 € 5.055 €	08.08. - 15.08.2026 ON OPTION
15.08. - 22.08.2026 4.135 € 4.865 €	22.08. - 29.08.2026 3.757 € 4.420 €	29.08. - 05.09.2026 NOT AVAILABLE	05.09. - 12.09.2026 NOT AVAILABLE
12.09. - 19.09.2026 NOT AVAILABLE	19.09. - 26.09.2026 NOT AVAILABLE	26.09. - 03.10.2026 NOT AVAILABLE	03.10. - 10.10.2026 NOT AVAILABLE
10.10. - 17.10.2026 2.295 €	17.10. - 24.10.2026 1.755 €	24.10. - 31.10.2026 1.580 € 1.755 €	31.10. - 07.11.2026 1.580 € 1.755 €
07.11. - 14.11.2026 1.580 € 1.755 €	20.11. - 12.03.2027 NOT AVAILABLE		



WEBSITE

www.plujeme.cz



E-MAIL

info@plujeme.cz



PHONE

+420 720 755 085



MOBILE

+420 777 170 276



PLUJEME RÁDI S.R.O.

Dlouhá 730/35, 11000 Praha 1 – Staré Město, Czech Republic

PRICE AND AVAILABILITY

13.03. - 20.03.2027 1.580 € 1.755 €	20.03. - 27.03.2027 1.580 € 1.755 €	27.03. - 03.04.2027 1.580 € 1.755 €	03.04. - 10.04.2027 1.580 € 1.755 €
10.04. - 17.04.2027 1.580 € 1.755 €	17.04. - 24.04.2027 1.580 € 1.755 €	24.04. - 01.05.2027 1.737 € 1.930 €	01.05. - 08.05.2027 1.737 € 1.930 €
08.05. - 15.05.2027 2.277 € 2.530 €	15.05. - 22.05.2027 2.745 € 3.050 €	22.05. - 29.05.2027 2.916 € 3.240 €	29.05. - 05.06.2027 3.254 € 3.615 €
05.06. - 12.06.2027 3.956 € 4.395 €	12.06. - 19.06.2027 3.533 € 3.925 €	19.06. - 26.06.2027 3.915 € 4.350 €	26.06. - 03.07.2027 4.325 € 4.805 €
03.07. - 10.07.2027 4.581 € 5.090 €	10.07. - 17.07.2027 5.090 € 5.655 €	17.07. - 24.07.2027 5.090 € 5.655 €	24.07. - 31.07.2027 5.342 € 5.935 €
31.07. - 07.08.2027 5.612 € 6.235 €			



WEBSITE
www.plujeme.cz



E-MAIL
info@plujeme.cz



PHONE
+420 720 755 085



MOBILE
+420 777 170 276



PLUJEME RÁDI S.R.O.
Dlouhá 730/35, 11000 Praha 1 – Staré Město, Czech Republic

PRICE AND AVAILABILITY

07.08. - 14.08.2027 5.612 € 6.235 €	14.08. - 21.08.2027 5.342 € 5.935 €	21.08. - 28.08.2027 4.460 € 4.955 €	28.08. - 04.09.2027 3.848 € 4.275 €
04.09. - 11.09.2027 3.794 € 4.215 €	11.09. - 18.09.2027 3.794 € 4.215 €	18.09. - 25.09.2027 3.488 € 3.875 €	25.09. - 02.10.2027 3.065 € 3.405 €
02.10. - 09.10.2027 2.273 € 2.525 €	09.10. - 16.10.2027 1.971 € 2.190 €	16.10. - 23.10.2027 1.580 € 1.755 €	23.10. - 30.10.2027 1.580 € 1.755 €
30.10. - 06.11.2027 1.580 € 1.755 €	06.11. - 13.11.2027 1.580 € 1.755 €	13.11. - 20.11.2027 1.580 € 1.755 €	20.11. - 27.11.2027 1.580 € 1.755 €
27.11. - 04.12.2027 1.580 € 1.755 €	04.12. - 11.12.2027 1.580 € 1.755 €	11.12. - 18.12.2027 1.580 € 1.755 €	18.12. - 25.12.2027 1.580 € 1.755 €



WEBSITE

www.plujeme.cz



E-MAIL

info@plujeme.cz



PHONE

+420 720 755 085



MOBILE

+420 777 170 276



PLUJEME RÁDI S.R.O.

Dlouhá 730/35, 11000 Praha 1 – Staré Město, Czech Republic