

# BAVARIA CRUISER 41

Lal (2018)

Sailing yacht **Bavaria Cruiser 41 Lal**, built in **2018** is anchored in the **Setur Göcek Village Port, Aegean, Turkey**. It has **3 cabins**, can accommodate **6 + 2 people** and has **2 toilets**. Bed linen and kitchen equipment are included in the price.

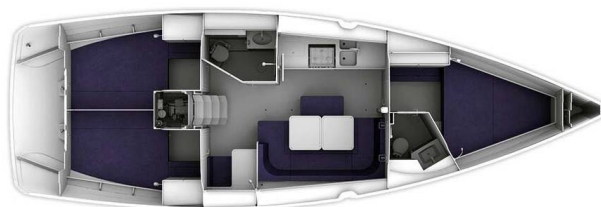

## YACHT SPECIFICATIONS

Yacht Base

**Setur Göcek Village Port, Turkey**

Yacht ID

**1247**

Brands

**Bavaria**

Yacht name

**Lal**

Production year

**2018**

Length

**41 ft**

Cabins

**3**

Berths

**6 + 2**

WC

**2**

Engine

**1 x 60 HP**

Fuel tank

**210 l**



**WEBSITE**

[www.plujeme.cz](http://www.plujeme.cz)



**PHONE**

+420 720 755 085



**MOBILE**

+420 777 170 276



**E-MAIL**

[info@plujeme.cz](mailto:info@plujeme.cz)



**PLUJEME RÁDI S.R.O.**

Dlouhá 730/35, 11000 Praha 1 – Staré Město, Czech Republic

## STANDARD YACHT EQUIPMENT

Comfort	<b>Bed linen, Towels</b>
Deck	<b>Bimini top, Boat hook, Cockpit/stern, outside shower, Dinghy, Electric anchor windlass, Fenders, Sprayhood, Swimming ladder</b>
Entertainment	<b>Radio CD mp3 player, Snorkeling equipment</b>
Galley	<b>Gas cookers, Hot water, Kitchen utensils (Galley equipment, cutlery), Oven, Refrigerator</b>
Interior	<b>Inside shower</b>
Navigation	<b>Autopilot, Bow thruster, Compass, GPS, GPS chart plotter, Log, Speed, Depth- echo sounder, Navigation (Nautical) charts and nautical guide, Radar reflector, Wind instrument/Anemometer</b>
Safety	<b>Distress signals, Emergency tiller, Fire extinguisher, First aid kit, Life jackets, Liferaft, Safety equipment, VHF radio</b>
Sails	<b>Rodkick</b>
Yacht electrics	<b>Batteries, Bilge pump - Electric, DSC station, Inverter, Solar panels</b>



**WEBSITE**

[www.plujeme.cz](http://www.plujeme.cz)



**PHONE**

+420 720 755 085



**MOBILE**

+420 777 170 276



**E-MAIL**

[info@plujeme.cz](mailto:info@plujeme.cz)



**PLUJEME RÁDI S.R.O.**

Dlouhá 730/35, 11000 Praha 1 – Staré Město, Czech Republic

## SERVICES

SELECTED SERVICES	OBLIGATORY	PAYMENT TYPE	PRICE
<b>Service Pack</b> (Payable at the base) <b>Season: 2026.</b> Transit Log, bedlinen, towels and dinghy	Yes	per booking	<b>300,00 €</b>
<b>Damage waiver</b> (Payable at the base) <b>Season: 2026.</b> ( Non refundable )- UPON REQUEST!	No	per booking	<b>0,00 €</b>
<b>Hostess</b> (Payable at the base) <b>Season: 2026.</b> Upon request + cabin	No	per day + food	<b>0,00 €</b>
<b>Regatta charge</b> (Payable at the base) <b>Season: 2026.</b>	No	per week	<b>400,00 €</b>
<b>Skipper</b> (Payable at the base) <b>Season: 2026.</b> Upon request + cabin	No	per day + food	<b>0,00 €</b>
<b>Transfer</b> (Payable at the base) <b>Season: 2026.</b> from-to Airport or any other place; UPON REQUEST	No	one-way	<b>0,00 €</b>
<b>WI-FI Internet connection on boat</b> (Payable at the base) <b>Season: 2026.</b> 10 GB	No	per booking	<b>50,00 €</b>
<b>WI-FI Internet connection on boat</b> (Payable at the base) <b>Season: 2026.</b> 30 GB	No	per booking	<b>80,00 €</b>



**WEBSITE**

[www.plujeme.cz](http://www.plujeme.cz)



**E-MAIL**

[info@plujeme.cz](mailto:info@plujeme.cz)



**PHONE**

+420 720 755 085



**MOBILE**

+420 777 170 276



**PLUJEME RÁDI S.R.O.**

Dlouhá 730/35, 11000 Praha 1 – Staré Město, Czech Republic

## ADDITIONAL EXTRAS

EXTRA	OBLIGATORY	PAYMENT TYPE	PRICE
<b>Gennaker</b> (Payable at the base) <b>Season: 2026.</b> + 800 EUR deposit - Payable at the base	No	per week	<b>400,00 €</b>
<b>Kayak</b> (Payable at the base) <b>Season: 2026.</b> Payable at the base	No	per week	<b>100,00 €</b>
<b>Outboard engine</b> (Payable at the base) <b>Season: 2026.</b> Payable at the base	No	per week	<b>80,00 €</b>
<b>Railing net (Safety net)</b> (Payable at the base) <b>Season: 2026.</b> Payable at the base	No	per booking	<b>120,00 €</b>
<b>Stand up paddle (SUP)</b> (Payable at the base) <b>Season: 2026.</b> Payable at the base	No	per week	<b>100,00 €</b>

**WEBSITE**[www.plujeme.cz](http://www.plujeme.cz)**E-MAIL**[info@plujeme.cz](mailto:info@plujeme.cz)**PHONE**

+420 720 755 085

**MOBILE**

+420 777 170 276

**PLUJEME RÁDI S.R.O.**

Dlouhá 730/35, 11000 Praha 1 – Staré Město, Czech Republic

## PRICE AND AVAILABILITY

25.04. - 02.05.2026 2.550 € 3.000 €	02.05. - 09.05.2026 2.550 € 3.000 €	09.05. - 16.05.2026 2.550 € 3.000 €	16.05. - 23.05.2026 2.550 € 3.000 €
23.05. - 30.05.2026 2.550 € 3.000 €	30.05. - 06.06.2026 2.550 € 3.000 €	06.06. - 13.06.2026 2.635 € 3.100 €	13.06. - 20.06.2026 2.635 € 3.100 €
20.06. - 27.06.2026 2.635 € 3.100 €	27.06. - 04.07.2026 2.635 € 3.100 €	04.07. - 11.07.2026 2.635 € 3.100 €	11.07. - 18.07.2026 NOT AVAILABLE
18.07. - 25.07.2026 2.720 € 3.200 €	25.07. - 01.08.2026 NOT AVAILABLE	01.08. - 08.08.2026 NOT AVAILABLE	08.08. - 15.08.2026 2.720 € 3.200 €
15.08. - 22.08.2026 NOT AVAILABLE	22.08. - 29.08.2026 2.890 € 3.400 €	29.08. - 05.09.2026 2.890 € 3.400 €	05.09. - 12.09.2026 2.890 € 3.400 €
12.09. - 19.09.2026 2.890 € 3.400 €	19.09. - 26.09.2026 2.720 € 3.200 €	26.09. - 03.10.2026 2.720 € 3.200 €	03.10. - 10.10.2026 2.720 € 3.200 €
10.10. - 17.10.2026 2.720 € 3.200 €	17.10. - 24.10.2026 2.720 € 3.200 €	24.10. - 31.10.2026 2.720 € 3.200 €	31.10. - 07.11.2026 2.720 € 3.200 €
07.11. - 14.11.2026 2.720 € 3.200 €	14.11. - 21.11.2026 2.380 € 2.800 €	21.11. - 28.11.2026 2.380 € 2.800 €	28.11. - 05.12.2026 2.380 € 2.800 €



WEBSITE

[www.plujeme.cz](http://www.plujeme.cz)



E-MAIL

[info@plujeme.cz](mailto:info@plujeme.cz)



PHONE

+420 720 755 085



MOBILE

+420 777 170 276



PLUJEME RÁDI S.R.O.

Dlouhá 730/35, 11000 Praha 1 – Staré Město, Czech Republic

## PRICE AND AVAILABILITY

05.12. - 12.12.2026

**2.380 €** 2.800 €

12.12. - 19.12.2026

**2.380 €** 2.800 €

19.12. - 26.12.2026

**2.380 €** 2.800 €



### WEBSITE

[www.plujeme.cz](http://www.plujeme.cz)



### E-MAIL

[info@plujeme.cz](mailto:info@plujeme.cz)



### PHONE

+420 720 755 085



### MOBILE

+420 777 170 276



### PLUJEME RÁDI S.R.O.

Dlouhá 730/35, 11000 Praha 1 – Staré Město, Czech Republic