

EXCESS 14

Blue Kiss (2024)

Catamaran **Excess 14 Blue Kiss**, built in **2024** is anchored in the **Dubrovnik, Komolac, ACI Marina Dubrovnik, Dubrovnik region, Croatia**. It has **4 + 2 cabins**, can accommodate **8 + 2 + 2 people** and has **4 toilets**. Bed linen and kitchen equipment are included in the price.

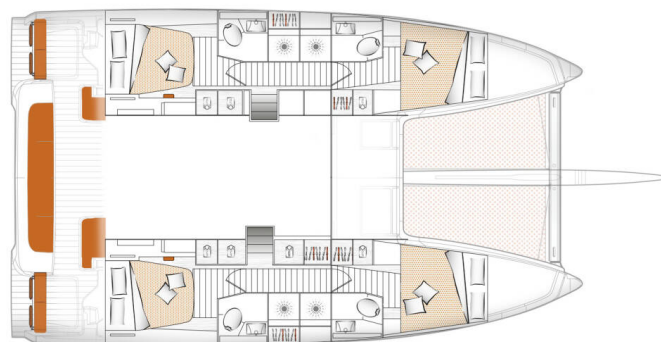

YACHT SPECIFICATIONS

Yacht Base

**Dubrovnik, Komolac, ACI Marina
Dubrovnik, Croatia**

Yacht ID

12452

Brands

Excess

Yacht name

Blue Kiss

Production year

2024

Length

46 ft

Cabins

4 + 2

Berths

8 + 2 + 2

Max Persons

12

WC

4

Engine

2 x 57 HP

Fuel tank

400 l



WEBSITE

www.plujeme.cz



PHONE

+420 720 755 085



MOBILE

+420 777 170 276



E-MAIL

info@plujeme.cz



PLUJEME RÁDI S.R.O.

Dlouhá 730/35, 11000 Praha 1 – Staré Město, Czech Republic

STANDARD YACHT EQUIPMENT

Comfort	Cockpit cushions
Deck	Cockpit fridge, Cockpit/stern, outside shower, Dinghy, Dinghy with outboard engine, Electric anchor windlass, Gangway, Hard Top Bimini, Mooring ropes, Swimming ladder
Entertainment	Outdoor speakers, Stand up paddle (SUP) - FREE
Galley	Gas cookers, Hot water, Nescaffe Dolce Gusto Coffee Maker, Oven, Refrigerator, Stove
Interior	Electric fans, Electric toilet
Navigation	Autopilot, GPS chart plotter - cockpit
Safety	Extra water tank, Liferaft
Sails	Lazy bag
Yacht electrics	220V socket, Air Conditioning, Battery charger, Generator, Isotherm boiler, Service batteries, Shore connection 220 V, Start battery, USB sockets



WEBSITE

www.plujeme.cz



PHONE

+420 720 755 085



MOBILE

+420 777 170 276



E-MAIL

info@plujeme.cz



PLUJEME RÁDI S.R.O.

Dlouhá 730/35, 11000 Praha 1 – Staré Město, Czech Republic

SERVICES

SELECTED SERVICES	OBLIGATORY	PAYMENT TYPE	PRICE
Charter pack (Payable now) Season: 2026. final cleaning, boat permits, berth for the first and last day in home marina, dinghy + outboard engine, bedding, towels, gas for cooking, WiFi unlimited	Yes	per booking	380,00 €
Outboard engine (Payable at the base) Season: 2026. Free	Yes	per booking	0,00 €
Stand up paddle (SUP) (Payable at the base) Season: 2026.	Yes	per booking	0,00 €
Cook (Payable now) Season: 2026. upon request Prepares 3 cooked meals per day/galley responsibilities. Meals for the cook are not included in the daily rate.	No	per week + food	1.750,00 €
Crew change (Payable now) Season: 2026. (with final cleaning)	No	per booking	250,00 €
Deposit insurance (Payable at the base) Season: 2026. Security deposit reduced to 0 EUR; payable at base.	No	per booking	500,00 €
Early Check in (Payable at the base) Season: 2026. 13-14h, subject to availability, payable at base in cash	No	per booking	180,00 €
Hostess (Payable now) Season: 2026. upon request Preparation of breakfast and lunch, boat interior cleaning. Meals for the hostess are not included in the daily rate.	No	per week + food	1.540,00 €
One way (Payable now) Season: 2026. price on request	No	one-way	0,00 €
Pet on board (Payable now) Season: 2026.	No	per booking	250,00 €
Provisioning (Payable now) Season: 2026. bill charge + 50 EUR service fee	No	per booking	0,00 €
Skipper (Payable now) Season: 2026. Food for the skipper are not included in the daily rate!	No	per week + food	1.540,00 €

Transfer (Payable at the base) Season: 2026. Airport Pula-ACI Pula up to 8 pax	No	per booking	60,00 €
Transfer (Payable at the base) Season: 2026. Airport St-ACI Split up to 8 pax	No	one-way	75,00 €
Transfer (Payable at the base) Season: 2026. Airport Dubrovnik-ACI Dubrovnik up to 8 pax	No	per booking	80,00 €

**WEBSITE**www.plujeme.cz**E-MAIL**info@plujeme.cz**PHONE**

+420 720 755 085

**MOBILE**

+420 777 170 276

**PLUJEME RÁDI S.R.O.**

Dlouhá 730/35, 11000 Praha 1 – Staré Město, Czech Republic

ADDITIONAL EXTRAS

EXTRA	OBLIGATORY	PAYMENT TYPE	PRICE
Extra towels (Payable at the base) Season: 2026. Payable at the base	No	per set	10,00 €
Railing net (Safety net) (Payable now) Season: 2026. Without installation! - Payable now	No	per booking	20,00 €
Stand up paddle (SUP) (Payable at the base) Season: 2026. Payable at the base	No	per week	120,00 €



WEBSITE

www.plujeme.cz



E-MAIL

info@plujeme.cz



PHONE

+420 720 755 085



MOBILE

+420 777 170 276



PLUJEME RÁDI S.R.O.

Dlouhá 730/35, 11000 Praha 1 – Staré Město, Czech Republic

PRICE AND AVAILABILITY

14.06. - 21.06.2026 NOT AVAILABLE	27.06. - 30.06.2026 ON OPTION	01.07. - 11.07.2026 NOT AVAILABLE	13.07. - 18.07.2026 NOT AVAILABLE
18.07. - 25.07.2026 9.678 € 12.870 €	28.07. - 31.07.2026 NOT AVAILABLE	02.08. - 07.08.2026 NOT AVAILABLE	08.08. - 15.08.2026 NOT AVAILABLE
15.08. - 22.08.2026 ON OPTION	22.08. - 29.08.2026 9.062 € 12.050 €	29.08. - 05.09.2026 NOT AVAILABLE	05.09. - 12.09.2026 NOT AVAILABLE
12.09. - 19.09.2026 NOT AVAILABLE	19.09. - 26.09.2026 NOT AVAILABLE	26.09. - 03.10.2026 NOT AVAILABLE	03.10. - 10.10.2026 NOT AVAILABLE
10.10. - 17.10.2026 NOT AVAILABLE	17.10. - 24.10.2026 6.862 € 7.300 €	24.10. - 31.10.2026 6.862 € 7.300 €	31.10. - 07.11.2026 6.862 € 7.300 €
07.11. - 14.11.2026 6.862 € 7.300 €	14.11. - 21.11.2026 6.862 € 7.300 €	21.11. - 28.11.2026 6.862 € 7.300 €	28.11. - 05.12.2026 6.862 € 7.300 €
05.12. - 12.12.2026 6.862 € 7.300 €	12.12. - 19.12.2026 6.862 € 7.300 €	19.12. - 26.12.2026 6.862 € 7.300 €	



WEBSITE

www.plujeme.cz



E-MAIL

info@plujeme.cz



PHONE

+420 720 755 085



MOBILE

+420 777 170 276



PLUJEME RÁDI S.R.O.

Dlouhá 730/35, 11000 Praha 1 – Staré Město, Czech Republic