

SUN LOFT 47

Linnea (2020)

Sailing yacht Sun Loft 47 Linnea, built in 2020 is anchored in the BVI, Tortola, Nanny Cay Marina, British Virgin Islands, British Virgin Islands. It has 6 + 1 cabins, can accommodate 12 + 1 people and has 4 + 1 toilets. Bed linen and kitchen equipment are included in the price.

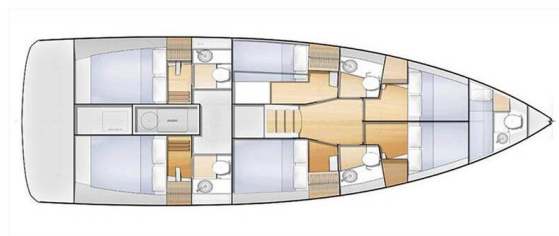

YACHT SPECIFICATIONS

Yacht Base

**BVI, Tortola, Nanny Cay Marina,
British Virgin Islands**

Yacht ID

12436

Brands

Jeanneau

Yacht name

Linnea

Production year

2020

Length

47 ft

Cabins

6 + 1

Berths

12 + 1

Max Persons

12

WC

4 + 1

Engine

1 x 80 HP

Fuel tank

240 l



WEBSITE

www.plujeme.cz



PHONE

+420 720 755 085



MOBILE

+420 777 170 276



E-MAIL

info@plujeme.cz



PLUJEME RÁDI S.R.O.

Dlouhá 730/35, 11000 Praha 1 – Staré Město, Czech Republic

STANDARD YACHT EQUIPMENT

Additional	Flag
Comfort	Blankets, Cockpit cushions, Mattresses, Pillows, Sheets, Sun mattresses
Deck	Anchor with chain, Bilge pump - Mechanic, Bimini top, Boat hook, Bosun's chair (Safe seat) (boatswain's chair), Cockpit fridge, Cockpit grill, Cockpit table, Cockpit/stern, outside shower, Deck brush, Deck lights, Diesel filter, Dinghy with outboard engine, Fenders, Fuel funnel, Galley in cockpit, Gangway, Hot water in cockpit, Jerry cans for fuel, Plastic bucket, Round/globular fender, Spare anchor (Reserve, Auxiliary anchor), Sponge, Sprayhood, Swimming ladder, Water hose
Entertainment	Fins, Fusion radio, Mask and snorkel
Galley	Blender, Electrical filter coffee maker, Gas bottles, Kitchen towel, Kitchen utensils (Galley equipment, cutlery), Microwave, Refrigerator, Sink, Toaster, Water pump
Interior	Clothes hangers, Electric fans in cabins, LED interior lights, Toilet brush
Navigation	Binoculars, Bow thruster, Compass, GPS chart plotter, Log, Nautical charts, Navigation set, Navigation/position Lights, Radar reflector, Raymarine navsystem (Tridata, Echo, Wind), Windex
Safety	Distress flare box, Emergency tiller, Engine spare parts, Fire extinguisher, First aid kit, Flashlight, Fog horn, Inflatable life raft, Life belts (Safety harness), Liferaft, Set of tools, Torch, Wire (shroud) cutter
Sails	Self tacking jib, Winch
Yacht electrics	Air Conditioning, Batteries, Battery charger, Bilge pump - Electric, Generator, Inverter, Motor hours counter, Service batteries, Shore power cable, USB sockets, Water heater



WEBSITE
www.plujeme.cz



PHONE
+420 720 755 085



MOBILE
+420 777 170 276



E-MAIL
info@plujeme.cz



PLUJEME RÁDI S.R.O.
Dlouhá 730/35, 11000 Praha 1 – Staré Město, Czech Republic

SERVICES

SELECTED SERVICES	OBLIGATORY	PAYMENT TYPE	PRICE
BVI Cruising Tax (Payable now) Season: 2026 Exotic . BVI: Cruising tax payable in advance: 4 USD per person / day (Price will be adjusted when the option is confirmed)	Yes	per guest/day	3,48 €
Handling fees (Payable now) Season: 2026 Exotic .	Yes	per booking	35,00 €
Navigare Carefree (Payable now) Season: 2026 Exotic . To be added upon client's price - OBLIGATORY - BVI - SY up to 49 ft - Includes Damage waiver (covering damages) with reduced security deposit addressed specifically to blocked toilets, unpaid fuel, lost equipment, unpaid fees & fines, and returning the boat in an extremely dirty state. NEW!, welcome package, final cleaning, bed sheets & towels, dinghy, outboard engine & fuel, propane gas, full water tanks, snorkelling equipment, National parks permits. Beach towels are provided 1 per person for the charter. Yacht Fuel is not included - the fuel tank will be full when your charter starts and you are responsible for topping off the fuel tank at the end of your charter. CRUISING TAX is NOT INCLUDED.	Yes	per booking	650,00 €
Preparation fee (Payable now) Season: 2026 Exotic . INCLUDED: Welcome pack // final cleaning // 1 set of bed sheets / cabin & 1 set of towels / pax, dinghy, outboard engine & initial supply of fuel, gas and water tanks // 1st & last night in the marina // NOT INCLUDED: refuelling, gas & water consumption at end of charter, taxes if any, handling fees & additional equipment deposit.	Yes	per booking	390,00 €
Search & Sea rescue (Payable at the base) Season: 2026 Exotic . Extra paid at base for the local Search and Sea rescue association (VISAR). The proceeds are fully sent to the association. 5 US \$ per person / Payment in cash only.	Yes	per person	4,55 €
Checkout Skipper (Payable now) Season: 2026 Exotic . A check-out skipper (COS) is a professional captain that boards with you on Day 1, and is dropped off late afternoon the same day. A COS may be requested by you or may be required by Navigare after review of your sailing resume.	No	per booking	370,00 €
Comfort Pack (Payable now) Season: 2026 Exotic . TYM - BVI: final cleaning, bed sheets & towels up to max pax number, cooking gas, full water tanks	No	per booking	0,00 €

Cook (Payable now)

No

per day + food

270,00 €

Season: 2026 Exotic . +provisioning ; Crew on board must have their own toilets/ showers. If either a skipper or a hostess/cook is on board, 1 double cabin will be required for him/her. If both a skipper and a hostess/cook are on board, 1 double cabin and 1 forepeak cabin will be required for them. Exceptions exists for specific layouts, Sales Agents will provide more details about the different boat models. A gratuity of 15-20% of the crew fee is customary for excellent service. Cooking breakfast, lunch, dinners, keeping the kitchen clean (not the rest of the boat, not the cabins). NOTE: Cook details will be available 3 days before the charter.

Cook (Payable now)

No

per day + food

270,00 €

Season: 2026 Exotic . +provisioning ; Crew on board must have their own toilets/ showers. If either a skipper or a hostess/cook is on board, 1 double cabin will be required for him/her. If both a skipper and a hostess/cook are on board, 1 double cabin and 1 forepeak cabin will be required for them. Exceptions exists for specific layouts, Sales Agents will provide more details about the different boat models. A gratuity of 15-20% of the crew fee is customary for excellent service. Cooking breakfast, lunch, dinners, keeping the kitchen clean (not the rest of the boat, not the cabins). NOTE: Cook details will be available 3 days before the charter.

Cook (Payable now)

No

per day + food

270,00 €

Season: 2026 Exotic . +provisioning ; Crew on board must have their own toilets/ showers. If either a skipper or a hostess/cook is on board, 1 double cabin will be required for him/her. If both a skipper and a hostess/cook are on board, 1 double cabin and 1 forepeak cabin will be required for them. Exceptions exists for specific layouts, Sales Agents will provide more details about the different boat models. A gratuity of 15-20% of the crew fee is customary for excellent service. Cooking breakfast, lunch, dinners, keeping the kitchen clean (not the rest of the boat, not the cabins). NOTE: Cook details will be available 3 days before the charter.

Cook (Payable now)

No

per day + food

295,00 €

Season: 2026 Exotic . +provisioning ; Crew on board must have their own toilets/ showers. If either a skipper or a hostess/cook is on board, 1 double cabin will be required for him/her. If both a skipper and a hostess/cook are on board, 1 double cabin and 1 forepeak cabin will be required for them. Exceptions exists for specific layouts, Sales Agents will provide more details about the different boat models. A gratuity of 15-20% of the crew fee is customary for excellent service. Cooking breakfast, lunch, dinners, keeping the kitchen clean (not the rest of the boat, not the cabins). NOTE: Cook details will be available 3 days before the charter.

Cook (Payable now)	No	per day + food	295,00 €
<p>Season: 2026 Exotic . +provisioning ; Crew on board must have their own toilets/ showers. If either a skipper or a hostess/cook is on board, 1 double cabin will be required for him/her. If both a skipper and a hostess/cook are on board, 1 double cabin and 1 forepeak cabin will be required for them. Exceptions exists for specific layouts, Sales Agents will provide more details about the different boat models. A gratuity of 15-20% of the crew fee is customary for excellent service. Cooking breakfast, lunch, dinners, keeping the kitchen clean (not the rest of the boat, not the cabins). NOTE: Cook details will be available 3 days before the charter.</p>			
Crew change (Payable now)	No	per booking	250,00 €
<p>Season: 2026 Exotic . Any crew change during the charter is subject to € 250.- additional cost. The charge includes administration cost, change of bed linen and towels and one night at NY ponton (marina fee included only if the same base than start base). It doesn't include cleaning, nor new transit log where applicable.</p>			
Damage waiver (Payable now)	No	per night	70,00 €
<p>Season: 2026 Exotic . Damage waiver limits your liability to the reduced Security Deposit . Mandatory when skipper is added. Price is per night of the charter (minimum value of 7 nights & a maximum value of 21 nights) Not applicable for 4+ weeks charters , nor Regattas/Races.</p>			
Extra cleaning (Payable now)	No	per booking	290,00 €
<p>Season: 2026 Exotic . Optional Additional cleaning</p>			
Extra set of linen (choose how many) (Payable now)	No	per booking	15,00 €
<p>Season: 2026 Exotic . Extra set of linen : 15 € 1 set of linen (2 sheets & 2 pillow case) - to be updated manually</p>			
Extra set of towels (choose how many) (Payable now)	No	per booking	10,00 €
<p>Season: 2026 Exotic . Extra set of towels: 10 € 1 set of towels (1 face & 1 bath towel) - to be updated manually</p>			
Full board 1-4 pax (number of guests to update manually) (Payable now)	No	per guest/day	75,00 €
<p>Season: 2026 Exotic . only available if cook is booked on board as the cook will do the provisioning based on client's preference. Includes breakfast, lunch & dinner + the crew's food. Does not included alcoholic drinks</p>			
Full board 5-12 pax (number of guests to update manually) (Payable now)	No	per guest/day	75,00 €
<p>Season: 2026 Exotic . only available if cook is booked on board as the cook will do the provisioning based on client's preference. Includes breakfast, lunch & dinner + the crew's food. Does not included alcoholic drinks</p>			

Gritchen cancellation insurance (Payable now) Season: 2026 Exotic . with Covid coverage (4% of client's Total price)- European clients Only	No	per booking	0,00 €
Half board 1-4 pax (number of guests to update manually) (Payable now) Season: 2026 Exotic . only available if cook is booked on board as the cook will do the provisioning based on client's preference. Includes breakfast & lunch OR dinner + the crew's food. Does not included alcoholic drinks	No	per guest/day	60,00 €
Half board 5-12 pax (number of guests to update manually) (Payable now) Season: 2026 Exotic . only available if cook is booked on board as the cook will do the provisioning based on client's preference. Includes breakfast & lunch OR dinner + the crew's food. Does not included alcoholic drinks	No	per guest/day	55,00 €
Sailing Instructor (Payable at the base) Season: 2026 Exotic . Sailing instructor BVI	No	per day + food	350,00 €
Skipper (Payable now) Season: 2026 Exotic . +provisioning ; Crew on board must have their own toilets/ showers. If either a skipper or a hostess/cook is on board, 1 double cabin will be required for him/her. If both a skipper and a hostess/cook are on board, 1 double cabin and 1 forepeak cabin will be required for them. Exceptions exists for specific layouts, Sales Agents will provide more details about the different boat models. A gratuity of 15-20% of the crew fee is customary for excellent service ***NOTE: Skipper details will be available 3 days before the charter.	No	per day + food	310,00 €
Skipper (Payable now) Season: 2026 Exotic . +provisioning ; Crew on board must have their own toilets/ showers. If either a skipper or a hostess/cook is on board, 1 double cabin will be required for him/her. If both a skipper and a hostess/cook are on board, 1 double cabin and 1 forepeak cabin will be required for them. Exceptions exists for specific layouts, Sales Agents will provide more details about the different boat models. A gratuity of 15-20% of the crew fee is customary for excellent service ***NOTE: Skipper details will be available 3 days before the charter.	No	per day + food	310,00 €
Skipper (Payable now) Season: 2026 Exotic . +provisioning ; Crew on board must have their own toilets/ showers. If either a skipper or a hostess/cook is on board, 1 double cabin will be required for him/her. If both a skipper and a hostess/cook are on board, 1 double cabin and 1 forepeak cabin will be required for them. Exceptions exists for specific layouts, Sales Agents will provide more details about the different boat models. A gratuity of 15-20% of the crew fee is customary for excellent service ***NOTE: Skipper details will be available 3 days before the charter.	No	per day + food	310,00 €

Skipper (Payable now)

No

per day + food

340,00 €

Season: 2026 Exotic . +provisioning ; Crew on board must have their own toilets/ showers. If either a skipper or a hostess/cook is on board, 1 double cabin will be required for him/her. If both a skipper and a hostess/cook are on board, 1 double cabin and 1 forepeak cabin will be required for them. Exceptions exists for specific layouts, Sales Agents will provide more details about the different boat models. A gratuity of 15-20% of the crew fee is customary for excellent service ***NOTE: Skipper details will be available 3 days before the charter.

Skipper (Payable now)

No

per day + food

340,00 €

Season: 2026 Exotic . +provisioning ; Crew on board must have their own toilets/ showers. If either a skipper or a hostess/cook is on board, 1 double cabin will be required for him/her. If both a skipper and a hostess/cook are on board, 1 double cabin and 1 forepeak cabin will be required for them. Exceptions exists for specific layouts, Sales Agents will provide more details about the different boat models. A gratuity of 15-20% of the crew fee is customary for excellent service ***NOTE: Skipper details will be available 3 days before the charter.

Sleep over before check in (Payable now)

No

per booking

0,00 €

Season: 2026 Exotic . Sleep over on a day before the check-in: Sleep over from 5PM on a day before the check-in date and time stated in the contract: 65% of the daily rate. (Price will be adjusted when the option is confirmed)

WI-FI Internet connection on boat (Payable now)

No

per night

15,00 €

Season: 2026 Exotic . Unlimited GigaBytes included in the price

**WEBSITE**www.plujeme.cz**PHONE**

+420 720 755 085

**MOBILE**

+420 777 170 276

**E-MAIL**info@plujeme.cz**PLUJEME RÁDI S.R.O.**

Dlouhá 730/35, 11000 Praha 1 – Staré Město, Czech Republic

ADDITIONAL EXTRAS

EXTRA	OBLIGATORY	PAYMENT TYPE	PRICE
Railing net (Safety net) <i>(Payable now)</i> Season: 2026 Exotic . <i>Payable now</i>	No	per booking	155,00 €
Stand up paddle (SUP) <i>(Payable now)</i> Season: 2026 Exotic . <i>Price per day - Payable now</i>	No	per night	15,00 €

**WEBSITE**

www.plujeme.cz

**E-MAIL**

info@plujeme.cz

**PHONE**

+420 720 755 085

**MOBILE**

+420 777 170 276

**PLUJEME RÁDI S.R.O.**

Dlouhá 730/35, 11000 Praha 1 – Staré Město, Czech Republic

PRICE AND AVAILABILITY

25.04. - 02.05.2026 3.060 € 3.825 €	02.05. - 09.05.2026 3.096 € 3.870 €	09.05. - 16.05.2026 3.300 € 4.125 €	16.05. - 23.05.2026 3.288 € 4.110 €
23.05. - 30.05.2026 3.288 € 4.110 €	30.05. - 06.06.2026 3.119 € 4.120 €	06.06. - 13.06.2026 3.090 € 4.120 €	13.06. - 20.06.2026 2.929 € 3.905 €
25.06. - 03.07.2026 NOT AVAILABLE	04.07. - 11.07.2026 2.891 € 3.855 €	11.07. - 18.07.2026 2.891 € 3.855 €	18.07. - 25.07.2026 2.839 € 3.785 €
25.07. - 01.08.2026 2.839 € 3.785 €	04.08. - 09.10.2026 NOT AVAILABLE	10.10. - 17.10.2026 3.585 €	17.10. - 24.10.2026 3.585 €
24.10. - 31.10.2026 3.227 € 3.585 €	31.10. - 07.11.2026 3.227 € 3.585 €	07.11. - 14.11.2026 3.461 € 3.845 €	14.11. - 21.11.2026 3.461 € 3.845 €
21.11. - 28.11.2026 4.167 € 4.630 €	28.11. - 05.12.2026 3.285 € 3.650 €		



WEBSITE

www.plujeme.cz



E-MAIL

info@plujeme.cz



PHONE

+420 720 755 085



MOBILE

+420 777 170 276



PLUJEME RÁDI S.R.O.

Dlouhá 730/35, 11000 Praha 1 – Staré Město, Czech Republic

PRICE AND AVAILABILITY

05.12. - 12.12.2026 3.092 € 3.435 €	12.12. - 19.12.2026 3.092 € 3.435 €	19.12. - 26.12.2026 4.158 € 4.620 €	02.01. - 09.01.2027 4.554 € 5.060 €
09.01. - 16.01.2027 4.554 € 5.060 €	16.01. - 23.01.2027 4.779 € 5.310 €	23.01. - 30.01.2027 5.018 € 5.575 €	30.01. - 06.02.2027 5.274 € 5.860 €
06.02. - 13.02.2027 5.576 € 6.195 €	13.02. - 20.02.2027 5.576 € 6.195 €	20.02. - 27.02.2027 5.576 € 6.195 €	27.02. - 06.03.2027 5.576 € 6.195 €
06.03. - 13.03.2027 6.003 € 6.670 €	13.03. - 20.03.2027 6.003 € 6.670 €	20.03. - 27.03.2027 6.003 € 6.670 €	27.03. - 03.04.2027 5.571 € 6.190 €
03.04. - 10.04.2027 5.571 € 6.190 €	10.04. - 17.04.2027 5.292 € 5.880 €	17.04. - 24.04.2027 4.973 € 5.525 €	24.04. - 01.05.2027 4.626 € 5.140 €
01.05. - 08.05.2027 4.338 € 4.820 €	08.05. - 15.05.2027 4.338 € 4.820 €	15.05. - 22.05.2027 4.338 € 4.820 €	22.05. - 29.05.2027 4.338 € 4.820 €
29.05. - 05.06.2027 4.122 € 4.580 €	05.06. - 12.06.2027 3.915 € 4.350 €	12.06. - 19.06.2027 3.551 € 3.945 €	19.06. - 26.06.2027 3.551 € 3.945 €
26.06. - 03.07.2027 3.726 € 4.140 €	03.07. - 10.07.2027 3.551 € 3.945 €	10.07. - 17.07.2027 3.551 € 3.945 €	17.07. - 24.07.2027 3.551 € 3.945 €
24.07. - 31.07.2027 3.551 € 3.945 €	31.07. - 07.08.2027 3.551 € 3.945 €		



WEBSITE

www.plujeme.cz



E-MAIL

info@plujeme.cz



PHONE

+420 720 755 085



MOBILE

+420 777 170 276



PLUJEME RÁDI S.R.O.

Dlouhá 730/35, 11000 Praha 1 – Staré Město, Czech Republic

PRICE AND AVAILABILITY

07.08. - 14.08.2027 3.227 € 3.585 €	14.08. - 21.08.2027 3.227 € 3.585 €	21.08. - 28.08.2027 3.227 € 3.585 €	28.08. - 04.09.2027 3.227 € 3.585 €
04.09. - 11.09.2027 3.227 € 3.585 €	11.09. - 18.09.2027 3.227 € 3.585 €	18.09. - 25.09.2027 3.227 € 3.585 €	25.09. - 02.10.2027 3.227 € 3.585 €
02.10. - 09.10.2027 3.227 € 3.585 €	09.10. - 16.10.2027 3.227 € 3.585 €	16.10. - 23.10.2027 3.227 € 3.585 €	23.10. - 30.10.2027 3.227 € 3.585 €
30.10. - 06.11.2027 3.227 € 3.585 €	06.11. - 13.11.2027 3.461 € 3.845 €	13.11. - 20.11.2027 3.461 € 3.845 €	20.11. - 27.11.2027 4.167 € 4.630 €
27.11. - 04.12.2027 3.285 € 3.650 €	04.12. - 11.12.2027 3.092 € 3.435 €	11.12. - 18.12.2027 3.092 € 3.435 €	18.12. - 25.12.2027 4.158 € 4.620 €



WEBSITE

www.plujeme.cz



E-MAIL

info@plujeme.cz



PHONE

+420 720 755 085



MOBILE

+420 777 170 276



PLUJEME RÁDI S.R.O.

Dlouhá 730/35, 11000 Praha 1 – Staré Město, Czech Republic