

BALI 4.2

Junior Mary 1 (2026)

Catamaran Bali 4.2 Junior Mary 1, built in 2026 is anchored in the Palairos, Ionian Islands, Greece. It has 4 + 2 cabins, can accommodate 8 people and has 4 + 1 toilets. Bed linen and kitchen equipment are included in the price.

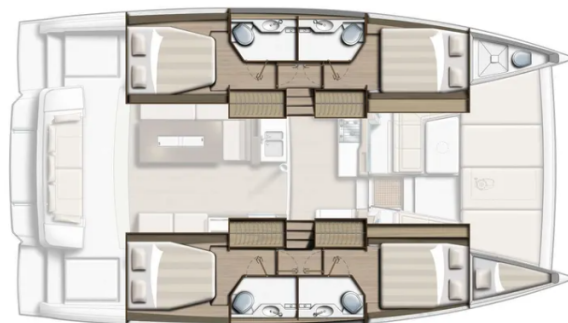

YACHT SPECIFICATIONS

Yacht Base

Palairos, Greece

Yacht ID

12380

Brands

Catana

Yacht name

Junior Mary 1

Production year

2026

Length

42 ft

Cabins

4 + 2

Berths

8

Max Persons

12

WC

4 + 1

Engine

1 x 0 HP

Fuel tank

0 l



WEBSITE

www.plujeme.cz



PHONE

+420 720 755 085



MOBILE

+420 777 170 276



E-MAIL

info@plujeme.cz



PLUJEME RÁDI S.R.O.

Dlouhá 730/35, 11000 Praha 1 – Staré Město, Czech Republic

STANDARD YACHT EQUIPMENT

| | |
|-----------------|--|
| Deck | Dinghy, Grill/Barbecue/Plancha |
| Entertainment | Stand up paddle (SUP) - FREE |
| Galley | Ice maker |
| Interior | Convertible table in salon, Electric toilet |
| Navigation | Autopilot, GPS chart plotter - cockpit, Log, Speed, Depth- echo sounder |
| Sails | Electric winch |
| Yacht electrics | Air Conditioning, Generator, Inverter, Solar panels, Watermaker - desalinator |



WEBSITE

www.plujeme.cz



E-MAIL

info@plujeme.cz



PHONE

+420 720 755 085



MOBILE

+420 777 170 276



PLUJEME RÁDI S.R.O.

Dlouhá 730/35, 11000 Praha 1 – Staré Město, Czech Republic

SERVICES

| SELECTED SERVICES | OBLIGATORY | PAYMENT TYPE | PRICE |
|--|------------|----------------|-----------------|
| Generator (Payable at the base) Season: 2026. Option 1 - Free of charge 8 hours per day, any additional hour comes with a cost of 10 euros per hour. Option 2 - Unlimited use for 200 euros per week. Payable on the spot with cash. | Yes | per hour | 0,00 € |
| Starter pack (Payable at the base) Season: 2026. End cleaning, 1x Cooking gas, Water, Linen 1 set (2 sheets, 1 pillow case, 1 bath towel, 1 face towel) per person, Harbour fees for the first & last night. * If there is pet on board, then double cleaning will be applied.; Payable on the spot with cash 🧺 bag with Greek Local Products is offered to all of our charters as a welcome gift. | Yes | per booking | 350,00 € |
| Cook (Payable at the base) Season: 2026. (Crew require their own cabin); Only responsible for daily cooking / provisioning and cleaning relevant to kitchen area; Payable on the spot with cash; Crew Cancellation Policy A Down payment of 25% is required upon confirmation, and the rest are payable on the spot with cash. Crew cancelled 4 weeks prior to embarkation will have 25% of total crew fee applicable. Crew cancelled less than 14 days prior to embarkation will have 100% of the total crew fee applicable. | No | per day + food | 200,00 € |
| Crew change (Payable at the base) Season: 2026. Payable on the spot with cash Applicable only at one of our bases: Included : Formalities (contract, crew list, etc.) and one day of mooring fees. Not included: Yachts cleaning and laundry. | No | per booking | 150,00 € |
| Early boarding/check-in (Payable at the base) Season: 2026. Access to the yacht by 14:00 In the event of delay beyond our control refunds will be made.; Payable on the spot with cash | No | per booking | 200,00 € |
| Hostess (Payable at the base) Season: 2026. *crew require their own cabin; Payable on the spot with cash Crew Cancellation Policy A Down payment of 25% is required upon confirmation, and the rest are payable on the spot with cash. Crew cancelled 4 weeks prior to embarkation will have 25% of total crew fee applicable. Crew cancelled less than 14 days prior to embarkation will have 100% of the total crew fee applicable. | No | per day + food | 190,00 € |

| | | | |
|--|----|----------------|-----------------|
| Internet pack (Payable at the base) | No | per booking | 70,00 € |
| Season: 2026. +20 € per week after the 1st (WiFi hotspot for up to 5 devices and unlimited usage of internet); Payable on the spot with cash | | | |
| Linen Pack (Payable at the base) | No | per set | 10,00 € |
| Season: 2026. 1 Extra set of linen (2 sheets, 1 pillow case, 1 bath towel, 1 face towel); Payable on the spot with cash | | | |
| Non refundable deposit/ insurance (Payable at the base) | No | per booking | 350,00 € |
| Season: 2026. + refundable deposit 1000 EUR; non refundable payable on spot in cash and refundable payable by credit card on spot * Non-Refundable Deposit is mandatory on all skippered charters. | | | |
| Skipper (Payable at the base) | No | per day + food | 210,00 € |
| Season: 2026. (Crew require their own cabin); Payable on the spot with cash Crew Cancellation Policy A Down payment of 25% is required upon confirmation, and the rest are payable on the spot with cash. Crew cancelled 4 weeks prior to embarkation will have 25% of total crew fee applicable. Crew cancelled less than 14 days prior to embarkation will have 100% of the total crew fee applicable. Damage waiver is obligatory for skippered charters. | | | |
| Welcome package (Payable at the base) | No | per booking | 70,00 € |
| Season: 2026. Toilet and Kitchen rolls, matches, Plastic bags for rubbish, 1 Dish Sponge, 1 Dish, Soap, Sugar, Salt and Pepper, Coffee, 6 bottles of Water, 1 bottle of wine, 6 cans of Coke, 6 cans of Beer, Milk, Orange Juice; Payable on the spot with cash | | | |



WEBSITE

www.plujeme.cz



PHONE

+420 720 755 085



MOBILE

+420 777 170 276



E-MAIL

info@plujeme.cz



PLUJEME RÁDI S.R.O.

Dlouhá 730/35, 11000 Praha 1 – Staré Město, Czech Republic

ADDITIONAL EXTRAS

| EXTRA | OBLIGATORY | PAYMENT TYPE | PRICE |
|---|------------|------------------|-----------------|
| Automatic Inflatable Life Jacket (Payable at the base) Season: 2026. Payable on the spot with cash - Payable at the base | No | per piece | 30,00 € |
| Beach towel (Payable at the base) Season: 2026. Payable on the spot with cash - Payable at the base | No | per piece | 5,00 € |
| Bed linen (Payable at the base) Season: 2026. Payable on the spot with cash - Payable at the base | No | per set | 10,00 € |
| Blister (Payable at the base) Season: 2026. + additional security deposit 500EUR; Payable on the spot with cash - Payable at the base | No | per week | 200,00 € |
| Electric outboard engine (Payable at the base) Season: 2026. 3 HP; Subject to availability, payable on the spot with cash - Payable at the base | No | per week | 110,00 € |
| Grill/Barbecue/Plancha (Payable at the base) Season: 2026. Gas - Payable at the base | No | per week | 100,00 € |
| Kayak (Payable at the base) Season: 2026. Payable on the spot with cash - Payable at the base | No | per week | 130,00 € |
| Life jacket (children) (Payable at the base) Season: 2026. for children under 25 kg, one included in every yacht free of charge; Payable on the spot with cash - Payable at the base | No | per week/ person | 20,00 € |
| Railing net (Safety net) (Payable at the base) Season: 2026. 200 € for yachts up to 46 ft., 300 € per week for yachts above 46ft & catamarans (Half price if the railing net is supplied uninstalled). Payable on the spot with cash - Payable at the base | No | per week | 300,00 € |
| SEA-D00 underwater scooter (Payable at the base) Season: 2026. Payable on the spot with cash - Payable at the base | No | per week | 150,00 € |
| Snorkeling equipment (Payable at the base) Season: 2026. The set contains mask, inhalator and flippers; Payable on the spot with cash - Payable at the base | No | per week/ person | 10,00 € |

Stand up paddle (SUP) (Payable at the base)

No

per week

130,00 €

Season: 2026. Payable on the spot with cash - Payable at the base



WEBSITE

www.plujeme.cz



E-MAIL

info@plujeme.cz



PHONE

+420 720 755 085



MOBILE

+420 777 170 276



PLUJEME RÁDI S.R.O.

Dlouhá 730/35, 11000 Praha 1 – Staré Město, Czech Republic

PRICE AND AVAILABILITY

| | | | |
|--|--|--|--|
| 13.06. - 20.06.2026 NOT AVAILABLE | 20.06. - 27.06.2026 NOT AVAILABLE | 27.06. - 04.07.2026 NOT AVAILABLE | 04.07. - 11.07.2026 NOT AVAILABLE |
| 11.07. - 18.07.2026 NOT AVAILABLE | 18.07. - 25.07.2026 NOT AVAILABLE | 25.07. - 01.08.2026 NOT AVAILABLE | 01.08. - 08.08.2026 NOT AVAILABLE |
| 08.08. - 22.08.2026 NOT AVAILABLE | 22.08. - 29.08.2026 NOT AVAILABLE | 29.08. - 05.09.2026 NOT AVAILABLE | 05.09. - 12.09.2026 NOT AVAILABLE |
| 12.09. - 26.09.2026 NOT AVAILABLE | 26.09. - 03.10.2026 NOT AVAILABLE | 03.10. - 10.10.2026 5.000 € | 10.10. - 17.10.2026 4.147 € 5.000 € |
| 17.10. - 24.10.2026 3.980 € 5.000 € | 24.10. - 31.10.2026 3.980 € 5.000 € | 31.10. - 07.11.2026 3.980 € 5.000 € | 07.11. - 14.11.2026 5.000 € |
| 14.11. - 21.11.2026 5.000 € | 21.11. - 28.11.2026 5.000 € | 28.11. - 03.04.2027 NOT AVAILABLE | |



WEBSITE

www.plujeme.cz



E-MAIL

info@plujeme.cz



PHONE

+420 720 755 085



MOBILE

+420 777 170 276



PLUJEME RÁDI S.R.O.

Dlouhá 730/35, 11000 Praha 1 – Staré Město, Czech Republic

PRICE AND AVAILABILITY

| | | | |
|--|--|--|--|
| 03.04. - 10.04.2027 4.750 € 5.000 € | 10.04. - 17.04.2027 4.750 € 5.000 € | 17.04. - 24.04.2027 5.985 € 6.650 € | 24.04. - 01.05.2027 5.985 € 6.650 € |
| 01.05. - 08.05.2027 5.985 € 6.650 € | 08.05. - 15.05.2027 5.985 € 6.650 € | 15.05. - 22.05.2027 7.695 € 8.550 € | 22.05. - 29.05.2027 7.695 € 8.550 € |
| 29.05. - 05.06.2027 7.695 € 8.550 € | 05.06. - 12.06.2027 7.695 € 8.550 € | 12.06. - 19.06.2027 8.550 € 9.500 € | 19.06. - 26.06.2027 9.025 € 9.500 € |
| 26.06. - 03.07.2027 9.025 € 9.500 € | 03.07. - 10.07.2027 9.025 € 9.500 € | 10.07. - 17.07.2027 9.025 € 9.500 € | 17.07. - 24.07.2027 9.025 € 9.500 € |
| 24.07. - 31.07.2027 10.213 € 10.750 € | 31.07. - 07.08.2027 10.213 € 10.750 € | 07.08. - 14.08.2027 10.213 € 10.750 € | 14.08. - 21.08.2027 9.025 € 9.500 € |
| 21.08. - 28.08.2027 9.025 € 9.500 € | 28.08. - 04.09.2027 9.025 € 9.500 € | 04.09. - 11.09.2027 9.500 € | 11.09. - 18.09.2027 8.550 € |
| 18.09. - 25.09.2027 8.550 € | 25.09. - 02.10.2027 6.650 € | | |



WEBSITE

www.plujeme.cz



E-MAIL

info@plujeme.cz



PHONE

+420 720 755 085



MOBILE

+420 777 170 276



PLUJEME RÁDI S.R.O.

Dlouhá 730/35, 11000 Praha 1 – Staré Město, Czech Republic

PRICE AND AVAILABILITY

| | | | |
|--|--|--|--|
| 02.10. - 09.10.2027 5.000 € | 09.10. - 16.10.2027 5.000 € | 16.10. - 23.10.2027 5.000 € | 23.10. - 30.10.2027 4.500 € 5.000 € |
| 30.10. - 06.11.2027 4.500 € 5.000 € | 06.11. - 13.11.2027 4.500 € 5.000 € | 13.11. - 20.11.2027 4.500 € 5.000 € | 20.11. - 27.11.2027 4.500 € 5.000 € |
| 27.11. - 04.12.2027 4.500 € 5.000 € | 04.12. - 11.12.2027 5.000 € | 11.12. - 18.12.2027 5.000 € | 18.12. - 25.12.2027 5.000 € |



WEBSITE

www.plujeme.cz



E-MAIL

info@plujeme.cz



PHONE

+420 720 755 085



MOBILE

+420 777 170 276



PLUJEME RÁDI S.R.O.

Dlouhá 730/35, 11000 Praha 1 – Staré Město, Czech Republic