

FOUNTAIN PAJOT TANNA 47 MAESTRO

Playful (2025)

Catamaran Fountaine Pajot Tanna 47 Maestro Playful, built in 2025 is anchored in the BVI, Tortola, Nanny Cay Marina, British Virgin Islands, British Virgin Islands. It has 3 cabins, can accommodate 6 people and has 3 toilets. Bed linen and kitchen equipment are included in the price.

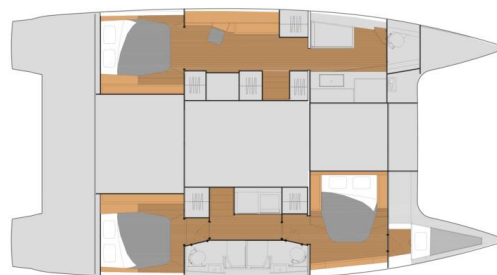

YACHT SPECIFICATIONS

Yacht Base

**BVI, Tortola, Nanny Cay Marina,
British Virgin Islands**

Yacht ID

12372

Brands

Fountaine Pajot

Yacht name

Playful

Production year

2025

Length

46 ft

Cabins

3

Berths

6

WC

3

Engine

2 x 60 HP

Fuel tank

919 l



WEBSITE

www.plujeme.cz



PHONE

+420 720 755 085



MOBILE

+420 777 170 276



E-MAIL

info@plujeme.cz



PLUJEME RÁDI S.R.O.

Dlouhá 730/35, 11000 Praha 1 – Staré Město, Czech Republic

STANDARD YACHT EQUIPMENT

Comfort	Sundeck cushions
Deck	Bathing platform, Cockpit fridge, Cockpit table, Cockpit/stern, outside shower, Dinghy with outboard engine, Electric anchor windlass, Flybridge, Grill/Barbecue/Plancha, Teak cockpit
Entertainment	Fusion radio, Indoor speakers, Outdoor speakers, TV, Underwater lights
Galley	Freezer, Ice maker, Kitchen utensils (Galley equipment, cutlery), Microwave, Oven, Refrigerator, Stove
Interior	Electric toilet
Navigation	Autopilot, GPS chart plotter, Helm station, Wind/speed/depth instruments
Safety	Black Water Tank, VHF radio
Sails	Electric winch, Lazy bag, Lazy jacks
Yacht electrics	110V socket, Air Conditioning, Generator, Inverter, Shore power connection, Solar panels, USB sockets, Watermaker - desalinator



WEBSITE

www.plujeme.cz



E-MAIL

info@plujeme.cz



PHONE

+420 720 755 085



MOBILE

+420 777 170 276



PLUJEME RÁDI S.R.O.

Dlouhá 730/35, 11000 Praha 1 – Staré Město, Czech Republic

SERVICES

SELECTED SERVICES	OBLIGATORY	PAYMENT TYPE	PRICE
Cancellation insurance (Payable now) Season: 2026.	Yes	per booking	200,00 €
Cruising tax (Payable at the base) Season: 2026.	Yes	per guest/day	4,00 €
DRA (Payable now) Season: 2026.	Yes	per day	50,00 €
National parks permit (Payable at the base) Season: 2026.	Yes	per booking	25,00 €
Outboard fuel & Gas (Payable now) Season: 2026. Dinghy Fuel	Yes	per booking	50,00 €
Visar (Payable at the base) Season: 2026.	Yes	per person	5,00 €
Captain (Payable now) Season: 2026. These are included in the invoice. Unlike the US Bases, we pay the Captain's.	No	per day + food	300,00 €
Captain (Payable now) Season: 2026. Instructional; These are included in the invoice. Unlike the US Bases, we pay the Captain's.	No	per day + food	350,00 €
Day Checkout Captain (Payable now) Season: 2026. Checkout Captain is typically a 1/2 day and is only for "testing" the charterers knowledge on the boat before they take it as a bareboat; These are included in the invoice. Unlike the US Bases, we pay the Captain's.	No	per booking	200,00 €
Fishing licence (Payable now) Season: 2026. NOTE: Guests can apply directly to Fisheries Dept. for \$45 per person/application fisheries@gov.vg	No	per licence	65,00 €
Sleep over before check in (Payable now) Season: 2026. 50% of average daily charter price; 4pm with briefing the following morning	No	per booking	0,00 €

Wire Transfer Fee (Payable now)

No

per booking

10,00 €

Season: 2026.



WEBSITE

www.plujeme.cz



E-MAIL

info@plujeme.cz



PHONE

+420 720 755 085



MOBILE

+420 777 170 276



PLUJEME RÁDI S.R.O.

Dlouhá 730/35, 11000 Praha 1 – Staré Město, Czech Republic

ADDITIONAL EXTRAS

EXTRA	OBLIGATORY	PAYMENT TYPE	PRICE
-------	------------	--------------	-------

**WEBSITE**

www.plujeme.cz

**E-MAIL**

info@plujeme.cz

**PHONE**

+420 720 755 085

**MOBILE**

+420 777 170 276

**PLUJEME RÁDI S.R.O.**

Dlouhá 730/35, 11000 Praha 1 – Staré Město, Czech Republic

PRICE AND AVAILABILITY

25.04. - 02.05.2026 10.106 € 10.106 €	02.05. - 09.05.2026 8.907 € 9.375 €	11.05. - 20.05.2026 NOT AVAILABLE	25.05. - 04.06.2026 NOT AVAILABLE
06.06. - 13.06.2026 8.438 € 9.375 €	18.06. - 28.06.2026 NOT AVAILABLE	06.07. - 15.07.2026 NOT AVAILABLE	18.07. - 25.07.2026 8.097 € 8.523 €
25.07. - 01.08.2026 8.580 €	01.08. - 19.10.2026 NOT AVAILABLE	24.10. - 31.10.2026 8.523 €	31.10. - 07.11.2026 8.645 €
13.11. - 23.11.2026 NOT AVAILABLE			



WEBSITE

www.plujeme.cz



E-MAIL

info@plujeme.cz



PHONE

+420 720 755 085



MOBILE

+420 777 170 276



PLUJEME RÁDI S.R.O.

Dlouhá 730/35, 11000 Praha 1 – Staré Město, Czech Republic

PRICE AND AVAILABILITY

01.12. - 10.12.2026 NOT AVAILABLE	12.12. - 19.12.2026 10.106 € 10.106 €	19.12. - 26.12.2026 11.080 €	02.01. - 09.01.2027 10.836 €
09.01. - 16.01.2027 10.228 €	16.01. - 23.01.2027 10.228 €	23.01. - 30.01.2027 10.228 €	02.02. - 11.02.2027 NOT AVAILABLE
13.02. - 20.02.2027 11.080 €	20.02. - 27.02.2027 11.080 €	27.02. - 06.03.2027 11.080 €	06.03. - 13.03.2027 11.080 €
13.03. - 20.03.2027 11.080 €	20.03. - 27.03.2027 11.080 €	27.03. - 03.04.2027 10.836 €	03.04. - 10.04.2027 10.228 €
10.04. - 17.04.2027 10.228 €	17.04. - 24.04.2027 10.228 €	24.04. - 01.05.2027 10.228 €	01.05. - 08.05.2027 9.375 €
08.05. - 15.05.2027 9.375 €	15.05. - 22.05.2027 9.375 €	22.05. - 29.05.2027 9.375 €	29.05. - 05.06.2027 9.375 €
05.06. - 12.06.2027 9.375 €	12.06. - 19.06.2027 9.375 €	19.06. - 26.06.2027 9.375 €	26.06. - 03.07.2027 9.375 €
03.07. - 10.07.2027 9.375 €	10.07. - 17.07.2027 8.523 €	17.07. - 24.07.2027 8.523 €	



WEBSITE
www.plujeme.cz



E-MAIL
info@plujeme.cz



PHONE
+420 720 755 085



PLUJEME RÁDI S.R.O.
Dlouhá 730/35, 11000 Praha 1 – Staré Město, Czech Republic



MOBILE
+420 777 170 276

PRICE AND AVAILABILITY

01.08. - 15.10.2027 NOT AVAILABLE	16.10. - 23.10.2027 8.523 €	23.10. - 30.10.2027 8.523 €	30.10. - 06.11.2027 8.523 €
06.11. - 13.11.2027 9.375 €	13.11. - 20.11.2027 9.375 €	20.11. - 27.11.2027 9.375 €	27.11. - 04.12.2027 9.375 €
04.12. - 11.12.2027 9.375 €	11.12. - 18.12.2027 9.862 €	18.12. - 25.12.2027 11.080 €	



WEBSITE

www.plujeme.cz



E-MAIL

info@plujeme.cz



PHONE

+420 720 755 085



MOBILE

+420 777 170 276



PLUJEME RÁDI S.R.O.

Dlouhá 730/35, 11000 Praha 1 – Staré Město, Czech Republic