

# LAGOON 46

Athina (2026)

Catamaran **Lagoon 46 Athina**, built in **2026** is anchored in the **Corfu, Gouvia Marina, Ionian Islands, Greece**. It has **4 + 2 cabins**, can accommodate **8 + 2 people** and has **4 toilets**. Bed linen and kitchen equipment are included in the price.

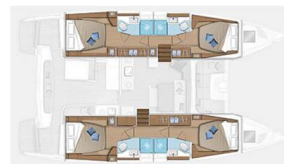

## YACHT SPECIFICATIONS

Yacht Base

**Corfu, Gouvia Marina, Greece**

Yacht ID

**12350**

Brands

**Lagoon**

Yacht name

**Athina**

Production year

**2026**

Length

**46 ft**

Cabins

**4 + 2**

Berths

**8 + 2**

Max Persons

**10**

WC

**4**

Engine

**2 x 45 HP**

Fuel tank

**1040 l**



**WEBSITE**

[www.plujeme.cz](http://www.plujeme.cz)



**PHONE**

+420 720 755 085



**MOBILE**

+420 777 170 276



**E-MAIL**

[info@plujeme.cz](mailto:info@plujeme.cz)



**PLUJEME RÁDI S.R.O.**

Dlouhá 730/35, 11000 Praha 1 – Staré Město, Czech Republic

## STANDARD YACHT EQUIPMENT

Comfort	<b>Cockpit cushions</b>
Deck	<b>Anchor, Bathing platform, Bimini top, Cockpit/stern, outside shower, Deck brush, Dinghy, Electric anchor windlass, Fenders, Outboard engine, Plastic bucket, Sprayhood</b>
Entertainment	<b>Fusion radio, Outdoor speakers, USB</b>
Galley	<b>Hot water, Kitchen utensils (Galley equipment, cutlery), Oven, Refrigerator, Stove</b>
Interior	<b>Electric fans, Electric toilet, Inside shower</b>
Navigation	<b>Autopilot, Compass, GPS, GPS chart plotter, GPS chart plotter - cockpit, Logge/Lot/Speed, Nautical charts, Navigation set, Wind instrument/Anemometer</b>
Safety	<b>Black Water Tank, Fire extinguisher, First aid kit, Flashlight, Safety equipment, Set of tools, VHF radio</b>
Sails	<b>Electric winch, Lazy bag, Lazy jacks</b>
Yacht electrics	<b>Air Conditioning, Generator, Watermaker - desalinator</b>



**WEBSITE**

[www.plujeme.cz](http://www.plujeme.cz)



**PHONE**

+420 720 755 085



**MOBILE**

+420 777 170 276



**E-MAIL**

[info@plujeme.cz](mailto:info@plujeme.cz)



**PLUJEME RÁDI S.R.O.**

Dlouhá 730/35, 11000 Praha 1 – Staré Město, Czech Republic

## SERVICES

SELECTED SERVICES	OBLIGATORY	PAYMENT TYPE	PRICE
<b>Damage waiver</b> (Payable at the base) <b>Season: 2026.</b> + About your Damage Waiver: If you're sailing with us for more than a week, the extra waiver cost for each additional week is 50% of the standard rate. The damage waiver is excluded from racing activities. Therefore, the full security deposit is required for these bookings. For Skipped charters the Damage waiver is 350,00eur If the yacht is returned in perfect condition, we'll give you a reward credit voucher for your next charter! - Reward Bonus: 150,00eur - This is just for you (non-transferable). - It's valid until the end of the year (31/12) and can be used for a trip this year or the next.	Yes	per booking	<b>550,00 €</b>
<b>Service Pack</b> (Payable at the base) <b>Season: 2026.</b> includes: final cleaning, water / 1x cooking gas bottle at the departure, batteries, linen equipment ( towels included ) for each crew member	Yes	per booking	<b>360,00 €</b>
<b>Cook</b> (Payable at the base) <b>Season: 2026.</b> Cook's meals are not included and are covered by the customer. 25% charge applicable if cook service is cancelled less than 4 weeks before departure.	No	per day + food	<b>210,00 €</b>
<b>Drinks pack</b> (Payable at the base) <b>Season: 2026.</b> Drinks Upgrade Pack: Gin (small bottle),Rum (small bottle),Mixers: tonic water, cola, soda water, lemon-lime soft drink ,Freshlemons/limes for garnish,Ice (on request / for first night only)	No	per booking	<b>60,00 €</b>
<b>Early Check in</b> (Payable at the base) <b>Season: 2026.</b> Embarkation at 13:00h option is subject to the condition that the yacht returns without damages from the previous charter	No	per booking	<b>300,00 €</b>
<b>Harbour and marine fee</b> (Payable at the base) <b>Season: 2026.</b> for the first and the last charter-night	No	per booking	<b>0,00 €</b>
<b>Hostess</b> (Payable at the base) <b>Season: 2026.</b> Hostess' meals are not included and are covered by the customer. Crew Cancellations: If canceled less than 30 days prior to departure: 50% of crew services fee is due.	No	per day + food	<b>180,00 €</b>

<b>Kids fun pack</b> (Payable at the base) <b>Season: 2026.</b> Chocolate spread, Fruit juice boxes, Small bottled water, Breakfast cereal (cornflakes or choco pops), Cookies or cereal bars, Fresh fruit (bananas, apples, grapes), Small pack of cheese sticks or babybel-type cheese	No	per booking	<b>35,00 €</b>
<b>Ready to go Pack</b> (Payable at the base) <b>Season: 2026.</b> Toilet paper, Kitchen rolls, Garbage bags (pack), Dish-washing liquid, Sponge, Matches, Sugar, Coffee, Tea, Orange juice, Milk, Cookies, Wine (1 bottle), Water, Fresh fruit, Bread, Butter, Jam, Honey, Beers, Cold cuts, Cheese selection, Yogurt, Fresh vegetables, Eggs, Chips, Crackers, Nuts, Sparkling water, Soft drinks, Extra wine, Breakfast cereal or muesli, Salt & Pepper, Olive oil, Pasta & canned tomato sauce, Small bottle of local ouzo/tsipouro	No	per booking	<b>100,00 €</b>
<b>Skipper</b> (Payable at the base) <b>Season: 2026.</b> Skipper's meals are not included and are covered by the customer. 25% charge applicable if skipper service is cancelled less than 4 weeks before departure.	No	per day	<b>210,00 €</b>
<b>Sunday Check-in</b> (Payable at the base) <b>Season: 2026.</b> additional fee of 150 euros will apply for check-in or check-out on Sundays at our Corfu base.	No	per booking	<b>150,00 €</b>
<b>Sunday Check-out</b> (Payable at the base) <b>Season: 2026.</b> additional fee of 150 euros will apply for check-in or check-out on Sundays at our Corfu base.	No	per booking	<b>150,00 €</b>
<b>Welcome package</b> (Payable at the base) <b>Season: 2026.</b> Toilet paper (per WC), Kitchen rolls (1), Garbage bags (per bin), Dishwashing liquid, Sponge, Sugar, Coffee, Tea, Orange juice, Milk, Cookies, Wine (1 bottle), Water (2-4 bottles)	No	per booking	<b>60,00 €</b>
<b>WI-FI Internet connection on boat</b> (Payable at the base) <b>Season: 2026.</b> unlimited	No	per week	<b>80,00 €</b>



**WEBSITE**  
www.plujeme.cz



**PHONE**  
+420 720 755 085



**MOBILE**  
+420 777 170 276



**E-MAIL**  
info@plujeme.cz



**PLUJEME RÁDI S.R.O.**  
Dlouhá 730/35, 11000 Praha 1 – Staré Město, Czech Republic

## ADDITIONAL EXTRAS

EXTRA	OBLIGATORY	PAYMENT TYPE	PRICE
<b>Extra bedlinen</b> (Payable at the base) <b>Season: 2026.</b> Payable at the base	No	per person	<b>15,00 €</b>
<b>Railing net (Safety net)</b> (Payable at the base) <b>Season: 2026.</b> upon availability - Payable at the base	No	per booking	<b>150,00 €</b>
<b>Spinnaker</b> (Payable at the base) <b>Season: 2026.</b> asymmetrical; on request, not available for all yachts & bases. Not available in: Mykonos, Skiathos, Volos, Avdira, Paros. - Payable at the base	No	per week	<b>200,00 €</b>
<b>Stand up paddle (SUP)</b> (Payable at the base) <b>Season: 2026.</b> + 300 EUR security deposit inflatable SUP - Payable at the base	No	per week	<b>130,00 €</b>

**WEBSITE**[www.plujeme.cz](http://www.plujeme.cz)**E-MAIL**[info@plujeme.cz](mailto:info@plujeme.cz)**PHONE**

+420 720 755 085

**MOBILE**

+420 777 170 276

**PLUJEME RÁDI S.R.O.**

Dlouhá 730/35, 11000 Praha 1 – Staré Město, Czech Republic

## PRICE AND AVAILABILITY

<b>30.05. - 06.06.2026</b> <b>9.571 €</b> 11.260 €	<b>06.06. - 13.06.2026</b> <b>9.571 €</b> 11.260 €	<b>13.06. - 20.06.2026</b> NOT AVAILABLE	<b>20.06. - 04.07.2026</b> NOT AVAILABLE
<b>04.07. - 11.07.2026</b> NOT AVAILABLE	<b>11.07. - 18.07.2026</b> NOT AVAILABLE	<b>18.07. - 01.08.2026</b> NOT AVAILABLE	<b>01.08. - 15.08.2026</b> NOT AVAILABLE
<b>15.08. - 22.08.2026</b> NOT AVAILABLE	<b>22.08. - 29.08.2026</b> NOT AVAILABLE	<b>29.08. - 05.09.2026</b> NOT AVAILABLE	<b>05.09. - 12.09.2026</b> NOT AVAILABLE
<b>12.09. - 19.09.2026</b> NOT AVAILABLE	<b>19.09. - 26.09.2026</b> NOT AVAILABLE	<b>26.09. - 03.10.2026</b> NOT AVAILABLE	<b>03.10. - 10.10.2026</b> <b>7.319 €</b> 8.132 €
<b>10.10. - 17.10.2026</b> <b>7.319 €</b> 8.132 €	<b>17.10. - 24.10.2026</b> <b>7.319 €</b> 8.132 €	<b>24.10. - 31.10.2026</b> <b>7.319 €</b> 8.132 €	<b>31.10. - 07.11.2026</b> <b>6.912 €</b> 8.132 €
<b>07.11. - 14.11.2026</b> <b>6.912 €</b> 8.132 €	<b>14.11. - 21.11.2026</b> <b>6.912 €</b> 8.132 €	<b>21.11. - 28.11.2026</b> <b>6.912 €</b> 8.132 €	<b>28.11. - 05.12.2026</b> <b>6.912 €</b> 8.132 €



### WEBSITE

[www.plujeme.cz](http://www.plujeme.cz)



### E-MAIL

[info@plujeme.cz](mailto:info@plujeme.cz)



### PHONE

+420 720 755 085



### MOBILE

+420 777 170 276



### PLUJEME RÁDI S.R.O.

Dlouhá 730/35, 11000 Praha 1 – Staré Město, Czech Republic

## PRICE AND AVAILABILITY

05.12. - 12.12.2026

**6.912 €** 8.132 €

12.12. - 19.12.2026

**6.912 €** 8.132 €

19.12. - 26.12.2026

**6.912 €** 8.132 €



**WEBSITE**

[www.plujeme.cz](http://www.plujeme.cz)



**E-MAIL**

[info@plujeme.cz](mailto:info@plujeme.cz)



**PHONE**

+420 720 755 085



**MOBILE**

+420 777 170 276



**PLUJEME RÁDI S.R.O.**

Dlouhá 730/35, 11000 Praha 1 – Staré Město, Czech Republic