

BALI 4.6

TERMEN (2024)

Catamaran Bali 4.6 TERMEN, built in 2024 is anchored in the Seychelles, Praslin, Mahé, Seychelles. It has 5 + 2 cabins, can accommodate 10 + 2 people and has 4 toilets. Bed linen and kitchen equipment are included in the price.

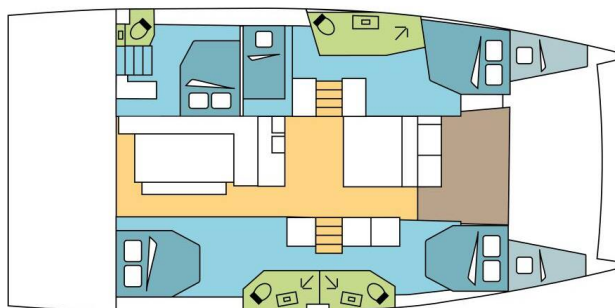

YACHT SPECIFICATIONS

Yacht Base

Seychelles, Praslin, Seychelles

Yacht ID

12295

Brands

Catana

Yacht name

TERMEN

Production year

2024

Length

47 ft

Cabins

5 + 2

Berths

10 + 2

Max Persons

12

WC

4

Engine

2 x 57 HP

Fuel tank

800 l



WEBSITE

www.plujeme.cz



PHONE

+420 720 755 085



MOBILE

+420 777 170 276



E-MAIL

info@plujeme.cz



PLUJEME RÁDI S.R.O.

Dlouhá 730/35, 11000 Praha 1 – Staré Město, Czech Republic

STANDARD YACHT EQUIPMENT

Deck	Cockpit table, Cockpit/stern, outside shower, Dinghy hydraulic lifting system, Electric anchor windlass, Grill/Barbecue/Plancha, Remote control for anchor winch with chain counter at helm, Swimming ladder
Entertainment	Portable Bluetooth speaker
Galley	Oven, Refrigerator
Interior	Electric fans in cabins, Electric toilet
Navigation	AIS, Autopilot, GPS chart plotter - cockpit
Safety	Extra fuel tank, Extra water tank
Sails	Electric main sail winch, Lazy bag, Lazy jacks
Yacht electrics	Air Conditioning, Alternator, Battery charger, Generator, Inverter, Solar panels, Watermaker - desalinator



WEBSITE

www.plujeme.cz



E-MAIL

info@plujeme.cz



PHONE

+420 720 755 085



MOBILE

+420 777 170 276



PLUJEME RÁDI S.R.O.

Dlouhá 730/35, 11000 Praha 1 – Staré Město, Czech Republic

SERVICES

SELECTED SERVICES	OBLIGATORY	PAYMENT TYPE	PRICE
<p>Essentials pack (Payable now)</p> <p>Season: 2026 Exotic. INCLUDED: Damage waiver (covering damages) with reduced security deposit addressed specifically to blocked toilets, unpaid fuel, lost equipment, unpaid fees & fines, and returning the boat in an extremely dirty state. // starter pack – (1 gallon water or 4 bottles of 1.5L, 1 bottle of disinfectant, 1 small bottle of washing up liquid, 1 dish cloth, 1 sponge, garbage bags, 1 roll of paper towels, 1 box of matches, 1 roll of toilet paper in each head) // final cleaning // 1 set of bed sheets & towels, dinghy, outboard engine & initial supply of fuel, gas and water tanks // DYC assistance guarantee // 1st & last night in the marina /// NOT INCLUDED: refuelling, gas & water consumption at end of charter, taxes if any, handling fees & additional equipment deposit.</p>	Yes	per booking	815,00 €
<p>Handling fees (Payable now)</p> <p>Season: 2026 Exotic.</p>	Yes	per booking	35,00 €
<p>Preparation fee (Payable now)</p> <p>Season: 2026 Exotic. INCLUDED: starter pack – (1 gallon water or 4 bottles of 1.5L, 1 bottle of disinfectant, 1 small bottle of washing up liquid, 1 dish cloth, 1 sponge, garbage bags, 1 roll of paper towels, 1 box of matches, 1 roll of toilet paper in each head) // final cleaning // 1 set of bed sheets / cabin & 1 set of towels / pax, dinghy, outboard engine & initial supply of fuel, gas and water tanks // DYC assistance guarantee // 1st & last night in the marina // NOT INCLUDED: refuelling, gas & water consumption at end of charter, taxes if any, handling fees & additional equipment deposit.</p>	Yes	per booking	430,00 €
<p>The Tourism Environmental Sustainability Levy (Payable at the base)</p> <p>Season: 2026 Exotic. According to S.I. 52 of 2023 ENVIRONMENT PROTECTION ACT (ext. of Act 18 of 2016), a Seychelles compulsory levy of 100SCR per person/day (or equivalent Currency as per daily rate) is applied, payable at base. NOT applicable to citizens and residents of Seychelles, children of 12 years and below (visitors), and Dream Yacht crew. . (Price will be adjusted according to the crew list)</p>	Yes	per guest/day	6,67 €
<p>Damage waiver (Payable now)</p> <p>Season: 2026 Exotic. Damage waiver limits your liability to the reduced Security Deposit . Mandatory when skipper is added. Price is per night of the charter (minimum value of 7 nights & a maximum value of 21 nights) Not applicable for 4+ weeks charters , nor Regattas/Races.</p>	No	per night	70,00 €

Deckhand/ Marinero (Payable now) Season: 2026 Exotic. + provisioning	No	per night	130,00 €
Electric & Water consumption in the Marinas (Payable at the base) Season: 2026 Exotic. Electric & Water consumption based on 2 nights on our dock (base will confirm the amount to pay locally depending on nights spent on dock)	No	per booking	36,00 €
Extra cleaning (Payable now) Season: 2026 Exotic. Optional Additional cleaning	No	per booking	340,00 €
Extra set of linen (choose how many) (Payable now) Season: 2026 Exotic. Extra set of linen : 15 € 1 set of linen (2 sheets & 2 pillow case) - to be updated manually	No	per booking	15,00 €
Extra set of towels (choose how many) (Payable now) Season: 2026 Exotic. Extra set of towels: 10 € 1 set of towels (1 face & 1 bath towel) - to be updated manually	No	per booking	10,00 €
Final cleaning (Payable now) Season: 2026 Exotic. included in Essentials pack	No	per booking	340,00 €
Final cleaning (Payable now) Season: 2026 Exotic. included in Essentials pack	No	per booking	340,00 €
Full board 1-3 pax (number of guests to update manually) (Payable now) Season: 2026 Exotic. only available if cook is booked on board as the cook will do the provisioning based on client's preference. Includes breakfast, lunch & dinner + the crew's food. Does not included alcoholic drinks	No	per guest/day	75,00 €
Full board 4-6 pax (number of guests to update manually) (Payable now) Season: 2026 Exotic. only available if cook is booked on board as the cook will do the provisioning based on client's preference. Includes breakfast, lunch & dinner + the crew's food. Does not included alcoholic drinks	No	per guest/day	60,00 €
Full board 7-12 pax (number of guests to update manually) (Payable now) Season: 2026 Exotic. only available if cook is booked on board as the cook will do the provisioning based on client's preference. Includes breakfast, lunch & dinner + the crew's food. Does not included alcoholic drinks	No	per guest/day	55,00 €
Half board 1-3 pax (number of guests to update manually) (Payable now) Season: 2026 Exotic. only available if cook is booked on board as the cook will do the provisioning based on client's preference. Includes breakfast & lunch OR dinner + the crew's food. Does not included alcoholic drinks	No	per guest/day	60,00 €

<p>Half board 4-6 pax (number of guests to update manually) (Payable now)</p> <p>Season: 2026 Exotic. only available if cook is booked on board as the cook will do the provisioning based on client's preference. Includes breakfast & lunch OR dinner + the crew's food. Does not included alcoholic drinks</p>	No	per guest/day	50,00 €
<p>Half board 7-12 pax (number of guests to update manually) (Payable now)</p> <p>Season: 2026 Exotic. only available if cook is booked on board as the cook will do the provisioning based on client's preference. Includes breakfast & lunch OR dinner + the crew's food. Does not included alcoholic drinks</p>	No	per guest/day	45,00 €
<p>Regatta surcharge (Payable now)</p> <p>Season: 2026 Exotic. all the regattas apart of ASW (different regatta surcharge for ASW) // A special race deposit need to be doubled manually once the regatta surcharge is added.</p>	No	per booking	0,00 €
<p>Skipper (Payable now)</p> <p>Season: 2026 Exotic. + provisioning, Crew on board must have their own toilets/ showers. If either a skipper or a hostess/cook is on board, 1 double cabin will be required for him/her. If both a skipper and a hostess/cook are on board, 1 double cabin and 1 forepeak cabin will be required for them. Exceptions exists for specific layouts, Sales Agents will provide more details about the different boat models</p>	No	per night	170,00 €
<p>Skipper (Payable now)</p> <p>Season: 2026 Exotic. + provisioning, Crew on board must have their own toilets/ showers. If either a skipper or a hostess/cook is on board, 1 double cabin will be required for him/her. If both a skipper and a hostess/cook are on board, 1 double cabin and 1 forepeak cabin will be required for them. Exceptions exists for specific layouts, Sales Agents will provide more details about the different boat models</p>	No	per night	170,00 €
<p>Skipper (Payable now)</p> <p>Season: 2026 Exotic. + provisioning, Crew on board must have their own toilets/ showers. If either a skipper or a hostess/cook is on board, 1 double cabin will be required for him/her. If both a skipper and a hostess/cook are on board, 1 double cabin and 1 forepeak cabin will be required for them. Exceptions exists for specific layouts, Sales Agents will provide more details about the different boat models</p>	No	per night	190,00 €

<p>Skipper+Cook (Payable now)</p> <p>Season: 2026 Exotic. (for charters up to max 3 guests, one person works as a skipper and cook)+ provisioning, Crew on board must have their own toilets/ showers. If either a skipper or a hostess/cook is on board, 1 double cabin will be required for him/her. If both a skipper and a hostess/cook are on board, 1 double cabin and 1 forepeak cabin will be required for them. Exceptions exists for specific layouts, Sales Agents will provide more details about the different boat models.</p>	No	per night	220,00 €
<p>Skipper+Cook (Payable now)</p> <p>Season: 2026 Exotic. (for charters up to max 3 guests, one person works as a skipper and cook)+ provisioning, Crew on board must have their own toilets/ showers. If either a skipper or a hostess/cook is on board, 1 double cabin will be required for him/her. If both a skipper and a hostess/cook are on board, 1 double cabin and 1 forepeak cabin will be required for them. Exceptions exists for specific layouts, Sales Agents will provide more details about the different boat models.</p>	No	per night	220,00 €
<p>Skipper+Cook (Payable now)</p> <p>Season: 2026 Exotic. (for charters up to max 3 guests, one person works as a skipper and cook)+ provisioning, Crew on board must have their own toilets/ showers. If either a skipper or a hostess/cook is on board, 1 double cabin will be required for him/her. If both a skipper and a hostess/cook are on board, 1 double cabin and 1 forepeak cabin will be required for them. Exceptions exists for specific layouts, Sales Agents will provide more details about the different boat models.</p>	No	per night	245,00 €
<p>Starter pack (Payable now)</p> <p>Season: 2026 Exotic. included in Essentials pack (The pack includes: 1 gallon water (or 4 bottles of 1.5L), 1 bottle of disinfectant, 1 small bottle of washing up liquid, 1 dish cloth, 1 sponge, garbage bags, 1 roll of paper towels, 1 box of matches, 1 roll of toilet paper in each head</p>	No	per booking	50,00 €
<p>Steward/Cook (Payable now)</p> <p>Season: 2026 Exotic. + provisioning, a cabin or forepeak to sleep and access to a WC/Shower</p>	No	per night	145,00 €
<p>Steward/Cook (Payable now)</p> <p>Season: 2026 Exotic. + provisioning, a cabin or forepeak to sleep and access to a WC/Shower</p>	No	per night	145,00 €
<p>Steward/Cook (Payable now)</p> <p>Season: 2026 Exotic. + provisioning, a cabin or forepeak to sleep and access to a WC/Shower</p>	No	per night	160,00 €

Transfer (Payable now)	No	one-way	15,00 €
Season: 2026 Exotic. OW - Jetty Terminal/base 1 to 4 pax			
Transfer (Payable now)	No	one-way	20,00 €
Season: 2026 Exotic. OW - Jetty Terminal/base 5 to 8 pax			
Transfer (Payable now)	No	one-way	29,00 €
Season: 2026 Exotic. OW - Jetty Terminal/base 9 to 12 pax			
Transfer (Payable now)	No	round trip	78,00 €
Season: 2026 Exotic. RT - Praslin airport/base/airport 1 to 4 pax			
Transfer (Payable now)	No	round trip	98,00 €
Season: 2026 Exotic. RT - Praslin airport/base/airport 5 to 8 pax			
Transfer (Payable now)	No	round trip	118,00 €
Season: 2026 Exotic. RT - Praslin airport/base/airport 9 to 12 pax			
Transfer (Payable now)	No	round trip	136,00 €
Season: 2026 Exotic. RT - Praslin airport/base/airport 13 to 16 pax			



WEBSITE

www.plujeme.cz



PHONE

+420 720 755 085



MOBILE

+420 777 170 276



E-MAIL

info@plujeme.cz



PLUJEME RÁDI S.R.O.

Dlouhá 730/35, 11000 Praha 1 – Staré Město, Czech Republic

ADDITIONAL EXTRAS

EXTRA	OBLIGATORY	PAYMENT TYPE	PRICE
Fishing equipment (Payable now) Season: 2026 Exotic. Additional deposit 100 EUR (subject to availability) - Payable now	No	per day	15,00 €
Kayak single (Payable now) Season: 2026 Exotic. price per day - Payable now	No	per night	15,00 €
Kayak tandem (Payable now) Season: 2026 Exotic. price per day - Payable now	No	per night	15,00 €
Railing net (Safety net) (Payable now) Season: 2026 Exotic. net is supplied but not installed - Payable now	No	per booking	300,00 €
Stand up paddle (SUP) (Payable now) Season: 2026 Exotic. Price per day - Payable now	No	per night	15,00 €
Wi-Fi Internet (Payable now) Season: 2026 Exotic. Wifi Unlimited - Payable now	No	per night	12,00 €

**WEBSITE**www.plujeme.cz**E-MAIL**info@plujeme.cz**PHONE**

+420 720 755 085

**MOBILE**

+420 777 170 276

**PLUJEME RÁDI S.R.O.**

Dlouhá 730/35, 11000 Praha 1 – Staré Město, Czech Republic

PRICE AND AVAILABILITY

13.06. - 20.06.2026 5.052 € 6.315 €	20.06. - 27.06.2026 NOT AVAILABLE	27.06. - 04.07.2026 5.052 € 6.315 €	04.07. - 11.07.2026 5.064 € 6.330 €
11.07. - 25.07.2026 NOT AVAILABLE	26.07. - 02.08.2026 NOT AVAILABLE	08.08. - 15.08.2026 5.660 € 7.075 €	15.08. - 22.08.2026 NOT AVAILABLE
22.08. - 29.08.2026 5.776 € 7.220 €	29.08. - 05.09.2026 5.776 € 7.220 €	05.09. - 12.09.2026 5.776 € 7.220 €	12.09. - 19.09.2026 6.064 € 7.580 €
19.09. - 26.09.2026 6.068 € 7.585 €	26.09. - 03.10.2026 6.409 € 8.011 €	03.10. - 10.10.2026 8.640 € 9.095 €	10.10. - 17.10.2026 9.557 € 10.060 €
17.10. - 24.10.2026 10.227 € 10.765 €	24.10. - 31.10.2026 10.944 € 11.520 €	31.10. - 07.11.2026 ON OPTION	07.11. - 14.11.2026 NOT AVAILABLE
14.11. - 21.11.2026 NOT AVAILABLE	22.11. - 29.11.2026 NOT AVAILABLE	05.12. - 12.12.2026 6.959 € 7.325 €	12.12. - 19.12.2026 6.959 € 7.325 €
19.12. - 26.12.2026 9.267 € 9.755 €	02.01. - 09.01.2027 10.075 € 10.605 €	09.01. - 16.01.2027 8.436 € 8.880 €	16.01. - 23.01.2027 8.436 € 8.880 €
23.01. - 30.01.2027 8.944 € 9.415 €	30.01. - 06.02.2027 9.647 € 10.155 €		



WEBSITE

www.plujeme.cz



E-MAIL

info@plujeme.cz



PHONE

+420 720 755 085



MOBILE

+420 777 170 276



PLUJEME RÁDI S.R.O.

Dlouhá 730/35, 11000 Praha 1 – Staré Město, Czech Republic

PRICE AND AVAILABILITY

06.02. - 13.02.2027 10.863 € 11.435 €	13.02. - 20.02.2027 11.457 € 12.060 €	20.02. - 27.02.2027 12.046 € 12.680 €	27.02. - 06.03.2027 11.471 € 12.075 €
06.03. - 13.03.2027 ON OPTION	13.03. - 20.03.2027 12.070 € 12.705 €	20.03. - 27.03.2027 12.664 € 13.330 €	27.03. - 03.04.2027 12.664 € 13.330 €
03.04. - 10.04.2027 12.664 € 13.330 €	10.04. - 17.04.2027 NOT AVAILABLE	17.04. - 24.04.2027 12.459 € 13.115 €	24.04. - 01.05.2027 11.747 € 12.365 €
01.05. - 08.05.2027 9.790 € 10.305 €	08.05. - 15.05.2027 8.322 € 8.760 €	15.05. - 22.05.2027 7.928 € 8.345 €	22.05. - 29.05.2027 7.928 € 8.345 €
29.05. - 05.06.2027 7.158 € 7.535 €	05.06. - 12.06.2027 7.158 € 7.535 €	12.06. - 19.06.2027 7.158 € 7.535 €	19.06. - 26.06.2027 7.158 € 7.535 €
26.06. - 03.07.2027 7.158 € 7.535 €	03.07. - 10.07.2027 7.576 € 7.975 €	10.07. - 17.07.2027 7.576 € 7.975 €	17.07. - 24.07.2027 7.576 € 7.975 €
24.07. - 31.07.2027 7.576 € 7.975 €	31.07. - 07.08.2027 7.576 € 7.975 €	07.08. - 14.08.2027 7.576 € 7.975 €	14.08. - 21.08.2027 7.576 € 7.975 €
21.08. - 28.08.2027 6.997 € 7.365 €	28.08. - 04.09.2027 6.997 € 7.365 €	04.09. - 11.09.2027 6.997 € 7.365 €	11.09. - 18.09.2027 7.486 € 7.880 €
18.09. - 25.09.2027 7.605 € 8.005 €	25.09. - 02.10.2027 7.741 € 8.149 €		



WEBSITE
www.plujeme.cz



E-MAIL
info@plujeme.cz



PHONE
+420 720 755 085



PLUJEME RÁDI S.R.O.
Dlouhá 730/35, 11000 Praha 1 – Staré Město, Czech Republic



MOBILE
+420 777 170 276

PRICE AND AVAILABILITY

02.10. - 09.10.2027 8.811 € 9.275 €	09.10. - 16.10.2027 9.747 € 10.260 €	16.10. - 23.10.2027 10.431 € 10.980 €	23.10. - 30.10.2027 11.163 € 11.750 €
30.10. - 06.11.2027 12.070 € 12.705 €	06.11. - 13.11.2027 12.977 € 13.660 €	13.11. - 20.11.2027 12.977 € 13.660 €	20.11. - 27.11.2027 11.077 € 11.660 €
27.11. - 04.12.2027 9.177 € 9.660 €	04.12. - 11.12.2027 7.097 € 7.470 €	11.12. - 18.12.2027 7.097 € 7.470 €	18.12. - 25.12.2027 9.453 € 9.950 €



WEBSITE

www.plujeme.cz



E-MAIL

info@plujeme.cz



PHONE

+420 720 755 085



MOBILE

+420 777 170 276



PLUJEME RÁDI S.R.O.

Dlouhá 730/35, 11000 Praha 1 – Staré Město, Czech Republic