

# BALI 4.6

GYPSOPHILA (2024)

Catamaran Bali 4.6 GYPSOPHILA, built in 2024 is anchored in the Polynesia, Raiatea, French Polynesia, French Polynesia.

It has 5 + 2 cabins, can accommodate 10 + 2 people and has 4 toilets. Bed linen and kitchen equipment are included in the price.

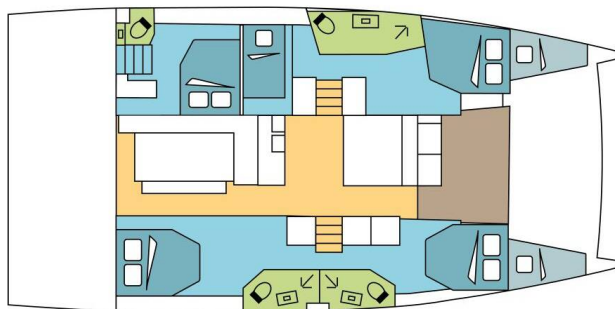

## YACHT SPECIFICATIONS

Yacht Base

**Polynesia, Raiatea, French Polynesia**

Yacht ID

**12255**

Brands

**Catana**

Yacht name

**GYPSOPHILA**

Production year

**2024**

Length

**47 ft**

Cabins

**5 + 2**

Berths

**10 + 2**

Max Persons

**12**

WC

**4**

Engine

**2 x 57 HP**

Fuel tank

**800 l**



**WEBSITE**

[www.plujeme.cz](http://www.plujeme.cz)



**PHONE**

+420 720 755 085



**MOBILE**

+420 777 170 276



**E-MAIL**

[info@plujeme.cz](mailto:info@plujeme.cz)



**PLUJEME RÁDI S.R.O.**

Dlouhá 730/35, 11000 Praha 1 – Staré Město, Czech Republic

## STANDARD YACHT EQUIPMENT

Comfort	<b>Cockpit cushions, Mosquito nets, Sun loungers</b>
Deck	<b>Cockpit table, Cockpit/stern, outside shower, Dinghy, Electric anchor windlass, Fly sunbathing area, Flybridge, Grill/Barbecue/Plancha, Spring cleats, Swimming ladder</b>
Entertainment	<b>Fusion radio</b>
Galley	<b>Oven, Refrigerator</b>
Interior	<b>Electric fans in cabins, Electric toilet</b>
Navigation	<b>AIS, Autopilot, Depthsounder, GPS chart plotter, Speedometer (Speed log), Wind instrument/Anemometer</b>
Safety	<b>VHF radio</b>
Sails	<b>Electric main sail winch, Lazy bag, Lazy jacks</b>
Yacht electrics	<b>Air Conditioning, Alternator, Battery charger, Generator, Inverter, Service batteries, Solar panels, Watermaker - desalinator</b>



**WEBSITE**

[www.plujeme.cz](http://www.plujeme.cz)



**PHONE**

+420 720 755 085



**MOBILE**

+420 777 170 276



**E-MAIL**

[info@plujeme.cz](mailto:info@plujeme.cz)



**PLUJEME RÁDI S.R.O.**

Dlouhá 730/35, 11000 Praha 1 – Staré Město, Czech Republic

## SERVICES

SELECTED SERVICES	OBLIGATORY	PAYMENT TYPE	PRICE
<b>Essentials pack</b> (Payable now) <b>Season: 2026 Exotic.</b> INCLUDED: Damage waiver (covering damages) with reduced security deposit addressed specifically to blocked toilets, unpaid fuel, lost equipment, unpaid fees & fines, and returning the boat in an extremely dirty state. // starter pack – (1 gallon water or 4 bottles of 1.5L, 1 bottle of disinfectant, 1 small bottle of washing up liquid, 1 dish cloth, 1 sponge, garbage bags, 1 roll of paper towels, 1 box of matches, 1 roll of toilet paper in each head) // final cleaning // 1 set of bed sheets & towels, dinghy, outboard engine & initial supply of fuel, gas and water tanks // DYC assistance guarantee // 1st & last night in the marina /// NOT INCLUDED: refuelling, gas & water consumption at end of charter, taxes if any, handling fees & additional equipment deposit.	Yes	per booking	<b>815,00 €</b>
<b>Handling fees</b> (Payable now) <b>Season: 2026 Exotic.</b>	Yes	per booking	<b>35,00 €</b>
<b>Preparation fee</b> (Payable now) <b>Season: 2026 Exotic.</b> INCLUDED: starter pack – (1 gallon water or 4 bottles of 1.5L, 1 bottle of disinfectant, 1 small bottle of washing up liquid, 1 dish cloth, 1 sponge, garbage bags, 1 roll of paper towels, 1 box of matches, 1 roll of toilet paper in each head) // final cleaning // 1 set of bed sheets / cabin & 1 set of towels / pax, dinghy, outboard engine & initial supply of fuel, gas and water tanks // DYC assistance guarantee // 1st & last night in the marina // NOT INCLUDED: refuelling, gas & water consumption at end of charter, taxes if any, handling fees & additional equipment deposit.	Yes	per booking	<b>450,00 €</b>
<b>Additional charge</b> (Payable now) <b>Season: 2026 Exotic.</b> Lost lure	No	per piece	<b>50,00 €</b>
<b>Crew change</b> (Payable now) <b>Season: 2026 Exotic.</b> Any crew change during the charter is subject to € 250.- additional cost. The charge includes administration cost, change of bed linen and towels and one night at DYC ponton (marina fee included only if the same base than start base). It doesn't include cleaning, nor new transit log where applicable.	No	per booking	<b>250,00 €</b>

<b>Damage waiver</b> (Payable now)	No	per night	<b>85,00 €</b>
<b>Season: 2026 Exotic.</b> Damage waiver limits your liability to the reduced Security Deposit . Mandatory when skipper is added. Price is per night of the charter ( minimum value of 7 nights & a maximum value of 21 nights) Not applicable for 4+ weeks charters , nor Regattas/Races.			
<b>Electric &amp; Water consumption in the Marinas</b> (Payable at the base)	No	per booking	<b>36,00 €</b>
<b>Season: 2026 Exotic.</b> Electric & Water consumption based on 2 nights on our dock (base will confirm the amount to pay locally depending on nights spent on dock)			
<b>Extra cleaning</b> (Payable now)	No	per booking	<b>340,00 €</b>
<b>Season: 2026 Exotic.</b> Optional Additional cleaning			
<b>Extra set of linen (choose how many)</b> (Payable now)	No	per booking	<b>15,00 €</b>
<b>Season: 2026 Exotic.</b> Extra set of linen : 15 € 1 set of linen (2 sheets & 2 pillow case) - to be updated manually			
<b>Extra set of towels (choose how many)</b> (Payable now)	No	per booking	<b>10,00 €</b>
<b>Season: 2026 Exotic.</b> Extra set of towels: 10 € 1 set of towels (1 face & 1 bath towel) - to be updated manually			
<b>Final cleaning</b> (Payable now)	No	per booking	<b>340,00 €</b>
<b>Season: 2026 Exotic.</b> included in Essentials pack			
<b>Final cleaning</b> (Payable now)	No	per booking	<b>340,00 €</b>
<b>Season: 2026 Exotic.</b> included in Essentials pack			
<b>Full board 1-3 pax (number of guests to update manually)</b> (Payable now)	No	per guest/day	<b>80,00 €</b>
<b>Season: 2026 Exotic.</b> only available if cook is booked on board as the cook will do the provisioning based on client's preference. Includes breakfast, lunch & dinner + the crew's food. Does not included alcoholic drinks			
<b>Full board 4-6 pax (number of guests to update manually)</b> (Payable now)	No	per guest/day	<b>65,00 €</b>
<b>Season: 2026 Exotic.</b> only available if cook is booked on board as the cook will do the provisioning based on client's preference. Includes breakfast, lunch & dinner + the crew's food. Does not included alcoholic drinks			
<b>Full board 7-12 pax (number of guests to update manually)</b> (Payable now)	No	per guest/day	<b>60,00 €</b>
<b>Season: 2026 Exotic.</b> only available if cook is booked on board as the cook will do the provisioning based on client's preference. Includes breakfast, lunch & dinner + the crew's food. Does not included alcoholic drinks			

<p><b>Half board 1-3 pax (number of guests to update manually)</b> (Payable now)</p> <p><b>Season: 2026 Exotic.</b> only available if cook is booked on board as the cook will do the provisioning based on client's preference. Includes breakfast &amp; lunch OR dinner + the crew's food. Does not included alcoholic drinks</p>	No	per guest/day	<b>65,00 €</b>
<p><b>Half board 4-6 pax (number of guests to update manually)</b> (Payable now)</p> <p><b>Season: 2026 Exotic.</b> only available if cook is booked on board as the cook will do the provisioning based on client's preference. Includes breakfast &amp; lunch OR dinner + the crew's food. Does not included alcoholic drinks</p>	No	per guest/day	<b>55,00 €</b>
<p><b>Half board 7-12 pax (number of guests to update manually)</b> (Payable now)</p> <p><b>Season: 2026 Exotic.</b> only available if cook is booked on board as the cook will do the provisioning based on client's preference. Includes breakfast &amp; lunch OR dinner + the crew's food. Does not included alcoholic drinks</p>	No	per guest/day	<b>50,00 €</b>
<p><b>Hostess/Cook</b> (Payable now)</p> <p><b>Season: 2026 Exotic.</b> + provisioning, Crew on board must have their own toilets/ showers. If either a skipper or a hostess/cook is on board, 1 double cabin will be required for him/her. If both a skipper and a hostess/cook are on board, 1 double cabin and 1 forepeak cabin will be required for them. Exceptions exists for specific layouts, Sales Agents will provide more details about the different boat models</p>	No	per night	<b>215,00 €</b>
<p><b>Hostess/Cook</b> (Payable now)</p> <p><b>Season: 2026 Exotic.</b> + provisioning, Crew on board must have their own toilets/ showers. If either a skipper or a hostess/cook is on board, 1 double cabin will be required for him/her. If both a skipper and a hostess/cook are on board, 1 double cabin and 1 forepeak cabin will be required for them. Exceptions exists for specific layouts, Sales Agents will provide more details about the different boat models</p>	No	per night	<b>215,00 €</b>
<p><b>Hostess/Cook</b> (Payable now)</p> <p><b>Season: 2026 Exotic.</b> + provisioning, Crew on board must have their own toilets/ showers. If either a skipper or a hostess/cook is on board, 1 double cabin will be required for him/her. If both a skipper and a hostess/cook are on board, 1 double cabin and 1 forepeak cabin will be required for them. Exceptions exists for specific layouts, Sales Agents will provide more details about the different boat models</p>	No	per night	<b>235,00 €</b>
<p><b>Race pack</b> (Payable now)</p> <p><b>Season: 2026 Exotic.</b> Tahiti Pearl Regatta / The Regatta Package includes - Briefing before the race, preparation and gauging of sails, registration of the yacht. // A special race deposit need to be doubled manually once the race fee is added.</p>	No	per booking	<b>350,00 €</b>

**Regatta surcharge** (Payable now) No per booking **0,00 €**

**Season: 2026 Exotic.** all the regattas apart of ASW (different regatta surcharge for ASW) // A special race deposit need to be doubled manually once the regatta surcharge is added.

**Skipper** (Payable now) No per night **250,00 €**

**Season: 2026 Exotic.** + provisioning, Crew on board must have their own toilets/ showers. If either a skipper or a hostess/cook is on board, 1 double cabin will be required for him/her. If both a skipper and a hostess/cook are on board, 1 double cabin and 1 forepeak cabin will be required for them. Exceptions exists for specific layouts, Sales Agents will provide more details about the different boat models

**Skipper** (Payable now) No per night **250,00 €**

**Season: 2026 Exotic.** + provisioning, Crew on board must have their own toilets/ showers. If either a skipper or a hostess/cook is on board, 1 double cabin will be required for him/her. If both a skipper and a hostess/cook are on board, 1 double cabin and 1 forepeak cabin will be required for them. Exceptions exists for specific layouts, Sales Agents will provide more details about the different boat models

**Skipper** (Payable now) No per night **275,00 €**

**Season: 2026 Exotic.** + provisioning, Crew on board must have their own toilets/ showers. If either a skipper or a hostess/cook is on board, 1 double cabin will be required for him/her. If both a skipper and a hostess/cook are on board, 1 double cabin and 1 forepeak cabin will be required for them. Exceptions exists for specific layouts, Sales Agents will provide more details about the different boat models

**Starter pack** (Payable now) No per booking **50,00 €**

**Season: 2026 Exotic.** included in Essentials pack (The pack includes: 1 gallon water (or 4 bottles of 1.5L), 1 bottle of disinfectant, 1 small bottle of washing up liquid, 1 dish cloth, 1 sponge, garbage bags, 1 roll of paper towels, 1 box of matches, 1 roll of toilet paper in each head

**Transfer** (Payable now) No one-way **12,00 €**

**Season: 2026 Exotic.** OW - Airport/Base - per pax

**Transfer** (Payable now) No round trip **20,00 €**

**Season: 2026 Exotic.** RT - Airport/Base / per pax



 **WEBSITE**  
www.plujeme.cz

 **PHONE**  
+420 720 755 085

 **MOBILE**  
+420 777 170 276

 **E-MAIL**  
info@plujeme.cz

 **PLUJEME RÁDI S.R.O.**  
Dlouhá 730/35, 11000 Praha 1 – Staré Město, Czech Republic

## ADDITIONAL EXTRAS

EXTRA	OBLIGATORY	PAYMENT TYPE	PRICE
<b>Fishing equipment</b> (Payable now) <b>Season: 2026 Exotic.</b> Additional deposit 100 EUR (subject to availability) - Payable now	No	per day	<b>15,00 €</b>
<b>Kayak single</b> (Payable now) <b>Season: 2026 Exotic.</b> price per day - Payable now	No	per night	<b>15,00 €</b>
<b>Kayak tandem</b> (Payable now) <b>Season: 2026 Exotic.</b> price per day - Payable now	No	per night	<b>15,00 €</b>
<b>Outboard engine 8 &amp; 9,8 HP</b> (Payable now) <b>Season: 2026 Exotic.</b> Dinghy not suitable in any case for waterski or wakeboard. Additional security deposit of 500 € - Payable now	No	per day	<b>35,00 €</b>
<b>Railing net (Safety net)</b> (Payable now) <b>Season: 2026 Exotic.</b> net is supplied but not installed - Payable now	No	per booking	<b>300,00 €</b>
<b>Stand up paddle (SUP)</b> (Payable now) <b>Season: 2026 Exotic.</b> Price per day - Payable now	No	per night	<b>15,00 €</b>

**WEBSITE**[www.plujeme.cz](http://www.plujeme.cz)**E-MAIL**[info@plujeme.cz](mailto:info@plujeme.cz)**PHONE**

+420 720 755 085

**MOBILE**

+420 777 170 276

**PLUJEME RÁDI S.R.O.**

Dlouhá 730/35, 11000 Praha 1 – Staré Město, Czech Republic

## PRICE AND AVAILABILITY

13.06. - 20.06.2026 NOT AVAILABLE	20.06. - 27.06.2026 NOT AVAILABLE	28.06. - 08.07.2026 NOT AVAILABLE	10.07. - 17.07.2026 NOT AVAILABLE
17.07. - 23.07.2026 NOT AVAILABLE	23.07. - 29.07.2026 ON OPTION	29.07. - 05.08.2026 NOT AVAILABLE	07.08. - 15.08.2026 NOT AVAILABLE
15.08. - 21.08.2026 NOT AVAILABLE	21.08. - 31.08.2026 NOT AVAILABLE	01.09. - 17.09.2026 NOT AVAILABLE	19.09. - 26.09.2026 NOT AVAILABLE
26.09. - 03.10.2026 <b>14.906 €</b>	03.10. - 10.10.2026 <b>17.081 €</b> 17.980 €	10.10. - 17.10.2026 NOT AVAILABLE	17.10. - 28.10.2026 NOT AVAILABLE
31.10. - 07.11.2026 <b>12.963 €</b> 13.645 €	07.11. - 14.11.2026 <b>11.813 €</b> 12.435 €	14.11. - 21.11.2026 <b>10.745 €</b> 11.310 €	21.11. - 29.11.2026 NOT AVAILABLE
30.11. - 09.12.2026 NOT AVAILABLE	12.12. - 19.12.2026 <b>6.755 €</b> 7.110 €	19.12. - 26.12.2026 <b>8.569 €</b> 9.020 €	26.12. - 04.01.2027 NOT AVAILABLE
09.01. - 16.01.2027 <b>6.755 €</b> 7.110 €	16.01. - 23.01.2027 <b>6.755 €</b> 7.110 €	23.01. - 30.01.2027 <b>6.755 €</b> 7.110 €	30.01. - 06.02.2027 <b>7.158 €</b> 7.535 €



WEBSITE

[www.plujeme.cz](http://www.plujeme.cz)



E-MAIL

[info@plujeme.cz](mailto:info@plujeme.cz)



PHONE

+420 720 755 085



MOBILE

+420 777 170 276



PLUJEME RÁDI S.R.O.

Dlouhá 730/35, 11000 Praha 1 – Staré Město, Czech Republic

## PRICE AND AVAILABILITY

06.02. - 13.02.2027 <b>7.586 €</b> 7.985 €	13.02. - 20.02.2027 <b>8.042 €</b> 8.465 €	20.02. - 27.02.2027 <b>8.683 €</b> 9.140 €	27.02. - 06.03.2027 <b>9.134 €</b> 9.615 €
06.03. - 13.03.2027 <b>9.586 €</b> 10.090 €	13.03. - 20.03.2027 <b>11.201 €</b> 11.790 €	20.03. - 27.03.2027 <b>12.193 €</b> 12.835 €	27.03. - 03.04.2027 <b>13.048 €</b> 13.735 €
03.04. - 10.04.2027 <b>13.713 €</b> 14.435 €	10.04. - 17.04.2027 <b>15.352 €</b> 16.160 €	17.04. - 24.04.2027 NOT AVAILABLE	24.04. - 01.05.2027 <b>14.179 €</b> 14.925 €
01.05. - 15.05.2027 NOT AVAILABLE	15.05. - 29.05.2027 NOT AVAILABLE	29.05. - 05.06.2027 <b>12.887 €</b> 13.565 €	05.06. - 12.06.2027 <b>12.887 €</b> 13.565 €
12.06. - 19.06.2027 <b>12.887 €</b> 13.565 €	19.06. - 26.06.2027 <b>12.887 €</b> 13.565 €	26.06. - 03.07.2027 <b>12.887 €</b> 13.565 €	03.07. - 10.07.2027 <b>13.789 €</b> 14.515 €
10.07. - 17.07.2027 <b>14.754 €</b> 15.530 €	17.07. - 24.07.2027 <b>15.784 €</b> 16.615 €	24.07. - 31.07.2027 <b>16.891 €</b> 17.780 €	31.07. - 07.08.2027 <b>19.100 €</b> 20.105 €
07.08. - 17.08.2027 NOT AVAILABLE	21.08. - 28.08.2027 <b>16.559 €</b> 17.430 €	28.08. - 04.09.2027 <b>15.770 €</b> 16.600 €	04.09. - 11.09.2027 <b>15.770 €</b> 16.600 €
11.09. - 18.09.2027 <b>15.770 €</b> 16.600 €	18.09. - 25.09.2027 <b>15.770 €</b> 16.600 €	25.09. - 02.10.2027 <b>16.539 €</b> 17.409 €	



WEBSITE

[www.plujeme.cz](http://www.plujeme.cz)



E-MAIL

[info@plujeme.cz](mailto:info@plujeme.cz)



PHONE

+420 720 755 085



MOBILE

+420 777 170 276



PLUJEME RÁDI S.R.O.

Dlouhá 730/35, 11000 Praha 1 – Staré Město, Czech Republic

## PRICE AND AVAILABILITY

02.10. - 09.10.2027 <b>17.423 €</b> 18.340 €	09.10. - 16.10.2027 <b>17.423 €</b> 18.340 €	16.10. - 23.10.2027 <b>15.210 €</b> 16.010 €	23.10. - 30.10.2027 <b>14.260 €</b> 15.010 €
30.10. - 06.11.2027 <b>13.224 €</b> 13.920 €	06.11. - 13.11.2027 <b>12.051 €</b> 12.685 €	13.11. - 20.11.2027 <b>10.958 €</b> 11.535 €	20.11. - 27.11.2027 <b>10.308 €</b> 10.850 €
27.11. - 04.12.2027 <b>8.170 €</b> 8.600 €	04.12. - 11.12.2027 <b>6.888 €</b> 7.250 €	11.12. - 18.12.2027 <b>6.888 €</b> 7.250 €	18.12. - 25.12.2027 <b>8.740 €</b> 9.200 €



### WEBSITE

[www.plujeme.cz](http://www.plujeme.cz)



### E-MAIL

[info@plujeme.cz](mailto:info@plujeme.cz)



### PHONE

+420 720 755 085



### MOBILE

+420 777 170 276



### PLUJEME RÁDI S.R.O.

Dlouhá 730/35, 11000 Praha 1 – Staré Město, Czech Republic