

BALI 4.6

CROCUS (2024)

Catamaran Bali 4.6 CROCUS, built in 2024 is anchored in the **St. Martin, Marina de L'Anse Marcel, St. Martin, Caribbean**. It has **5 + 2 cabins**, can accommodate **10 + 2 people** and has **4 toilets**. Bed linen and kitchen equipment are included in the price.

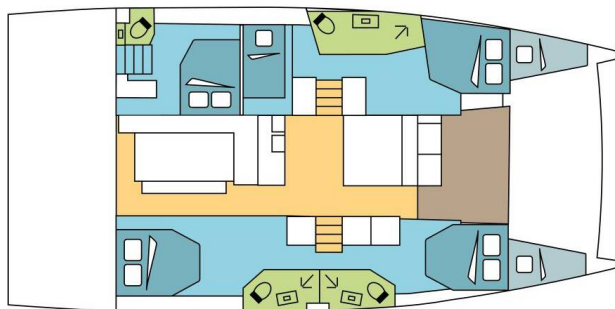

YACHT SPECIFICATIONS

Yacht Base

**St. Martin, Marina de L'Anse Marcel,
Caribbean**

Yacht ID

12246

Brands

Catana

Yacht name

CROCUS

Production year

2024

Length

47 ft

Cabins

5 + 2

Berths

10 + 2

Max Persons

12

WC

4

Engine

2 x 57 HP

Fuel tank

800 l



WEBSITE

www.plujeme.cz



PHONE

+420 720 755 085



MOBILE

+420 777 170 276



E-MAIL

info@plujeme.cz



PLUJEME RÁDI S.R.O.

Dlouhá 730/35, 11000 Praha 1 – Staré Město, Czech Republic

STANDARD YACHT EQUIPMENT

Comfort	Cockpit cushions, Helmstation seat cushions, Mosquito nets
Deck	Bimini top, Cockpit table, Cockpit/stern, outside shower, Electric anchor windlass, Fly sunbathing area, Flybridge, Grill/Barbecue/Plancha, Swimming ladder
Entertainment	Fusion radio
Galley	Additional fridge, Oven, Refrigerator
Interior	Electric fans in cabins, Electric toilet, Upholstery
Navigation	AIS, Autopilot, GPS chart plotter
Safety	VHF radio
Sails	Electric main sail winch, Lazy bag, Lazy jacks
Yacht electrics	Air Conditioning, Battery charger, Generator, Inverter, Service batteries, Shore connection 220 V, Solar panels, Watermaker - desalinator



WEBSITE

www.plujeme.cz



E-MAIL

info@plujeme.cz



PHONE

+420 720 755 085



MOBILE

+420 777 170 276



PLUJEME RÁDI S.R.O.

Dlouhá 730/35, 11000 Praha 1 – Staré Město, Czech Republic

SERVICES

SELECTED SERVICES	OBLIGATORY	PAYMENT TYPE	PRICE
Essentials pack (Payable now) Season: 2026 Exotic. INCLUDED: Damage waiver (covering damages) with reduced security deposit addressed specifically to blocked toilets, unpaid fuel, lost equipment, unpaid fees & fines, and returning the boat in an extremely dirty state. // starter pack – (1 gallon water or 4 bottles of 1.5L, 1 bottle of disinfectant, 1 small bottle of washing up liquid, 1 dish cloth, 1 sponge, garbage bags, 1 roll of paper towels, 1 box of matches, 1 roll of toilet paper in each head) // final cleaning // 1 set of bed sheets & towels, dinghy, outboard engine & initial supply of fuel, gas and water tanks // DYC assistance guarantee // 1st & last night in the marina /// NOT INCLUDED: refuelling, gas & water consumption at end of charter, taxes if any, handling fees & additional equipment deposit.	Yes	per booking	815,00 €
Handling fees (Payable now) Season: 2026 Exotic.	Yes	per booking	35,00 €
Nature reserve tax (Payable at the base) Season: 2026 Exotic. payable at base	Yes	per person	5,00 €
Preparation fee (Payable now) Season: 2026 Exotic. INCLUDED: starter pack – (1 gallon water or 4 bottles of 1.5L, 1 bottle of disinfectant, 1 small bottle of washing up liquid, 1 dish cloth, 1 sponge, garbage bags, 1 roll of paper towels, 1 box of matches, 1 roll of toilet paper in each head) // final cleaning // 1 set of bed sheets / cabin & 1 set of towels / pax, dinghy, outboard engine & initial supply of fuel, gas and water tanks // DYC assistance guarantee // 1st & last night in the marina // NOT INCLUDED: refuelling, gas & water consumption at end of charter, taxes if any, handling fees & additional equipment deposit.	Yes	per booking	430,00 €
Crew change (Payable now) Season: 2026 Exotic. Any crew change during the charter is subject to € 250.- additional cost. The charge includes administration cost, change of bed linen and towels and one night at DYC ponton (marina fee included only if the same base than start base). It doesn't include cleaning, nor new transit log where applicable.	No	per booking	250,00 €

Damage waiver (Payable now)	No	per night	70,00 €
Season: 2026 Exotic. Damage waiver limits your liability to the reduced Security Deposit . Mandatory when skipper is added. Price is per night of the charter (minimum value of 7 nights & a maximum value of 21 nights) Not applicable for 4+ weeks charters , nor Regattas/Races.			
Early boarding/check-in (Payable now)	No	per booking	480,00 €
Season: 2026 Exotic. EB (boat only) - 14:00 h / 2 PM starting time of boat's delivery // limited number of early boardings on same departure day			
Early boarding/check-in (Payable now)	No	per booking	700,00 €
Season: 2026 Exotic. EB boat + extra fee skipper - 14:00 h / 2 PM starting time of boat's delivery // limited number of early boardings on same departure day			
Early boarding/check-in (Payable now)	No	per booking	885,00 €
Season: 2026 Exotic. EB + extra fee Skipper & Hostes - 14:00 h / 2 PM starting time of boat's delivery // limited number of early boardings on same departure day			
Electric & Water consumption in the Marinas (Payable at the base)	No	per booking	36,00 €
Season: 2026 Exotic. Electric & Water consumption based on 2 nights on our dock (base will confirm the amount to pay locally depending on nights spent on dock)			
Extra cleaning (Payable now)	No	per booking	340,00 €
Season: 2026 Exotic. Optional Additional cleaning			
Extra set of linen (choose how many) (Payable now)	No	per booking	15,00 €
Season: 2026 Exotic. Extra set of linen : 15 € 1 set of linen (2 sheets & 2 pillow case) - to be updated manually			
Extra set of towels (choose how many) (Payable now)	No	per booking	10,00 €
Season: 2026 Exotic. Extra set of towels: 10 € 1 set of towels (1 face & 1 bath towel) - to be updated manually			
Final cleaning (Payable now)	No	per booking	340,00 €
Season: 2026 Exotic. included in Essentials pack			
Final cleaning (Payable now)	No	per booking	340,00 €
Season: 2026 Exotic. included in Essentials pack			
Full board 1-4 pax (number of guests to update manually) (Payable now)	No	per guest/day	65,00 €
Season: 2026 Exotic. only available if cook is booked on board as the cook will do the provisioning based on client's preference. Includes breakfast, lunch & dinner + the crew's food. Does not included alcoholic drinks			

<p>Full board 5-12 pax (number of guests to update manually) (Payable now)</p> <p>Season: 2026 Exotic. only available if cook is booked on board as the cook will do the provisioning based on client's preference. Includes breakfast, lunch & dinner + the crew's food. Does not included alcoholic drinks</p>	No	per guest/day	60,00 €
<p>Half board 1-4 pax (number of guests to update manually) (Payable now)</p> <p>Season: 2026 Exotic. only available if cook is booked on board as the cook will do the provisioning based on client's preference. Includes breakfast & lunch OR dinner + the crew's food. Does not included alcoholic drinks</p>	No	per guest/day	55,00 €
<p>Half board 5-12 pax (number of guests to update manually) (Payable now)</p> <p>Season: 2026 Exotic. only available if cook is booked on board as the cook will do the provisioning based on client's preference. Includes breakfast & lunch OR dinner + the crew's food. Does not included alcoholic drinks</p>	No	per guest/day	50,00 €
<p>Hostess/Cook (Payable now)</p> <p>Season: 2026 Exotic. + provisioning, Crew on board must have their own toilets/ showers. If either a skipper or a hostess/cook is on board, 1 double cabin will be required for him/her. If both a skipper and a hostess/cook are on board, 1 double cabin and 1 forepeak cabin will be required for them. Exceptions exists for specific layouts, Sales Agents will provide more details about the different boat models</p>	No	per night	230,00 €
<p>Hostess/Cook (Payable now)</p> <p>Season: 2026 Exotic. + provisioning, Crew on board must have their own toilets/ showers. If either a skipper or a hostess/cook is on board, 1 double cabin will be required for him/her. If both a skipper and a hostess/cook are on board, 1 double cabin and 1 forepeak cabin will be required for them. Exceptions exists for specific layouts, Sales Agents will provide more details about the different boat models</p>	No	per night	230,00 €
<p>Hostess/Cook (Payable now)</p> <p>Season: 2026 Exotic. + provisioning, Crew on board must have their own toilets/ showers. If either a skipper or a hostess/cook is on board, 1 double cabin will be required for him/her. If both a skipper and a hostess/cook are on board, 1 double cabin and 1 forepeak cabin will be required for them. Exceptions exists for specific layouts, Sales Agents will provide more details about the different boat models</p>	No	per night	255,00 €
<p>Race pack (Payable now)</p> <p>Season: 2026 Exotic. BVI Spring Regatta, Briefing before the race, preparation and gauging of sails, registration of th eyacht (not of the passengers), technical assistance during the race ** ** technical assistance during the race not valid for RORC Caribbean 600 // A special race deposit need to be doubled manually once the race fee is added.</p>	No	per booking	1.320,00 €

Race pack (Payable now)	No	per booking	1.650,00 €
Season: 2026 Exotic. Antigua, Briefing before the race, preparation and gauging of sails, registration of the yacht (not of the passengers), technical assistance during the race *** technical assistance during the race not valid for RORC Caribbean 600 // A special race deposit need to be doubled manually once the race fee is added.			
Race pack (Payable now)	No	per booking	1.650,00 €
Season: 2026 Exotic. RORC caribbean 600, Briefing before the race, preparation and gauging of sails, registration of the yacht (not of the passengers), technical assistance during the race *** technical assistance during the race not valid for RORC Caribbean 600 // A special race deposit need to be doubled manually once the race fee is added.			
Regatta surcharge (Payable now)	No	per booking	1.950,00 €
Season: 2026 Exotic. valid for ASW regatta only // A special race deposit need to be doubled manually once the regatta surcharge is added.			
Regatta surcharge (Payable now)	No	per booking	0,00 €
Season: 2026 Exotic. all the regattas apart of ASW (different regatta surcharge for ASW) // A special race deposit need to be doubled manually once the regatta surcharge is added.			
Same day briefing (Payable now)	No	per booking	150,00 €
Season: 2026 Exotic. Same day briefing starting between 5 & 5.30pm (departure following morning)			
Skipper (Payable now)	No	per night	300,00 €
Season: 2026 Exotic. + provisioning, Crew on board must have their own toilets/ showers. If either a skipper or a hostess/cook is on board, 1 double cabin will be required for him/her. If both a skipper and a hostess/cook are on board, 1 double cabin and 1 forepeak cabin will be required for them. Exceptions exists for specific layouts, Sales Agents will provide more details about the different boat models			
Skipper (Payable now)	No	per night	300,00 €
Season: 2026 Exotic. + provisioning, Crew on board must have their own toilets/ showers. If either a skipper or a hostess/cook is on board, 1 double cabin will be required for him/her. If both a skipper and a hostess/cook are on board, 1 double cabin and 1 forepeak cabin will be required for them. Exceptions exists for specific layouts, Sales Agents will provide more details about the different boat models			

Skipper (Payable now)	No	per night	330,00 €
Season: 2026 Exotic. + provisioning, Crew on board must have their own toilets/ showers. If either a skipper or a hostess/cook is on board, 1 double cabin will be required for him/her. If both a skipper and a hostess/cook are on board, 1 double cabin and 1 forepeak cabin will be required for them. Exceptions exists for specific layouts, Sales Agents will provide more details about the different boat models			
Starter pack (Payable now)	No	per booking	50,00 €
Season: 2026 Exotic. included in Essentials pack (The pack includes: 1 gallon water (or 4 bottles of 1.5L), 1 bottle of disinfectant, 1 small bottle of washing up liquid, 1 dish cloth, 1 sponge, garbage bags, 1 roll of paper towels, 1 box of matches, 1 roll of toilet paper in each head			
Transfer (Payable now)	No	round trip	26,00 €
Season: 2026 Exotic. RT - Grand Case airport/base - additional pax			
Transfer (Payable now)	No	round trip	65,00 €
Season: 2026 Exotic. RT - Juliana airport/base additional pax			
Transfer (Payable now)	No	round trip	78,00 €
Season: 2026 Exotic. RT -Grand Case airport – St Martin base 1-3 pax			
Transfer (Payable now)	No	round trip	195,00 €
Season: 2026 Exotic. RT - Juliana airport – St Martin base 1-3 pax			



WEBSITE

www.plujeme.cz



PHONE

+420 720 755 085



MOBILE

+420 777 170 276



E-MAIL

info@plujeme.cz



PLUJEME RÁDI S.R.O.

Dlouhá 730/35, 11000 Praha 1 – Staré Město, Czech Republic

ADDITIONAL EXTRAS

EXTRA	OBLIGATORY	PAYMENT TYPE	PRICE
Fishing equipment (Payable now) Season: 2026 Exotic. Additional deposit 100 EUR (subject to availability) - Payable now	No	per day	15,00 €
Kayak single (Payable now) Season: 2026 Exotic. price per day - Payable now	No	per night	15,00 €
Kayak tandem (Payable now) Season: 2026 Exotic. price per day - Payable now	No	per night	15,00 €
Outboard engine 8 & 9,8 HP (Payable now) Season: 2026 Exotic. Dinghy not suitable in any case for waterski or wakeboard. Additional security deposit of 500 € on outboard engines. A powerboat licence is mandatory in French territories to drive a dinghy with an outboard more powerful than 6hp. It's client responsibility to ensure to have the right powerboat licence when renting a more powerful outboard. In case the needed licence is not presented at base, it will not be possible to use this larger outboard which will not be refunded - Payable now	No	per day	35,00 €
Railing net (Safety net) (Payable now) Season: 2026 Exotic. net is supplied but not installed - Payable now	No	per booking	300,00 €
Stand up paddle (SUP) (Payable now) Season: 2026 Exotic. Price per day - Payable now	No	per night	15,00 €



WEBSITE
www.plujeme.cz



PHONE
+420 720 755 085



MOBILE
+420 777 170 276



E-MAIL
info@plujeme.cz



PLUJEME RÁDI S.R.O.
Dlouhá 730/35, 11000 Praha 1 – Staré Město, Czech Republic

PRICE AND AVAILABILITY

03.05. - 11.05.2026 NOT AVAILABLE	18.05. - 01.06.2026 NOT AVAILABLE	06.06. - 13.06.2026 7.150 €	13.06. - 20.06.2026 6.955 €
20.06. - 27.06.2026 7.610 €	27.06. - 04.07.2026 7.600 €	04.07. - 11.07.2026 NOT AVAILABLE	11.07. - 18.07.2026 6.155 €
18.07. - 25.07.2026 5.540 €	31.07. - 08.08.2026 NOT AVAILABLE	08.08. - 15.08.2026 5.590 €	15.08. - 22.08.2026 5.590 €
22.08. - 29.08.2026 5.590 €	31.08. - 17.09.2026 NOT AVAILABLE	19.09. - 26.09.2026 5.590 €	26.09. - 03.10.2026 5.690 €
03.10. - 10.10.2026 5.643 € 5.940 €	10.10. - 17.10.2026 5.643 € 5.940 €	17.10. - 24.10.2026 5.643 € 5.940 €	24.10. - 31.10.2026 6.631 € 6.980 €
01.11. - 09.11.2026 NOT AVAILABLE	14.11. - 28.11.2026 NOT AVAILABLE	28.11. - 05.12.2026 8.251 € 8.685 €	05.12. - 12.12.2026 7.614 € 8.015 €
13.12. - 20.12.2026 NOT AVAILABLE	20.12. - 30.12.2026 ON OPTION		



WEBSITE

www.plujeme.cz



E-MAIL

info@plujeme.cz



PHONE

+420 720 755 085



MOBILE

+420 777 170 276



PLUJEME RÁDI S.R.O.

Dlouhá 730/35, 11000 Praha 1 – Staré Město, Czech Republic

PRICE AND AVAILABILITY

02.01. - 09.01.2027 10.559 € 11.115 €	09.01. - 16.01.2027 10.559 € 11.115 €	16.01. - 23.01.2027 10.559 € 11.115 €	23.01. - 30.01.2027 11.011 € 11.590 €
30.01. - 06.02.2027 11.467 € 12.070 €	06.02. - 13.02.2027 11.623 € 12.235 €	13.02. - 20.02.2027 12.203 € 12.845 €	20.02. - 27.02.2027 12.203 € 12.845 €
27.02. - 06.03.2027 12.203 € 12.845 €	06.03. - 13.03.2027 12.203 € 12.845 €	13.03. - 20.03.2027 10.987 € 11.565 €	20.03. - 27.03.2027 10.987 € 11.565 €
27.03. - 03.04.2027 10.987 € 11.565 €	03.04. - 10.04.2027 10.987 € 11.565 €	10.04. - 17.04.2027 12.203 € 12.845 €	17.04. - 24.04.2027 12.203 € 12.845 €
24.04. - 01.05.2027 9.980 € 10.505 €	01.05. - 08.05.2027 8.412 € 8.855 €	08.05. - 15.05.2027 8.412 € 8.855 €	15.05. - 22.05.2027 8.412 € 8.855 €
22.05. - 29.05.2027 8.412 € 8.855 €	29.05. - 05.06.2027 8.412 € 8.855 €	05.06. - 12.06.2027 8.412 € 8.855 €	12.06. - 19.06.2027 8.412 € 8.855 €
19.06. - 26.06.2027 8.412 € 8.855 €	26.06. - 03.07.2027 8.412 € 8.855 €	03.07. - 10.07.2027 9.904 € 10.425 €	10.07. - 17.07.2027 9.904 € 10.425 €
17.07. - 24.07.2027 9.904 € 10.425 €	24.07. - 31.07.2027 9.904 € 10.425 €	31.07. - 07.08.2027 8.422 € 8.865 €	07.08. - 14.08.2027 6.270 € 6.600 €
14.08. - 21.08.2027 6.270 € 6.600 €	21.08. - 28.08.2027 5.643 € 5.940 €	28.08. - 04.09.2027 5.643 € 5.940 €	



WEBSITE
www.plujeme.cz



E-MAIL
info@plujeme.cz



PHONE
+420 720 755 085



MOBILE
+420 777 170 276



PLUJEME RÁDI S.R.O.
Dlouhá 730/35, 11000 Praha 1 – Staré Město, Czech Republic

PRICE AND AVAILABILITY

04.09. - 11.09.2027 5.643 € 5.940 €	11.09. - 18.09.2027 5.643 € 5.940 €	18.09. - 25.09.2027 5.643 € 5.940 €	25.09. - 02.10.2027 5.643 € 5.940 €
02.10. - 09.10.2027 5.643 € 5.940 €	09.10. - 16.10.2027 5.643 € 5.940 €	16.10. - 23.10.2027 5.643 € 5.940 €	23.10. - 30.10.2027 6.631 € 6.980 €
30.10. - 06.11.2027 7.301 € 7.685 €	06.11. - 13.11.2027 8.227 € 8.660 €	13.11. - 20.11.2027 8.227 € 8.660 €	20.11. - 27.11.2027 8.227 € 8.660 €
27.11. - 04.12.2027 8.251 € 8.685 €	04.12. - 11.12.2027 7.614 € 8.015 €	11.12. - 18.12.2027 7.614 € 8.015 €	18.12. - 25.12.2027 12.545 € 13.205 €



WEBSITE

www.plujeme.cz



E-MAIL

info@plujeme.cz



PHONE

+420 720 755 085



MOBILE

+420 777 170 276



PLUJEME RÁDI S.R.O.

Dlouhá 730/35, 11000 Praha 1 – Staré Město, Czech Republic