

BALI 4.6

APRES SAIL II (2025)

Catamaran Bali 4.6 APRES SAIL II, built in 2025 is anchored in the **Belize, Placencia, Roberts Grove Marina, Belize, Belize**. It has **5 + 2 cabins**, can accommodate **10 + 2 people** and has **4 toilets**. Bed linen and kitchen equipment are included in the price.

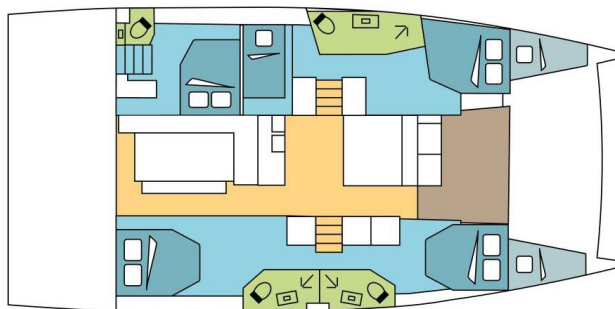

YACHT SPECIFICATIONS

Yacht Base

Belize, Placencia, Roberts Grove Marina, Belize

Yacht ID

12237

Brands

Catana

Yacht name

APRES SAIL II

Production year

2025

Length

47 ft

Cabins

5 + 2

Berths

10 + 2

Max Persons

12

WC

4

Engine

2 x 57 HP

Fuel tank

800 l



WEBSITE

www.plujeme.cz



PHONE

+420 720 755 085



MOBILE

+420 777 170 276



E-MAIL

info@plujeme.cz



PLUJEME RÁDI S.R.O.

Dlouhá 730/35, 11000 Praha 1 – Staré Město, Czech Republic

STANDARD YACHT EQUIPMENT

| | |
|-----------------|---|
| Comfort | Cockpit seat cushions with backrest, Mosquito nets, Sun loungers |
| Deck | Bimini top, Cockpit table, Cockpit/stern, outside shower, Davit, Electric anchor windlass, Flybridge, Forward cockpit, Grill/Barbecue/Plancha, Remote control for anchor winch with chain counter at helm, Swimming ladder |
| Entertainment | Fusion radio |
| Galley | Freezer, Oven |
| Interior | Electric fans, Electric toilet |
| Navigation | AIS, Autopilot, GPS chart plotter, Log, Speed, Depth- echo sounder, Wind instrument/Anemometer |
| Safety | VHF radio |
| Sails | Electric main sail winch, Lazy bag, Lazy jacks |
| Yacht electrics | Air Conditioning, Battery charger, Generator, Inverter, Service batteries, Solar panels, Watermaker - desalinator |



WEBSITE

www.plujeme.cz



E-MAIL

info@plujeme.cz



PHONE

+420 720 755 085



MOBILE

+420 777 170 276



PLUJEME RÁDI S.R.O.

Dlouhá 730/35, 11000 Praha 1 – Staré Město, Czech Republic

SERVICES

| SELECTED SERVICES | OBLIGATORY | PAYMENT TYPE | PRICE |
|---|------------|--------------|-----------------|
| Belize Taxes (Payable now) Season: 2026 Exotic. | Yes | per booking | 0,00 € |
| Essentials pack (Payable now) Season: 2026 Exotic. INCLUDED: Damage waiver (covering damages) with reduced security deposit addressed specifically to blocked toilets, unpaid fuel, lost equipment, unpaid fees & fines, and returning the boat in an extremely dirty state. // starter pack – (1 gallon water or 4 bottles of 1.5L, 1 bottle of disinfectant, 1 small bottle of washing up liquid, 1 dish cloth, 1 sponge, garbage bags, 1 roll of paper towels, 1 box of matches, 1 roll of toilet paper in each head) // final cleaning // 1 set of bed sheets & towels, dinghy, outboard engine & initial supply of fuel, gas and water tanks // DYC assistance guarantee // 1st & last night in the marina /// NOT INCLUDED: refuelling, gas & water consumption at end of charter, taxes if any, handling fees & additional equipment deposit. | Yes | per booking | 945,00 € |
| Handling fees (Payable now) Season: 2026 Exotic. | Yes | per booking | 35,00 € |
| Preparation fee (Payable now) Season: 2026 Exotic. INCLUDED: starter pack – (1 gallon water or 4 bottles of 1.5L, 1 bottle of disinfectant, 1 small bottle of washing up liquid, 1 dish cloth, 1 sponge, garbage bags, 1 roll of paper towels, 1 box of matches, 1 roll of toilet paper in each head) // final cleaning // 1 set of bed sheets / cabin & 1 set of towels / pax, dinghy, outboard engine & initial supply of fuel, gas and water tanks // DYC assistance guarantee // 1st & last night in the marina // NOT INCLUDED: refuelling, gas & water consumption at end of charter, taxes if any, handling fees & additional equipment deposit. | Yes | per booking | 450,00 € |
| Temporary Belize Skipper Certificate fee (Payable now) Season: 2026 Exotic. + provisioning, a cabin or forepeak to sleep and access to a WC/Shower | Yes | per booking | 17,00 € |
| Crew change (Payable now) Season: 2026 Exotic. Any crew change during the charter is subject to € 250.- additional cost. The charge includes administration cost, change of bed linen and towels and one night at DYC ponton (marina fee included only if the same base than start base). It doesn't include cleaning, nor new transit log where applicable. | No | per booking | 250,00 € |

| | | | |
|---|----|---------------|-----------------|
| Damage waiver (Payable now) | No | per night | 85,00 € |
| Season: 2026 Exotic. Damage waiver limits your liability to the reduced Security Deposit . Mandatory when skipper is added. Price is per night of the charter (minimum value of 7 nights & a maximum value of 21 nights) Not applicable for 4+ weeks charters , nor Regattas/Races. | | | |
| Early boarding/check-in (Payable now) | No | per booking | 480,00 € |
| Season: 2026 Exotic. EB (boat only) - 14:00 h / 2 PM starting time of boat's delivery // limited number of early boardings on same departure day | | | |
| Early boarding/check-in (Payable now) | No | per booking | 620,00 € |
| Season: 2026 Exotic. EB boat + extra fee skipper - 14:00 h / 2 PM starting time of boat's delivery // limited number of early boardings on same departure day | | | |
| Early boarding/check-in (Payable now) | No | per booking | 730,00 € |
| Season: 2026 Exotic. EB + extra fee Skipper & Hostes - 14:00 h / 2 PM starting time of boat's delivery // limited number of early boardings on same departure day | | | |
| Electric & Water consumption in the Marinas (Payable at the base) | No | per booking | 36,00 € |
| Season: 2026 Exotic. Electric & Water consumption based on 2 nights on our dock (base will confirm the amount to pay locally depending on nights spent on dock) | | | |
| Extra cleaning (Payable now) | No | per booking | 340,00 € |
| Season: 2026 Exotic. Optional Additional cleaning | | | |
| Extra set of linen (choose how many) (Payable now) | No | per booking | 15,00 € |
| Season: 2026 Exotic. Extra set of linen : 15 € 1 set of linen (2 sheets & 2 pillow case) - to be updated manually | | | |
| Extra set of towels (choose how many) (Payable now) | No | per booking | 10,00 € |
| Season: 2026 Exotic. Extra set of towels: 10 € 1 set of towels (1 face & 1 bath towel) - to be updated manually | | | |
| Final cleaning (Payable now) | No | per booking | 340,00 € |
| Season: 2026 Exotic. included in Essentials pack | | | |
| Final cleaning (Payable now) | No | per booking | 340,00 € |
| Season: 2026 Exotic. included in Essentials pack | | | |
| Full board 1-4 pax (number of guests to update manually) (Payable now) | No | per guest/day | 65,00 € |
| Season: 2026 Exotic. only available if cook is booked on board as the cook will do the provisioning based on client's preference. Includes breakfast, lunch & dinner + the crew's food. Does not included alcoholic drinks | | | |

| | | | |
|--|----|---------------|-----------------|
| <p>Full board 5-12 pax (number of guests to update manually) (Payable now)</p> <p>Season: 2026 Exotic. only available if cook is booked on board as the cook will do the provisioning based on client's preference. Includes breakfast, lunch & dinner + the crew's food. Does not included alcoholic drinks</p> | No | per guest/day | 60,00 € |
| <p>Hostess/Cook (Payable now)</p> <p>Season: 2026 Exotic. + provisioning, Crew on board must have their own toilets/ showers. If either a skipper or a hostess/cook is on board, 1 double cabin will be required for him/her. If both a skipper and a hostess/cook are on board, 1 double cabin and 1 forepeak cabin will be required for them. Exceptions exists for specific layouts, Sales Agents will provide more details about the different boat models</p> | No | per night | 110,00 € |
| <p>Hostess/Cook (Payable now)</p> <p>Season: 2026 Exotic. + provisioning, Crew on board must have their own toilets/ showers. If either a skipper or a hostess/cook is on board, 1 double cabin will be required for him/her. If both a skipper and a hostess/cook are on board, 1 double cabin and 1 forepeak cabin will be required for them. Exceptions exists for specific layouts, Sales Agents will provide more details about the different boat models</p> | No | per night | 110,00 € |
| <p>Hostess/Cook (Payable now)</p> <p>Season: 2026 Exotic. + provisioning, Crew on board must have their own toilets/ showers. If either a skipper or a hostess/cook is on board, 1 double cabin will be required for him/her. If both a skipper and a hostess/cook are on board, 1 double cabin and 1 forepeak cabin will be required for them. Exceptions exists for specific layouts, Sales Agents will provide more details about the different boat models</p> | No | per night | 120,00 € |
| <p>Regatta surcharge (Payable now)</p> <p>Season: 2026 Exotic. all the regattas apart of ASW (different regatta surcharge for ASW) // A special race deposit need to be doubled manually once the regatta surcharge is added.</p> | No | per booking | 0,00 € |
| <p>Same day briefing (Payable now)</p> <p>Season: 2026 Exotic. Same day briefing starting between 5 & 5.30pm (departure following morning)</p> | No | per booking | 150,00 € |
| <p>Skipper (Payable now)</p> <p>Season: 2026 Exotic. + provisioning, Crew on board must have their own toilets/ showers. If either a skipper or a hostess/cook is on board, 1 double cabin will be required for him/her. If both a skipper and a hostess/cook are on board, 1 double cabin and 1 forepeak cabin will be required for them. Exceptions exists for specific layouts, Sales Agents will provide more details about the different boat models</p> | No | per night | 140,00 € |

| | | | |
|---|----|-------------|-----------------|
| <p>Skipper (Payable now)</p> <p>Season: 2026 Exotic. + provisioning, Crew on board must have their own toilets/ showers. If either a skipper or a hostess/cook is on board, 1 double cabin will be required for him/her. If both a skipper and a hostess/cook are on board, 1 double cabin and 1 forepeak cabin will be required for them. Exceptions exists for specific layouts, Sales Agents will provide more details about the different boat models</p> | No | per night | 140,00 € |
| <p>Skipper (Payable now)</p> <p>Season: 2026 Exotic. + provisioning, Crew on board must have their own toilets/ showers. If either a skipper or a hostess/cook is on board, 1 double cabin will be required for him/her. If both a skipper and a hostess/cook are on board, 1 double cabin and 1 forepeak cabin will be required for them. Exceptions exists for specific layouts, Sales Agents will provide more details about the different boat models</p> | No | per night | 155,00 € |
| <p>Starter pack (Payable now)</p> <p>Season: 2026 Exotic. included in Essentials pack (The pack includes: 1 gallon water (or 4 bottles of 1.5L), 1 bottle of disinfectant, 1 small bottle of washing up liquid, 1 dish cloth, 1 sponge, garbage bags, 1 roll of paper towels, 1 box of matches, 1 roll of toilet paper in each head</p> | No | per booking | 50,00 € |
| <p>Transfer (Payable now)</p> <p>Season: 2026 Exotic. OW - Placencia airport/base/airport + additional per pax</p> | No | one-way | 7,00 € |
| <p>Transfer (Payable now)</p> <p>Season: 2026 Exotic. OW - 1 - 2 pax from/to airport Placencia - base</p> | No | one-way | 16,00 € |
| <p>Transfer (Payable now)</p> <p>Season: 2026 Exotic. OW - Belize City airport/base/airport - additional per pax</p> | No | one-way | 86,00 € |
| <p>Transfer (Payable now)</p> <p>Season: 2026 Exotic. OW - 1 - 5 pax from/to airport Belize City - base</p> | No | one-way | 555,00 € |



WEBSITE
www.plujeme.cz



PHONE
+420 720 755 085



MOBILE
+420 777 170 276



E-MAIL
info@plujeme.cz



PLUJEME RÁDI S.R.O.
Dlouhá 730/35, 11000 Praha 1 - Staré Město, Czech Republic

ADDITIONAL EXTRAS

| EXTRA | OBLIGATORY | PAYMENT TYPE | PRICE |
|--|------------|--------------|-----------------|
| Fishing equipment (Payable now) Season: 2026 Exotic. Additional deposit 100 EUR (subject to availability) - Payable now | No | per day | 15,00 € |
| Kayak single (Payable now) Season: 2026 Exotic. price per day - Payable now | No | per night | 15,00 € |
| Kayak tandem (Payable now) Season: 2026 Exotic. price per day - Payable now | No | per night | 15,00 € |
| Outboard engine 8 & 9,8 HP (Payable now) Season: 2026 Exotic. Dinghy not suitable in any case for waterski or wakeboard. Additional security deposit of 500 € - Payable now | No | per day | 35,00 € |
| Railing net (Safety net) (Payable now) Season: 2026 Exotic. net is supplied but not installed - Payable now | No | per booking | 300,00 € |
| Stand up paddle (SUP) (Payable now) Season: 2026 Exotic. Price per day - Payable now | No | per night | 15,00 € |

**WEBSITE**www.plujeme.cz**E-MAIL**info@plujeme.cz**PHONE**

+420 720 755 085

**MOBILE**

+420 777 170 276

**PLUJEME RÁDI S.R.O.**

Dlouhá 730/35, 11000 Praha 1 – Staré Město, Czech Republic

PRICE AND AVAILABILITY

| | | | |
|--|--|--------------------------------------|--|
| 25.04. - 09.05.2026 NOT AVAILABLE | 09.05. - 16.05.2026 5.320 € 6.650 € | 16.05. - 30.05.2026 NOT AVAILABLE | 30.05. - 06.06.2026 NOT AVAILABLE |
| 06.06. - 14.06.2026 NOT AVAILABLE | 20.06. - 27.06.2026 NOT AVAILABLE | 28.06. - 05.07.2026 NOT AVAILABLE | 11.07. - 18.07.2026 4.376 € 5.470 € |
| 18.07. - 25.07.2026 4.132 € 5.165 € | 25.07. - 01.08.2026 NOT AVAILABLE | 03.08. - 09.08.2026 NOT AVAILABLE | 15.08. - 22.08.2026 NOT AVAILABLE |



WEBSITE

www.plujeme.cz



E-MAIL

info@plujeme.cz



PHONE

+420 720 755 085



MOBILE

+420 777 170 276



PLUJEME RÁDI S.R.O.

Dlouhá 730/35, 11000 Praha 1 – Staré Město, Czech Republic

PRICE AND AVAILABILITY

27.12. - 10.01.2027

NOT AVAILABLE

06.02. - 13.02.2027

NOT AVAILABLE



WEBSITE

www.plujeme.cz



E-MAIL

info@plujeme.cz



PHONE

+420 720 755 085



MOBILE

+420 777 170 276



PLUJEME RÁDI S.R.O.

Dlouhá 730/35, 11000 Praha 1 – Staré Město, Czech Republic