

# BALI 4.6

AMARE (2023)

Catamaran Bali 4.6 AMARE, built in 2023 is anchored in the Cote D'Azur, Port Pin Rolland, Provence-Alpes-Côte d'Azur, France. It has 5 + 1 cabins, can accommodate 10 + 1 people and has 4 + 1 toilets. Bed linen and kitchen equipment are included in the price.

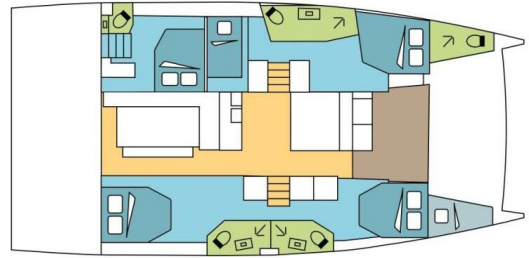

## YACHT SPECIFICATIONS

Yacht Base

**Cote D'Azur, Port Pin Rolland, France**

Yacht ID

**12190**

Brands

**Catana**

Yacht name

**AMARE**

Production year

**2023**

Length

**47 ft**

Cabins

**5 + 1**

Berths

**10 + 1**

Max Persons

**11**

WC

**4 + 1**

Engine

**2 x 57 HP**

Fuel tank

**800 l**



**WEBSITE**

[www.plujeme.cz](http://www.plujeme.cz)



**PHONE**

+420 720 755 085



**MOBILE**

+420 777 170 276



**E-MAIL**

[info@plujeme.cz](mailto:info@plujeme.cz)



**PLUJEME RÁDI S.R.O.**

Dlouhá 730/35, 11000 Praha 1 – Staré Město, Czech Republic

## STANDARD YACHT EQUIPMENT

Deck	<b>Cockpit table, Cockpit/stern, outside shower, Davit, Dinghy, Electric anchor windlass, Outboard engine, Swimming ladder</b>
Entertainment	<b>Radio</b>
Galley	<b>Kitchen utensils (Galley equipment, cutlery), Oven, Refrigerator, Stove</b>
Interior	<b>Electric fans in cabins, Electric toilet</b>
Navigation	<b>Autopilot, GPS chart plotter, Wind/speed/depth instruments</b>
Safety	<b>VHF radio</b>
Sails	<b>Electric main sail winch, Lazy bag, Lazy jacks</b>
Yacht electrics	<b>Air Conditioning, Battery charger, Generator, Inverter, Solar panels, Watermaker - desalinator</b>



#### WEBSITE

[www.plujeme.cz](http://www.plujeme.cz)



#### E-MAIL

[info@plujeme.cz](mailto:info@plujeme.cz)



#### PHONE

+420 720 755 085



#### MOBILE

+420 777 170 276



#### PLUJEME RÁDI S.R.O.

Dlouhá 730/35, 11000 Praha 1 – Staré Město, Czech Republic

## SERVICES

SELECTED SERVICES	OBLIGATORY	PAYMENT TYPE	PRICE
<b>Handling fees</b> (Payable now) <b>Season: 2026.</b>	Yes	per booking	<b>25,00 €</b>
<b>Preparation fee</b> (Payable now) <b>Season: 2026.</b> INCLUDED: starter pack – (1 gallon water or 4 bottles of 1.5L, 1 bottle of disinfectant, 1 small bottle of washing up liquid, 1 dish cloth, 1 sponge, garbage bags, 1 roll of paper towels, 1 box of matches, 1 roll of toilet paper in each head) // final cleaning // 1 set of bed sheets / cabin & 1 set of towels / pax, dinghy, outboard engine & initial supply of fuel, gas and water tanks // DYC assistance guarantee // 1st & last night in the marina // NOT INCLUDED: refuelling, gas & water consumption at end of charter, taxes if any, handling fees & additional equipment deposit.	Yes	per booking	<b>415,00 €</b>
<b>Crew change</b> (Payable now) <b>Season: 2026.</b> Any crew change during the charter is subject to € 250.- additional cost. The charge includes administration cost, change of bed linen and towels and one night at DYC ponton (marina fee included only if the same base than start base). It doesn't include cleaning, nor new transit log where applicable.	No	per booking	<b>250,00 €</b>
<b>Damage waiver</b> (Payable now) <b>Season: 2026.</b> Damage waiver limits your liability to the reduced Security Deposit . Mandatory when skipper is added. Price is per night of the charter ( minimum value of 7 nights & a maximum value of 21 nights) . Not applicable for 4+ weeks charters , nor Regattas/Races.	No	per night	<b>60,00 €</b>
<b>Early boarding/check-in</b> (Payable now) <b>Season: 2026.</b> EB (boat only) - 13:00h, starting time of boat's delivery // limited number of early boardings on same departure day	No	per booking	<b>360,00 €</b>
<b>Early boarding/check-in</b> (Payable now) <b>Season: 2026.</b> EB + extra fee skipper - 13:00h, starting time of boat's delivery // limited number of early boardings on same departure day	No	per booking	<b>490,00 €</b>
<b>Early boarding/check-in</b> (Payable now) <b>Season: 2026.</b> EB + extra fee Skipper & Hostess - 13:00h, starting time of boat's delivery // limited number of early boardings on same departure day	No	per booking	<b>590,00 €</b>

<b>Electric &amp; Water consumption in the Marinas</b> (Payable at the base)	No	per booking	<b>36,00 €</b>
<b>Season: 2026.</b> Electric & Water consumption based on 2 nights on our dock (base will confirm the amount to pay locally depending on nights spent on dock)			
<b>Extra cleaning</b> (Payable now)	No	per booking	<b>340,00 €</b>
<b>Season: 2026.</b> Optional Additional cleaning			
<b>Extra set of linen (choose how many)</b> (Payable now)	No	per booking	<b>15,00 €</b>
<b>Season: 2026.</b> Extra set of linen : 15 € 1 extra set of linen (2 sheets & 2 pillow case) - to be updated manually			
<b>Extra set of towels (choose how many)</b> (Payable now)	No	per booking	<b>10,00 €</b>
<b>Season: 2026.</b> Extra set of towels: 10 € 1 extra set of towels (1 face & 1 bath towel) - to be updated manually			
<b>Full board 1-4 pax (number of guests to update manually)</b> (Payable now)	No	per guest/day	<b>60,00 €</b>
<b>Season: 2026.</b> only available if cook is booked on board as the cook will do the provisioning based on client's preference. Includes breakfast, lunch & dinner + the crew's food. Does not included alcoholic drinks			
<b>Full board 5-12 pax (number of guests to update manually)</b> (Payable now)	No	per guest/day	<b>55,00 €</b>
<b>Season: 2026.</b> only available if cook is booked on board as the cook will do the provisioning based on client's preference. Includes breakfast, lunch & dinner + the crew's food. Does not included alcoholic drinks			
<b>Half board 1-4 pax (number of guests to update manually)</b> (Payable now)	No	per guest/day	<b>50,00 €</b>
<b>Season: 2026.</b> only available if cook is booked on board as the cook will do the provisioning based on client's preference. Includes breakfast & lunch OR dinner + the crew's food. Does not included alcoholic drinks			
<b>Half board 5-12 pax (number of guests to update manually)</b> (Payable now)	No	per guest/day	<b>45,00 €</b>
<b>Season: 2026.</b> only available if cook is booked on board as the cook will do the provisioning based on client's preference. Includes breakfast & lunch OR dinner + the crew's food. Does not included alcoholic drinks			
<b>Hostess/Cook</b> (Payable now)	No	per night	<b>200,00 €</b>
<b>Season: 2026.</b> + provisioning, Crew on board must have their own toilets/showers. If either a skipper or a hostess/cook is on board, 1 double cabin will be required for him/her. If both a skipper and a hostess/cook are on board, 1 double cabin and 1 forepeak cabin will be required for them. Exceptions exists for specific layouts, Sales Agents will provide more details about the different boat models			

<p><b>Hostess/Cook</b> (Payable now)</p> <p><b>Season: 2026.</b> + provisioning, Crew on board must have their own toilets/showers. If either a skipper or a hostess/cook is on board, 1 double cabin will be required for him/her. If both a skipper and a hostess/cook are on board, 1 double cabin and 1 forepeak cabin will be required for them. Exceptions exists for specific layouts, Sales Agents will provide more details about the different boat models</p>	No	per night	<b>200,00 €</b>
<p><b>Hostess/Cook</b> (Payable now)</p> <p><b>Season: 2026.</b> + provisioning, Crew on board must have their own toilets/showers. If either a skipper or a hostess/cook is on board, 1 double cabin will be required for him/her. If both a skipper and a hostess/cook are on board, 1 double cabin and 1 forepeak cabin will be required for them. Exceptions exists for specific layouts, Sales Agents will provide more details about the different boat models</p>	No	per night	<b>220,00 €</b>
<p><b>Regatta surcharge</b> (Payable now)</p> <p><b>Season: 2026.</b> A special race deposit need to be doubled manually once the regatta surcharge is added.</p>	No	per booking	<b>0,00 €</b>
<p><b>Skipper</b> (Payable now)</p> <p><b>Season: 2026.</b> + provisioning, Crew on board must have their own toilets/showers. If either a skipper or a hostess/cook is on board, 1 double cabin will be required for him/her. If both a skipper and a hostess/cook are on board, 1 double cabin and 1 forepeak cabin will be required for them. Exceptions exists for specific layouts, Sales Agents will provide more details about the different boat models</p>	No	per night	<b>270,00 €</b>
<p><b>Skipper</b> (Payable now)</p> <p><b>Season: 2026.</b> + provisioning, Crew on board must have their own toilets/showers. If either a skipper or a hostess/cook is on board, 1 double cabin will be required for him/her. If both a skipper and a hostess/cook are on board, 1 double cabin and 1 forepeak cabin will be required for them. Exceptions exists for specific layouts, Sales Agents will provide more details about the different boat models</p>	No	per night	<b>270,00 €</b>
<p><b>Skipper</b> (Payable now)</p> <p><b>Season: 2026.</b> + provisioning, Crew on board must have their own toilets/showers. If either a skipper or a hostess/cook is on board, 1 double cabin will be required for him/her. If both a skipper and a hostess/cook are on board, 1 double cabin and 1 forepeak cabin will be required for them. Exceptions exists for specific layouts, Sales Agents will provide more details about the different boat models</p>	No	per night	<b>300,00 €</b>

<b>Transfer</b> (Payable now)	No	one-way	<b>52,00 €</b>
<b>Season: 2026.</b> OW - 1-4pax ,Day rate ,Train station SNCF of Toulon from/to Port Pin Rolland base			
<b>Transfer</b> (Payable now)	No	one-way	<b>52,00 €</b>
<b>Season: 2026.</b> OW - 1-4pax ,Day rate , Ferry terminal of Toulon from/to Port Pin Rolland base			
<b>Transfer</b> (Payable now)	No	one-way	<b>65,00 €</b>
<b>Season: 2026.</b> OW - 5-7 pax ,Day rate , Train station SNCF of Toulon from/to Port Pin Rolland			
<b>Transfer</b> (Payable now)	No	one-way	<b>65,00 €</b>
<b>Season: 2026.</b> OW - 1-4pax ,Night rate(19:00 – 07:00) Train station SNCF of Toulon from/to Port Pin Rolland			
<b>Transfer</b> (Payable now)	No	one-way	<b>65,00 €</b>
<b>Season: 2026.</b> OW - 5-7 pax ,Day rate, Ferry terminal of Toulon from/to Port Pin Rolland base			
<b>Transfer</b> (Payable now)	No	one-way	<b>65,00 €</b>
<b>Season: 2026.</b> OW - 1-4pax ,Night rate(19:00-07:00) ,Ferry terminal of Toulon from/to Port Pin Rolland			
<b>Transfer</b> (Payable now)	No	one-way	<b>78,00 €</b>
<b>Season: 2026.</b> OW -5-7pax ,Holidays,Sundays,Night rate(19:00-07:00), Train station SNCF of Toulon from/to Port Pin Rolland			
<b>Transfer</b> (Payable now)	No	one-way	<b>78,00 €</b>
<b>Season: 2026.</b> OW-5-7pax ,Bank Holidays,Sundays,Night rate(19:00-07:00), Ferry terminal of Toulon from/to Port Pin Rolland base			
<b>Transfer</b> (Payable now)	No	one-way	<b>247,00 €</b>
<b>Season: 2026.</b> OW - 1-4pax ,Day rate ,Airport Marseille from/to Port Pin Rolland			
<b>Transfer</b> (Payable now)	No	one-way	<b>270,00 €</b>
<b>Season: 2026.</b> OW - 1-4pax ,Night rate(19:00 – 07:00) , Airport Marseille from/to Port Pin Rolland base			
<b>Transfer</b> (Payable now)	No	one-way	<b>290,00 €</b>
<b>Season: 2026.</b> OW - 5-7 pax ,Day rate , Airport Marseille from/to Port Pin Rolland			

**Transfer** (Payable now)

No

one-way

**340,00 €**

**Season: 2026.** 0W -5-7pax, Holidays ,Sundays, Night rate(19:00-07:00),

Airport Marseille from/to Port Pin Rolland base



**WEBSITE**

[www.plujeme.cz](http://www.plujeme.cz)



**E-MAIL**

[info@plujeme.cz](mailto:info@plujeme.cz)



**PHONE**

+420 720 755 085



**PLUJEME RÁDI S.R.O.**

Dlouhá 730/35, 11000 Praha 1 – Staré Město, Czech Republic



**MOBILE**

+420 777 170 276

## ADDITIONAL EXTRAS

EXTRA	OBLIGATORY	PAYMENT TYPE	PRICE
<b>Kayak single</b> (Payable now) <b>Season: 2026.</b> Price per day - Payable now	No	per night	<b>15,00 €</b>
<b>Outboard engine 8 &amp; 9,8 HP</b> (Payable now) <b>Season: 2026.</b> Subject to Availability ; 8 & 9.8hp. Dinghy not suitable in any case for waterski or wakeboard. "a powerboat licence is mandatory in French territories to drive a dinghy with an outboard more powerful than 6hp. It's client responsibility to ensure to have the right powerboat licence when renting a more powerful outboard. In case the needed licence is not presented at base, it will not be possible to use this larger outboard which will not be refunded" - Payable now	No	per day	<b>35,00 €</b>
<b>Railing net (Safety net)</b> (Payable now) <b>Season: 2026.</b> net is supplied but not installed - Payable now	No	per booking	<b>300,00 €</b>
<b>Stand up paddle (SUP)</b> (Payable now) <b>Season: 2026.</b> Price per day - Payable now	No	per night	<b>15,00 €</b>



**WEBSITE**

[www.plujeme.cz](http://www.plujeme.cz)



**PHONE**

+420 720 755 085



**MOBILE**

+420 777 170 276



**E-MAIL**

[info@plujeme.cz](mailto:info@plujeme.cz)



**PLUJEME RÁDI S.R.O.**

Dlouhá 730/35, 11000 Praha 1 – Staré Město, Czech Republic

## PRICE AND AVAILABILITY

25.04. - 02.05.2026 NOT AVAILABLE	02.05. - 09.05.2026 NOT AVAILABLE	09.05. - 16.05.2026 3.300 € 4.485 €	16.05. - 30.05.2026 NOT AVAILABLE
30.05. - 13.06.2026 NOT AVAILABLE	13.06. - 20.06.2026 7.805 €	20.06. - 27.06.2026 NOT AVAILABLE	27.06. - 04.07.2026 NOT AVAILABLE
04.07. - 11.07.2026 9.435 €	11.07. - 18.07.2026 NOT AVAILABLE	18.07. - 25.07.2026 NOT AVAILABLE	25.07. - 01.08.2026 NOT AVAILABLE
01.08. - 08.08.2026 13.745 €	08.08. - 15.08.2026 12.465 €	15.08. - 22.08.2026 12.055 €	22.08. - 29.08.2026 NOT AVAILABLE
29.08. - 19.09.2026 NOT AVAILABLE	19.09. - 26.09.2026 6.915 €	26.09. - 03.10.2026 NOT AVAILABLE	03.10. - 10.10.2026 NOT AVAILABLE
10.10. - 17.10.2026 4.070 €	17.10. - 24.10.2026 3.965 €	24.10. - 31.10.2026 NOT AVAILABLE	31.10. - 07.11.2026 3.021 € 3.180 €
07.11. - 14.11.2026 3.021 € 3.180 €	20.11. - 12.03.2027 NOT AVAILABLE		



WEBSITE

[www.plujeme.cz](http://www.plujeme.cz)



E-MAIL

[info@plujeme.cz](mailto:info@plujeme.cz)



PHONE

+420 720 755 085



MOBILE

+420 777 170 276



PLUJEME RÁDI S.R.O.

Dlouhá 730/35, 11000 Praha 1 – Staré Město, Czech Republic

## PRICE AND AVAILABILITY

<b>13.03. - 20.03.2027</b> <b>3.021 €</b> 3.180 €	<b>20.03. - 27.03.2027</b> <b>3.472 €</b> 3.655 €	<b>27.03. - 03.04.2027</b> <b>3.472 €</b> 3.655 €	<b>03.04. - 10.04.2027</b> <b>3.472 €</b> 3.655 €
<b>10.04. - 17.04.2027</b> <b>3.472 €</b> 3.655 €	<b>17.04. - 24.04.2027</b> <b>3.472 €</b> 3.655 €	<b>24.04. - 01.05.2027</b> <b>4.669 €</b> 4.915 €	<b>01.05. - 08.05.2027</b> <b>4.669 €</b> 4.915 €
<b>08.05. - 15.05.2027</b> <b>5.092 €</b> 5.360 €	<b>15.05. - 22.05.2027</b> <b>5.092 €</b> 5.360 €	<b>22.05. - 29.05.2027</b> <b>5.600 €</b> 5.895 €	<b>29.05. - 05.06.2027</b> <b>7.776 €</b> 8.185 €
<b>05.06. - 12.06.2027</b> NOT AVAILABLE	<b>12.06. - 19.06.2027</b> <b>9.581 €</b> 10.085 €	<b>19.06. - 26.06.2027</b> <b>9.581 €</b> 10.085 €	<b>26.06. - 03.07.2027</b> <b>9.581 €</b> 10.085 €
<b>03.07. - 10.07.2027</b> <b>11.068 €</b> 11.650 €	<b>10.07. - 17.07.2027</b> <b>12.070 €</b> 12.705 €	<b>17.07. - 24.07.2027</b> <b>12.070 €</b> 12.705 €	<b>24.07. - 31.07.2027</b> <b>13.243 €</b> 13.940 €
<b>31.07. - 07.08.2027</b> <b>14.621 €</b> 15.390 €			



**WEBSITE**  
www.plujeme.cz



**E-MAIL**  
info@plujeme.cz



**PHONE**  
+420 720 755 085



**PLUJEME RÁDI S.R.O.**  
Dlouhá 730/35, 11000 Praha 1 – Staré Město, Czech Republic



**MOBILE**  
+420 777 170 276

## PRICE AND AVAILABILITY

07.08. - 14.08.2027 <b>14.559 €</b> 15.325 €	14.08. - 21.08.2027 <b>13.243 €</b> 13.940 €	21.08. - 28.08.2027 <b>9.795 €</b> 10.310 €	28.08. - 04.09.2027 <b>9.852 €</b> 10.370 €
04.09. - 11.09.2027 <b>8.617 €</b> 9.070 €	11.09. - 18.09.2027 <b>8.023 €</b> 8.445 €	18.09. - 25.09.2027 <b>7.139 €</b> 7.515 €	25.09. - 02.10.2027 <b>5.952 €</b> 6.265 €
02.10. - 09.10.2027 <b>4.864 €</b> 5.120 €	09.10. - 16.10.2027 <b>3.867 €</b> 4.070 €	16.10. - 23.10.2027 <b>3.463 €</b> 3.645 €	23.10. - 30.10.2027 <b>3.430 €</b> 3.610 €
30.10. - 06.11.2027 <b>3.325 €</b> 3.500 €	09.11. - 31.12.2098 NOT AVAILABLE		



### WEBSITE

[www.plujeme.cz](http://www.plujeme.cz)



### E-MAIL

[info@plujeme.cz](mailto:info@plujeme.cz)



### PHONE

+420 720 755 085



### MOBILE

+420 777 170 276



### PLUJEME RÁDI S.R.O.

Dlouhá 730/35, 11000 Praha 1 – Staré Město, Czech Republic