

DUFOUR 520 GL

ELESSAR (2020)

Sailing yacht Dufour 520 GL ELESSAR, built in 2020 is anchored in the **Lefkas, D-Marin, Ionian Islands, Greece**. It has **5 cabins**, can accommodate **10 + 2 people** and has **3 toilets**. Bed linen and kitchen equipment are included in the price.

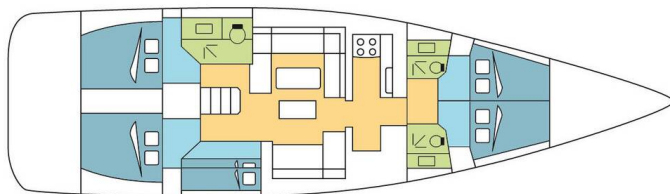

YACHT SPECIFICATIONS

Yacht Base

Lefkas, D-Marin, Greece

Yacht ID

12118

Brands

Dufour

Yacht name

ELESSAR

Production year

2020

Length

50 ft

Cabins

5

Berths

10 + 2

Max Persons

12

WC

3

Engine

1 x 75 HP

Fuel tank

440 l



WEBSITE

www.plujeme.cz



PHONE

+420 720 755 085



MOBILE

+420 777 170 276



E-MAIL

info@plujeme.cz



PLUJEME RÁDI S.R.O.

Dlouhá 730/35, 11000 Praha 1 – Staré Město, Czech Republic

STANDARD YACHT EQUIPMENT

Comfort	Cockpit cushions
Deck	Bathing platform, Bimini top, Cockpit fridge, Cockpit table, Cockpit/stern, outside shower, Dinghy, Electric anchor windlass, Grill/Barbecue/Plancha, Outboard engine, Sprayhood, Swimming ladder, Teak cockpit
Entertainment	Outdoor speakers, Radio CD mp3 player
Galley	Kitchen utensils (Galley equipment, cutlery), Oven, Refrigerator, Stove
Interior	Convertible table in salon
Navigation	Autopilot, Bow thruster, GPS chart plotter, Wind/speed/depth instruments
Safety	VHF radio
Sails	Lazy bag, Self tailing (manual) winch
Yacht electrics	220V socket, Inverter



WEBSITE

www.plujeme.cz



E-MAIL

info@plujeme.cz



PHONE

+420 720 755 085



MOBILE

+420 777 170 276



PLUJEME RÁDI S.R.O.

Dlouhá 730/35, 11000 Praha 1 – Staré Město, Czech Republic

SERVICES

SELECTED SERVICES	OBLIGATORY	PAYMENT TYPE	PRICE
Handling fees (Payable now) Season: 2026.	Yes	per booking	20,00 €
Preparation fee (Payable now) Season: 2026. INCLUDED: starter pack – (1 gallon water or 4 bottles of 1.5L, 1 bottle of disinfectant, 1 small bottle of washing up liquid, 1 dish cloth, 1 sponge, garbage bags, 1 roll of paper towels, 1 box of matches, 1 roll of toilet paper in each head) // final cleaning // 1 set of bed sheets / cabin & 1 set of towels / pax, dinghy, outboard engine & initial supply of fuel, gas and water tanks // DYC assistance guarantee // 1st & last night in the marina // NOT INCLUDED: refuelling, gas & water consumption at end of charter, taxes if any, handling fees & additional equipment deposit.	Yes	per booking	335,00 €
Crew change (Payable now) Season: 2026. Any crew change during the charter is subject to € 250.- additional cost. The charge includes administration cost, change of bed linen and towels and one night at DYC ponton (marina fee included only if the same base than start base). It doesn't include cleaning, nor new transit log where applicable.	No	per booking	250,00 €
Damage waiver (Payable now) Season: 2026. Damage waiver limits your liability to the reduced Security Deposit . Mandatory when skipper is added. Price is per night of the charter (minimum value of 7 nights & a maximum value of 21 nights). Not applicable for 4+ weeks charters , nor Regattas/Races.	No	per night	50,00 €
Early boarding/check-in (Payable now) Season: 2026. EB (boat only) - 13:00h, starting time of boat's delivery // limited number of early boardings on same departure day	No	per booking	300,00 €
Early boarding/check-in (Payable now) Season: 2026. EB + extra fee skipper - 13:00h, starting time of boat's delivery // limited number of early boardings on same departure day	No	per booking	405,00 €
Early boarding/check-in (Payable now) Season: 2026. EB + extra fee Skipper & Hostess - 13:00h, starting time of boat's delivery // limited number of early boardings on same departure day	No	per booking	503,00 €

Electric & Water consumption in the Marinas (Payable at the base)	No	per booking	28,00 €
Season: 2026. Electric & Water consumption based on 2 nights on our dock (base will confirm the amount to pay locally depending on nights spent on dock)			
Extra set of linen (choose how many) (Payable now)	No	per booking	15,00 €
Season: 2026. Extra set of linen : 15 € 1 extra set of linen (2 sheets & 2 pillow case) - to be updated manually			
Extra set of towels (choose how many) (Payable now)	No	per booking	10,00 €
Season: 2026. Extra set of towels: 10 € 1 extra set of towels (1 face & 1 bath towel) - to be updated manually			
Full board 1-4 pax (number of guests to update manually) (Payable now)	No	per guest/day	60,00 €
Season: 2026. only available if cook is booked on board as the cook will do the provisioning based on client's preference. Includes breakfast, lunch & dinner + the crew's food. Does not included alcoholic drinks			
Full board 5-12 pax (number of guests to update manually) (Payable now)	No	per guest/day	55,00 €
Season: 2026. only available if cook is booked on board as the cook will do the provisioning based on client's preference. Includes breakfast, lunch & dinner + the crew's food. Does not included alcoholic drinks			
Half board 1-4 pax (number of guests to update manually) (Payable now)	No	per guest/day	50,00 €
Season: 2026. only available if cook is booked on board as the cook will do the provisioning based on client's preference. Includes breakfast & lunch OR dinner + the crew's food. Does not included alcoholic drinks			
Half board 5-12 pax (number of guests to update manually) (Payable now)	No	per guest/day	45,00 €
Season: 2026. only available if cook is booked on board as the cook will do the provisioning based on client's preference. Includes breakfast & lunch OR dinner + the crew's food. Does not included alcoholic drinks			
Hostess/Cook (Payable now)	No	per night	195,00 €
Season: 2026. + provisioning, Crew on board must have their own toilets/showers. If either a skipper or a hostess/cook is on board, 1 double cabin will be required for him/her. If both a skipper and a hostess/cook are on board, 1 double cabin and 1 forepeak cabin will be required for them. Exceptions exists for specific layouts, Sales Agents will provide more details about the different boat models			

<p>Hostess/Cook (Payable now)</p> <p>Season: 2026. + provisioning, Crew on board must have their own toilets/showers. If either a skipper or a hostess/cook is on board, 1 double cabin will be required for him/her. If both a skipper and a hostess/cook are on board, 1 double cabin and 1 forepeak cabin will be required for them. Exceptions exists for specific layouts, Sales Agents will provide more details about the different boat models</p>	No	per night	195,00 €
<p>Hostess/Cook (Payable now)</p> <p>Season: 2026. + provisioning, Crew on board must have their own toilets/showers. If either a skipper or a hostess/cook is on board, 1 double cabin will be required for him/her. If both a skipper and a hostess/cook are on board, 1 double cabin and 1 forepeak cabin will be required for them. Exceptions exists for specific layouts, Sales Agents will provide more details about the different boat models</p>	No	per night	215,00 €
<p>Regatta surcharge (Payable now)</p> <p>Season: 2026. A special race deposit need to be doubled manually once the regatta surcharge is added.</p>	No	per booking	0,00 €
<p>Skipper (Payable now)</p> <p>Season: 2026. + provisioning, Crew on board must have their own toilets/showers. If either a skipper or a hostess/cook is on board, 1 double cabin will be required for him/her. If both a skipper and a hostess/cook are on board, 1 double cabin and 1 forepeak cabin will be required for them. Exceptions exists for specific layouts, Sales Agents will provide more details about the different boat models</p>	No	per night	210,00 €
<p>Skipper (Payable now)</p> <p>Season: 2026. + provisioning, Crew on board must have their own toilets/showers. If either a skipper or a hostess/cook is on board, 1 double cabin will be required for him/her. If both a skipper and a hostess/cook are on board, 1 double cabin and 1 forepeak cabin will be required for them. Exceptions exists for specific layouts, Sales Agents will provide more details about the different boat models</p>	No	per night	210,00 €
<p>Skipper (Payable now)</p> <p>Season: 2026. + provisioning, Crew on board must have their own toilets/showers. If either a skipper or a hostess/cook is on board, 1 double cabin will be required for him/her. If both a skipper and a hostess/cook are on board, 1 double cabin and 1 forepeak cabin will be required for them. Exceptions exists for specific layouts, Sales Agents will provide more details about the different boat models</p>	No	per night	230,00 €

Transfer (Payable now)	No	one-way / person	13,00 €
Season: 2026. OW - Base to Preveza's airport - additional person - For transfers during hours 21:00-06:00h and bank holidays price should be raised by 30€ one-way, or 60€ round trip			
Transfer (Payable now)	No	one-way	52,00 €
Season: 2026. OW - Preveza's airport/base 1 to 3 pax - For transfers during hours 21:00-06:00h and bank holidays price should be raised by 30€ one-way, or 60€ round trip			
WI-FI Internet connection on boat (Payable now)	No	per week	50,00 €
Season: 2026. unlimited data			



WEBSITE

www.plujeme.cz



E-MAIL

info@plujeme.cz



PHONE

+420 720 755 085



MOBILE

+420 777 170 276



PLUJEME RÁDI S.R.O.

Dlouhá 730/35, 11000 Praha 1 – Staré Město, Czech Republic

ADDITIONAL EXTRAS

EXTRA	OBLIGATORY	PAYMENT TYPE	PRICE
Railing net (Safety net) (Payable now) <i>Season: 2026. net is supplied but not installed - Payable now</i>	No	per booking	230,00 €
Stand up paddle (SUP) (Payable now) <i>Season: 2026. Price per day - Payable now</i>	No	per night	15,00 €

**WEBSITE**

www.plujeme.cz

**E-MAIL**

info@plujeme.cz

**PHONE**

+420 720 755 085

**MOBILE**

+420 777 170 276

**PLUJEME RÁDI S.R.O.**

Dlouhá 730/35, 11000 Praha 1 – Staré Město, Czech Republic

PRICE AND AVAILABILITY

25.04. - 02.05.2026 2.050 € 2.345 €	02.05. - 09.05.2026 2.050 € 2.420 €	09.05. - 16.05.2026 NOT AVAILABLE	16.05. - 23.05.2026 NOT AVAILABLE
23.05. - 30.05.2026 NOT AVAILABLE	30.05. - 13.06.2026 NOT AVAILABLE	13.06. - 20.06.2026 4.880 €	20.06. - 27.06.2026 NOT AVAILABLE
27.06. - 04.07.2026 4.713 € 5.545 €	04.07. - 11.07.2026 NOT AVAILABLE	11.07. - 18.07.2026 4.368 € 5.460 €	18.07. - 25.07.2026 4.648 € 5.810 €
25.07. - 01.08.2026 5.088 € 6.360 €	01.08. - 08.08.2026 5.344 € 6.680 €	08.08. - 15.08.2026 5.356 € 6.695 €	15.08. - 22.08.2026 5.088 € 6.360 €
22.08. - 29.08.2026 4.888 € 6.110 €	29.08. - 05.09.2026 6.110 €	05.09. - 12.09.2026 NOT AVAILABLE	12.09. - 19.09.2026 6.250 €
19.09. - 26.09.2026 5.940 €	26.09. - 03.10.2026 NOT AVAILABLE	03.10. - 10.10.2026 4.045 €	10.10. - 17.10.2026 3.015 €
17.10. - 24.10.2026 2.115 €	24.10. - 31.10.2026 1.733 € 1.925 €	31.10. - 07.11.2026 1.733 € 1.925 €	07.11. - 14.11.2026 1.733 € 1.925 €
20.11. - 12.03.2027 NOT AVAILABLE			



WEBSITE
www.plujeme.cz



E-MAIL
info@plujeme.cz



PHONE
+420 720 755 085



MOBILE
+420 777 170 276



PLUJEME RÁDI S.R.O.
Dlouhá 730/35, 11000 Praha 1 – Staré Město, Czech Republic

PRICE AND AVAILABILITY

13.03. - 20.03.2027 1.733 € 1.925 €	20.03. - 27.03.2027 1.733 € 1.925 €	27.03. - 03.04.2027 1.733 € 1.925 €	03.04. - 10.04.2027 1.733 € 1.925 €
10.04. - 17.04.2027 1.733 € 1.925 €	17.04. - 24.04.2027 2.021 € 2.245 €	24.04. - 01.05.2027 2.466 € 2.740 €	01.05. - 08.05.2027 2.610 € 2.900 €
08.05. - 15.05.2027 2.741 € 3.045 €	15.05. - 22.05.2027 3.299 € 3.665 €	22.05. - 29.05.2027 3.582 € 3.980 €	29.05. - 05.06.2027 3.848 € 4.275 €
05.06. - 12.06.2027 4.104 € 4.560 €	12.06. - 19.06.2027 4.424 € 4.915 €	19.06. - 26.06.2027 4.424 € 4.915 €	26.06. - 03.07.2027 4.424 € 4.915 €
03.07. - 10.07.2027 4.959 € 5.510 €	10.07. - 17.07.2027 5.517 € 6.130 €	17.07. - 24.07.2027 5.805 € 6.450 €	24.07. - 31.07.2027 6.363 € 7.070 €
31.07. - 07.08.2027 7.034 € 7.815 €			



WEBSITE
www.plujeme.cz



E-MAIL
info@plujeme.cz



PHONE
+420 720 755 085



PLUJEME RÁDI S.R.O.
Dlouhá 730/35, 11000 Praha 1 – Staré Město, Czech Republic



MOBILE
+420 777 170 276

PRICE AND AVAILABILITY

07.08. - 14.08.2027 7.034 € 7.815 €	14.08. - 21.08.2027 6.363 € 7.070 €	21.08. - 28.08.2027 5.499 € 6.110 €	28.08. - 04.09.2027 5.499 € 6.110 €
04.09. - 11.09.2027 5.796 € 6.440 €	11.09. - 18.09.2027 5.625 € 6.250 €	18.09. - 25.09.2027 5.090 € 5.655 €	25.09. - 02.10.2027 4.122 € 4.580 €
02.10. - 09.10.2027 3.641 € 4.045 €	09.10. - 16.10.2027 3.015 € 3.350 €	16.10. - 23.10.2027 2.097 € 2.330 €	23.10. - 30.10.2027 1.904 € 2.115 €
30.10. - 06.11.2027 1.733 € 1.925 €	06.11. - 13.11.2027 1.733 € 1.925 €	13.11. - 20.11.2027 1.733 € 1.925 €	20.11. - 27.11.2027 1.733 € 1.925 €
27.11. - 04.12.2027 1.733 € 1.925 €	04.12. - 11.12.2027 1.733 € 1.925 €	11.12. - 18.12.2027 1.733 € 1.925 €	18.12. - 25.12.2027 1.733 € 1.925 €



WEBSITE

www.plujeme.cz



E-MAIL

info@plujeme.cz



PHONE

+420 720 755 085



MOBILE

+420 777 170 276



PLUJEME RÁDI S.R.O.

Dlouhá 730/35, 11000 Praha 1 – Staré Město, Czech Republic