

BALI 4.1

CARLINE (2020)

Catamaran Bali 4.1 CARLINE, built in 2020 is anchored in the New Caledonia, Noumea, Port Moselle, New Caledonia, New Caledonia. It has 4 + 2 cabins, can accommodate 8 + 2 + 2 people and has 4 toilets. Bed linen and kitchen equipment are included in the price.

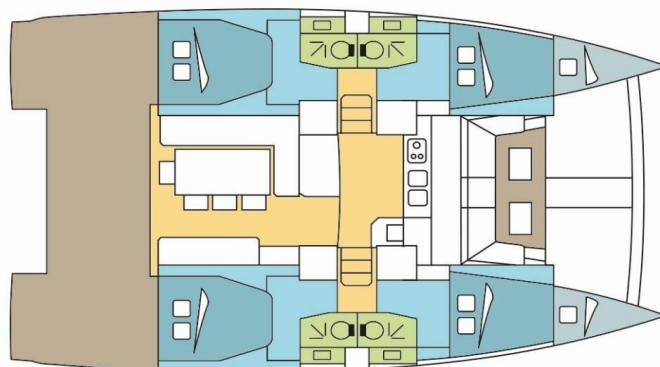

YACHT SPECIFICATIONS

Yacht Base

New Caledonia, Noumea, Port Moselle, New Caledonia

Yacht ID

12097

Brands

Catana

Yacht name

CARLINE

Production year

2020

Length

41 ft

Cabins

4 + 2

Berths

8 + 2 + 2

Max Persons

12

WC

4

Engine

2 x 40 HP

Fuel tank

400 l



WEBSITE

www.plujeme.cz



PHONE

+420 720 755 085



MOBILE

+420 777 170 276



E-MAIL

info@plujeme.cz



PLUJEME RÁDI S.R.O.

Dlouhá 730/35, 11000 Praha 1 – Staré Město, Czech Republic

STANDARD YACHT EQUIPMENT

Comfort	Cockpit cushions
Deck	Bimini top, Cockpit table, Cockpit/stern, outside shower, Davit, Dinghy, Electric anchor windlass, Outboard engine, Swimming ladder
Entertainment	Outdoor speakers, Radio
Galley	Freezer, Hot water, Oven, Refrigerator, Stove
Interior	Convertible table, Convertible table in salon, Electric fans in cabins
Navigation	Autopilot, Depthsounder, GPS chart plotter, Speedometer (Speed log), Wind instrument/Anemometer
Safety	VHF radio
Sails	Electric winch, Lazy bag, Lazy jacks, Self tailing (manual) winch
Yacht electrics	12V Socket, Inverter, Solar panels, Watermaker - desalinator, WC pump



WEBSITE

www.plujeme.cz



E-MAIL

info@plujeme.cz



PHONE

+420 720 755 085



MOBILE

+420 777 170 276



PLUJEME RÁDI S.R.O.

Dlouhá 730/35, 11000 Praha 1 – Staré Město, Czech Republic

SERVICES

SELECTED SERVICES	OBLIGATORY	PAYMENT TYPE	PRICE
Final cleaning (Payable now) Season: 2026 Exotic. included in Essentials pack	Yes	per booking	310,00 €
Handling fees (Payable now) Season: 2026 Exotic.	Yes	per booking	35,00 €
Preparation fee (Payable now) Season: 2026 Exotic. INCLUDED: starter pack – (1 gallon water or 4 bottles of 1.5L, 1 bottle of disinfectant, 1 small bottle of washing up liquid, 1 dish cloth, 1 sponge, garbage bags, 1 roll of paper towels, 1 box of matches, 1 roll of toilet paper in each head) // final cleaning // 1 set of bed sheets / cabin & 1 set of towels / pax, dinghy, outboard engine & initial supply of fuel, gas and water tanks // DYC assistance guarantee // 1st & last night in the marina // NOT INCLUDED: refuelling, gas & water consumption at end of charter, taxes if any, handling fees & additional equipment deposit.	Yes	per booking	415,00 €
Starter pack (Payable now) Season: 2026 Exotic. included in Essentials pack (The pack includes: 1 gallon water (or 4 bottles of 1.5L), 1 bottle of disinfectant, 1 small bottle of washing up liquid, 1 dish cloth, 1 sponge, garbage bags, 1 roll of paper towels, 1 box of matches, 1 roll of toilet paper in each head	Yes	per booking	50,00 €
Crew change (Payable now) Season: 2026 Exotic. Any crew change during the charter is subject to € 250.- additional cost. The charge includes administration cost, change of bed linen and towels and one night at DYC ponton (marina fee included only if the same base than start base). It doesn't include cleaning, nor new transit log where applicable.	No	per booking	250,00 €
Damage waiver (Payable now) Season: 2026 Exotic. Damage waiver limits your liability to the reduced Security Deposit . Mandatory when skipper is added. Price is per night of the charter (minimum value of 7 nights & a maximum value of 21 nights) Not applicable for 4+ weeks charters , nor Regattas/Races.	No	per night	70,00 €
Diving (Payable now) Season: 2026 Exotic. For bareboat charters only Upon request	No	per booking	0,00 €

<p>Electric & Water consumption in the Marinas (Payable at the base)</p> <p>Season: 2026 Exotic. Electric & Water consumption based on 2 nights on our dock (base will confirm the amount to pay locally depending on nights spent on dock)</p>	No	per booking	28,00 €
<p>Essentials pack (Payable now)</p> <p>Season: 2026 Exotic. INCLUDED: Damage waiver (covering damages) with reduced security deposit addressed specifically to blocked toilets, unpaid fuel, lost equipment, unpaid fees & fines, and returning the boat in an extremely dirty state. // starter pack – (1 gallon water or 4 bottles of 1.5L, 1 bottle of disinfectant, 1 small bottle of washing up liquid, 1 dish cloth, 1 sponge, garbage bags, 1 roll of paper towels, 1 box of matches, 1 roll of toilet paper in each head)// final cleaning // 1 set of bed sheets & towels, dinghy, outboard engine & initial supply of fuel, gas and water tanks // DYC assistance guarantee // 1st & last night in the marina /// NOT INCLUDED: refuelling, gas & water consumption at end of charter, taxes if any, handling fees & additional equipment deposit.</p>	No	per booking	770,00 €
<p>Extra cleaning (Payable now)</p> <p>Season: 2026 Exotic. Optional Additional cleaning</p>	No	per booking	310,00 €
<p>Extra set of linen (choose how many) (Payable now)</p> <p>Season: 2026 Exotic. Extra set of linen : 15 € 1 set of linen (2 sheets & 2 pillow case) - to be updated manually</p>	No	per booking	15,00 €
<p>Extra set of towels (choose how many) (Payable now)</p> <p>Season: 2026 Exotic. Extra set of towels: 10 € 1 set of towels (1 face & 1 bath towel) - to be updated manually</p>	No	per booking	10,00 €
<p>Full board 1-4 pax (number of guests to update manually) (Payable now)</p> <p>Season: 2026 Exotic. only available if cook is booked on board as the cook will do the provisioning based on client's preference. Includes breakfast, lunch & dinner + the crew's food. Does not included alcoholic drinks</p>	No	per guest/day	65,00 €
<p>Full board 5-12 pax (number of guests to update manually) (Payable now)</p> <p>Season: 2026 Exotic. only available if cook is booked on board as the cook will do the provisioning based on client's preference. Includes breakfast, lunch & dinner + the crew's food. Does not included alcoholic drinks</p>	No	per guest/day	60,00 €
<p>Hostess/Cook (Payable now)</p> <p>Season: 2026 Exotic. + provisioning, Crew on board must have their own toilets/ showers. If either a skipper or a hostess/cook is on board, 1 double cabin will be required for him/her. If both a skipper and a hostess/cook are on board, 1 double cabin and 1 forepeak cabin will be required for them. Exceptions exists for specific layouts, Sales Agents will provide more details about the different boat models</p>	No	per night	205,00 €

<p>Hostess/Cook (Payable now)</p> <p>Season: 2026 Exotic. + provisioning, Crew on board must have their own toilets/ showers. If either a skipper or a hostess/cook is on board, 1 double cabin will be required for him/her. If both a skipper and a hostess/cook are on board, 1 double cabin and 1 forepeak cabin will be required for them. Exceptions exists for specific layouts, Sales Agents will provide more details about the different boat models</p>	No	per night	205,00 €
<p>Hostess/Cook (Payable now)</p> <p>Season: 2026 Exotic. + provisioning, Crew on board must have their own toilets/ showers. If either a skipper or a hostess/cook is on board, 1 double cabin will be required for him/her. If both a skipper and a hostess/cook are on board, 1 double cabin and 1 forepeak cabin will be required for them. Exceptions exists for specific layouts, Sales Agents will provide more details about the different boat models</p>	No	per night	225,00 €
<p>Local telephone (Payable now)</p> <p>Season: 2026 Exotic.</p>	No	per booking	17,00 €
<p>Regatta surcharge (Payable now)</p> <p>Season: 2026 Exotic. all the regattas apart of ASW (different regatta surcharge for ASW) // A special race deposit need to be doubled manually once the regatta surcharge is added.</p>	No	per booking	0,00 €
<p>Skipper (Payable now)</p> <p>Season: 2026 Exotic. + provisioning, Crew on board must have their own toilets/ showers. If either a skipper or a hostess/cook is on board, 1 double cabin will be required for him/her. If both a skipper and a hostess/cook are on board, 1 double cabin and 1 forepeak cabin will be required for them. Exceptions exists for specific layouts, Sales Agents will provide more details about the different boat models</p>	No	per night	275,00 €
<p>Skipper (Payable now)</p> <p>Season: 2026 Exotic. + provisioning, Crew on board must have their own toilets/ showers. If either a skipper or a hostess/cook is on board, 1 double cabin will be required for him/her. If both a skipper and a hostess/cook are on board, 1 double cabin and 1 forepeak cabin will be required for them. Exceptions exists for specific layouts, Sales Agents will provide more details about the different boat models</p>	No	per night	275,00 €

Skipper (Payable now)	No	per night	305,00 €
Season: 2026 Exotic. + provisioning, Crew on board must have their own toilets/ showers. If either a skipper or a hostess/cook is on board, 1 double cabin will be required for him/her. If both a skipper and a hostess/cook are on board, 1 double cabin and 1 forepeak cabin will be required for them. Exceptions exists for specific layouts, Sales Agents will provide more details about the different boat models			
Transfer (Payable now)	No	one-way	27,50 €
Season: 2026 Exotic. OW - Airport/Base / per pax			
Transfer (Payable now)	No	round trip	55,00 €
Season: 2026 Exotic. RT - Airport / Base / per pax			
WI-FI Internet connection on boat (Payable now)	No	per night	10,00 €
Season: 2026 Exotic. 1 Gb/ day			
WI-FI Internet connection on boat (Payable now)	No	per night	19,00 €
Season: 2026 Exotic. 2 GB / day			



WEBSITE
www.plujeme.cz



PHONE
+420 720 755 085



MOBILE
+420 777 170 276



E-MAIL
info@plujeme.cz



PLUJEME RÁDI S.R.O.
Dlouhá 730/35, 11000 Praha 1 – Staré Město, Czech Republic

ADDITIONAL EXTRAS

EXTRA	OBLIGATORY	PAYMENT TYPE	PRICE
2 Trawling hand lines (Payable now) Season: 2026 Exotic. price for 2 days / per set - Payable now	No	per booking	35,00 €
2 Trawling hand lines (Payable now) Season: 2026 Exotic. price for 1 week / per set - Payable now	No	per booking	55,00 €
2 Trawling hand lines (Payable now) Season: 2026 Exotic. price for more than 1 week /per set - Payable now	No	per booking	70,00 €
Fishing equipment (Payable now) Season: 2026 Exotic. Additional deposit 100 EUR (subject to availability) - Payable now	No	per day	15,00 €
Floating mats (Payable now) Season: 2026 Exotic. price per day - Floating mats available through the provider (to be paid at the price of 1 week minimum + additional daily price if longer) - Payable now	No	per booking	13,00 €
Floating mats (Payable now) Season: 2026 Exotic. 1 week price - Floating mats available through the provider (to be paid at the price of 1 week minimum + additional daily price if longer) - Payable now	No	per booking	65,00 €
Ice box (Payable at the base) Season: 2026 Exotic. Payable at the base	No	per week	21,00 €
Kayak single (Payable now) Season: 2026 Exotic. price per day - Payable now	No	per day	21,00 €
Kayak single (Payable now) Season: 2026 Exotic. price per week - Payable now	No	per week	120,00 €
Kayak tandem (Payable now) Season: 2026 Exotic. price per day - Payable now	No	per day	30,00 €
Kayak tandem (Payable now) Season: 2026 Exotic. price per week - Payable now	No	per week	175,00 €

Kayak triple (Payable now)	No	per day	40,00 €
Season: 2026 Exotic. price per day- available through the provider and is subject to availability. To be paid at the price of 1 week minimum + additional daily price if longer - Payable now			
Kayak triple (Payable now)	No	per week	230,00 €
Season: 2026 Exotic. price per week - available through the provider and is subject to availability. To be paid at the price of 1 week minimum + additional daily price if longer - Payable now			
Mobile phone (Payable at the base)	No	per booking	17,00 €
Season: 2026 Exotic. Payable at the base			
Railing net (Safety net) (Payable now)	No	per booking	250,00 €
Season: 2026 Exotic. net is supplied but not installed - Payable now			
Stand up paddle (SUP) (Payable now)	No	per night	15,00 €
Season: 2026 Exotic. Price per day - Payable now			



WEBSITE

www.plujeme.cz



PHONE

+420 720 755 085



MOBILE

+420 777 170 276



E-MAIL

info@plujeme.cz



PLUJEME RÁDI S.R.O.

Dlouhá 730/35, 11000 Praha 1 – Staré Město, Czech Republic

PRICE AND AVAILABILITY

25.04. - 02.05.2026 5.024 € 5.910 €	02.05. - 09.05.2026 5.024 € 5.910 €	09.05. - 16.05.2026 5.274 € 6.205 €	16.05. - 29.05.2026 NOT AVAILABLE
30.05. - 06.06.2026 5.024 € 5.910 €	06.06. - 13.06.2026 5.024 € 5.910 €	13.06. - 20.06.2026 5.024 € 5.910 €	20.06. - 27.06.2026 4.998 € 5.880 €
01.07. - 08.07.2026 NOT AVAILABLE	11.07. - 18.07.2026 5.015 € 5.900 €	18.07. - 25.07.2026 5.015 € 5.900 €	25.07. - 01.08.2026 5.015 € 5.900 €
07.08. - 13.08.2026 NOT AVAILABLE	15.08. - 22.08.2026 5.041 € 5.930 €	22.08. - 29.08.2026 5.041 € 5.930 €	29.08. - 05.09.2026 5.041 € 5.930 €
05.09. - 12.09.2026 5.291 € 6.225 €	12.09. - 19.09.2026 5.041 € 5.930 €	19.09. - 26.09.2026 5.041 € 5.930 €	26.09. - 03.10.2026 5.588 € 6.574 €
05.10. - 15.10.2026 NOT AVAILABLE	16.10. - 06.11.2026 NOT AVAILABLE	07.11. - 14.11.2026 6.075 € 6.750 €	14.11. - 21.11.2026 5.535 € 6.150 €
21.11. - 28.11.2026 5.252 € 5.835 €	28.11. - 05.12.2026 4.982 € 5.535 €		



WEBSITE

www.plujeme.cz



E-MAIL

info@plujeme.cz



PHONE

+420 720 755 085



MOBILE

+420 777 170 276



PLUJEME RÁDI S.R.O.

Dlouhá 730/35, 11000 Praha 1 – Staré Město, Czech Republic

PRICE AND AVAILABILITY

05.12. - 12.12.2026

4.626 € 5.140 €

12.12. - 19.12.2026

4.626 € 5.140 €

19.12. - 26.12.2026

7.241 € 8.045 €

04.01. - 30.12.2039

NOT AVAILABLE



WEBSITE

www.plujeme.cz



E-MAIL

info@plujeme.cz



PHONE

+420 720 755 085



MOBILE

+420 777 170 276



PLUJEME RÁDI S.R.O.

Dlouhá 730/35, 11000 Praha 1 – Staré Město, Czech Republic