

DUFOUR 520 GL

BIANCO (2020)

Sailing yacht Dufour 520 GL BIANCO, built in 2020 is anchored in the Cote D'Azur, Port Pin Rolland, Provence-Alpes-Côte d'Azur, France. It has 5 cabins, can accommodate 10 + 2 people and has 3 toilets. Bed linen and kitchen equipment are included in the price.

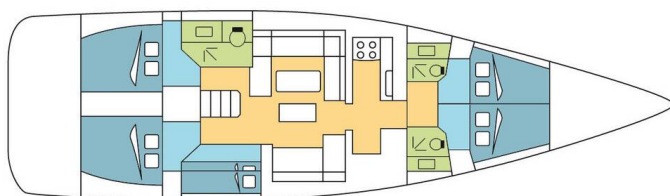

YACHT SPECIFICATIONS

Yacht Base

Cote D'Azur, Port Pin Rolland, France

Yacht ID

12093

Brands

Dufour

Yacht name

BIANCO

Production year

2020

Length

50 ft

Cabins

5

Berths

10 + 2

Max Persons

12

WC

3

Engine

1 x 75 HP

Fuel tank

250 l



WEBSITE

www.plujeme.cz



PHONE

+420 720 755 085



MOBILE

+420 777 170 276



E-MAIL

info@plujeme.cz



PLUJEME RÁDI S.R.O.

Dlouhá 730/35, 11000 Praha 1 – Staré Město, Czech Republic

STANDARD YACHT EQUIPMENT

Comfort	Cockpit cushions
Deck	Bathing platform, Bimini top, Cockpit table, Cockpit/stern, outside shower, Dinghy, Electric anchor windlass, Outboard engine, Swimming ladder, Teak deck
Entertainment	Outdoor speakers, Radio
Galley	Kitchen utensils (Galley equipment, cutlery), Microwave, Oven, Refrigerator, Stove, Wine cellar
Interior	Convertible table, Convertible table in salon
Navigation	Autopilot, Bow thruster, GPS chart plotter, Wind/speed/depth instruments
Safety	VHF radio
Sails	Lazy bag, Self tailing (manual) winch
Yacht electrics	220V socket, Inverter, Shore connection 220 V



WEBSITE

www.plujeme.cz



E-MAIL

info@plujeme.cz



PHONE

+420 720 755 085



MOBILE

+420 777 170 276



PLUJEME RÁDI S.R.O.

Dlouhá 730/35, 11000 Praha 1 – Staré Město, Czech Republic

SERVICES

SELECTED SERVICES	OBLIGATORY	PAYMENT TYPE	PRICE
Handling fees (Payable now) Season: 2026.	Yes	per booking	25,00 €
Preparation fee (Payable now) Season: 2026. INCLUDED: starter pack – (1 gallon water or 4 bottles of 1.5L, 1 bottle of disinfectant, 1 small bottle of washing up liquid, 1 dish cloth, 1 sponge, garbage bags, 1 roll of paper towels, 1 box of matches, 1 roll of toilet paper in each head) // final cleaning // 1 set of bed sheets / cabin & 1 set of towels / pax, dinghy, outboard engine & initial supply of fuel, gas and water tanks // DYC assistance guarantee // 1st & last night in the marina // NOT INCLUDED: refuelling, gas & water consumption at end of charter, taxes if any, handling fees & additional equipment deposit.	Yes	per booking	360,00 €
Crew change (Payable now) Season: 2026. Any crew change during the charter is subject to € 250.- additional cost. The charge includes administration cost, change of bed linen and towels and one night at DYC ponton (marina fee included only if the same base than start base). It doesn't include cleaning, nor new transit log where applicable.	No	per booking	250,00 €
Damage waiver (Payable now) Season: 2026. Damage waiver limits your liability to the reduced Security Deposit . Mandatory when skipper is added. Price is per night of the charter (minimum value of 7 nights & a maximum value of 21 nights). Not applicable for 4+ weeks charters , nor Regattas/Races.	No	per night	50,00 €
Early boarding/check-in (Payable now) Season: 2026. EB (boat only) - 13:00h, starting time of boat's delivery // limited number of early boardings on same departure day	No	per booking	300,00 €
Early boarding/check-in (Payable now) Season: 2026. EB + extra fee skipper - 13:00h, starting time of boat's delivery // limited number of early boardings on same departure day	No	per booking	430,00 €
Early boarding/check-in (Payable now) Season: 2026. EB + extra fee Skipper & Hostess - 13:00h, starting time of boat's delivery // limited number of early boardings on same departure day	No	per booking	530,00 €

<p>Electric & Water consumption in the Marinas (Payable at the base)</p> <p>Season: 2026. Electric & Water consumption based on 2 nights on our dock (base will confirm the amount to pay locally depending on nights spent on dock)</p>	No	per booking	28,00 €
<p>Extra set of linen (choose how many) (Payable now)</p> <p>Season: 2026. Extra set of linen : 15 € 1 extra set of linen (2 sheets & 2 pillow case) - to be updated manually</p>	No	per booking	15,00 €
<p>Extra set of towels (choose how many) (Payable now)</p> <p>Season: 2026. Extra set of towels: 10 € 1 extra set of towels (1 face & 1 bath towel) - to be updated manually</p>	No	per booking	10,00 €
<p>Full board 1-4 pax (number of guests to update manually) (Payable now)</p> <p>Season: 2026. only available if cook is booked on board as the cook will do the provisioning based on client's preference. Includes breakfast, lunch & dinner + the crew's food. Does not included alcoholic drinks</p>	No	per guest/day	60,00 €
<p>Full board 5-12 pax (number of guests to update manually) (Payable now)</p> <p>Season: 2026. only available if cook is booked on board as the cook will do the provisioning based on client's preference. Includes breakfast, lunch & dinner + the crew's food. Does not included alcoholic drinks</p>	No	per guest/day	55,00 €
<p>Half board 1-4 pax (number of guests to update manually) (Payable now)</p> <p>Season: 2026. only available if cook is booked on board as the cook will do the provisioning based on client's preference. Includes breakfast & lunch OR dinner + the crew's food. Does not included alcoholic drinks</p>	No	per guest/day	50,00 €
<p>Half board 5-12 pax (number of guests to update manually) (Payable now)</p> <p>Season: 2026. only available if cook is booked on board as the cook will do the provisioning based on client's preference. Includes breakfast & lunch OR dinner + the crew's food. Does not included alcoholic drinks</p>	No	per guest/day	45,00 €
<p>Hostess/Cook (Payable now)</p> <p>Season: 2026. + provisioning, Crew on board must have their own toilets/showers. If either a skipper or a hostess/cook is on board, 1 double cabin will be required for him/her. If both a skipper and a hostess/cook are on board, 1 double cabin and 1 forepeak cabin will be required for them. Exceptions exists for specific layouts, Sales Agents will provide more details about the different boat models</p>	No	per night	200,00 €

<p>Hostess/Cook (Payable now)</p> <p>Season: 2026. + provisioning, Crew on board must have their own toilets/showers. If either a skipper or a hostess/cook is on board, 1 double cabin will be required for him/her. If both a skipper and a hostess/cook are on board, 1 double cabin and 1 forepeak cabin will be required for them. Exceptions exists for specific layouts, Sales Agents will provide more details about the different boat models</p>	No	per night	200,00 €
<p>Hostess/Cook (Payable now)</p> <p>Season: 2026. + provisioning, Crew on board must have their own toilets/showers. If either a skipper or a hostess/cook is on board, 1 double cabin will be required for him/her. If both a skipper and a hostess/cook are on board, 1 double cabin and 1 forepeak cabin will be required for them. Exceptions exists for specific layouts, Sales Agents will provide more details about the different boat models</p>	No	per night	220,00 €
<p>Regatta surcharge (Payable now)</p> <p>Season: 2026. A special race deposit need to be doubled manually once the regatta surcharge is added.</p>	No	per booking	0,00 €
<p>Skipper (Payable now)</p> <p>Season: 2026. + provisioning, Crew on board must have their own toilets/showers. If either a skipper or a hostess/cook is on board, 1 double cabin will be required for him/her. If both a skipper and a hostess/cook are on board, 1 double cabin and 1 forepeak cabin will be required for them. Exceptions exists for specific layouts, Sales Agents will provide more details about the different boat models</p>	No	per night	270,00 €
<p>Skipper (Payable now)</p> <p>Season: 2026. + provisioning, Crew on board must have their own toilets/showers. If either a skipper or a hostess/cook is on board, 1 double cabin will be required for him/her. If both a skipper and a hostess/cook are on board, 1 double cabin and 1 forepeak cabin will be required for them. Exceptions exists for specific layouts, Sales Agents will provide more details about the different boat models</p>	No	per night	270,00 €
<p>Skipper (Payable now)</p> <p>Season: 2026. + provisioning, Crew on board must have their own toilets/showers. If either a skipper or a hostess/cook is on board, 1 double cabin will be required for him/her. If both a skipper and a hostess/cook are on board, 1 double cabin and 1 forepeak cabin will be required for them. Exceptions exists for specific layouts, Sales Agents will provide more details about the different boat models</p>	No	per night	300,00 €

Transfer (Payable now)	No	one-way	52,00 €
Season: 2026. OW - 1-4pax ,Day rate ,Train station SNCF of Toulon from/to Port Pin Rolland base			
Transfer (Payable now)	No	one-way	52,00 €
Season: 2026. OW - 1-4pax ,Day rate , Ferry terminal of Toulon from/to Port Pin Rolland base			
Transfer (Payable now)	No	one-way	65,00 €
Season: 2026. OW - 5-7 pax ,Day rate , Train station SNCF of Toulon from/to Port Pin Rolland			
Transfer (Payable now)	No	one-way	65,00 €
Season: 2026. OW - 1-4pax ,Night rate(19:00 – 07:00) Train station SNCF of Toulon from/to Port Pin Rolland			
Transfer (Payable now)	No	one-way	65,00 €
Season: 2026. OW - 5-7 pax ,Day rate, Ferry terminal of Toulon from/to Port Pin Rolland base			
Transfer (Payable now)	No	one-way	65,00 €
Season: 2026. OW - 1-4pax ,Night rate(19:00-07:00) ,Ferry terminal of Toulon from/to Port Pin Rolland			
Transfer (Payable now)	No	one-way	78,00 €
Season: 2026. OW -5-7pax ,Holidays,Sundays,Night rate(19:00-07:00), Train station SNCF of Toulon from/to Port Pin Rolland			
Transfer (Payable now)	No	one-way	78,00 €
Season: 2026. OW-5-7pax ,Bank Holidays,Sundays,Night rate(19:00-07:00), Ferry terminal of Toulon from/to Port Pin Rolland base			
Transfer (Payable now)	No	one-way	247,00 €
Season: 2026. OW - 1-4pax ,Day rate ,Airport Marseille from/to Port Pin Rolland			
Transfer (Payable now)	No	one-way	270,00 €
Season: 2026. OW - 1-4pax ,Night rate(19:00 – 07:00) , Airport Marseille from/to Port Pin Rolland base			
Transfer (Payable now)	No	one-way	290,00 €
Season: 2026. OW - 5-7 pax ,Day rate , Airport Marseille from/to Port Pin Rolland			

Transfer (Payable now)

No

one-way

340,00 €

Season: 2026. 0W -5-7pax, Holidays, Sundays, Night rate(19:00-07:00),

Airport Marseille from/to Port Pin Rolland base



WEBSITE

www.plujeme.cz



E-MAIL

info@plujeme.cz



PHONE

+420 720 755 085



MOBILE

+420 777 170 276



PLUJEME RÁDI S.R.O.

Dlouhá 730/35, 11000 Praha 1 – Staré Město, Czech Republic

ADDITIONAL EXTRAS

EXTRA	OBLIGATORY	PAYMENT TYPE	PRICE
Kayak single (Payable now) Season: 2026. Price per day - Payable now	No	per night	15,00 €
Railing net (Safety net) (Payable now) Season: 2026. net is supplied but not installed - Payable now	No	per booking	230,00 €
Stand up paddle (SUP) (Payable now) Season: 2026. Price per day - Payable now	No	per night	15,00 €



WEBSITE

www.plujeme.cz



E-MAIL

info@plujeme.cz



PHONE

+420 720 755 085



MOBILE

+420 777 170 276



PLUJEME RÁDI S.R.O.

Dlouhá 730/35, 11000 Praha 1 – Staré Město, Czech Republic

PRICE AND AVAILABILITY

25.04. - 23.05.2026 NOT AVAILABLE	23.05. - 30.05.2026 NOT AVAILABLE	30.05. - 06.06.2026 NOT AVAILABLE	06.06. - 13.06.2026 NOT AVAILABLE
13.06. - 20.06.2026 NOT AVAILABLE	20.06. - 27.06.2026 NOT AVAILABLE	27.06. - 04.07.2026 NOT AVAILABLE	04.07. - 11.07.2026 NOT AVAILABLE
11.07. - 18.07.2026 NOT AVAILABLE	18.07. - 25.07.2026 NOT AVAILABLE	25.07. - 01.08.2026 NOT AVAILABLE	01.08. - 08.08.2026 NOT AVAILABLE
08.08. - 15.08.2026 NOT AVAILABLE	15.08. - 22.08.2026 NOT AVAILABLE	22.08. - 29.08.2026 NOT AVAILABLE	29.08. - 05.09.2026 NOT AVAILABLE
05.09. - 12.09.2026 NOT AVAILABLE	12.09. - 19.09.2026 NOT AVAILABLE	19.09. - 26.09.2026 4.115 €	26.09. - 03.10.2026 NOT AVAILABLE
03.10. - 10.10.2026 3.260 €	10.10. - 17.10.2026 NOT AVAILABLE	17.10. - 24.10.2026 NOT AVAILABLE	24.10. - 31.10.2026 1.994 € 2.215 €
31.10. - 07.11.2026 1.832 € 2.035 €	07.11. - 14.11.2026 1.832 € 2.035 €	20.11. - 12.03.2027 NOT AVAILABLE	



WEBSITE

www.plujeme.cz



E-MAIL

info@plujeme.cz



PHONE

+420 720 755 085



MOBILE

+420 777 170 276



PLUJEME RÁDI S.R.O.

Dlouhá 730/35, 11000 Praha 1 – Staré Město, Czech Republic

PRICE AND AVAILABILITY

13.03. - 20.03.2027 1.832 € 2.035 €	20.03. - 27.03.2027 2.106 € 2.340 €	27.03. - 03.04.2027 2.106 € 2.340 €	03.04. - 10.04.2027 2.106 € 2.340 €
10.04. - 17.04.2027 2.106 € 2.340 €	17.04. - 24.04.2027 2.106 € 2.340 €	24.04. - 01.05.2027 3.222 € 3.580 €	01.05. - 08.05.2027 3.371 € 3.745 €
08.05. - 15.05.2027 3.515 € 3.905 €	15.05. - 22.05.2027 3.515 € 3.905 €	22.05. - 29.05.2027 NOT AVAILABLE	29.05. - 05.06.2027 NOT AVAILABLE
05.06. - 12.06.2027 4.766 € 5.295 €	12.06. - 19.06.2027 4.761 € 5.290 €	19.06. - 26.06.2027 4.761 € 5.290 €	26.06. - 03.07.2027 4.761 € 5.290 €
03.07. - 10.07.2027 5.490 € 6.100 €	10.07. - 17.07.2027 5.490 € 6.100 €	17.07. - 24.07.2027 5.711 € 6.345 €	24.07. - 31.07.2027 5.976 € 6.640 €
31.07. - 07.08.2027 6.791 € 7.545 €			



WEBSITE
www.plujeme.cz



E-MAIL
info@plujeme.cz



PHONE
+420 720 755 085



PLUJEME RÁDI S.R.O.
Dlouhá 730/35, 11000 Praha 1 – Staré Město, Czech Republic



MOBILE
+420 777 170 276

PRICE AND AVAILABILITY

07.08. - 14.08.2027 6.791 € 7.545 €	14.08. - 21.08.2027 6.494 € 7.215 €	21.08. - 28.08.2027 5.522 € 6.135 €	28.08. - 04.09.2027 5.117 € 5.685 €
04.09. - 11.09.2027 4.622 € 5.135 €	11.09. - 18.09.2027 4.172 € 4.635 €	18.09. - 25.09.2027 4.028 € 4.475 €	25.09. - 02.10.2027 3.839 € 4.265 €
02.10. - 09.10.2027 2.934 € 3.260 €	09.10. - 16.10.2027 2.745 € 3.050 €	16.10. - 23.10.2027 NOT AVAILABLE	23.10. - 30.10.2027 NOT AVAILABLE
30.10. - 06.11.2027 2.016 € 2.240 €	06.11. - 13.11.2027 1.832 € 2.035 €	13.11. - 20.11.2027 1.832 € 2.035 €	20.11. - 27.11.2027 1.832 € 2.035 €
27.11. - 04.12.2027 1.832 € 2.035 €	04.12. - 11.12.2027 1.832 € 2.035 €	11.12. - 18.12.2027 1.832 € 2.035 €	18.12. - 25.12.2027 1.832 € 2.035 €



WEBSITE

www.plujeme.cz



E-MAIL

info@plujeme.cz



PHONE

+420 720 755 085



MOBILE

+420 777 170 276



PLUJEME RÁDI S.R.O.

Dlouhá 730/35, 11000 Praha 1 – Staré Město, Czech Republic