

BALI 4.1

COTINGA (2019)

Catamaran Bali 4.1 COTINGA, built in 2019 is anchored in the Phuket, Yacht Haven Marina, Phuket, Thailand . It has 4 + 2 cabins, can accommodate 8 + 2 people and has 4 toilets. Bed linen and kitchen equipment are included in the price.

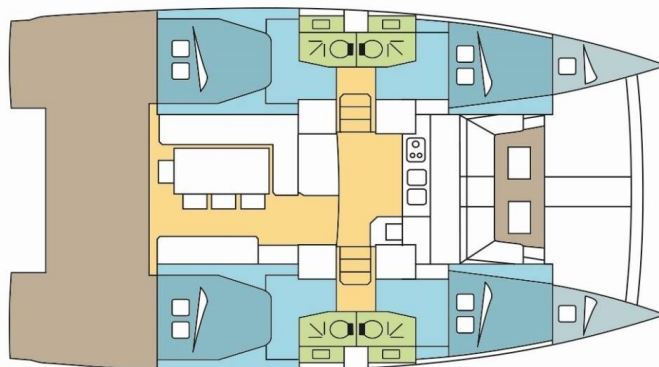

YACHT SPECIFICATIONS

Yacht Base

Phuket, Yacht Haven Marina, Thailand

Yacht ID

12083

Brands

Catana

Yacht name

COTINGA

Production year

2019

Length

41 ft

Cabins

4 + 2

Berths

8 + 2

Max Persons

10

WC

4

Engine

2 x 40 HP

Fuel tank

01



WEBSITE

www.plujeme.cz



PHONE

+420 720 755 085



MOBILE

+420 777 170 276



E-MAIL

info@plujeme.cz



PLUJEME RÁDI S.R.O.

Dlouhá 730/35, 11000 Praha 1 - Staré Město, Czech Republic

STANDARD YACHT EQUIPMENT

Comfort	Cockpit cushions
Deck	Bathing platform, Bimini top, Cockpit table, Cockpit/stern, outside shower, Davit, Dinghy, Electric anchor windlass, Swimming ladder
Entertainment	Fusion radio, Outdoor speakers
Galley	Freezer, Microwave, Oven, Refrigerator, Stove
Interior	Convertible table, Convertible table in salon, Electric fans in cabins
Navigation	Autopilot, Depthsounder, GPS chart plotter, Speedometer (Speed log), Wind instrument/Anemometer
Safety	VHF radio
Sails	Electric winch, Lazy bag, Lazy jacks
Yacht electrics	12V Socket, Converter 220V/12V, Inverter, Solar panels, Watermaker - desalinator, WC pump



WEBSITE

www.plujeme.cz



E-MAIL

info@plujeme.cz



PHONE

+420 720 755 085



MOBILE

+420 777 170 276



PLUJEME RÁDI S.R.O.

Dlouhá 730/35, 11000 Praha 1 – Staré Město, Czech Republic

SERVICES

SELECTED SERVICES	OBLIGATORY	PAYMENT TYPE	PRICE
Essentials pack (Payable now) Season: 2026 Exotic. INCLUDED: Damage waiver (covering damages) with reduced security deposit addressed specifically to blocked toilets, unpaid fuel, lost equipment, unpaid fees & fines, and returning the boat in an extremely dirty state. // starter pack – (1 gallon water or 4 bottles of 1.5L, 1 bottle of disinfectant, 1 small bottle of washing up liquid, 1 dish cloth, 1 sponge, garbage bags, 1 roll of paper towels, 1 box of matches, 1 roll of toilet paper in each head) // final cleaning // 1 set of bed sheets & towels, dinghy, outboard engine & initial supply of fuel, gas and water tanks // DYC assistance guarantee // 1st & last night in the marina /// NOT INCLUDED: refuelling, gas & water consumption at end of charter, taxes if any, handling fees & additional equipment deposit.	Yes	per booking	780,00 €
Handling fees (Payable now) Season: 2026 Exotic.	Yes	per booking	35,00 €
Preparation fee (Payable now) Season: 2026 Exotic. INCLUDED: starter pack – (1 gallon water or 4 bottles of 1.5L, 1 bottle of disinfectant, 1 small bottle of washing up liquid, 1 dish cloth, 1 sponge, garbage bags, 1 roll of paper towels, 1 box of matches, 1 roll of toilet paper in each head) // final cleaning // 1 set of bed sheets / cabin & 1 set of towels / pax, dinghy, outboard engine & initial supply of fuel, gas and water tanks // DYC assistance guarantee // 1st & last night in the marina // NOT INCLUDED: refuelling, gas & water consumption at end of charter, taxes if any, handling fees & additional equipment deposit.	Yes	per booking	395,00 €
Crew change (Payable now) Season: 2026 Exotic. Any crew change during the charter is subject to € 250.- additional cost. The charge includes administration cost, change of bed linen and towels and one night at DYC ponton (marina fee included only if the same base than start base). It doesn't include cleaning, nor new transit log where applicable.	No	per booking	250,00 €
Damage waiver (Payable now) Season: 2026 Exotic. Damage waiver limits your liability to the reduced Security Deposit . Mandatory when skipper is added. Price is per night of the charter (minimum value of 7 nights & a maximum value of 21 nights) Not applicable for 4+ weeks charters , nor Regattas/Races.	No	per night	60,00 €

Early boarding/check-in (Payable now)	No	per booking	450,00 €
Season: 2026 Exotic. EB (boat only) - 14:00 h / 2 PM starting time of boat's delivery // limited number of early boardings on same departure day			
Early boarding/check-in (Payable now)	No	per booking	615,00 €
Season: 2026 Exotic. EB boat + extra fee skipper - 14:00 h / 2 PM starting time of boat's delivery // limited number of early boardings on same departure day			
Early boarding/check-in (Payable now)	No	per booking	745,00 €
Season: 2026 Exotic. EB + extra fee Skipper & Hostes - 14:00 h / 2 PM starting time of boat's delivery // limited number of early boardings on same departure day			
Electric & Water consumption in the Marinas (Payable at the base)	No	per booking	28,00 €
Season: 2026 Exotic. Electric & Water consumption based on 2 nights on our dock (base will confirm the amount to pay locally depending on nights spent on dock)			
Extra cleaning (Payable now)	No	per booking	310,00 €
Season: 2026 Exotic. Optional Additional cleaning			
Extra set of linen (choose how many) (Payable now)	No	per booking	15,00 €
Season: 2026 Exotic. Extra set of linen : 15 € 1 set of linen (2 sheets & 2 pillow case) - to be updated manually			
Extra set of towels (choose how many) (Payable now)	No	per booking	10,00 €
Season: 2026 Exotic. Extra set of towels: 10 € 1 set of towels (1 face & 1 bath towel) - to be updated manually			
Final cleaning (Payable now)	No	per booking	310,00 €
Season: 2026 Exotic. included in Essentials pack			
Final cleaning (Payable now)	No	per booking	310,00 €
Season: 2026 Exotic. included in Essentials pack			
Full board 1-4 pax (number of guests to update manually) (Payable now)	No	per guest/day	60,00 €
Season: 2026 Exotic. only available if cook is booked on board as the cook will do the provisioning based on client's preference. Includes breakfast, lunch & dinner + the crew's food. Does not included alcoholic drinks			
Full board 5-12 pax (number of guests to update manually) (Payable now)	No	per guest/day	55,00 €
Season: 2026 Exotic. only available if cook is booked on board as the cook will do the provisioning based on client's preference. Includes breakfast, lunch & dinner + the crew's food. Does not included alcoholic drinks			

<p>Half board 1-4 pax (number of guests to update manually) (Payable now)</p> <p>Season: 2026 Exotic. only available if cook is booked on board as the cook will do the provisioning based on client's preference. Includes breakfast & lunch OR dinner + the crew's food. Does not included alcoholic drinks</p>	No	per guest/day	50,00 €
<p>Half board 5-12 pax (number of guests to update manually) (Payable now)</p> <p>Season: 2026 Exotic. only available if cook is booked on board as the cook will do the provisioning based on client's preference. Includes breakfast & lunch OR dinner + the crew's food. Does not included alcoholic drinks</p>	No	per guest/day	45,00 €
<p>Hostess/Cook (Payable now)</p> <p>Season: 2026 Exotic. + provisioning, Crew on board must have their own toilets/ showers. If either a skipper or a hostess/cook is on board, 1 double cabin will be required for him/her. If both a skipper and a hostess/cook are on board, 1 double cabin and 1 forepeak cabin will be required for them. Exceptions exists for specific layouts, Sales Agents will provide more details about the different boat models</p>	No	per night	130,00 €
<p>Hostess/Cook (Payable now)</p> <p>Season: 2026 Exotic. + provisioning, Crew on board must have their own toilets/ showers. If either a skipper or a hostess/cook is on board, 1 double cabin will be required for him/her. If both a skipper and a hostess/cook are on board, 1 double cabin and 1 forepeak cabin will be required for them. Exceptions exists for specific layouts, Sales Agents will provide more details about the different boat models</p>	No	per night	130,00 €
<p>Hostess/Cook (Payable now)</p> <p>Season: 2026 Exotic. + provisioning, Crew on board must have their own toilets/ showers. If either a skipper or a hostess/cook is on board, 1 double cabin will be required for him/her. If both a skipper and a hostess/cook are on board, 1 double cabin and 1 forepeak cabin will be required for them. Exceptions exists for specific layouts, Sales Agents will provide more details about the different boat models</p>	No	per night	145,00 €
<p>Race pack (Payable now)</p> <p>Season: 2026 Exotic. Multihull Solutions Regatta / The Regatta Package includes - Briefing before the race, preparation and gauging of sails, technical assistance during the race, registration of the boat (not of the passengers). // A special race deposit need to be doubled manually once the race fee is added.</p>	No	per booking	800,00 €

Race pack (Payable now) Season: 2026 Exotic. Phuket Race Week / The Regatta Package includes - Briefing before the race, preparation and gauging of sails, technical assistance during the race, registration of the boat (not of the passengers) // A special race deposit need to be doubled manually once the race fee is added.	No	per booking	800,00 €
Race pack (Payable now) Season: 2026 Exotic. Royal Langkawi International Regatta / The Regatta Package includes - Briefing before the race, preparation and gauging of sails, technical assistance during the race, registration of the boat (not of the passengers). // A special race deposit need to be doubled manually once the race fee is added.	No	per booking	1.000,00 €
Race pack (Payable now) Season: 2026 Exotic. Raja Muda Selangor International Regatta / The Regatta Package includes - Briefing before the race, preparation and gauging of sails, technical assistance during the race, registration of the boat (not of the passengers) // A special race deposit need to be doubled manually once the race fee is added.	No	per booking	1.200,00 €
Race pack (Payable now) Season: 2026 Exotic. Kings Cup / The Regatta Package includes - Briefing before the race, preparation and gauging of sails, technical assistance during the race, registration of the boat (not of the passengers). // A special race deposit need to be doubled manually once the race fee is added.	No	per booking	1.200,00 €
Race pack (Payable now) Season: 2026 Exotic. Bay Regatta / The Regatta Package includes - Briefing before the race, preparation and gauging of sails, technical assistance during the race, registration of the boat (not of the passengers). // A special race deposit need to be doubled manually once the race fee is added.	No	per booking	1.200,00 €
Regatta surcharge (Payable now) Season: 2026 Exotic. all the regattas apart of ASW (different regatta surcharge for ASW) // A special race deposit need to be doubled manually once the regatta surcharge is added.	No	per booking	0,00 €
Same day briefing (Payable now) Season: 2026 Exotic. Same day briefing starting between 5 & 5.30pm (departure following morning)	No	per booking	150,00 €

Skipper (Payable now) Season: 2026 Exotic. + provisioning, Crew on board must have their own toilets/ showers. If either a skipper or a hostess/cook is on board, 1 double cabin will be required for him/her. If both a skipper and a hostess/cook are on board, 1 double cabin and 1 forepeak cabin will be required for them. Exceptions exists for specific layouts, Sales Agents will provide more details about the different boat models	No	per night	165,00 €
Skipper (Payable now) Season: 2026 Exotic. + provisioning, Crew on board must have their own toilets/ showers. If either a skipper or a hostess/cook is on board, 1 double cabin will be required for him/her. If both a skipper and a hostess/cook are on board, 1 double cabin and 1 forepeak cabin will be required for them. Exceptions exists for specific layouts, Sales Agents will provide more details about the different boat models	No	per night	165,00 €
Skipper (Payable now) Season: 2026 Exotic. + provisioning, Crew on board must have their own toilets/ showers. If either a skipper or a hostess/cook is on board, 1 double cabin will be required for him/her. If both a skipper and a hostess/cook are on board, 1 double cabin and 1 forepeak cabin will be required for them. Exceptions exists for specific layouts, Sales Agents will provide more details about the different boat models	No	per night	180,00 €
Starter pack (Payable now) Season: 2026 Exotic. included in Essentials pack (The pack includes: 1 gallon water (or 4 bottles of 1.5L), 1 bottle of disinfectant, 1 small bottle of washing up liquid, 1 dish cloth, 1 sponge, garbage bags, 1 roll of paper towels, 1 box of matches, 1 roll of toilet paper in each head	No	per booking	50,00 €
Transfer (Payable now) Season: 2026 Exotic. RT - PHU airport/base/airport from 1 to 3 pax	No	round trip	56,00 €
Transfer (Payable now) Season: 2026 Exotic. RT - PHU airport/base/airport from 4 to 8 pax	No	round trip	75,00 €
Transfer (Payable now) Season: 2026 Exotic. RT - PHU airport/base/airport from 9 to 12 pax	No	round trip	135,00 €
WI-FI Internet connection on boat (Payable now) Season: 2026 Exotic. Sim card + Wifi key 5 Go is provided (reloadable upon calling the base)	No	per week	50,00 €



WEBSITE
www.plujeme.cz



PHONE
+420 720 755 085



MOBILE
+420 777 170 276



E-MAIL
info@plujeme.cz



PLUJEME RÁDI S.R.O.
Dlouhá 730/35, 11000 Praha 1 – Staré Město, Czech Republic

ADDITIONAL EXTRAS

EXTRA	OBLIGATORY	PAYMENT TYPE	PRICE
Fishing equipment (Payable now) Season: 2026 Exotic. Additional deposit 100 EUR (subject to availability) - Payable now	No	per day	15,00 €
Kayak single (Payable now) Season: 2026 Exotic. price per day - Payable now	No	per night	15,00 €
Kayak tandem (Payable now) Season: 2026 Exotic. price per day - Payable now	No	per night	15,00 €
Outboard engine 8 & 9,8 HP (Payable now) Season: 2026 Exotic. Dinghy not suitable in any case for waterski or wakeboard. Additional security deposit of 500 € - Payable now	No	per day	35,00 €
Railing net (Safety net) (Payable now) Season: 2026 Exotic. net is supplied but not installed - Payable now	No	per booking	250,00 €
Stand up paddle (SUP) (Payable now) Season: 2026 Exotic. Price per day - Payable now	No	per night	15,00 €



WEBSITE
www.plujeme.cz



PHONE
+420 720 755 085



MOBILE
+420 777 170 276



E-MAIL
info@plujeme.cz



PLUJEME RÁDI S.R.O.
Dlouhá 730/35, 11000 Praha 1 – Staré Město, Czech Republic

PRICE AND AVAILABILITY

02.05. - 09.05.2026 3.008 € 3.760 €	09.05. - 16.05.2026 2.892 € 3.615 €	16.05. - 23.05.2026 2.892 € 3.615 €	23.05. - 30.05.2026 2.892 € 3.615 €
30.05. - 06.06.2026 2.892 € 3.615 €	06.06. - 13.06.2026 2.892 € 3.615 €	13.06. - 20.06.2026 2.892 € 3.615 €	20.06. - 27.06.2026 2.892 € 3.615 €
27.06. - 04.07.2026 2.892 € 3.615 €	04.07. - 11.07.2026 2.892 € 3.615 €	11.07. - 18.07.2026 2.892 € 3.615 €	18.07. - 25.07.2026 2.792 € 3.490 €
25.07. - 01.08.2026 2.788 € 3.485 €	01.08. - 08.08.2026 2.788 € 3.485 €	08.08. - 15.08.2026 2.980 € 3.725 €	15.08. - 22.08.2026 2.892 € 3.615 €
22.08. - 29.08.2026 2.892 € 3.615 €	29.08. - 05.09.2026 2.892 € 3.615 €	05.09. - 12.09.2026 2.892 € 3.615 €	12.09. - 19.09.2026 2.892 € 3.615 €
19.09. - 26.09.2026 2.892 € 3.615 €	26.09. - 03.10.2026 2.879 € 3.599 €	03.10. - 10.10.2026 NOT AVAILABLE	10.10. - 24.10.2026 NOT AVAILABLE
24.10. - 31.10.2026 5.715 € 6.350 €	31.10. - 07.11.2026 6.957 € 7.730 €	07.11. - 14.11.2026 8.856 € 9.840 €	19.11. - 30.11.2026 NOT AVAILABLE
05.12. - 12.12.2026 8.217 € 9.130 €	12.12. - 19.12.2026 8.217 € 9.130 €	19.12. - 26.12.2026 11.295 € 12.550 €	



WEBSITE
www.plujeme.cz



E-MAIL
info@plujeme.cz



PHONE
+420 720 755 085



PLUJEME RÁDI S.R.O.
Dlouhá 730/35, 11000 Praha 1 – Staré Město, Czech Republic



MOBILE
+420 777 170 276

PRICE AND AVAILABILITY

02.01. - 09.01.2027 9.356 € 10.395 €	09.01. - 23.01.2027 NOT AVAILABLE	23.01. - 30.01.2027 9.770 € 10.855 €	30.01. - 06.02.2027 9.770 € 10.855 €
06.02. - 13.02.2027 9.770 € 10.855 €	13.02. - 20.02.2027 9.770 € 10.855 €	20.02. - 27.02.2027 10.283 € 11.425 €	27.02. - 06.03.2027 9.999 € 11.110 €
06.03. - 13.03.2027 9.333 € 10.370 €	13.03. - 20.03.2027 7.515 € 8.350 €	20.03. - 27.03.2027 7.277 € 8.085 €	27.03. - 03.04.2027 6.656 € 7.395 €
03.04. - 10.04.2027 6.219 € 6.910 €	10.04. - 17.04.2027 6.219 € 6.910 €	17.04. - 24.04.2027 5.598 € 6.220 €	24.04. - 01.05.2027 5.031 € 5.590 €
01.05. - 08.05.2027 3.807 € 4.230 €	08.05. - 15.05.2027 3.254 € 3.615 €	15.05. - 22.05.2027 3.254 € 3.615 €	22.05. - 29.05.2027 3.254 € 3.615 €
29.05. - 05.06.2027 3.254 € 3.615 €	05.06. - 12.06.2027 3.254 € 3.615 €	12.06. - 19.06.2027 3.254 € 3.615 €	19.06. - 26.06.2027 3.254 € 3.615 €
26.06. - 03.07.2027 3.254 € 3.615 €	03.07. - 10.07.2027 3.254 € 3.615 €	10.07. - 17.07.2027 3.254 € 3.615 €	17.07. - 24.07.2027 3.447 € 3.830 €
24.07. - 31.07.2027 3.447 € 3.830 €	31.07. - 07.08.2027 3.447 € 3.830 €	07.08. - 14.08.2027 3.330 € 3.700 €	14.08. - 21.08.2027 3.204 € 3.560 €
21.08. - 28.08.2027 3.204 € 3.560 €	28.08. - 04.09.2027 3.204 € 3.560 €		



WEBSITE

www.plujeme.cz



E-MAIL

info@plujeme.cz



PHONE

+420 720 755 085



MOBILE

+420 777 170 276



PLUJEME RÁDI S.R.O.

Dlouhá 730/35, 11000 Praha 1 – Staré Město, Czech Republic

PRICE AND AVAILABILITY

04.09. - 11.09.2027 3.204 € 3.560 €	11.09. - 18.09.2027 3.204 € 3.560 €	18.09. - 25.09.2027 3.204 € 3.560 €	25.09. - 02.10.2027 3.204 € 3.560 €
02.10. - 09.10.2027 3.204 € 3.560 €	09.10. - 16.10.2027 4.037 € 4.485 €	16.10. - 23.10.2027 5.810 € 6.455 €	23.10. - 30.10.2027 6.350 € 7.055 €
30.10. - 06.11.2027 6.962 € 7.735 €	06.11. - 13.11.2027 8.033 € 8.925 €	13.11. - 20.11.2027 8.303 € 9.225 €	20.11. - 27.11.2027 8.739 € 9.710 €
27.11. - 04.12.2027 7.866 € 8.740 €	04.12. - 11.12.2027 8.217 € 9.130 €	11.12. - 18.12.2027 8.217 € 9.130 €	18.12. - 25.12.2027 11.295 € 12.550 €



WEBSITE

www.plujeme.cz



E-MAIL

info@plujeme.cz



PHONE

+420 720 755 085



MOBILE

+420 777 170 276



PLUJEME RÁDI S.R.O.

Dlouhá 730/35, 11000 Praha 1 – Staré Město, Czech Republic