

# BALI 4.1

ZENA (2019)

Catamaran Bali 4.1 ZENA, built in 2019 is anchored in the Seychelles, Praslin, Mahé, Seychelles. It has 3 + 1 cabins, can accommodate 6 + 1 people and has 2 toilets. Bed linen and kitchen equipment are included in the price.

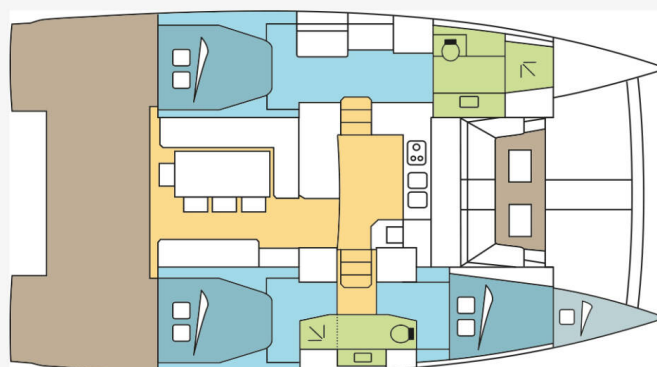

## YACHT SPECIFICATIONS

Yacht Base

**Seychelles, Praslin, Seychelles**

Yacht ID

**12080**

Brands

**Catana**

Yacht name

**ZENA**

Production year

**2019**

Length

**41 ft**

Cabins

**3 + 1**

Berths

**6 + 1**

Max Persons

**7**

WC

**2**

Engine

**2 x 40 HP**

Fuel tank

**400 l**



**WEBSITE**

[www.plujeme.cz](http://www.plujeme.cz)



**PHONE**

+420 720 755 085



**MOBILE**

+420 777 170 276



**E-MAIL**

[info@plujeme.cz](mailto:info@plujeme.cz)



**PLUJEME RÁDI S.R.O.**

Dlouhá 730/35, 11000 Praha 1 – Staré Město, Czech Republic

## STANDARD YACHT EQUIPMENT

|                 |   |
|-----------------|---|
| Comfort         | <b>Cockpit cushions</b>   |
| Deck            | <b>Bimini top, Cockpit grill, Cockpit table, Davit, Dinghy, Electric anchor windlass, Grill/Barbecue/Plancha, Swimming ladder</b> |
| Entertainment   | <b>Fusion radio, Outdoor speakers</b>   |
| Galley          | <b>Freezer, Oven, Refrigerator, Stove</b>   |
| Navigation      | <b>Autopilot, Depthsounder, Radar, Wind instrument/Anemometer</b>   |
| Safety          | <b>VHF radio</b>  |
| Sails           | <b>Electric winch, Lazy bag, Lazy jacks, Self tailing (manual) winch</b>  |
| Yacht electrics | <b>12V Socket, 220V socket, Inverter, Solar panels, WC pump</b>   |



#### WEBSITE

[www.plujeme.cz](http://www.plujeme.cz)



#### E-MAIL

[info@plujeme.cz](mailto:info@plujeme.cz)



#### PHONE

+420 720 755 085



#### MOBILE

+420 777 170 276



#### PLUJEME RÁDI S.R.O.

Dlouhá 730/35, 11000 Praha 1 – Staré Město, Czech Republic

## SERVICES

| SELECTED SERVICES  | OBLIGATORY | PAYMENT TYPE  | PRICE           |
|--|------------|---------------|-----------------|
| <p><b>Essentials pack</b> (Payable now)</p> <p><b>Season: 2026 Exotic.</b> INCLUDED: Damage waiver (covering damages) with reduced security deposit addressed specifically to blocked toilets, unpaid fuel, lost equipment, unpaid fees &amp; fines, and returning the boat in an extremely dirty state. // starter pack – (1 gallon water or 4 bottles of 1.5L, 1 bottle of disinfectant, 1 small bottle of washing up liquid, 1 dish cloth, 1 sponge, garbage bags, 1 roll of paper towels, 1 box of matches, 1 roll of toilet paper in each head) // final cleaning // 1 set of bed sheets &amp; towels, dinghy, outboard engine &amp; initial supply of fuel, gas and water tanks // DYC assistance guarantee // 1st &amp; last night in the marina /// NOT INCLUDED: refuelling, gas &amp; water consumption at end of charter, taxes if any, handling fees &amp; additional equipment deposit.</p> | Yes        | per booking   | <b>780,00 €</b> |
| <p><b>Handling fees</b> (Payable now)</p> <p><b>Season: 2026 Exotic.</b></p>   | Yes        | per booking   | <b>35,00 €</b>  |
| <p><b>Preparation fee</b> (Payable now)</p> <p><b>Season: 2026 Exotic.</b> INCLUDED: starter pack – (1 gallon water or 4 bottles of 1.5L, 1 bottle of disinfectant, 1 small bottle of washing up liquid, 1 dish cloth, 1 sponge, garbage bags, 1 roll of paper towels, 1 box of matches, 1 roll of toilet paper in each head) // final cleaning // 1 set of bed sheets / cabin &amp; 1 set of towels / pax, dinghy, outboard engine &amp; initial supply of fuel, gas and water tanks // DYC assistance guarantee // 1st &amp; last night in the marina // NOT INCLUDED: refuelling, gas &amp; water consumption at end of charter, taxes if any, handling fees &amp; additional equipment deposit.</p>  | Yes        | per booking   | <b>395,00 €</b> |
| <p><b>The Tourism Environmental Sustainability Levy</b> (Payable at the base)</p> <p><b>Season: 2026 Exotic.</b> According to S.I. 52 of 2023 ENVIRONMENT PROTECTION ACT (ext. of Act 18 of 2016), a Seychelles compulsory levy of 100SCR per person/day (or equivalent Currency as per daily rate) is applied, payable at base. NOT applicable to citizens and residents of Seychelles, children of 12 years and below (visitors), and Dream Yacht crew. . (Price will be adjusted according to the crew list)</p>  | Yes        | per guest/day | <b>6,67 €</b>   |
| <p><b>Damage waiver</b> (Payable now)</p> <p><b>Season: 2026 Exotic.</b> Damage waiver limits your liability to the reduced Security Deposit . Mandatory when skipper is added. Price is per night of the charter ( minimum value of 7 nights &amp; a maximum value of 21 nights) Not applicable for 4+ weeks charters , nor Regattas/Races.</p>   | No         | per night     | <b>60,00 €</b>  |

|   |    |               |                 |
|---|----|---------------|-----------------|
| <b>Deckhand/ Marinero</b> (Payable now)<br><b>Season: 2026 Exotic.</b> + provisioning   | No | per night     | <b>130,00 €</b> |
| <b>Electric &amp; Water consumption in the Marinas</b> (Payable at the base)<br><b>Season: 2026 Exotic.</b> Electric & Water consumption based on 2 nights on our dock (base will confirm the amount to pay locally depending on nights spent on dock)  | No | per booking   | <b>28,00 €</b>  |
| <b>Extra cleaning</b> (Payable now)<br><b>Season: 2026 Exotic.</b> Optional Additional cleaning   | No | per booking   | <b>310,00 €</b> |
| <b>Extra set of linen (choose how many)</b> (Payable now)<br><b>Season: 2026 Exotic.</b> Extra set of linen : 15 € 1 set of linen (2 sheets & 2 pillow case) - to be updated manually   | No | per booking   | <b>15,00 €</b>  |
| <b>Extra set of towels (choose how many)</b> (Payable now)<br><b>Season: 2026 Exotic.</b> Extra set of towels: 10 € 1 set of towels (1 face & 1 bath towel) - to be updated manually  | No | per booking   | <b>10,00 €</b>  |
| <b>Final cleaning</b> (Payable now)<br><b>Season: 2026 Exotic.</b> included in Essentials pack  | No | per booking   | <b>310,00 €</b> |
| <b>Final cleaning</b> (Payable now)<br><b>Season: 2026 Exotic.</b> included in Essentials pack  | No | per booking   | <b>310,00 €</b> |
| <b>Full board 1-4 pax (number of guests to update manually)</b> (Payable now)<br><b>Season: 2026 Exotic.</b> only available if cook is booked on board as the cook will do the provisioning based on client's preference. Includes breakfast, lunch & dinner + the crew's food. Does not included alcoholic drinks    | No | per guest/day | <b>60,00 €</b>  |
| <b>Full board 5-12 pax (number of guests to update manually)</b> (Payable now)<br><b>Season: 2026 Exotic.</b> only available if cook is booked on board as the cook will do the provisioning based on client's preference. Includes breakfast, lunch & dinner + the crew's food. Does not included alcoholic drinks   | No | per guest/day | <b>55,00 €</b>  |
| <b>Half board 1-4 pax (number of guests to update manually)</b> (Payable now)<br><b>Season: 2026 Exotic.</b> only available if cook is booked on board as the cook will do the provisioning based on client's preference. Includes breakfast & lunch OR dinner + the crew's food. Does not included alcoholic drinks  | No | per guest/day | <b>50,00 €</b>  |
| <b>Half board 5-12 pax (number of guests to update manually)</b> (Payable now)<br><b>Season: 2026 Exotic.</b> only available if cook is booked on board as the cook will do the provisioning based on client's preference. Includes breakfast & lunch OR dinner + the crew's food. Does not included alcoholic drinks | No | per guest/day | <b>45,00 €</b>  |

|   |    |             |                 |
|---|----|-------------|-----------------|
| <b>Regatta surcharge</b> (Payable now)  | No | per booking | <b>0,00 €</b>   |
| <b>Season: 2026 Exotic.</b> all the regattas apart of ASW (different regatta surcharge for ASW) // A special race deposit need to be doubled manually once the regatta surcharge is added.  |    |             |                 |
| <b>Skipper</b> (Payable now)  | No | per night   | <b>170,00 €</b> |
| <b>Season: 2026 Exotic.</b> + provisioning, Crew on board must have their own toilets/ showers. If either a skipper or a hostess/cook is on board, 1 double cabin will be required for him/her. If both a skipper and a hostess/cook are on board, 1 double cabin and 1 forepeak cabin will be required for them. Exceptions exists for specific layouts, Sales Agents will provide more details about the different boat models  |    |             |                 |
| <b>Skipper</b> (Payable now)  | No | per night   | <b>170,00 €</b> |
| <b>Season: 2026 Exotic.</b> + provisioning, Crew on board must have their own toilets/ showers. If either a skipper or a hostess/cook is on board, 1 double cabin will be required for him/her. If both a skipper and a hostess/cook are on board, 1 double cabin and 1 forepeak cabin will be required for them. Exceptions exists for specific layouts, Sales Agents will provide more details about the different boat models  |    |             |                 |
| <b>Skipper</b> (Payable now)  | No | per night   | <b>190,00 €</b> |
| <b>Season: 2026 Exotic.</b> + provisioning, Crew on board must have their own toilets/ showers. If either a skipper or a hostess/cook is on board, 1 double cabin will be required for him/her. If both a skipper and a hostess/cook are on board, 1 double cabin and 1 forepeak cabin will be required for them. Exceptions exists for specific layouts, Sales Agents will provide more details about the different boat models  |    |             |                 |
| <b>Skipper+Cook</b> (Payable now)   | No | per night   | <b>220,00 €</b> |
| <b>Season: 2026 Exotic.</b> (for charters up to max 3 guests, one person works as a skipper and cook) + provisioning, Crew on board must have their own toilets/ showers. If either a skipper or a hostess/cook is on board, 1 double cabin will be required for him/her. If both a skipper and a hostess/cook are on board, 1 double cabin and 1 forepeak cabin will be required for them. Exceptions exists for specific layouts, Sales Agents will provide more details about the different boat models. |    |             |                 |
| <b>Skipper+Cook</b> (Payable now)   | No | per night   | <b>220,00 €</b> |
| <b>Season: 2026 Exotic.</b> (for charters up to max 3 guests, one person works as a skipper and cook) + provisioning, Crew on board must have their own toilets/ showers. If either a skipper or a hostess/cook is on board, 1 double cabin will be required for him/her. If both a skipper and a hostess/cook are on board, 1 double cabin and 1 forepeak cabin will be required for them. Exceptions exists for specific layouts, Sales Agents will provide more details about the different boat models. |    |             |                 |

|  |    |             |                 |
|--|----|-------------|-----------------|
| <b>Skipper+Cook</b> (Payable now)  | No | per night   | <b>245,00 €</b> |
| <b>Season: 2026 Exotic.</b> (for charters up to max 3 guests, one person works as a skipper and cook)+ provisioning, Crew on board must have their own toilets/ showers. If either a skipper or a hostess/cook is on board, 1 double cabin will be required for him/her. If both a skipper and a hostess/cook are on board, 1 double cabin and 1 forepeak cabin will be required for them. Exceptions exists for specific layouts, Sales Agents will provide more details about the different boat models. |    |             |                 |
| <b>Starter pack</b> (Payable now)  | No | per booking | <b>50,00 €</b>  |
| <b>Season: 2026 Exotic.</b> included in Essentials pack (The pack includes: 1 gallon water (or 4 bottles of 1.5L), 1 bottle of disinfectant, 1 small bottle of washing up liquid, 1 dish cloth, 1 sponge, garbage bags, 1 roll of paper towels, 1 box of matches, 1 roll of toilet paper in each head  |    |             |                 |
| <b>Steward/Cook</b> (Payable now)  | No | per night   | <b>145,00 €</b> |
| <b>Season: 2026 Exotic.</b> + provisioning, a cabin or forepeak to sleep and access to a WC/Shower   |    |             |                 |
| <b>Steward/Cook</b> (Payable now)  | No | per night   | <b>145,00 €</b> |
| <b>Season: 2026 Exotic.</b> + provisioning, a cabin or forepeak to sleep and access to a WC/Shower   |    |             |                 |
| <b>Steward/Cook</b> (Payable now)  | No | per night   | <b>160,00 €</b> |
| <b>Season: 2026 Exotic.</b> + provisioning, a cabin or forepeak to sleep and access to a WC/Shower   |    |             |                 |
| <b>Transfer</b> (Payable now)  | No | one-way     | <b>15,00 €</b>  |
| <b>Season: 2026 Exotic.</b> OW - Jetty Terminal/base 1 to 4 pax  |    |             |                 |
| <b>Transfer</b> (Payable now)  | No | one-way     | <b>20,00 €</b>  |
| <b>Season: 2026 Exotic.</b> OW - Jetty Terminal/base 5 to 8 pax  |    |             |                 |
| <b>Transfer</b> (Payable now)  | No | one-way     | <b>29,00 €</b>  |
| <b>Season: 2026 Exotic.</b> OW - Jetty Terminal/base 9 to 12 pax   |    |             |                 |
| <b>Transfer</b> (Payable now)  | No | round trip  | <b>78,00 €</b>  |
| <b>Season: 2026 Exotic.</b> RT - Praslin airport/base/airport 1 to 4 pax   |    |             |                 |
| <b>Transfer</b> (Payable now)  | No | round trip  | <b>98,00 €</b>  |
| <b>Season: 2026 Exotic.</b> RT - Praslin airport/base/airport 5 to 8 pax   |    |             |                 |
| <b>Transfer</b> (Payable now)  | No | round trip  | <b>118,00 €</b> |
| <b>Season: 2026 Exotic.</b> RT - Praslin airport/base/airport 9 to 12 pax  |    |             |                 |

**Transfer** (Payable now)

No

round trip

**136,00 €**

**Season: 2026 Exotic.** RT - Praslin airport/base/airport 13 to 16 pax



**WEBSITE**

[www.plujeme.cz](http://www.plujeme.cz)



**E-MAIL**

[info@plujeme.cz](mailto:info@plujeme.cz)



**PHONE**

+420 720 755 085



**MOBILE**

+420 777 170 276



**PLUJEME RÁDI S.R.O.**

Dlouhá 730/35, 11000 Praha 1 – Staré Město, Czech Republic

## ADDITIONAL EXTRAS

| EXTRA  | OBLIGATORY | PAYMENT TYPE | PRICE           |
|--|------------|--------------|-----------------|
| <b>Fishing equipment</b> (Payable now)<br><b>Season: 2026 Exotic.</b> Additional deposit 100 EUR (subject to availability) - Payable now | No         | per day      | <b>15,00 €</b>  |
| <b>Kayak single</b> (Payable now)<br><b>Season: 2026 Exotic.</b> price per day - Payable now   | No         | per night    | <b>15,00 €</b>  |
| <b>Kayak tandem</b> (Payable now)<br><b>Season: 2026 Exotic.</b> price per day - Payable now   | No         | per night    | <b>15,00 €</b>  |
| <b>Railing net (Safety net)</b> (Payable now)<br><b>Season: 2026 Exotic.</b> net is supplied but not installed - Payable now             | No         | per booking  | <b>250,00 €</b> |
| <b>Stand up paddle (SUP)</b> (Payable now)<br><b>Season: 2026 Exotic.</b> Price per day - Payable now                                    | No         | per night    | <b>15,00 €</b>  |
| <b>Wi-Fi Internet</b> (Payable now)<br><b>Season: 2026 Exotic.</b> Wifi Unlimited - Payable now  | No         | per night    | <b>12,00 €</b>  |



**WEBSITE**

[www.plujeme.cz](http://www.plujeme.cz)



**E-MAIL**

[info@plujeme.cz](mailto:info@plujeme.cz)



**PHONE**

+420 720 755 085



**MOBILE**

+420 777 170 276



**PLUJEME RÁDI S.R.O.**

Dlouhá 730/35, 11000 Praha 1 – Staré Město, Czech Republic

## PRICE AND AVAILABILITY

|  |  |  |  |
|--|--|--|--|
| 25.04. - 02.05.2026<br>NOT AVAILABLE   | 02.05. - 09.05.2026<br>NOT AVAILABLE   | 09.05. - 23.05.2026<br>NOT AVAILABLE   | 23.05. - 30.05.2026<br>NOT AVAILABLE   |
| 30.05. - 06.06.2026<br>2.808 € 3.510 € | 06.06. - 13.06.2026<br>2.520 € 3.150 € | 13.06. - 20.06.2026<br>2.520 € 3.150 € | 20.06. - 27.06.2026<br>2.520 € 3.150 € |
| 27.06. - 04.07.2026<br>2.520 € 3.150 € | 05.07. - 10.07.2026<br>NOT AVAILABLE   | 11.07. - 18.07.2026<br>2.512 € 3.140 € | 18.07. - 25.07.2026<br>2.724 € 3.405 € |
| 25.07. - 01.08.2026<br>2.724 € 3.405 € | 05.08. - 13.08.2026<br>NOT AVAILABLE   | 19.08. - 30.08.2026<br>NOT AVAILABLE   | 05.09. - 12.09.2026<br>NOT AVAILABLE   |
| 12.09. - 19.09.2026<br>NOT AVAILABLE   | 21.09. - 02.10.2026<br>NOT AVAILABLE   | 06.10. - 11.10.2026<br>NOT AVAILABLE   | 17.10. - 24.10.2026<br>5.060 €         |
| 24.10. - 31.10.2026<br>4.221 € 4.690 € | 31.10. - 07.11.2026<br>4.928 € 5.475 € | 07.11. - 14.11.2026<br>4.919 € 5.465 € | 17.11. - 08.12.2026<br>NOT AVAILABLE   |



WEBSITE

[www.plujeme.cz](http://www.plujeme.cz)



E-MAIL

[info@plujeme.cz](mailto:info@plujeme.cz)



PHONE

+420 720 755 085



MOBILE

+420 777 170 276



PLUJEME RÁDI S.R.O.

Dlouhá 730/35, 11000 Praha 1 – Staré Město, Czech Republic

## PRICE AND AVAILABILITY

|   |   |   |   |
|---|---|---|---|
| 12.12. - 19.12.2026<br><b>2.696 €</b> 2.995 € | 19.12. - 26.12.2026<br><b>3.753 €</b> 4.170 € | 02.01. - 09.01.2027<br><b>4.086 €</b> 4.540 € | 09.01. - 16.01.2027<br><b>3.420 €</b> 3.800 € |
| 22.01. - 29.01.2027<br>NOT AVAILABLE          | 30.01. - 06.02.2027<br><b>3.911 €</b> 4.345 € | 06.02. - 13.02.2027<br><b>4.401 €</b> 4.890 € | 13.02. - 20.02.2027<br><b>4.527 €</b> 5.030 € |
| 20.02. - 27.02.2027<br><b>4.649 €</b> 5.165 € | 27.02. - 06.03.2027<br><b>4.649 €</b> 5.165 € | 06.03. - 13.03.2027<br><b>4.887 €</b> 5.430 € | 13.03. - 20.03.2027<br><b>4.887 €</b> 5.430 € |
| 20.03. - 27.03.2027<br><b>4.887 €</b> 5.430 € | 27.03. - 03.04.2027<br><b>5.049 €</b> 5.610 € | 03.04. - 10.04.2027<br><b>5.049 €</b> 5.610 € | 10.04. - 17.04.2027<br><b>5.049 €</b> 5.610 € |
| 17.04. - 24.04.2027<br><b>5.049 €</b> 5.610 € | 24.04. - 01.05.2027<br><b>4.451 €</b> 4.945 € | 02.05. - 31.12.2098<br>NOT AVAILABLE          |   |



WEBSITE

[www.plujeme.cz](http://www.plujeme.cz)



E-MAIL

[info@plujeme.cz](mailto:info@plujeme.cz)



PHONE

+420 720 755 085



MOBILE

+420 777 170 276



PLUJEME RÁDI S.R.O.

Dlouhá 730/35, 11000 Praha 1 – Staré Město, Czech Republic