

DUFOUR 460 GL

GRIEG (2017)

Sailing yacht Dufour 460 GL GRIEG, built in 2017 is anchored in the **La Paz, Costa Baja Marina, Baja California Sur, Mexico**. It has **4 cabins**, can accommodate **8 + 2 people** and has **4 toilets**. Bed linen and kitchen equipment are included in the price.

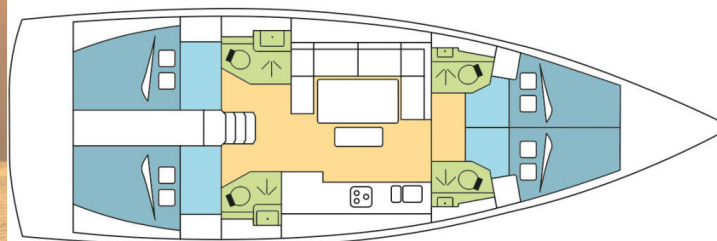

YACHT SPECIFICATIONS

Yacht Base

La Paz, Costa Baja Marina, Mexico

Yacht ID

12078

Brands

Dufour

Yacht name

GRIEG

Production year

2017

Length

46 ft

Cabins

4

Berths

8 + 2

Max Persons

10

WC

4

Engine

1 x 75 HP

Fuel tank

250 l



WEBSITE

www.plujeme.cz



PHONE

+420 720 755 085



MOBILE

+420 777 170 276



E-MAIL

info@plujeme.cz



PLUJEME RÁDI S.R.O.

Dlouhá 730/35, 11000 Praha 1 – Staré Město, Czech Republic

STANDARD YACHT EQUIPMENT

Comfort	Cockpit cushions
Deck	Bimini top, Cockpit table, Cockpit/stern, outside shower, Dinghy, Outboard engine, Sprayhood, Swimming ladder
Entertainment	Outdoor speakers, Radio
Galley	Oven, Refrigerator, Stove
Interior	Convertible table, Convertible table in salon, Electric fans in cabins
Navigation	Autopilot, Depthsounder, GPS chart plotter, Speedometer (Speed log), Wind instrument/Anemometer
Safety	VHF radio
Sails	Lazy bag, Lazy jacks, Self tailing (manual) winch
Yacht electrics	220V socket, Battery charger, Heating, Inverter, Shore connection 220 V, WC pump



WEBSITE

www.plujeme.cz



PHONE

+420 720 755 085



MOBILE

+420 777 170 276



E-MAIL

info@plujeme.cz



PLUJEME RÁDI S.R.O.

Dlouhá 730/35, 11000 Praha 1 – Staré Město, Czech Republic





SERVICES

SELECTED SERVICES	OBLIGATORY	PAYMENT TYPE	PRICE
<p>Environmental Sanitation Fee (Payable at the base)</p> <p>Season: 2026 Exotic. Municipal fee since January 1, 2026, created to finance environmental protection actions, waste managements & conservation of the municipality's natural environment. It applies to recreational or sports boat rental services operating within the municipality of La Paz</p>	Yes	per day	3,04 €
<p>Essentials pack (Payable now)</p> <p>Season: 2026 Exotic. INCLUDED: Damage waiver (covering damages) with reduced security deposit addressed specifically to blocked toilets, unpaid fuel, lost equipment, unpaid fees & fines, and returning the boat in an extremely dirty state. // starter pack – (1 gallon water or 4 bottles of 1.5L, 1 bottle of disinfectant, 1 small bottle of washing up liquid, 1 dish cloth, 1 sponge, garbage bags, 1 roll of paper towels, 1 box of matches, 1 roll of toilet paper in each head)// final cleaning // 1 set of bed sheets & towels, dinghy, outboard engine & initial supply of fuel, gas and water tanks // DYC assistance guarantee // 1st & last night in the marina /// NOT INCLUDED: refuelling, gas & water consumption at end of charter, taxes if any, handling fees & additional equipment deposit.</p>	Yes	per booking	765,00 €
<p>Handling fees (Payable now)</p> <p>Season: 2026 Exotic.</p>	Yes	per booking	35,00 €
<p>National parks permit (Payable at the base)</p> <p>Season: 2026 Exotic. Required for access to Balandra Bay and Espiritu Santo Island, as mandated by CONANP. Each guest must wear a wristband daily to comply with regulations.</p>	Yes	per guest/night	8,00 €
<p>Preparation fee (Payable now)</p> <p>Season: 2026 Exotic. INCLUDED: starter pack – (1 gallon water or 4 bottles of 1.5L, 1 bottle of disinfectant, 1 small bottle of washing up liquid, 1 dish cloth, 1 sponge, garbage bags, 1 roll of paper towels, 1 box of matches, 1 roll of toilet paper in each head)// final cleaning // 1 set of bed sheets / cabin & 1 set of towels / pax, dinghy, outboard engine & initial supply of fuel, gas and water tanks // DYC assistance guarantee // 1st & last night in the marina // NOT INCLUDED: refuelling, gas & water consumption at end of charter, taxes if any, handling fees & additional equipment deposit.</p>	Yes	per booking	355,00 €

Crew change (Payable now)	No	per booking	250,00 €
Season: 2026 Exotic. Any crew change during the charter is subject to € 250.- additional cost. The charge includes administration cost, change of bed linen and towels and one night at DYC ponton (marina fee included only if the same base than start base). It doesn't include cleaning, nor new transit log where applicable.			
Damage waiver (Payable now)	No	per night	65,00 €
Season: 2026 Exotic. Damage waiver limits your liability to the reduced Security Deposit . Mandatory when skipper is added. Price is per night of the charter (minimum value of 7 nights & a maximum value of 21 nights) Not applicable for 4+ weeks charters , nor Regattas/Races.			
Early boarding/check-in (Payable now)	No	per booking	360,00 €
Season: 2026 Exotic. EB (boat only) - 14:00 h / 2 PM starting time of boat's delivery // limited number of early boardings on same departure day			
Early boarding/check-in (Payable now)	No	per booking	530,00 €
Season: 2026 Exotic. EB boat + extra fee skipper - 14:00 h / 2 PM starting time of boat's delivery // limited number of early boardings on same departure day			
Early boarding/check-in (Payable now)	No	per booking	665,00 €
Season: 2026 Exotic. EB + extra fee Skipper & Hostes - 14:00 h / 2 PM starting time of boat's delivery // limited number of early boardings on same departure day			
Electric & Water consumption in the Marinas (Payable at the base)	No	per booking	22,00 €
Season: 2026 Exotic. Electric & Water consumption based on 2 nights on our dock (base will confirm the amount to pay locally depending on nights spent on dock)			
Extra set of linen (choose how many) (Payable now)	No	per booking	15,00 €
Season: 2026 Exotic. Extra set of linen : 15 € 1 set of linen (2 sheets & 2 pillow case) - to be updated manually			
Extra set of towels (choose how many) (Payable now)	No	per booking	10,00 €
Season: 2026 Exotic. Extra set of towels: 10 € 1 set of towels (1 face & 1 bath towel) - to be updated manually			
Final cleaning (Payable now)	No	per booking	260,00 €
Season: 2026 Exotic. included in Essentials pack			
Final cleaning (Payable now)	No	per booking	260,00 €
Season: 2026 Exotic. included in Essentials pack			

<p>Full board 1-4 pax (number of guests to update manually) (Payable now)</p> <p>Season: 2026 Exotic. only available if cook is booked on board as the cook will do the provisioning based on client's preference. Includes breakfast, lunch & dinner + the crew's food. Does not included alcoholic drinks</p>	No	per guest/day	60,00 €
<p>Full board 5-12 pax (number of guests to update manually) (Payable now)</p> <p>Season: 2026 Exotic. only available if cook is booked on board as the cook will do the provisioning based on client's preference. Includes breakfast, lunch & dinner + the crew's food. Does not included alcoholic drinks</p>	No	per guest/day	55,00 €
<p>Hostess/Cook (Payable now)</p> <p>Season: 2026 Exotic. + provisioning, Crew on board must have their own toilets/ showers. If either a skipper or a hostess/cook is on board, 1 double cabin will be required for him/her. If both a skipper and a hostess/cook are on board, 1 double cabin and 1 forepeak cabin will be required for them. Exceptions exists for specific layouts, Sales Agents will provide more details about the different boat models</p>	No	per night	135,00 €
<p>Hostess/Cook (Payable now)</p> <p>Season: 2026 Exotic. + provisioning, Crew on board must have their own toilets/ showers. If either a skipper or a hostess/cook is on board, 1 double cabin will be required for him/her. If both a skipper and a hostess/cook are on board, 1 double cabin and 1 forepeak cabin will be required for them. Exceptions exists for specific layouts, Sales Agents will provide more details about the different boat models</p>	No	per night	135,00 €
<p>Hostess/Cook (Payable now)</p> <p>Season: 2026 Exotic. + provisioning, Crew on board must have their own toilets/ showers. If either a skipper or a hostess/cook is on board, 1 double cabin will be required for him/her. If both a skipper and a hostess/cook are on board, 1 double cabin and 1 forepeak cabin will be required for them. Exceptions exists for specific layouts, Sales Agents will provide more details about the different boat models</p>	No	per night	150,00 €
<p>Regatta surcharge (Payable now)</p> <p>Season: 2026 Exotic. all the regattas apart of ASW (different regatta surcharge for ASW) // A special race deposit need to be doubled manually once the regatta surcharge is added.</p>	No	per booking	0,00 €
<p>Same day briefing (Payable now)</p> <p>Season: 2026 Exotic. Same day briefing starting between 5 & 5.30pm (departure following morning)</p>	No	per booking	120,00 €

Skipper (Payable now)	No	per night	170,00 €
Season: 2026 Exotic. + provisioning, Crew on board must have their own toilets/ showers. If either a skipper or a hostess/cook is on board, 1 double cabin will be required for him/her. If both a skipper and a hostess/cook are on board, 1 double cabin and 1 forepeak cabin will be required for them. Exceptions exists for specific layouts, Sales Agents will provide more details about the different boat models			
Skipper (Payable now)	No	per night	170,00 €
Season: 2026 Exotic. + provisioning, Crew on board must have their own toilets/ showers. If either a skipper or a hostess/cook is on board, 1 double cabin will be required for him/her. If both a skipper and a hostess/cook are on board, 1 double cabin and 1 forepeak cabin will be required for them. Exceptions exists for specific layouts, Sales Agents will provide more details about the different boat models			
Skipper (Payable now)	No	per night	185,00 €
Season: 2026 Exotic. + provisioning, Crew on board must have their own toilets/ showers. If either a skipper or a hostess/cook is on board, 1 double cabin will be required for him/her. If both a skipper and a hostess/cook are on board, 1 double cabin and 1 forepeak cabin will be required for them. Exceptions exists for specific layouts, Sales Agents will provide more details about the different boat models			
Starter pack (Payable now)	No	per booking	50,00 €
Season: 2026 Exotic. included in Essentials pack (The pack includes: 1 gallon water (or 4 bottles of 1.5L), 1 bottle of disinfectant, 1 small bottle of washing up liquid, 1 dish cloth, 1 sponge, garbage bags, 1 roll of paper towels, 1 box of matches, 1 roll of toilet paper in each head			
Transfer (Payable now)	No	one-way	40,00 €
Season: 2026 Exotic. OW La Paz airport /base TAXI 1-4 pax			
Transfer (Payable now)	No	round trip	80,00 €
Season: 2026 Exotic. RT- La Paz airport /base TAXI 1-4 pax			
Transfer (Payable now)	No	one-way	118,00 €
Season: 2026 Exotic. OW La Paz airport /base VAN 1-10 pax			
Transfer (Payable now)	No	round trip	236,00 €
Season: 2026 Exotic. RT - La Paz airport /base VAN 1-10 pax			

Transfer (Payable now)		WEBSITE www.plujeme.cz		PHONE +420 720 755 085		MOBILE round trip +420 777 170 276	796,00 €
Season: 2026 Exotic. RT Los cabos airport / base VAN 1-10 pax		E-MAIL info@plujeme.cz		PLUJEME RÁDI S.R.O. Dlouhá 730/35, 11000 Praha 1 – Staré Město, Czech Republic			



ADDITIONAL EXTRAS

EXTRA	OBLIGATORY	PAYMENT TYPE	PRICE
Kayak single (Payable now) Season: 2026 Exotic. price per day - Payable now	No	per night	15,00 €
Kayak tandem (Payable now) Season: 2026 Exotic. price per day - Payable now	No	per night	15,00 €
Railing net (Safety net) (Payable now) Season: 2026 Exotic. net is supplied but not installed - Payable now	No	per booking	230,00 €
Stand up paddle (SUP) (Payable now) Season: 2026 Exotic. price per day - Payable now	No	per night	15,00 €



WEBSITE

www.plujeme.cz



E-MAIL

info@plujeme.cz



PHONE

+420 720 755 085



MOBILE

+420 777 170 276



PLUJEME RÁDI S.R.O.

Dlouhá 730/35, 11000 Praha 1 – Staré Město, Czech Republic

PRICE AND AVAILABILITY

25.04. - 02.05.2026 3.502 € 4.120 €	02.05. - 09.05.2026 2.797 € 3.290 €	09.05. - 16.05.2026 2.784 € 3.275 €	20.05. - 27.05.2026 NOT AVAILABLE
30.05. - 06.06.2026 2.631 € 3.095 €	06.06. - 13.06.2026 2.622 € 3.085 €	13.06. - 20.06.2026 2.797 € 3.290 €	20.06. - 27.06.2026 NOT AVAILABLE
27.06. - 04.07.2026 2.682 € 3.155 €	04.07. - 11.07.2026 2.682 € 3.155 €	11.07. - 18.07.2026 2.682 € 3.155 €	18.07. - 25.07.2026 2.682 € 3.155 €
25.07. - 01.08.2026 2.682 € 3.155 €	01.08. - 08.08.2026 2.682 € 3.155 €	08.08. - 15.08.2026 2.100 € 2.470 €	15.08. - 22.08.2026 2.100 € 2.470 €
22.08. - 29.08.2026 2.100 € 2.470 €	29.08. - 05.09.2026 2.470 €	05.09. - 12.09.2026 2.470 €	12.09. - 19.09.2026 2.470 €
19.09. - 26.09.2026 2.470 €	26.09. - 03.10.2026 2.470 €	03.10. - 10.10.2026 2.470 €	10.10. - 17.10.2026 NOT AVAILABLE
17.10. - 24.10.2026 ON OPTION	24.10. - 31.10.2026 ON OPTION	01.11. - 15.11.2026 NOT AVAILABLE	21.11. - 28.11.2026 4.392 € 4.880 €
28.11. - 05.12.2026 4.167 € 4.630 €			



WEBSITE
www.plujeme.cz



E-MAIL
info@plujeme.cz



PHONE
+420 720 755 085



PLUJEME RÁDI S.R.O.
Dlouhá 730/35, 11000 Praha 1 – Staré Město, Czech Republic



MOBILE
+420 777 170 276

PRICE AND AVAILABILITY

05.12. - 12.12.2026 4.068 € 4.520 €	12.12. - 19.12.2026 3.497 € 3.885 €	19.12. - 26.12.2026 3.906 € 4.340 €	02.01. - 09.01.2027 2.939 € 3.265 €
09.01. - 16.01.2027 2.939 € 3.265 €	16.01. - 23.01.2027 2.939 € 3.265 €	23.01. - 30.01.2027 3.020 € 3.355 €	30.01. - 06.02.2027 3.303 € 3.670 €
06.02. - 13.02.2027 3.483 € 3.870 €	13.02. - 20.02.2027 3.636 € 4.040 €	20.02. - 27.02.2027 3.852 € 4.280 €	27.02. - 06.03.2027 3.852 € 4.280 €
06.03. - 13.03.2027 4.032 € 4.480 €	13.03. - 20.03.2027 4.032 € 4.480 €	20.03. - 27.03.2027 4.496 € 4.995 €	27.03. - 03.04.2027 4.973 € 5.525 €
03.04. - 10.04.2027 4.973 € 5.525 €	10.04. - 17.04.2027 4.532 € 5.035 €	17.04. - 24.04.2027 4.532 € 5.035 €	24.04. - 01.05.2027 4.532 € 5.035 €
01.05. - 08.05.2027 4.073 € 4.525 €	08.05. - 15.05.2027 3.677 € 4.085 €	15.05. - 22.05.2027 3.398 € 3.775 €	22.05. - 29.05.2027 3.398 € 3.775 €
29.05. - 05.06.2027 3.087 € 3.430 €	05.06. - 12.06.2027 3.087 € 3.430 €	12.06. - 19.06.2027 2.961 € 3.290 €	19.06. - 26.06.2027 2.840 € 3.155 €
26.06. - 03.07.2027 2.840 € 3.155 €	03.07. - 10.07.2027 2.840 € 3.155 €	10.07. - 17.07.2027 2.840 € 3.155 €	17.07. - 24.07.2027 2.840 € 3.155 €
24.07. - 31.07.2027 2.840 € 3.155 €	31.07. - 07.08.2027 2.840 € 3.155 €		



WEBSITE

www.plujeme.cz



E-MAIL

info@plujeme.cz



PHONE

+420 720 755 085



MOBILE

+420 777 170 276



PLUJEME RÁDI S.R.O.

Dlouhá 730/35, 11000 Praha 1 – Staré Město, Czech Republic

PRICE AND AVAILABILITY

07.08. - 14.08.2027 2.718 € 3.020 €	14.08. - 21.08.2027 2.718 € 3.020 €	21.08. - 28.08.2027 2.718 € 3.020 €	28.08. - 04.09.2027 2.718 € 3.020 €
04.09. - 11.09.2027 2.718 € 3.020 €	11.09. - 18.09.2027 2.718 € 3.020 €	18.09. - 25.09.2027 2.718 € 3.020 €	25.09. - 02.10.2027 2.718 € 3.020 €
02.10. - 09.10.2027 2.718 € 3.020 €	09.10. - 16.10.2027 3.006 € 3.340 €	16.10. - 23.10.2027 3.492 € 3.880 €	23.10. - 30.10.2027 3.920 € 4.355 €
30.10. - 06.11.2027 4.352 € 4.835 €	06.11. - 13.11.2027 4.352 € 4.835 €	13.11. - 20.11.2027 4.352 € 4.835 €	20.11. - 27.11.2027 4.392 € 4.880 €
27.11. - 04.12.2027 4.167 € 4.630 €	04.12. - 11.12.2027 3.875 € 4.305 €	11.12. - 18.12.2027 3.497 € 3.885 €	18.12. - 25.12.2027 3.906 € 4.340 €



WEBSITE

www.plujeme.cz



E-MAIL

info@plujeme.cz



PHONE

+420 720 755 085



MOBILE

+420 777 170 276



PLUJEME RÁDI S.R.O.

Dlouhá 730/35, 11000 Praha 1 – Staré Město, Czech Republic