

LAGOON 52 F

CARACARA (2019)

Catamaran Lagoon 52 F CARACARA, built in 2019 is anchored in the Trogir, Yachtclub Seget (Marina Baotić), Split region, Croatia. It has 6 + 2 cabins, can accommodate 12 + 2 people and has 6 toilets. Bed linen and kitchen equipment are included in the price.

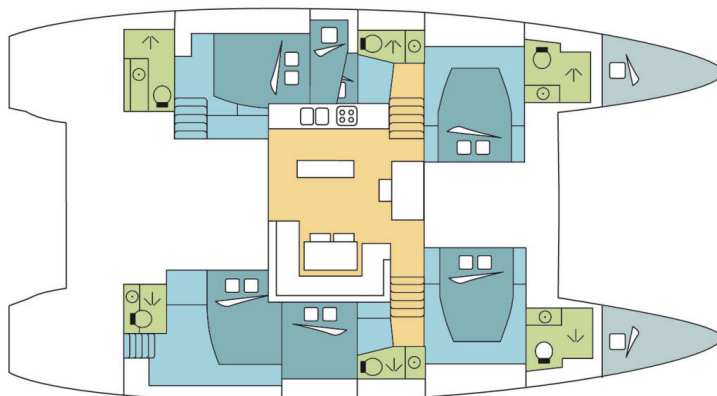

YACHT SPECIFICATIONS

Yacht Base

Trogir, Yachtclub Seget (Marina Baotić), Croatia

Yacht ID

12007

Brands

Lagoon

Yacht name

CARACARA

Production year

2019

Length

52 ft

Cabins

6 + 2

Berths

12 + 2

Max Persons

14

WC

6

Engine

2 x 80 HP

Fuel tank

992 l



WEBSITE

www.plujeme.cz



PHONE

+420 720 755 085



MOBILE

+420 777 170 276



E-MAIL

info@plujeme.cz



PLUJEME RÁDI S.R.O.

Dlouhá 730/35, 11000 Praha 1 – Staré Město, Czech Republic

STANDARD YACHT EQUIPMENT

Comfort	Cockpit cushions
Deck	Bimini top, Cockpit fridge, Cockpit table, Cockpit/stern, outside shower, Davit, Dinghy, Electric anchor windlass, Flybridge, Swimming ladder
Entertainment	Outdoor speakers, Radio
Galley	Freezer, Hot water, Oven, Refrigerator, Stove
Interior	Electric fans in cabins, Electric toilet
Navigation	Autopilot, Depthsounder, GPS chart plotter - cockpit, Speedometer (Speed log), Wind instrument/Anemometer
Safety	VHF radio
Sails	Electric winch, Lazy bag, Lazy jacks, Self tailing (manual) winch
Yacht electrics	220V socket, Air Conditioning, Battery charger, Generator, Inverter, USB sockets, Watermaker - desalinator



WEBSITE

www.plujeme.cz



E-MAIL

info@plujeme.cz



PHONE

+420 720 755 085



MOBILE

+420 777 170 276



PLUJEME RÁDI S.R.O.

Dlouhá 730/35, 11000 Praha 1 – Staré Město, Czech Republic

SERVICES

SELECTED SERVICES	OBLIGATORY	PAYMENT TYPE	PRICE
Handling fees (Payable now) Season: 2026.	Yes	per booking	20,00 €
Preparation fee (Payable now) Season: 2026. INCLUDED: starter pack – (1 gallon water or 4 bottles of 1.5L, 1 bottle of disinfectant, 1 small bottle of washing up liquid, 1 dish cloth, 1 sponge, garbage bags, 1 roll of paper towels, 1 box of matches, 1 roll of toilet paper in each head) // final cleaning // 1 set of bed sheets / cabin & 1 set of towels / pax, dinghy, outboard engine & initial supply of fuel, gas and water tanks // DYC assistance guarantee // 1st & last night in the marina // NOT INCLUDED: refuelling, gas & water consumption at end of charter, taxes if any, handling fees & additional equipment deposit.	Yes	per booking	425,00 €
Tourist tax (Payable at the base) Season: 2026. Payment by credit card only, no cash	Yes	per guest/day	1,33 €
Crew change (Payable now) Season: 2026. Any crew change during the charter is subject to € 250.- additional cost. The charge includes administration cost, change of bed linen and towels and one night at DYC ponton (marina fee included only if the same base than start base). It doesn't include cleaning, nor new transit log where applicable.	No	per booking	250,00 €
Damage waiver (Payable now) Season: 2026. Damage waiver limits your liability to the reduced Security Deposit . Mandatory when skipper is added. Price is per night of the charter (minimum value of 7 nights & a maximum value of 21 nights). Not applicable for 4+ weeks charters , nor Regattas/Races.	No	per night	65,00 €
Early boarding/check-in (Payable now) Season: 2026. EB (boat only) - 13:00h, starting time of boat's delivery // limited number of early boardings on same departure day	No	per booking	550,00 €
Early boarding/check-in (Payable now) Season: 2026. EB + extra fee skipper - 13:00h, starting time of boat's delivery // limited number of early boardings on same departure day	No	per booking	690,00 €
Early boarding/check-in (Payable now) Season: 2026. EB + extra fee Skipper & Hostess - 13:00h, starting time of boat's delivery // limited number of early boardings on same departure day	No	per booking	820,00 €

Electric & Water consumption in the Marinas (Payable at the base) Season: 2026. Electric & Water consumption based on 2 nights on our dock (base will confirm the amount to pay locally depending on nights spent on dock)	No	per booking	52,00 €
Extra cleaning (Payable now) Season: 2026. Optional Additional cleaning	No	per booking	375,00 €
Extra set of linen (choose how many) (Payable now) Season: 2026. Extra set of linen : 15 € 1 extra set of linen (2 sheets & 2 pillow case) - to be updated manually	No	per booking	15,00 €
Extra set of towels (choose how many) (Payable now) Season: 2026. Extra set of towels: 10 € 1 extra set of towels (1 face & 1 bath towel) - to be updated manually	No	per booking	10,00 €
Full board 1-4 pax (number of guests to update manually) (Payable now) Season: 2026. only available if cook is booked on board as the cook will do the provisioning based on client's preference. Includes breakfast, lunch & dinner + the crew's food. Does not included alcoholic drinks	No	per guest/day	60,00 €
Full board 5-12 pax (number of guests to update manually) (Payable now) Season: 2026. only available if cook is booked on board as the cook will do the provisioning based on client's preference. Includes breakfast, lunch & dinner + the crew's food. Does not included alcoholic drinks	No	per guest/day	55,00 €
Half board 1-4 pax (number of guests to update manually) (Payable now) Season: 2026. only available if cook is booked on board as the cook will do the provisioning based on client's preference. Includes breakfast & lunch OR dinner + the crew's food. Does not included alcoholic drinks	No	per guest/day	50,00 €
Half board 5-12 pax (number of guests to update manually) (Payable now) Season: 2026. only available if cook is booked on board as the cook will do the provisioning based on client's preference. Includes breakfast & lunch OR dinner + the crew's food. Does not included alcoholic drinks	No	per guest/day	45,00 €
Hostess/Cook (Payable now) Season: 2026. + provisioning, Crew on board must have their own toilets/showers. If either a skipper or a hostess/cook is on board, 1 double cabin will be required for him/her. If both a skipper and a hostess/cook are on board, 1 double cabin and 1 forepeak cabin will be required for them. Exceptions exists for specific layouts, Sales Agents will provide more details about the different boat models	No	per night	220,00 €

<p>Hostess/Cook (Payable now)</p> <p>Season: 2026. + provisioning, Crew on board must have their own toilets/showers. If either a skipper or a hostess/cook is on board, 1 double cabin will be required for him/her. If both a skipper and a hostess/cook are on board, 1 double cabin and 1 forepeak cabin will be required for them. Exceptions exists for specific layouts, Sales Agents will provide more details about the different boat models</p>	No	per night	220,00 €
<p>Hostess/Cook (Payable now)</p> <p>Season: 2026. + provisioning, Crew on board must have their own toilets/showers. If either a skipper or a hostess/cook is on board, 1 double cabin will be required for him/her. If both a skipper and a hostess/cook are on board, 1 double cabin and 1 forepeak cabin will be required for them. Exceptions exists for specific layouts, Sales Agents will provide more details about the different boat models</p>	No	per night	245,00 €
<p>Regatta surcharge (Payable now)</p> <p>Season: 2026. A special race deposit need to be doubled manually once the regatta surcharge is added.</p>	No	per booking	0,00 €
<p>Skipper (Payable now)</p> <p>Season: 2026. + provisioning, Crew on board must have their own toilets/showers. If either a skipper or a hostess/cook is on board, 1 double cabin will be required for him/her. If both a skipper and a hostess/cook are on board, 1 double cabin and 1 forepeak cabin will be required for them. Exceptions exists for specific layouts, Sales Agents will provide more details about the different boat models</p>	No	per night	240,00 €
<p>Skipper (Payable now)</p> <p>Season: 2026. + provisioning, Crew on board must have their own toilets/showers. If either a skipper or a hostess/cook is on board, 1 double cabin will be required for him/her. If both a skipper and a hostess/cook are on board, 1 double cabin and 1 forepeak cabin will be required for them. Exceptions exists for specific layouts, Sales Agents will provide more details about the different boat models</p>	No	per night	240,00 €
<p>Skipper (Payable now)</p> <p>Season: 2026. + provisioning, Crew on board must have their own toilets/showers. If either a skipper or a hostess/cook is on board, 1 double cabin will be required for him/her. If both a skipper and a hostess/cook are on board, 1 double cabin and 1 forepeak cabin will be required for them. Exceptions exists for specific layouts, Sales Agents will provide more details about the different boat models</p>	No	per night	265,00 €
<p>Transfer (Payable now)</p> <p>Season: 2026. RT - Split Airport / Base 1 - 4 pax</p>	No	round trip	82,00 €

Transfer (Payable now)

No

round trip

96,00 €

Season: 2026. RT - Split Airport / Base 5 - 8 pax

WI-FI Internet connection on boat (Payable now)

No

per week

32,00 €

Season: 2026. Unlimited - included in price



WEBSITE

www.plujeme.cz



E-MAIL

info@plujeme.cz



PHONE

+420 720 755 085



MOBILE

+420 777 170 276



PLUJEME RÁDI S.R.O.

Dlouhá 730/35, 11000 Praha 1 - Staré Město, Czech Republic

ADDITIONAL EXTRAS

EXTRA	OBLIGATORY	PAYMENT TYPE	PRICE
Kayak single (Payable now) Season: 2026. Price per day - Payable now	No	per night	15,00 €
Kayak single (Payable now) Season: 2026. Price per day - Payable now	No	per night	15,00 €
Outboard engine 8 & 9,8 HP (Payable now) Season: 2026. Subject to Availability ; 8/9hp. Dinghy not suitable in any case for waterski or wakeboard. - Payable now	No	per day	35,00 €
Railing net (Safety net) (Payable now) Season: 2026. net is supplied but not installed - Payable now	No	per booking	300,00 €
Stand up paddle (SUP) (Payable now) Season: 2026. Price per day - Payable now	No	per night	15,00 €



WEBSITE

www.plujeme.cz



E-MAIL

info@plujeme.cz



PHONE

+420 720 755 085



MOBILE

+420 777 170 276



PLUJEME RÁDI S.R.O.

Dlouhá 730/35, 11000 Praha 1 – Staré Město, Czech Republic

PRICE AND AVAILABILITY

02.05. - 16.05.2026 NOT AVAILABLE	16.05. - 23.05.2026 5.150 € 6.435 €	23.05. - 30.05.2026 5.150 € 8.800 €	30.05. - 06.06.2026 NOT AVAILABLE
06.06. - 13.06.2026 NOT AVAILABLE	13.06. - 20.06.2026 NOT AVAILABLE	20.06. - 27.06.2026 NOT AVAILABLE	27.06. - 04.07.2026 NOT AVAILABLE
04.07. - 11.07.2026 NOT AVAILABLE	11.07. - 18.07.2026 15.181 € 17.860 €	18.07. - 25.07.2026 NOT AVAILABLE	25.07. - 01.08.2026 NOT AVAILABLE
01.08. - 08.08.2026 14.692 € 18.365 €	08.08. - 15.08.2026 14.632 € 18.290 €	15.08. - 22.08.2026 13.848 € 17.310 €	22.08. - 29.08.2026 NOT AVAILABLE
29.08. - 05.09.2026 NOT AVAILABLE	05.09. - 12.09.2026 15.270 €	12.09. - 19.09.2026 13.060 €	19.09. - 03.10.2026 NOT AVAILABLE
03.10. - 10.10.2026 5.890 €	10.10. - 17.10.2026 4.475 €	17.10. - 24.10.2026 NOT AVAILABLE	24.10. - 31.10.2026 3.132 € 3.480 €
31.10. - 07.11.2026 3.132 € 3.480 €	07.11. - 14.11.2026 3.132 € 3.480 €	20.11. - 12.03.2027 NOT AVAILABLE	



WEBSITE

www.plujeme.cz



E-MAIL

info@plujeme.cz



PHONE

+420 720 755 085



MOBILE

+420 777 170 276



PLUJEME RÁDI S.R.O.

Dlouhá 730/35, 11000 Praha 1 – Staré Město, Czech Republic

PRICE AND AVAILABILITY

13.03. - 20.03.2027 2.925 € 3.250 €	20.03. - 27.03.2027 2.925 € 3.250 €	27.03. - 03.04.2027 3.362 € 3.735 €	03.04. - 10.04.2027 3.362 € 3.735 €
10.04. - 17.04.2027 3.551 € 3.945 €	17.04. - 24.04.2027 3.551 € 3.945 €	24.04. - 01.05.2027 4.586 € 5.095 €	01.05. - 08.05.2027 4.586 € 5.095 €
08.05. - 15.05.2027 5.040 € 5.600 €	15.05. - 22.05.2027 7.416 € 8.240 €	22.05. - 29.05.2027 9.936 € 11.040 €	29.05. - 05.06.2027 11.430 € 12.700 €
05.06. - 12.06.2027 12.929 € 14.365 €	12.06. - 19.06.2027 14.112 € 15.680 €	19.06. - 26.06.2027 14.711 € 16.345 €	26.06. - 03.07.2027 15.750 € 17.500 €
03.07. - 10.07.2027 17.528 € 19.475 €	10.07. - 17.07.2027 18.851 € 20.945 €	17.07. - 24.07.2027 18.851 € 20.945 €	24.07. - 31.07.2027 18.851 € 20.945 €
31.07. - 07.08.2027 20.390 € 22.655 €			



WEBSITE
www.plujeme.cz



E-MAIL
info@plujeme.cz



PHONE
+420 720 755 085



MOBILE
+420 777 170 276



PLUJEME RÁDI S.R.O.
Dlouhá 730/35, 11000 Praha 1 – Staré Město, Czech Republic

PRICE AND AVAILABILITY

07.08. - 14.08.2027 20.390 € 22.655 €	14.08. - 21.08.2027 18.851 € 20.945 €	21.08. - 28.08.2027 13.239 € 14.710 €	28.08. - 04.09.2027 12.582 € 13.980 €
04.09. - 11.09.2027 13.185 € 14.650 €	11.09. - 18.09.2027 12.735 € 14.150 €	18.09. - 25.09.2027 10.386 € 11.540 €	25.09. - 02.10.2027 8.177 € 9.085 €
02.10. - 09.10.2027 5.193 € 5.770 €	09.10. - 16.10.2027 4.019 € 4.465 €	16.10. - 23.10.2027 3.654 € 4.060 €	23.10. - 30.10.2027 3.132 € 3.480 €
30.10. - 06.11.2027 2.984 € 3.315 €	06.11. - 13.11.2027 2.984 € 3.315 €	13.11. - 20.11.2027 2.984 € 3.315 €	20.11. - 27.11.2027 2.984 € 3.315 €
27.11. - 04.12.2027 2.984 € 3.315 €	04.12. - 11.12.2027 2.984 € 3.315 €	11.12. - 18.12.2027 2.984 € 3.315 €	18.12. - 25.12.2027 2.984 € 3.315 €



WEBSITE

www.plujeme.cz



E-MAIL

info@plujeme.cz



PHONE

+420 720 755 085



MOBILE

+420 777 170 276



PLUJEME RÁDI S.R.O.

Dlouhá 730/35, 11000 Praha 1 – Staré Město, Czech Republic