

# BALI CATSPACE

Pinnacle Cat (2022)

Catamaran Bali Catspace Pinnacle Cat, built in 2022 is anchored in the **BVI, Hodge's Creek Marina, British Virgin Islands, British Virgin Islands**. It has **4 cabins**, can accommodate **8 + 2 people** and has **4 toilets**. Bed linen and kitchen equipment are included in the price.

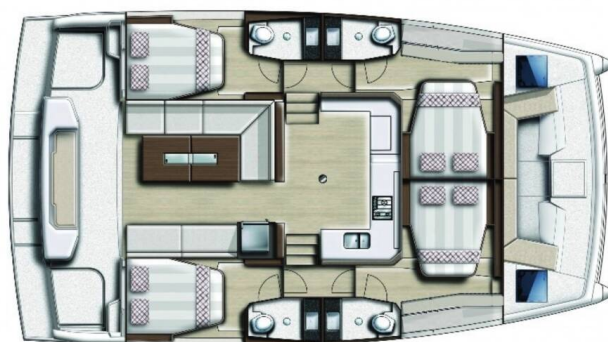

## YACHT SPECIFICATIONS

Yacht Base

**BVI, Hodge's Creek Marina, British Virgin Islands**

Yacht ID

**11675**

Brands

**Catana**

Yacht name

**Pinnacle Cat**

Production year

**2022**

Length

**40 ft**

Cabins

**4**

Berths

**8 + 2**

Max Persons

**10**

WC

**4**

Engine

**2 x 40 HP**

Fuel tank

**397 l**



**WEBSITE**

[www.plujeme.cz](http://www.plujeme.cz)



**PHONE**

+420 720 755 085



**MOBILE**

+420 777 170 276



**E-MAIL**

[info@plujeme.cz](mailto:info@plujeme.cz)



**PLUJEME RÁDI S.R.O.**

Dlouhá 730/35, 11000 Praha 1 – Staré Město, Czech Republic

## STANDARD YACHT EQUIPMENT

Comfort	<b>Cockpit cushions, Deck cushions, Forward cockpit cushions, Helmsman seat cushions</b>
Deck	<b>Bimini top, Cockpit/stern, outside shower, Davit, Electric anchor windlass, Grill/Barbecue/Plancha, Seats for aft bench, Swimming ladder</b>
Galley	<b>Oven, Refrigerator, Stove</b>
Interior	<b>Electric fans in cabins, Salon table</b>
Navigation	<b>Autopilot, GPS chart plotter</b>
Safety	<b>Extra water tank, VHF radio</b>
Sails	<b>Lazy bag</b>
Yacht electrics	<b>Air Conditioning, Battery charger, Generator, Inverter, Service batteries, Watermaker - desalinator</b>



#### WEBSITE

[www.plujeme.cz](http://www.plujeme.cz)



#### E-MAIL

[info@plujeme.cz](mailto:info@plujeme.cz)



#### PHONE

+420 720 755 085



#### MOBILE

+420 777 170 276



#### PLUJEME RÁDI S.R.O.

Dlouhá 730/35, 11000 Praha 1 – Staré Město, Czech Republic

## SERVICES

SELECTED SERVICES	OBLIGATORY	PAYMENT TYPE	PRICE
<b>BVI Cruising Tax</b> (Payable now) <i>Season: 2026. BVI Cruising Permit Fee</i>	Yes	per guest/day	<b>4,00 €</b>
<b>Credit card surcharge</b> (Payable now) <i>Season: 2026. Waived if paying by wire transfer or Zelle</i>	Yes	per booking	<b>0,00 €</b>
<b>Damage waiver</b> (Payable now) <i>Season: 2026.</i>	Yes	per day	<b>50,00 €</b>
<b>Final cleaning</b> (Payable now) <i>Season: 2026.</i>	Yes	per booking	<b>299,00 €</b>
<b>National parks permit</b> (Payable now) <i>Season: 2026. Not to exceed 4 pax</i>	Yes	per week	<b>25,00 €</b>
<b>National parks permit</b> (Payable now) <i>Season: 2026. Not to exceed 6 pax</i>	Yes	per week	<b>35,00 €</b>
<b>National parks permit</b> (Payable now) <i>Season: 2026. Not to exceed 8 pax</i>	Yes	per week	<b>45,00 €</b>
<b>National parks permit</b> (Payable now) <i>Season: 2026. Not to exceed 10 pax</i>	Yes	per week	<b>55,00 €</b>
<b>National parks permit</b> (Payable now) <i>Season: 2026. Passengers in excess of 10, \$5 for each additional passengers</i>	Yes	per week	<b>60,00 €</b>
<b>National parks permit</b> (Payable now) <i>Season: 2026. Passengers in excess of 10, \$5 for each additional passengers</i>	Yes	per week	<b>65,00 €</b>
<b>National parks permit</b> (Payable now) <i>Season: 2026. Passengers in excess of 10, \$5 for each additional passengers</i>	Yes	per week	<b>70,00 €</b>
<b>National parks permit</b> (Payable now) <i>Season: 2026. Passengers in excess of 10, \$5 for each additional passengers</i>	Yes	per week	<b>75,00 €</b>

<b>Starter pack</b> (Payable now) <b>Season: 2026.</b>	Yes	per booking	<b>55,00 €</b>
<b>Visar</b> (Payable now) <b>Season: 2026.</b>	Yes	per person	<b>5,00 €</b>
<b>Cancellation fee</b> (Payable at the base) <b>Season: 2026.</b>	No	per booking	<b>599,00 €</b>
<b>CDW for Sleep Aboard</b> (Payable now) <b>Season: 2026.</b>	No	per booking	<b>74,00 €</b>
<b>Cook</b> (Payable now) <b>Season: 2026.</b> (Prepares meals exclusively with provisions supplied by the guest. Service does not include shopping, provisioning, or operational responsibilities. Standard gratuity and prepaid food allowance included. Cabin/head must be available. Non-refundable 45 days or less prior to departure.)	No	per day + food	<b>452,00 €</b>
<b>Cook</b> (Payable now) <b>Season: 2026.</b> (Prepares meals exclusively with provisions supplied by the guest. Service does not include shopping, provisioning, or operational responsibilities. Standard gratuity and prepaid food allowance included. Cabin/head must be available. Non-refundable 45 days or less prior to departure.)	No	per day + food	<b>452,00 €</b>
<b>Cook</b> (Payable now) <b>Season: 2026.</b> (Prepares meals exclusively with provisions supplied by the guest. Service does not include shopping, provisioning, or operational responsibilities. Standard gratuity and prepaid food allowance included. Cabin/head must be available. Non-refundable 45 days or less prior to departure.)	No	per day + food	<b>552,00 €</b>
<b>Holiday Surcharge</b> (Payable now) <b>Season: 2026.</b> \$100/day for Skipper + \$100/day for Chef	No	per day	<b>200,00 €</b>
<b>Late payment fee</b> (Payable now) <b>Season: 2026.</b>	No	per booking	<b>90,00 €</b>
<b>Sailing Instructor</b> (Payable now) <b>Season: 2026.</b> Standard gratuity and prepaid food allowance included. Cabin/head must be available. Non-refundable 45 days or less prior to departure.	No	per day + food	<b>472,00 €</b>

<b>Skipper</b> (Payable now)	No	per day + food	<b>452,00 €</b>
<b>Season: 2026.</b> Standard gratuity and prepaid food allowance included. Cabin/head must be available. Non-refundable 45 days or less prior to departure.			
<b>Skipper</b> (Payable now)	No	per day + food	<b>452,00 €</b>
<b>Season: 2026.</b> Standard gratuity and prepaid food allowance included. Cabin/head must be available. Non-refundable 45 days or less prior to departure.			
<b>Skipper</b> (Payable now)	No	per day + food	<b>552,00 €</b>
<b>Season: 2026.</b> Standard gratuity and prepaid food allowance included. Cabin/head must be available. Non-refundable 45 days or less prior to departure. Includes Holiday Surcharge - \$100/day for Skipper.			
<b>Sleep over before check in</b> (Payable now)	No	per booking	<b>0,00 €</b>
<b>Season: 2026.</b>			
<b>VIP Departure Service</b> (Payable now)	No	per person	<b>150,00 €</b>
<b>Season: 2026.</b>			
<b>VIP Fast track</b> (Payable now)	No	per person	<b>150,00 €</b>
<b>Season: 2026.</b>			
<b>WI-FI Internet connection on boat</b> (Payable now)	No	per day	<b>25,00 €</b>
<b>Season: 2026.</b>			



**WEBSITE**

[www.plujeme.cz](http://www.plujeme.cz)



**E-MAIL**

[info@plujeme.cz](mailto:info@plujeme.cz)



**PHONE**

+420 720 755 085



**MOBILE**

+420 777 170 276



**PLUJEME RÁDI S.R.O.**

Dlouhá 730/35, 11000 Praha 1 – Staré Město, Czech Republic

## PRICE AND AVAILABILITY

25.04. - 02.05.2026 6.331 €	02.05. - 09.05.2026 5.206 €	09.05. - 22.05.2026 NOT AVAILABLE	23.05. - 30.05.2026 5.114 €
30.05. - 06.06.2026 5.114 €	06.06. - 13.06.2026 5.114 €	13.06. - 20.06.2026 5.114 €	20.06. - 27.06.2026 5.114 €
27.06. - 04.07.2026 4.627 € 4.627 €	04.07. - 11.07.2026 4.261 €	11.07. - 18.07.2026 4.261 €	18.07. - 25.07.2026 4.261 €
25.07. - 01.08.2026 4.261 €	01.08. - 08.08.2026 4.261 €	08.08. - 15.08.2026 4.261 €	15.08. - 22.08.2026 4.261 €
22.08. - 29.08.2026 4.261 €	01.09. - 30.09.2026 NOT AVAILABLE	03.10. - 10.10.2026 4.261 €	10.10. - 17.10.2026 4.261 €
17.10. - 24.10.2026 4.261 €	24.10. - 31.10.2026 4.048 € 4.261 €	31.10. - 07.11.2026 4.742 € 4.992 €	07.11. - 14.11.2026 4.858 € 5.114 €
14.11. - 21.11.2026 4.858 € 5.114 €	21.11. - 28.11.2026 4.858 € 5.114 €	28.11. - 05.12.2026 4.280 € 4.505 €	



WEBSITE

[www.plujeme.cz](http://www.plujeme.cz)



E-MAIL

[info@plujeme.cz](mailto:info@plujeme.cz)



PHONE

+420 720 755 085



MOBILE

+420 777 170 276



PLUJEME RÁDI S.R.O.

Dlouhá 730/35, 11000 Praha 1 – Staré Město, Czech Republic

## PRICE AND AVAILABILITY

05.12. - 12.12.2026

**4.048 €** 4.261 €

12.12. - 19.12.2026

**5.436 €** 5.723 €

19.12. - 26.12.2026

**7.671 €**

28.12. - 05.01.2027

NOT AVAILABLE

08.01. - 31.08.2027

NOT AVAILABLE



**WEBSITE**

[www.plujeme.cz](http://www.plujeme.cz)



**PHONE**

+420 720 755 085



**MOBILE**

+420 777 170 276



**E-MAIL**

[info@plujeme.cz](mailto:info@plujeme.cz)



**PLUJEME RÁDI S.R.O.**

Dlouhá 730/35, 11000 Praha 1 – Staré Město, Czech Republic

## PRICE AND AVAILABILITY

01.09. - 30.09.2027 NOT AVAILABLE	02.10. - 09.10.2027 4.261 €	09.10. - 16.10.2027 4.261 €	16.10. - 23.10.2027 4.261 €
23.10. - 30.10.2027 4.261 €	30.10. - 06.11.2027 4.870 €	06.11. - 13.11.2027 5.114 €	13.11. - 20.11.2027 5.114 €
20.11. - 27.11.2027 5.114 €	27.11. - 04.12.2027 4.627 € 4.627 €	04.12. - 11.12.2027 4.261 €	



### WEBSITE

[www.plujeme.cz](http://www.plujeme.cz)



### E-MAIL

[info@plujeme.cz](mailto:info@plujeme.cz)



### PHONE

+420 720 755 085



### MOBILE

+420 777 170 276



### PLUJEME RÁDI S.R.O.

Dlouhá 730/35, 11000 Praha 1 – Staré Město, Czech Republic