

BALI 4.4

Here and Now (2023)

Catamaran Bali 4.4 Here and Now, built in **2023** is anchored in the **BVI, Hodge's Creek Marina, British Virgin Islands, British Virgin Islands**. It has **4 + 1 cabins**, can accommodate **8 people** and has **4 toilets**. Bed linen and kitchen equipment are included in the price.

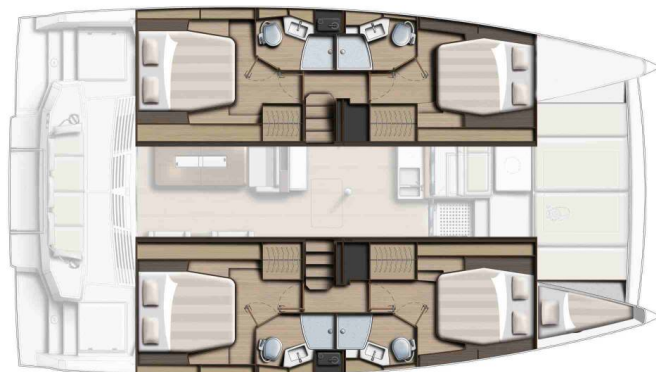

YACHT SPECIFICATIONS

Yacht Base

BVI, Hodge's Creek Marina, British Virgin Islands

Yacht ID

11671

Brands

Catana

Yacht name

Here and Now

Production year

2023

Length

44 ft

Cabins

4 + 1

Berths

8

Max Persons

8

WC

4

Engine

2 x 57 HP

Fuel tank

798 l



WEBSITE

www.plujeme.cz



PHONE

+420 720 755 085



MOBILE

+420 777 170 276



E-MAIL

info@plujeme.cz



PLUJEME RÁDI S.R.O.

Dlouhá 730/35, 11000 Praha 1 – Staré Město, Czech Republic

STANDARD YACHT EQUIPMENT

Comfort	Cockpit cushions
Deck	Bimini top
Entertainment	Radio
Galley	Coffee machine, Microwave, Oven, Refrigerator, Stove, Water pump
Interior	Electric fans in cabins, Electric toilet, Salon table
Navigation	Autopilot, GPS chart plotter
Safety	Life jackets, VHF radio
Sails	Lazy bag, Lazy jacks
Yacht electrics	Air Conditioning, Generator, Inverter, Watermaker - desalinator



WEBSITE

www.plujeme.cz



E-MAIL

info@plujeme.cz



PHONE

+420 720 755 085



MOBILE

+420 777 170 276



PLUJEME RÁDI S.R.O.

Dlouhá 730/35, 11000 Praha 1 – Staré Město, Czech Republic

SERVICES

SELECTED SERVICES	OBLIGATORY	PAYMENT TYPE	PRICE
BVI Cruising Tax (Payable now) <i>Season: 2026. BVI Cruising Permit Fee</i>	Yes	per guest/day	4,00 €
Credit card surcharge (Payable now) <i>Season: 2026. Waived if paying by wire transfer or Zelle</i>	Yes	per booking	0,00 €
Damage waiver (Payable now) <i>Season: 2026.</i>	Yes	per day	60,00 €
Final cleaning (Payable now) <i>Season: 2026.</i>	Yes	per booking	299,00 €
National parks permit (Payable now) <i>Season: 2026. Not to exceed 4 pax</i>	Yes	per week	25,00 €
National parks permit (Payable now) <i>Season: 2026. Not to exceed 6 pax</i>	Yes	per week	35,00 €
National parks permit (Payable now) <i>Season: 2026. Not to exceed 8 pax</i>	Yes	per week	45,00 €
National parks permit (Payable now) <i>Season: 2026. Not to exceed 10 pax</i>	Yes	per week	55,00 €
National parks permit (Payable now) <i>Season: 2026. Passengers in excess of 10, \$5 for each additional passengers</i>	Yes	per week	60,00 €
National parks permit (Payable now) <i>Season: 2026. Passengers in excess of 10, \$5 for each additional passengers</i>	Yes	per week	65,00 €
National parks permit (Payable now) <i>Season: 2026. Passengers in excess of 10, \$5 for each additional passengers</i>	Yes	per week	70,00 €
National parks permit (Payable now) <i>Season: 2026. Passengers in excess of 10, \$5 for each additional passengers</i>	Yes	per week	75,00 €

Starter pack (Payable now) Season: 2026.	Yes	per booking	55,00 €
Visar (Payable now) Season: 2026.	Yes	per person	5,00 €
Cancellation fee (Payable at the base) Season: 2026.	No	per booking	599,00 €
CDW for Sleep Aboard (Payable now) Season: 2026.	No	per booking	74,00 €
Cook (Payable now) Season: 2026. (Prepares meals exclusively with provisions supplied by the guest. Service does not include shopping, provisioning, or operational responsibilities. Standard gratuity and prepaid food allowance included. Cabin/head must be available. Non-refundable 45 days or less prior to departure.)	No	per day + food	452,00 €
Cook (Payable now) Season: 2026. (Prepares meals exclusively with provisions supplied by the guest. Service does not include shopping, provisioning, or operational responsibilities. Standard gratuity and prepaid food allowance included. Cabin/head must be available. Non-refundable 45 days or less prior to departure.)	No	per day + food	452,00 €
Cook (Payable now) Season: 2026. (Prepares meals exclusively with provisions supplied by the guest. Service does not include shopping, provisioning, or operational responsibilities. Standard gratuity and prepaid food allowance included. Cabin/head must be available. Non-refundable 45 days or less prior to departure.)	No	per day + food	552,00 €
Holiday Surcharge (Payable now) Season: 2026. \$100/day for Skipper + \$100/day for Chef	No	per day	200,00 €
Late payment fee (Payable now) Season: 2026.	No	per booking	90,00 €
Sailing Instructor (Payable now) Season: 2026. Standard gratuity and prepaid food allowance included. Cabin/head must be available. Non-refundable 45 days or less prior to departure.	No	per day + food	472,00 €

Skipper (Payable now)	No	per day + food	452,00 €
Season: 2026. Standard gratuity and prepaid food allowance included. Cabin/head must be available. Non-refundable 45 days or less prior to departure.			
Skipper (Payable now)	No	per day + food	452,00 €
Season: 2026. Standard gratuity and prepaid food allowance included. Cabin/head must be available. Non-refundable 45 days or less prior to departure.			
Skipper (Payable now)	No	per day + food	552,00 €
Season: 2026. Standard gratuity and prepaid food allowance included. Cabin/head must be available. Non-refundable 45 days or less prior to departure. Includes Holiday Surcharge - \$100/day for Skipper.			
Sleep over before check in (Payable now)	No	per booking	0,00 €
Season: 2026.			
VIP Departure Service (Payable now)	No	per person	150,00 €
Season: 2026.			
VIP Fast track (Payable now)	No	per person	150,00 €
Season: 2026.			
WI-FI Internet connection on boat (Payable now)	No	per day	25,00 €
Season: 2026.			



WEBSITE

www.plujeme.cz



E-MAIL

info@plujeme.cz



PHONE

+420 720 755 085



MOBILE

+420 777 170 276



PLUJEME RÁDI S.R.O.

Dlouhá 730/35, 11000 Praha 1 – Staré Město, Czech Republic

PRICE AND AVAILABILITY

25.04. - 02.05.2026 8.888 €	02.05. - 09.05.2026 7.671 €	09.05. - 16.05.2026 7.671 €	16.05. - 23.05.2026 7.671 €
23.05. - 30.05.2026 7.671 €	30.05. - 06.06.2026 7.671 €	06.06. - 13.06.2026 7.671 €	13.06. - 20.06.2026 7.671 €
20.06. - 27.06.2026 7.671 €	27.06. - 04.07.2026 7.184 € 7.184 €	04.07. - 11.07.2026 6.818 €	11.07. - 18.07.2026 6.818 €
18.07. - 25.07.2026 6.818 €	25.07. - 01.08.2026 6.818 €	01.08. - 08.08.2026 6.818 €	08.08. - 15.08.2026 6.818 €
15.08. - 22.08.2026 6.818 €	22.08. - 29.08.2026 6.818 €	01.09. - 30.09.2026 NOT AVAILABLE	03.10. - 10.10.2026 6.818 €
10.10. - 17.10.2026 6.818 €	17.10. - 24.10.2026 6.818 €	24.10. - 31.10.2026 7.140 € 7.516 €	31.10. - 08.11.2026 NOT AVAILABLE
09.11. - 09.12.2026 NOT AVAILABLE			



WEBSITE

www.plujeme.cz



E-MAIL

info@plujeme.cz



PHONE

+420 720 755 085



MOBILE

+420 777 170 276



PLUJEME RÁDI S.R.O.

Dlouhá 730/35, 11000 Praha 1 – Staré Město, Czech Republic

PRICE AND AVAILABILITY

12.12. - 19.12.2026 8.560 € 9.010 €	19.12. - 26.12.2026 11.932 €	05.01. - 01.03.2027 NOT AVAILABLE	06.03. - 13.03.2027 8.523 €
13.03. - 20.03.2027 8.523 €	20.03. - 27.03.2027 8.523 €	27.03. - 03.04.2027 8.523 €	03.04. - 10.04.2027 8.523 €
10.04. - 17.04.2027 8.523 €	17.04. - 24.04.2027 8.523 €	24.04. - 01.05.2027 8.279 €	01.05. - 08.05.2027 6.818 €
08.05. - 15.05.2027 6.818 €	15.05. - 22.05.2027 6.818 €	22.05. - 29.05.2027 6.818 €	29.05. - 05.06.2027 6.818 €
05.06. - 12.06.2027 6.818 €	12.06. - 19.06.2027 6.818 €	19.06. - 26.06.2027 6.818 €	26.06. - 03.07.2027 6.453 €
03.07. - 10.07.2027 5.966 €	10.07. - 17.07.2027 5.966 €	17.07. - 24.07.2027 5.966 €	24.07. - 31.07.2027 5.966 €
31.07. - 07.08.2027 5.966 €			



WEBSITE

www.plujeme.cz



E-MAIL

info@plujeme.cz



PHONE

+420 720 755 085



MOBILE

+420 777 170 276



PLUJEME RÁDI S.R.O.

Dlouhá 730/35, 11000 Praha 1 – Staré Město, Czech Republic

PRICE AND AVAILABILITY

07.08. - 14.08.2027 5.966 €	14.08. - 21.08.2027 5.966 €	21.08. - 28.08.2027 5.966 €	01.09. - 30.09.2027 NOT AVAILABLE
02.10. - 09.10.2027 5.966 €	09.10. - 16.10.2027 5.966 €	16.10. - 23.10.2027 5.966 €	23.10. - 30.10.2027 5.966 €
30.10. - 06.11.2027 6.575 €	06.11. - 13.11.2027 6.818 €	13.11. - 20.11.2027 6.818 €	20.11. - 27.11.2027 6.818 €
27.11. - 04.12.2027 6.331 €	04.12. - 11.12.2027 5.966 €		



WEBSITE

www.plujeme.cz



E-MAIL

info@plujeme.cz



PHONE

+420 720 755 085



MOBILE

+420 777 170 276



PLUJEME RÁDI S.R.O.

Dlouhá 730/35, 11000 Praha 1 – Staré Město, Czech Republic