

# OCEANIS 40.1

Stefano (2025)

Sailing yacht **Oceanis 40.1 Stefano**, built in **2025** is anchored in the **Paros, Cyclades, Greece**. It has **4 cabins**, can accommodate **8 + 2 people** and has **2 toilets**. Bed linen and kitchen equipment are included in the price.

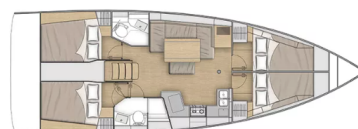

## YACHT SPECIFICATIONS

Yacht Base

**Paros, Greece**

Yacht ID

**11396**

Brands

**Beneteau**

Yacht name

**Stefano**

Production year

**2025**

Length

**42 ft**

Cabins

**4**

Berths

**8 + 2**

WC

**2**

Engine

**1 x 45 HP**

Fuel tank

**200 l**



**WEBSITE**

[www.plujeme.cz](http://www.plujeme.cz)



**PHONE**

+420 720 755 085



**MOBILE**

+420 777 170 276



**E-MAIL**

[info@plujeme.cz](mailto:info@plujeme.cz)



**PLUJEME RÁDI S.R.O.**

Dlouhá 730/35, 11000 Praha 1 – Staré Město, Czech Republic

## STANDARD YACHT EQUIPMENT

Deck	<b>Bathing platform, Bimini top, Dinghy, Outboard engine, Sprayhood, Swimming ladder, Teak cockpit</b>
Entertainment	<b>Bluetooth player, Outdoor speakers, Radio CD mp3 player</b>
Galley	<b>Refrigerator</b>
Interior	<b>Electric fans</b>
Navigation	<b>Autopilot, Bow thruster, GPS chart plotter - cockpit</b>



#### WEBSITE

[www.plujeme.cz](http://www.plujeme.cz)



#### E-MAIL

[info@plujeme.cz](mailto:info@plujeme.cz)



#### PHONE

+420 720 755 085



#### MOBILE

+420 777 170 276



#### PLUJEME RÁDI S.R.O.

Dlouhá 730/35, 11000 Praha 1 – Staré Město, Czech Republic

## SERVICES

SELECTED SERVICES	OBLIGATORY	PAYMENT TYPE	PRICE
<b>Charter pack</b> (Payable at the base) <b>Season: 2026.</b> includes end cleaning, gas bottle, fuel for the outboard, mooring fee for the first and last night	Yes	per booking	<b>220,00 €</b>
<b>Welcome package</b> (Payable at the base) <b>Season: 2026.</b> selection of Greek products and bath amenities, Mooring fees for first & last night at the marina / port, first fill for outboard engine, spare bottle of gas, autopilot , GPS/Plotter, Radio/Music Player & cockpit speakers, dinghy with outboard engine, 1 set of linen and towels per person per week, Snorkeling equipment (all adult sizes), espresso coffee maker (only for platinum fleet yachts), 1 SUP (for monohull charters 50 ft and larger and for catamaran charters up to 44ft), 2 SUP (for catamarans 44ft and larger)	Yes	per booking	<b>0,00 €</b>
<b>Cook</b> (Payable at the base) <b>Season: 2026.</b>	No	per day + food	<b>190,00 €</b>
<b>Crew change</b> (Payable at the base) <b>Season: 2026.</b> (skipper remains the same) - the cost covers expenses for port authorities formalities, bed linen/towels and marina fees. In case cleaning is needed the cost is as per the Price list.	No	per booking	<b>200,00 €</b>
<b>Damage waiver</b> (Payable at the base) <b>Season: 2026.</b> non-refundable + refundable deposit 600 EUR	No	per week	<b>300,00 €</b>
<b>Fast Track pack</b> (Payable at the base) <b>Season: 2026.</b> early embarkation at 14:00 (upon request and subject to no damages from previous charter)	No	per booking	<b>180,00 €</b>
<b>Hostess</b> (Payable at the base) <b>Season: 2026.</b>	No	per day + food	<b>180,00 €</b>
<b>One way</b> (Payable at the base) <b>Season: 2026.</b> Athens - Lavrion	No	one-way	<b>400,00 €</b>
<b>One way</b> (Payable at the base) <b>Season: 2026.</b> Athens - Paros	No	one-way	<b>900,00 €</b>
<b>One way</b> (Payable at the base) <b>Season: 2026.</b> Athens - Lefkas	No	one-way	<b>1.400,00 €</b>

<b>Skipper</b> (Payable at the base)	No	per day + food	<b>200,00 €</b>
<b>Season: 2026.</b>			
<b>Transfer</b> (Payable at the base)	No	one-way	<b>60,00 €</b>
<b>Season: 2026.</b> Athens Airport - Lavrion base; taxi 1 - 3 pax			
<b>Transfer</b> (Payable at the base)	No	one-way	<b>60,00 €</b>
<b>Season: 2026.</b> Airport - Athens base; taxi 1 - 3 pax			
<b>Transfer</b> (Payable at the base)	No	one-way	<b>100,00 €</b>
<b>Season: 2026.</b> Airport - Athens base; minivan up to 8 pax			
<b>Transfer</b> (Payable at the base)	No	one-way	<b>120,00 €</b>
<b>Season: 2026.</b> Athens Airport - Lavrion base; minivan up to 8 pax			
<b>Transfer</b> (Payable at the base)	No	one-way	<b>180,00 €</b>
<b>Season: 2026.</b> Athens Airport - Lavrion base; minivan up to 20 pax			
<b>Transfer</b> (Payable at the base)	No	one-way	<b>180,00 €</b>
<b>Season: 2026.</b> Airport - Athens base; minivan up to 16 pax			
<b>Transfer</b> (Payable at the base)	No	one-way	<b>300,00 €</b>
<b>Season: 2026.</b> Airport - Athens base; bus up to 50 pax			
<b>WI-FI Internet connection on boat</b> (Payable at the base)	No	per week	<b>90,00 €</b>
<b>Season: 2026.</b> unlimited data			



**WEBSITE**

[www.plujeme.cz](http://www.plujeme.cz)



**E-MAIL**

[info@plujeme.cz](mailto:info@plujeme.cz)



**PHONE**

+420 720 755 085



**MOBILE**

+420 777 170 276



**PLUJEME RÁDI S.R.O.**

Dlouhá 730/35, 11000 Praha 1 - Staré Město, Czech Republic

## ADDITIONAL EXTRAS

EXTRA	OBLIGATORY	PAYMENT TYPE	PRICE
<b>Extra bedlinen</b> (Payable at the base) <b>Season: 2026.</b> Payable at the base	No	per person	<b>10,00 €</b>
<b>Inflatable lifejacket</b> (Payable at the base) <b>Season: 2026.</b> Payable at the base	No	per week/ person	<b>30,00 €</b>
<b>Railing net (Safety net)</b> (Payable at the base) <b>Season: 2026.</b> installed - Payable at the base	No	per booking	<b>250,00 €</b>
<b>Stand up paddle (SUP)</b> (Payable at the base) <b>Season: 2026.</b> Payable at the base	No	per week	<b>120,00 €</b>

**WEBSITE**[www.plujeme.cz](http://www.plujeme.cz)**E-MAIL**[info@plujeme.cz](mailto:info@plujeme.cz)**PHONE**

+420 720 755 085

**MOBILE**

+420 777 170 276

**PLUJEME RÁDI S.R.O.**

Dlouhá 730/35, 11000 Praha 1 – Staré Město, Czech Republic

## PRICE AND AVAILABILITY

25.04. - 02.05.2026 2.250 € 2.500 €	02.05. - 09.05.2026 NOT AVAILABLE	09.05. - 16.05.2026 2.880 € 3.200 €	16.05. - 23.05.2026 NOT AVAILABLE
23.05. - 30.05.2026 NOT AVAILABLE	30.05. - 06.06.2026 NOT AVAILABLE	06.06. - 13.06.2026 NOT AVAILABLE	13.06. - 20.06.2026 NOT AVAILABLE
20.06. - 27.06.2026 NOT AVAILABLE	27.06. - 04.07.2026 NOT AVAILABLE	04.07. - 11.07.2026 4.042 € 4.700 €	11.07. - 18.07.2026 4.042 € 4.700 €
18.07. - 25.07.2026 4.230 € 4.700 €	25.07. - 01.08.2026 4.230 € 4.700 €	01.08. - 08.08.2026 NOT AVAILABLE	08.08. - 15.08.2026 NOT AVAILABLE
15.08. - 22.08.2026 NOT AVAILABLE	22.08. - 29.08.2026 3.984 € 4.800 €	29.08. - 05.09.2026 NOT AVAILABLE	05.09. - 12.09.2026 NOT AVAILABLE
12.09. - 19.09.2026 NOT AVAILABLE	19.09. - 26.09.2026 NOT AVAILABLE	26.09. - 03.10.2026 3.060 € 3.400 €	03.10. - 10.10.2026 NOT AVAILABLE
10.10. - 17.10.2026 3.060 € 3.400 €	17.10. - 24.10.2026 2.250 € 2.500 €	24.10. - 31.10.2026 NOT AVAILABLE	31.10. - 07.11.2026 2.250 € 2.500 €
07.11. - 14.11.2026 2.250 € 2.500 €	14.11. - 21.11.2026 2.250 € 2.500 €	21.11. - 28.11.2026 2.250 € 2.500 €	28.11. - 05.12.2026 2.250 € 2.500 €



**WEBSITE**  
[www.plujeme.cz](http://www.plujeme.cz)



**E-MAIL**  
[info@plujeme.cz](mailto:info@plujeme.cz)



**PHONE**  
+420 720 755 085



**PLUJEME RÁDI S.R.O.**  
Dlouhá 730/35, 11000 Praha 1 – Staré Město, Czech Republic



**MOBILE**  
+420 777 170 276

## PRICE AND AVAILABILITY

05.12. - 12.12.2026

**2.250 €** 2.500 €

12.12. - 19.12.2026

**2.250 €** 2.500 €

19.12. - 26.12.2026

**2.250 €** 2.500 €



### WEBSITE

[www.plujeme.cz](http://www.plujeme.cz)



### E-MAIL

[info@plujeme.cz](mailto:info@plujeme.cz)



### PHONE

+420 720 755 085



### MOBILE

+420 777 170 276



### PLUJEME RÁDI S.R.O.

Dlouhá 730/35, 11000 Praha 1 – Staré Město, Czech Republic