

OCEANIS 34.1

Rookie (2023)

Sailing yacht Oceanis 34.1 Rookie, built in 2023 is anchored in the ACI Marina Split, Split region, Croatia. It has 3 cabins, can accommodate 6 + 2 people and has 1 toilets. Bed linen and kitchen equipment are included in the price.

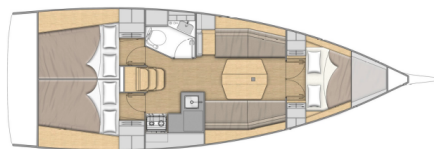

YACHT SPECIFICATIONS

Yacht Base

ACI Marina Split, Croatia

Yacht ID

11203

Brands

Beneteau

Yacht name

Rookie

Production year

2023

Length

35 ft

Cabins

3

Berths

6 + 2

WC

1

Engine

1 x 29 HP

Fuel tank

130 l



WEBSITE

www.plujeme.cz



PHONE

+420 720 755 085



MOBILE

+420 777 170 276



E-MAIL

info@plujeme.cz



PLUJEME RÁDI S.R.O.

Dlouhá 730/35, 11000 Praha 1 – Staré Město, Czech Republic

STANDARD YACHT EQUIPMENT

Comfort	Bed linen, Cockpit cushions, Towels
Deck	Anchor with chain, Bilge pump - Mechanic, Bimini top, Boat hook, Bosun's chair (Safe seat) (boatswain's chair), Cockpit table, Cockpit/stern, outside shower, Dinghy, Electric anchor windlass, Round/globular fender, Spare anchor (Reserve, Auxiliary anchor), Sprayhood, Teak cockpit
Entertainment	Outdoor speakers, Radio with USB, Wi-Fi Internet
Galley	Gas bottles, Hot water, Kitchen utensils (Galley equipment, cutlery), Oven, Refrigerator, Stove
Interior	Salon table
Navigation	Autopilot, Binoculars, Compass, GPS chart plotter - cockpit, Navigation (Nautical) charts and nautical guide, Pilot book, Wind instrument/Anemometer
Safety	Black Water Tank, Buoyant smoke signal, Distress signals, Fire axe, Fire extinguisher, First aid kit, Fog horn, Life belts (Safety harness), Life jackets, VHF radio
Sails	Lazy bag, Performance sails
Yacht electrics	Battery charger, Bilge pump - Electric, Heating, Shore connection 220 V, Solar panels



WEBSITE

www.plujeme.cz



PHONE

+420 720 755 085



MOBILE

+420 777 170 276



E-MAIL

info@plujeme.cz



PLUJEME RÁDI S.R.O.

Dlouhá 730/35, 11000 Praha 1 - Staré Město, Czech Republic

SERVICES

SELECTED SERVICES	OBLIGATORY	PAYMENT TYPE	PRICE
Charter pack (Payable at the base) Season: 2026 - Ultra Sailing. Includes: bed linen, towels, kitchen utensils, 3 GB WiFi, snorkeling set, diver's inspection, end cleaning	Yes	per booking	258,00 €
Tourist tax (Payable at the base) Season: 2026 - Ultra Sailing. cash or card	Yes	per guest/night	1,33 €
APA (Advance Provisioning Allowance) (Payable at the base) Season: 2026 - Ultra Sailing. Obligatory with Hostess	No	per week	3.000,00 €
Damage waiver (Payable now) Season: 2026 - Ultra Sailing. + 100 EUR refundable	No	per booking	250,00 €
Hostess (Payable now) Season: 2026 - Ultra Sailing. Preparation of 2 meals daily; + obligatory APA 3000,00eur	No	per week + food	1.575,00 €
Pet on board (Payable at the base) Season: 2026 - Ultra Sailing.	No	per booking	150,00 €
Skipper (Payable now) Season: 2026 - Ultra Sailing. + cabin	No	per week + food	1.660,00 €
Transfer (Payable at the base) Season: 2026 - Ultra Sailing. Transfer APT Split- ACI Split (4-8pax)	No	one-way	80,00 €
Transfer (Payable at the base) Season: 2026 - Ultra Sailing. Transfer APT Split- ACI Split (1-3pax)	No	one-way	75,00 €
WI-FI Internet connection on boat (Payable at the base) Season: 2026 - Ultra Sailing. 40GB	No	per booking	30,00 €



WEBSITE
www.plujeme.cz



PHONE
+420 720 755 085



MOBILE
+420 777 170 276



E-MAIL
info@plujeme.cz



PLUJEME RÁDI S.R.O.
Dlouhá 730/35, 11000 Praha 1 – Staré Město, Czech Republic

ADDITIONAL EXTRAS

EXTRA	OBLIGATORY	PAYMENT TYPE	PRICE
Automatic Inflatable Life Jacket (Payable at the base) Season: 2026 - Ultra Sailing. Payable at the base	No	per week	35,00 €
e-SUP (Payable at the base) Season: 2026 - Ultra Sailing. Sipaboard – Allrounder + additional deposit 500€ - Payable at the base	No	per week	250,00 €
Electric outboard engine (Payable now) Season: 2026 - Ultra Sailing. limited, on request - Payable now	No	per week	150,00 €
Gennaker (Payable at the base) Season: 2026 - Ultra Sailing. on request - Payable at the base	No	per week	200,00 €
Ice maker (Payable now) Season: 2026 - Ultra Sailing. limited, on request - Payable now	No	per week	40,00 €
Railing net (Safety net) (Payable at the base) Season: 2026 - Ultra Sailing. Payable at the base	No	per booking	100,00 €
Snorkeling equipment (Payable at the base) Season: 2026 - Ultra Sailing. Payable at the base	No	per set	12,00 €
Stand up paddle (SUP) (Payable at the base) Season: 2026 - Ultra Sailing. Payable at the base	No	per week	120,00 €



WEBSITE
www.plujeme.cz



E-MAIL
info@plujeme.cz



PHONE
+420 720 755 085



PLUJEME RÁDI S.R.O.
Dlouhá 730/35, 11000 Praha 1 – Staré Město, Czech Republic



MOBILE
+420 777 170 276

PRICE AND AVAILABILITY

25.04. - 02.05.2026 910 € 1.300 €	02.05. - 09.05.2026 NOT AVAILABLE	09.05. - 16.05.2026 1.015 € 1.450 €	16.05. - 23.05.2026 1.160 € 1.450 €
23.05. - 30.05.2026 NOT AVAILABLE	30.05. - 06.06.2026 NOT AVAILABLE	06.06. - 20.06.2026 NOT AVAILABLE	20.06. - 27.06.2026 NOT AVAILABLE
27.06. - 04.07.2026 NOT AVAILABLE	04.07. - 11.07.2026 NOT AVAILABLE	11.07. - 18.07.2026 2.423 € 2.550 €	18.07. - 01.08.2026 NOT AVAILABLE
01.08. - 29.08.2026 NOT AVAILABLE	29.08. - 05.09.2026 1.750 € 2.500 €	05.09. - 12.09.2026 NOT AVAILABLE	12.09. - 19.09.2026 NOT AVAILABLE
19.09. - 26.09.2026 NOT AVAILABLE	26.09. - 03.10.2026 1.260 € 1.400 €	03.10. - 10.10.2026 945 € 1.350 €	10.10. - 17.10.2026 945 € 1.350 €
17.10. - 24.10.2026 1.000 € 1.250 €	24.10. - 31.10.2026 1.080 € 1.350 €	01.11. - 31.12.2026 NOT AVAILABLE	



WEBSITE

www.plujeme.cz



E-MAIL

info@plujeme.cz



PHONE

+420 720 755 085



MOBILE

+420 777 170 276



PLUJEME RÁDI S.R.O.

Dlouhá 730/35, 11000 Praha 1 – Staré Město, Czech Republic