

AQUILA 42

This is It (2023)

Power catamaran **Aquila 42 This is It**, built in **2023** is anchored in the **Bahamas, Abacos, Boat Harbour Marina, Abaco Islands, Bahamas**. It has **3 cabins**, can accommodate **6 people** and has **3 toilets**. Bed linen and kitchen equipment are included in the price.

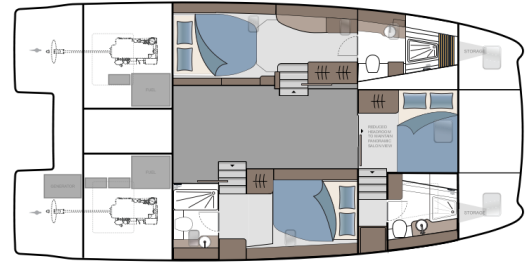

YACHT SPECIFICATIONS

Yacht Base

Bahamas, Abacos, Boat Harbour Marina, Bahamas

Yacht ID

11125

Brands

Aquila Yachts

Yacht name

This is It

Production year

2023

Length

41 ft

Cabins

3

Berths

6

WC

3

Engine

2 x 0 HP

Fuel tank

1100 l



WEBSITE

www.plujeme.cz



PHONE

+420 720 755 085



MOBILE

+420 777 170 276



E-MAIL

info@plujeme.cz



PLUJEME RÁDI S.R.O.

Dlouhá 730/35, 11000 Praha 1 – Staré Město, Czech Republic

STANDARD YACHT EQUIPMENT

Deck	Bimini top, Cockpit fridge, Cockpit/stern, outside shower, Davit, Electric anchor windlass, Flybridge, Grill/Barbecue/Plancha
Entertainment	Indoor speakers, Outdoor speakers, Radio, Underwater lights
Galley	Freezer, Kitchen utensils (Galley equipment, cutlery), Microwave, Oven, Refrigerator, Stove
Interior	Electric toilet
Navigation	Autopilot, Depthsounder, GPS chart plotter - cockpit, Helm station
Safety	VHF radio
Yacht electrics	110V socket, Air Conditioning, Generator, Inverter, Shore power connection, Solar panels, USB sockets



WEBSITE

www.plujeme.cz



E-MAIL

info@plujeme.cz



PHONE

+420 720 755 085



MOBILE

+420 777 170 276









PLUJEME RÁDI S.R.O.

Dlouhá 730/35, 11000 Praha 1 – Staré Město, Czech Republic

SERVICES

SELECTED SERVICES	OBLIGATORY	PAYMENT TYPE	PRICE
Bahamas foreign charter tax (Payable now) Season: 2026.	Yes	per booking	0,00 €
Bahamas Taxes (Payable now) Season: 2026.	Yes	per booking	0,00 €
DRA (Payable now) Season: 2026.	Yes	per day	50,00 €
ASA Processing Fee (Payable now) Season: 2026. Certificate 103	No	per person/per course	150,00 €
ASA Processing Fee (Payable now) Season: 2026. Certificate 101	No	per person/per course	150,00 €
ASA Processing Fee (Payable now) Season: 2026. Certificate 114	No	per person/per course	200,00 €
ASA Processing Fee (Payable now) Season: 2026. Certificate 104	No	per person/per course	200,00 €
ASA Processing Fee (Payable now) Season: 2026. Overnight Open Water. Available only on Flotilla Sails; Certificate 106	No	per person/per course	250,00 €
ASA Processing Fee (Payable now) Season: 2026. Certificate 101, 103 & 104	No	per person/per course	400,00 €
ASA Processing Fee (Payable now) Season: 2026. Overnight Open Water. Available only on Flotilla Sails; Certificate 105	No	per person/per course	400,00 €
ASA Processing Fee (Payable now) Season: 2026. Overnight Open Water. Available only on Flotilla Sails; Certificate 105 & 106	No	per person/per course	550,00 €
Captain By Day (Payable now) Season: 2026.	No	per day + food	350,00 €

Captain By Night (Payable now) Season: 2026.	No	per night	450,00 €
Chef (Payable now) Season: 2026. Overnight	No	per day + food	400,00 €
Credit card surcharge (Payable now) Season: 2026. A 3% convenience fee will be added to all credit card transactions	No	per booking	0,00 €
Daily trips (Payable now) Season: 2026. Trips north from Guana	No	per booking	400,00 €
Delivery and pick up (Payable at the base) Season: 2026. Pick-up and drop-off in Little Harbour or Green Turtle Cay	No	one-way	350,00 €
Education (Payable at the base) Season: 2026. NauticEd skipper training hours	No	per person/per course	100,00 €
Education (Payable at the base) Season: 2026. NauticEd bareboat hours	No	per person/per course	200,00 €
Extra cleaning (Payable at the base) Season: 2026.	No	per service	400,00 €
Fuel charge (Payable now) Season: 2026. + 500,00\$ deposit; This is only for power cat day trips	No	per booking	300,00 €
Gratuity (Payable now) Season: 2026. On Day Trips	No	per booking	220,00 €
Hostess/Cook (Payable now) Season: 2026.	No	per day + food	350,00 €
Participation fee (Payable at the base) Season: 2026. NauticEd sign up fee	No	per person/per course	175,00 €
Rescheduling (Payable now) Season: 2026. On Day Trips	No	per booking	350,00 €
Sleep over after check out (Payable now) Season: 2026.	No	per booking	700,00 €

	 WEBSITE www.plujeme.cz	 PHONE +420 720 755 085 No	 MOBILE +420 777 170 276 per booking	700,00 €
	 E-MAIL info@plujeme.cz	 PLUJEME RÁDI S.R.O. Dlouhá 730/35, 11000 Praha 1 – Staré Město, Czech Republic		

Sleep over before check in (Payable now)
Season: 2026. at 12:00 PM

ADDITIONAL EXTRAS

EXTRA	OBLIGATORY	PAYMENT TYPE	PRICE
Fins (Payable now) Season: 2026. Payable now	No	per week/ person	35,00 €
Fishing cane/rod (Payable now) Season: 2026. Payable now	No	per week	60,00 €
Inflatable swimming platform (Payable now) Season: 2026. POP-UP DOCK - Payable now	No	per week	250,00 €
Kayak (Payable now) Season: 2026. Tandem - Payable now	No	per week	250,00 €
Snorkeling equipment (Payable now) Season: 2026. Payable now	No	per week/ person	50,00 €
Stand up paddle (SUP) (Payable now) Season: 2026. Payable now	No	per week	250,00 €
Starlink (Payable now) Season: 2026. Payable now	No	per week	100,00 €



WEBSITE

www.plujeme.cz



E-MAIL

info@plujeme.cz



PHONE

+420 720 755 085



MOBILE

+420 777 170 276



PLUJEME RÁDI S.R.O.

Dlouhá 730/35, 11000 Praha 1 – Staré Město, Czech Republic