

# XC 47

Penelope (2025)

Sailing yacht **XC 47 Penelope**, built in **2025** is anchored in the **Lavrion - Olympic Marine, Athens area/Saronic/Peloponese, Greece**. It has **3 cabins**, can accommodate **6 + 2 people** and has **2 toilets**. Bed linen and kitchen equipment are included in the price.

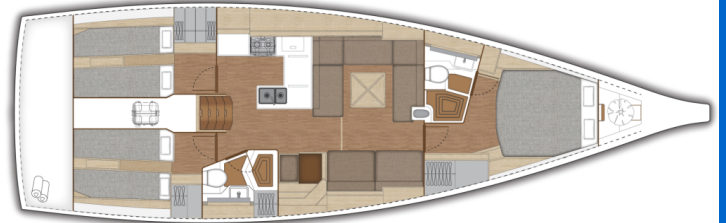

## YACHT SPECIFICATIONS

Yacht Base

**Lavrion - Olympic Marine, Greece**

Yacht ID

**11124**

Brands

**X-Yachts**

Yacht name

**Penelope**

Production year

**2025**

Length

**50 ft**

Cabins

**3**

Berths

**6 + 2**

Max Persons

**10**

WC

**2**

Engine

**1 x 80 HP**

Fuel tank

**500 l**



**WEBSITE**

[www.plujeme.cz](http://www.plujeme.cz)



**PHONE**

+420 720 755 085



**MOBILE**

+420 777 170 276



**E-MAIL**

[info@plujeme.cz](mailto:info@plujeme.cz)



**PLUJEME RÁDI S.R.O.**

Dlouhá 730/35, 11000 Praha 1 - Staré Město, Czech Republic

## STANDARD YACHT EQUIPMENT

Comfort	<b>Cockpit cushions</b>
Deck	<b>Bathing platform, Bimini top, Davit, Dinghy, Sprayhood, Teak cockpit, Teak deck</b>
Interior	<b>Washer/dryer</b>
Navigation	<b>Autopilot, GPS chart plotter - cockpit, Speedometer (Speed log), Wind instrument/Anemometer</b>
Safety	<b>VHF radio</b>
Sails	<b>Electric winch</b>
Yacht electrics	<b>Air Conditioning, Generator, Watermaker - desalinator</b>



**WEBSITE**

[www.plujeme.cz](http://www.plujeme.cz)



**E-MAIL**

[info@plujeme.cz](mailto:info@plujeme.cz)



**PHONE**

+420 720 755 085



**MOBILE**

+420 777 170 276



**PLUJEME RÁDI S.R.O.**

Dlouhá 730/35, 11000 Praha 1 – Staré Město, Czech Republic

## SERVICES

SELECTED SERVICES	OBLIGATORY	PAYMENT TYPE	PRICE
<b>Bed linen</b> (Payable at the base) <b>Season: 2026.</b>	Yes	per booking	<b>80,00 €</b>
<b>Final cleaning</b> (Payable now) <b>Season: 2026.</b> Includes sheets, face towel, body towel, swimming towel/person	Yes	per booking	<b>200,00 €</b>
<b>Skipper training practice</b> (Payable at the base) <b>Season: 2026.</b> professional "first day" skipper, includes skipper's return ticket to base and skippers food. Price with VAT included, in cash upon arrival.	Yes	per day	<b>298,00 €</b>
<b>Starter pack</b> (Payable now) <b>Season: 2026.</b> Includes basic supplies such as fresh fruit, mineral water, refreshments, snacks, hygiene & kitchen paper, cleaning products, gas bottle, etc.	Yes	per booking	<b>80,00 €</b>
<b>Early boarding/check-in</b> (Payable now) <b>Season: 2026.</b> before 14:00; We serve the Early Embarkation customers in priority In case of delay despite all the center's effort, the amount is fully refunded.	No	per booking	<b>160,00 €</b>
<b>Hostess</b> (Payable at the base) <b>Season: 2026.</b> On board to take care of breakfast, lunch, dish washing, cabin and wc freshen up, preparing up to two dinners on board. Extra dinners on board and child care to be quoted separately according to your needs. Very discreet professional service, hostess can sleep on land when at port with 30€ per day surcharge. Hostess food allowance is not included and is 25EUR per day or alternatively she/he can join your meals, according to the mood of the day. Food allowance is payable in cash to the hostess. Price with VAT included, in cash upon arrival.	No	per day + food	<b>198,40 €</b>
<b>Luxury service pack</b> (Payable now) <b>Season: 2026.</b> complementary to the basic starter pack. Includes two bottles of fine quality wine (red & white), fresh collection of local cheese bites, one kit per cabin of sun cream, after sun lotion, hydrating face mist, shower gel/shampoo in both WCs, 1 extra swimming towel per passenger	No	per booking	<b>190,00 €</b>

**Provisioning** (Payable now)

No

per service

**80,00 €**

**Season: 2026.** If chosen, will send you a list of available goods separately, with mentioned pricing per item; If chosen, will be included in charter fee, including the cost of the chosen provisions

**WI-FI Internet connection on boat** (Payable now)

No

per booking

**85,00 €**

**Season: 2026.** includes 5GB, additional data data packs available to buy on the go



**WEBSITE**

[www.plujeme.cz](http://www.plujeme.cz)



**E-MAIL**

[info@plujeme.cz](mailto:info@plujeme.cz)



**PHONE**

+420 720 755 085



**MOBILE**

+420 777 170 276



**PLUJEME RÁDI S.R.O.**

Dlouhá 730/35, 11000 Praha 1 – Staré Město, Czech Republic

## ADDITIONAL EXTRAS

EXTRA	OBLIGATORY	PAYMENT TYPE	PRICE
<b>Bike</b> (Payable at the base) <b>Season: 2026.</b> Xiaomi Mi QiCycle Electric Folding Bike - Payable at the base	No	per week	<b>195,00 €</b>
<b>Code Zero</b> (Payable now) <b>Season: 2026.</b> additional 300EUR on the standard damage deposit, fully refundable at the end of the charter - Payable now	No	per week	<b>300,00 €</b>
<b>Extra bedlinen</b> (Payable now) <b>Season: 2026.</b> Includes two sheets, one face towel, one body towel, one swimming towel - Payable now	No	per set	<b>15,00 €</b>
<b>Furling gennaker</b> (Payable at the base) <b>Season: 2026.</b> Payable at the base	No	per booking	<b>400,00 €</b>
<b>Kayak</b> (Payable now) <b>Season: 2026.</b> Payable now	No	per week	<b>180,00 €</b>
<b>Railing net (Safety net)</b> (Payable now) <b>Season: 2026.</b> Includes installation, also on the aft rails. Includes up to 3 extra junior life jackets (one is already included in the standard inventory). - Payable now	No	per booking	<b>240,00 €</b>
<b>Sea Scooter</b> (Payable now) <b>Season: 2026.</b> Electric - Payable now	No	per week	<b>180,00 €</b>
<b>Spinnaker</b> (Payable at the base) <b>Season: 2026.</b> Asymmetrical A2 spinnaker in a shock and an easy to hoist or fully remove - within seconds; Additional 300€ on the standard damage deposit, fully refundable at the end of the charter. - Payable at the base	No	per week	<b>400,00 €</b>
<b>Stand up paddle (SUP)</b> (Payable now) <b>Season: 2026.</b> additional 300EUR on the standard damage deposit, fully refundable at the end of the charter - Payable now	No	per week	<b>150,00 €</b>
<b>Staysail</b> (Payable at the base) <b>Season: 2026.</b> Payable at the base	No	per booking	<b>200,00 €</b>



**WEBSITE**  
www.plujeme.cz



**PHONE**  
+420 720 755 085



**MOBILE**  
+420 777 170 276



**E-MAIL**  
info@plujeme.cz



**PLUJEME RÁDI S.R.O.**  
Dlouhá 730/35, 11000 Praha 1 - Staré Město, Czech Republic

## PRICE AND AVAILABILITY

25.04. - 16.05.2026 NOT AVAILABLE	16.05. - 23.05.2026 10.820 €	23.05. - 30.05.2026 10.820 €	30.05. - 06.06.2026 11.340 €
06.06. - 13.06.2026 11.340 €	13.06. - 20.06.2026 NOT AVAILABLE	20.06. - 27.06.2026 11.340 €	27.06. - 04.07.2026 11.340 €
05.07. - 18.07.2026 NOT AVAILABLE	18.07. - 25.07.2026 11.340 €	25.07. - 01.08.2026 11.340 €	01.08. - 08.08.2026 11.340 €
08.08. - 15.08.2026 11.340 €	15.08. - 22.08.2026 11.340 €	22.08. - 29.08.2026 11.340 €	29.08. - 12.09.2026 NOT AVAILABLE
12.09. - 19.09.2026 NOT AVAILABLE	19.09. - 26.09.2026 NOT AVAILABLE	26.09. - 03.10.2026 10.820 €	03.10. - 24.10.2026 NOT AVAILABLE
24.10. - 31.10.2026 NOT AVAILABLE	31.10. - 07.11.2026 NOT AVAILABLE	07.11. - 14.11.2026 9.660 €	14.11. - 21.11.2026 9.660 €
22.11. - 31.12.2026 NOT AVAILABLE			



WEBSITE

[www.plujeme.cz](http://www.plujeme.cz)



E-MAIL

[info@plujeme.cz](mailto:info@plujeme.cz)



PHONE

+420 720 755 085



MOBILE

+420 777 170 276



PLUJEME RÁDI S.R.O.

Dlouhá 730/35, 11000 Praha 1 – Staré Město, Czech Republic