

QUEEN OF ADRIATIC

Queen of Adriatic (2008)

Gulet **Queen of Adriatic Queen of Adriatic**, built in **2008** is anchored in the **Kaštel Gomilica, Kaštilac, Split region, Croatia**. It has **6 cabins**, can accommodate **12 + 2 people** and has **6 toilets**. Bed linen and kitchen equipment are included in the price.

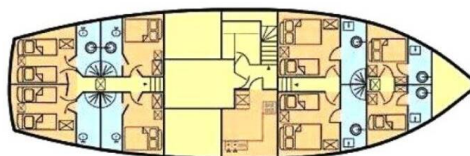

YACHT SPECIFICATIONS

Yacht Base

Kaštel Gomilica, Kaštilac, Croatia

Yacht ID

1095

Brands

Yener Yachts

Yacht name

Queen of Adriatic

Production year

2008

Length

89 ft

Cabins

6

Berths

12 + 2

WC

6

Engine

2 x 450 HP

Fuel tank

9000 l



WEBSITE

www.plujeme.cz



PHONE

+420 720 755 085



MOBILE

+420 777 170 276



E-MAIL

info@plujeme.cz



PLUJEME RÁDI S.R.O.

Dlouhá 730/35, 11000 Praha 1 – Staré Město, Czech Republic

STANDARD YACHT EQUIPMENT

Comfort	Bed linen, Blankets, Pillows, Sheets, Towels
Deck	Bar
Entertainment	Banana boat, Donut, Fishing equipment, Kayak, Radio CD player, Snorkeling equipment, Stand up paddle (SUP), TV + DVD, Water skis, Wi-Fi Internet
Yacht electrics	Air Conditioning, Battery charger, Generator



WEBSITE

www.plujeme.cz



E-MAIL

info@plujeme.cz



PHONE

+420 720 755 085



MOBILE

+420 777 170 276



PLUJEME RÁDI S.R.O.

Dlouhá 730/35, 11000 Praha 1 – Staré Město, Czech Republic

SERVICES

SELECTED SERVICES	OBLIGATORY	PAYMENT TYPE	PRICE
<p>Half board (Payable at the base)</p> <p>Season: 2026. breakfast + lunch Food for children under the age of 2: Free of charge Food for children under the age of 11: - 50% Two weeks booked: - 5%</p>	Yes	per week/ person	500,00 €
<p>Port fee (Payable at the base)</p> <p>Season: 2026. Port fees, anchorages or private marina fees are to be paid on the spot according to the actual costs in each port/anchorage (in cash). This cost depends on the selected itinerary/ports of call. The gulet doesn't need to be in port or marina each day; the gulet can also be anchored, which reduces the mooring fees (estimated 1.000 € - 2.000 € per week, have to be paid in cash on the boat)</p>	Yes	per booking	1.500,00 €
<p>Tourist tax (Payable at the base)</p> <p>Season: 2026.</p>	Yes	per guest/night	2,00 €
<p>AC generator running over 12h/day (Payable at the base)</p> <p>Season: 2026. running over 12h/day</p>	No	per hour	20,00 €
<p>All inclusive domestic non alcoholic package (Payable at the base)</p> <p>Season: 2026. Water, tea, coffee, juices</p>	No	per week/ person	145,00 €
<p>All inclusive domestic package (Payable at the base)</p> <p>Season: 2026. (Includes Croatian-produced wine, beer, spirits, soft drinks, and hot beverages. *Specially ordered wines or premium wines, foreign alcoholic drinks like vodka, whiskey, gin, champagnes, etc., are extra cost if consumed</p>	No	per week/ person	290,00 €
<p>All inclusive package (Payable at the base)</p> <p>Season: 2026. soft drinks and hot beverages, beer, Croatian produced quality wine from boat bar list, also foreign spirits: Bombay Sapphire and Tanqueray gin, Absolut and Finlandia vodka, Johny Walker Red Label, Jameson, Sambuca, J. Cuervo Silver tequila, Amaretto, Vermouth, Jägermeister, Malibu, Aperol, Prosecco, Baileys. *Drinks not listed are not included and should be supplied and charged at special arrangement.</p>	No	per week/ person	470,00 €
<p>Base expenses: fuel charges (Payable at the base)</p> <p>Season: 2026. Fuel for sailing over 5h/day</p>	No	per hour	70,00 €

Corkage fee (Payable at the base)	No	per week	750,00 €
Season: 2026. Drinks and beverages are completely supplied by guests			
Fuel consumption (Payable at the base)	No	per hour	80,00 €
Season: 2026. Fuel for water sports that use tender (water ski, donut, wakeboard, etc..)			
Full board (Payable at the base)	No	per week/ person	700,00 €
Season: 2026. breakfas + lunch + dinner			
Gratuity (Payable at the base)	No	per booking	0,00 €
Season: 2026. Tips for the crew (customary is 5-10% of charter fee)			
One way (Payable at the base)	No	one-way	1.000,00 €
Season: 2026. to Dubrovnik (if empty leg caused)			
Transfer (Payable at the base)	No	one-way	0,00 €
Season: 2026. on request			



WEBSITE

www.plujeme.cz



E-MAIL

info@plujeme.cz



PHONE

+420 720 755 085



MOBILE

+420 777 170 276



PLUJEME RÁDI S.R.O.

Dlouhá 730/35, 11000 Praha 1 – Staré Město, Czech Republic

ADDITIONAL EXTRAS

EXTRA	OBLIGATORY	PAYMENT TYPE	PRICE
-------	------------	--------------	-------

**WEBSITE**

www.plujeme.cz

**E-MAIL**

info@plujeme.cz

**PHONE**

+420 720 755 085

**MOBILE**

+420 777 170 276

**PLUJEME RÁDI S.R.O.**

Dlouhá 730/35, 11000 Praha 1 – Staré Město, Czech Republic

PRICE AND AVAILABILITY

06.06. – 13.06.2026 17.955 € 18.900 €	13.06. – 20.06.2026 22.705 € 23.900 €	20.06. – 27.06.2026 22.705 € 23.900 €	27.06. – 04.07.2026 22.705 € 23.900 €
04.07. – 11.07.2026 NOT AVAILABLE	11.07. – 18.07.2026 NOT AVAILABLE	18.07. – 25.07.2026 NOT AVAILABLE	25.07. – 01.08.2026 24.605 € 25.900 €
01.08. – 08.08.2026 24.605 € 25.900 €	08.08. – 15.08.2026 24.605 € 25.900 €	15.08. – 22.08.2026 22.705 € 23.900 €	22.08. – 29.08.2026 22.705 € 23.900 €
29.08. – 05.09.2026 22.705 € 23.900 €	05.09. – 12.09.2026 22.705 € 23.900 €	12.09. – 19.09.2026 17.955 € 18.900 €	19.09. – 26.09.2026 17.955 € 18.900 €
26.09. – 03.10.2026 17.955 € 18.900 €	03.10. – 10.10.2026 17.955 € 18.900 €	10.10. – 17.10.2026 17.955 € 18.900 €	17.10. – 24.10.2026 17.955 € 18.900 €
24.10. – 31.10.2026 17.955 € 18.900 €	31.10. – 07.11.2026 17.955 € 18.900 €	07.11. – 14.11.2026 17.955 € 18.900 €	14.11. – 21.11.2026 17.955 € 18.900 €
21.11. – 28.11.2026 17.955 € 18.900 €	28.11. – 05.12.2026 17.955 € 18.900 €	05.12. – 12.12.2026 17.955 € 18.900 €	12.12. – 19.12.2026 17.955 € 18.900 €
19.12. – 26.12.2026 17.955 € 18.900 €	02.01. – 09.01.2027 18.900 €	09.01. – 16.01.2027 18.900 €	16.01. – 23.01.2027 18.900 €
23.01. – 30.01.2027 18.900 €	30.01. – 06.02.2027 18.900 €		



WEBSITE

www.plujeme.cz



E-MAIL

info@plujeme.cz



PHONE

+420 720 755 085



MOBILE

+420 777 170 276



PLUJEME RÁDI S.R.O.

Dlouhá 730/35, 11000 Praha 1 – Staré Město, Czech Republic

PRICE AND AVAILABILITY

06.02. - 13.02.2027 18.900 €	13.02. - 20.02.2027 18.900 €	20.02. - 27.02.2027 18.900 €	27.02. - 06.03.2027 18.900 €
06.03. - 13.03.2027 18.900 €	13.03. - 20.03.2027 18.900 €	20.03. - 27.03.2027 18.900 €	27.03. - 03.04.2027 18.900 €
03.04. - 10.04.2027 18.900 €	10.04. - 17.04.2027 18.900 €	17.04. - 24.04.2027 18.900 €	24.04. - 01.05.2027 18.900 €
01.05. - 08.05.2027 18.900 €	08.05. - 15.05.2027 18.900 €	15.05. - 22.05.2027 18.900 €	22.05. - 29.05.2027 18.900 €
29.05. - 05.06.2027 18.900 €	05.06. - 12.06.2027 18.900 €	12.06. - 19.06.2027 23.900 €	19.06. - 26.06.2027 23.900 €
26.06. - 03.07.2027 23.900 €	03.07. - 10.07.2027 23.900 €	10.07. - 17.07.2027 23.900 €	17.07. - 24.07.2027 25.900 €
24.07. - 31.07.2027 25.900 €	31.07. - 07.08.2027 25.900 €	07.08. - 14.08.2027 25.900 €	14.08. - 21.08.2027 23.900 €
21.08. - 28.08.2027 23.900 €	28.08. - 04.09.2027 23.900 €	04.09. - 11.09.2027 23.900 €	11.09. - 18.09.2027 18.900 €
18.09. - 25.09.2027 18.900 €	25.09. - 02.10.2027 18.900 €		



WEBSITE
www.plujeme.cz



E-MAIL
info@plujeme.cz



PHONE
+420 720 755 085



PLUJEME RÁDI S.R.O.
Dlouhá 730/35, 11000 Praha 1 – Staré Město, Czech Republic



MOBILE
+420 777 170 276

PRICE AND AVAILABILITY

02.10. - 09.10.2027 18.900 €	09.10. - 16.10.2027 18.900 €	16.10. - 23.10.2027 18.900 €	23.10. - 30.10.2027 18.900 €
30.10. - 06.11.2027 18.900 €	06.11. - 13.11.2027 18.900 €	13.11. - 20.11.2027 18.900 €	20.11. - 27.11.2027 18.900 €
27.11. - 04.12.2027 18.900 €	04.12. - 11.12.2027 18.900 €	11.12. - 18.12.2027 18.900 €	18.12. - 25.12.2027 18.900 €



WEBSITE

www.plujeme.cz



E-MAIL

info@plujeme.cz



PHONE

+420 720 755 085



MOBILE

+420 777 170 276



PLUJEME RÁDI S.R.O.

Dlouhá 730/35, 11000 Praha 1 – Staré Město, Czech Republic