

# DUFOUR 470

Ninna Nanna (2025)

Sailing yacht Dufour 470 Ninna Nanna, built in 2025 is anchored in the **Sardinia, Cannigione, Sardinia, Italy**. It has **4 cabins**, can accommodate **8 people** and has **4 toilets**. Bed linen and kitchen equipment are included in the price.

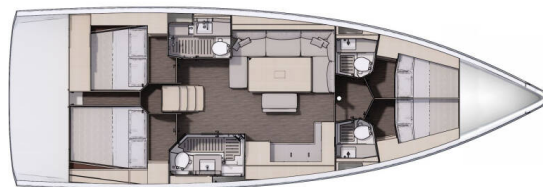

## YACHT SPECIFICATIONS

Yacht Base

**Sardinia, Cannigione, Italy**

Yacht ID

**10890**

Brands

**Dufour**

Yacht name

**Ninna Nanna**

Production year

**2025**

Length

**49 ft**

Cabins

**4**

Berths

**8**

WC

**4**

Engine

**1 x 60 HP**

Fuel tank

**250 l**



**WEBSITE**

[www.plujeme.cz](http://www.plujeme.cz)



**PHONE**

+420 720 755 085



**MOBILE**

+420 777 170 276



**E-MAIL**

[info@plujeme.cz](mailto:info@plujeme.cz)



**PLUJEME RÁDI S.R.O.**

Dlouhá 730/35, 11000 Praha 1 – Staré Město, Czech Republic

## STANDARD YACHT EQUIPMENT

Deck	<b>Bathing platform, Bimini top, Cockpit grill, Cockpit table, Cockpit/stern, outside shower, Electric anchor windlass, Sink in cockpit, Sprayhood, Teak cockpit, Tender</b>
Entertainment	<b>Audio pack, DVD player, Radio</b>
Galley	<b>Hot water, Refrigerator</b>
Interior	<b>Electric fans in cabins, Electric toilet</b>
Navigation	<b>Autopilot, Echosounder/Depthsounder, GPS chart plotter, Log, Speedometer (Speed log), Wind instrument/Anemometer</b>
Safety	<b>VHF radio</b>
Sails	<b>Lazy bag, Lazy jacks</b>
Yacht electrics	<b>Battery charger, Inverter, Solar panels, Watermaker - desalinator</b>



#### WEBSITE

[www.plujeme.cz](http://www.plujeme.cz)



#### E-MAIL

[info@plujeme.cz](mailto:info@plujeme.cz)



#### PHONE

+420 720 755 085



#### MOBILE

+420 777 170 276



#### PLUJEME RÁDI S.R.O.

Dlouhá 730/35, 11000 Praha 1 – Staré Město, Czech Republic

## SERVICES

SELECTED SERVICES	OBLIGATORY	PAYMENT TYPE	PRICE
<b>Breakfast</b> (Payable at the base) <b>Season: 2026.</b> Breakfast box - included in price	Yes	one-way	<b>0,00 €</b>
<b>Service Pack</b> (Payable now) <b>Season: 2026.</b> SERVICE PACK M4 S (final cleaning - gas bottle - bed linen 1 set/person - towels 1 set/person - 2 set snorkeling equipment)	Yes	per booking	<b>360,00 €</b>
<b>Welcome package</b> (Payable at the base) <b>Season: 2026.</b> Welcome pack with eco-friendly products - included in price	Yes	per booking	<b>0,00 €</b>
<b>Deposit insurance</b> (Payable now) <b>Season: 2026.</b> reduce deposit to 500€	No	per booking	<b>270,00 €</b>
<b>Made beds</b> (Payable at the base) <b>Season: 2026.</b> to be requested two weeks in advance	No	per cabin	<b>15,00 €</b>
<b>WI-FI Internet connection on boat</b> (Payable now) <b>Season: 2026.</b>	No	per week	<b>30,00 €</b>

**WEBSITE**[www.plujeme.cz](http://www.plujeme.cz)**E-MAIL**[info@plujeme.cz](mailto:info@plujeme.cz)**PHONE**

+420 720 755 085

**MOBILE**

+420 777 170 276

**PLUJEME RÁDI S.R.O.**

Dlouhá 730/35, 11000 Praha 1 – Staré Město, Czech Republic

## ADDITIONAL EXTRAS

EXTRA	OBLIGATORY	PAYMENT TYPE	PRICE
<b>Extra bedlinen</b> (Payable now) <b>Season: 2026.</b> Payable now	No	per person	<b>10,00 €</b>
<b>Outboard engine</b> (Payable now) <b>Season: 2026.</b> 50€ additional week - Payable now	No	per week	<b>100,00 €</b>
<b>Sea Scooter</b> (Payable now) <b>Season: 2026.</b> Payable now	No	per week	<b>180,00 €</b>
<b>Stand up paddle (SUP)</b> (Payable now) <b>Season: 2026.</b> Payable now	No	per week	<b>110,00 €</b>
<b>Towels</b> (Payable now) <b>Season: 2026.</b> Payable now	No	per person	<b>10,00 €</b>

**WEBSITE**[www.plujeme.cz](http://www.plujeme.cz)**E-MAIL**[info@plujeme.cz](mailto:info@plujeme.cz)**PHONE**

+420 720 755 085

**MOBILE**

+420 777 170 276

**PLUJEME RÁDI S.R.O.**

Dlouhá 730/35, 11000 Praha 1 – Staré Město, Czech Republic

## PRICE AND AVAILABILITY

02.05. - 09.05.2026 3.168 € 3.520 €	09.05. - 16.05.2026 NOT AVAILABLE	16.05. - 23.05.2026 3.168 € 3.520 €	23.05. - 30.05.2026 NOT AVAILABLE
30.05. - 06.06.2026 NOT AVAILABLE	06.06. - 13.06.2026 NOT AVAILABLE	13.06. - 20.06.2026 NOT AVAILABLE	20.06. - 27.06.2026 NOT AVAILABLE
27.06. - 04.07.2026 NOT AVAILABLE	04.07. - 11.07.2026 NOT AVAILABLE	11.07. - 18.07.2026 NOT AVAILABLE	18.07. - 25.07.2026 NOT AVAILABLE
25.07. - 01.08.2026 NOT AVAILABLE	01.08. - 08.08.2026 NOT AVAILABLE	08.08. - 15.08.2026 NOT AVAILABLE	15.08. - 22.08.2026 NOT AVAILABLE
22.08. - 29.08.2026 NOT AVAILABLE	29.08. - 05.09.2026 NOT AVAILABLE	05.09. - 12.09.2026 NOT AVAILABLE	12.09. - 19.09.2026 NOT AVAILABLE
19.09. - 26.09.2026 NOT AVAILABLE	26.09. - 03.10.2026 NOT AVAILABLE	03.10. - 10.10.2026 3.530 € 3.922 €	10.10. - 17.10.2026 3.537 € 3.930 €
17.10. - 24.10.2026 3.537 € 3.930 €	24.10. - 31.10.2026 3.537 € 3.930 €	31.10. - 07.11.2026 3.537 € 3.930 €	07.11. - 14.11.2026 3.537 € 3.930 €
14.11. - 21.11.2026 3.537 € 3.930 €	21.11. - 28.11.2026 3.537 € 3.930 €	28.11. - 05.12.2026 3.537 € 3.930 €	



WEBSITE  
[www.plujeme.cz](http://www.plujeme.cz)



E-MAIL  
[info@plujeme.cz](mailto:info@plujeme.cz)



PHONE  
+420 720 755 085



PLUJEME RÁDI S.R.O.  
Dlouhá 730/35, 11000 Praha 1 – Staré Město, Czech Republic



MOBILE  
+420 777 170 276

## PRICE AND AVAILABILITY

05.12. - 12.12.2026

**3.537 €** 3.930 €

12.12. - 19.12.2026

**3.537 €** 3.930 €

19.12. - 26.12.2026

**3.537 €** 3.930 €



### WEBSITE

[www.plujeme.cz](http://www.plujeme.cz)



### E-MAIL

[info@plujeme.cz](mailto:info@plujeme.cz)



### PHONE

+420 720 755 085



### MOBILE

+420 777 170 276



### PLUJEME RÁDI S.R.O.

Dlouhá 730/35, 11000 Praha 1 – Staré Město, Czech Republic