

LAGOON 38

Furia (2025)

Catamaran Lagoon 38 Furia, built in 2025 is anchored in the Marina Frapa, Rogoznica, Šibenik region, Croatia. It has 4 + 2 cabins, can accommodate 8 + 2 + 2 people and has 2 toilets. Bed linen and kitchen equipment are included in the price.

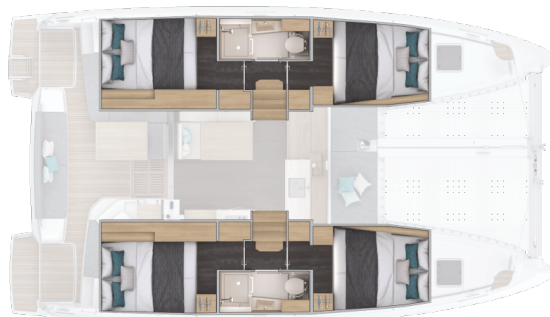

YACHT SPECIFICATIONS

Yacht Base

Marina Frapa, Rogoznica, Croatia

Yacht ID

10844

Brands

Lagoon

Yacht name

Furia

Production year

2025

Length

43 ft

Cabins

4 + 2

Berths

8 + 2 + 2

WC

2

Engine

2 x 30 HP

Fuel tank

01



WEBSITE

www.plujeme.cz



PHONE

+420 720 755 085



MOBILE

+420 777 170 276



E-MAIL

info@plujeme.cz



PLUJEME RÁDI S.R.O.

Dlouhá 730/35, 11000 Praha 1 – Staré Město, Czech Republic

STANDARD YACHT EQUIPMENT

Comfort	Bed linen, Cockpit cushions, Sundeck cushions, Towels
Deck	Bimini top, Bow sunbathing area, Cockpit table, Cockpit/stern, outside shower, Dinghy, Electric anchor windlass, Gangway, Outboard engine
Entertainment	Outdoor speakers, Stand up paddle (SUP) - FREE, TV
Galley	Freezer, Hot water, Ice maker, Oven, Refrigerator, Stove
Interior	Convertible table in salon, Curtains, Electric fans in cabins, Electric toilet, Hair dryer
Navigation	Autopilot, GPS chart plotter, Navigation (Nautical) charts and nautical guide, Pilot book, Raymarine navsystem (Tridata, Echo, Wind)
Safety	Black Water Tank, Liferaft, Safety equipment
Sails	Lazy bag
Yacht electrics	Air Conditioning, Bilge pump - Electric, Generator, Shore connection 220 V



WEBSITE

www.plujeme.cz



PHONE

+420 720 755 085



MOBILE

+420 777 170 276



E-MAIL

info@plujeme.cz









PLUJEME RÁDI S.R.O.

Dlouhá 730/35, 11000 Praha 1 – Staré Město, Czech Republic

SERVICES

SELECTED SERVICES	OBLIGATORY	PAYMENT TYPE	PRICE
Comfort pack (Payable now) Season: 2026. includes: final cleaning, bottle of wine, bottle of water, salt, sugar, aluminum foil, cling film, dish detergent with sponge, dishwasher tablets (if applicable), roll of rubbish bags, toilet paper (2 rolls per toilet), soap, table cloth, 5 kitchen towels, 2 rolls of paper towels, matches, hand, bath and beach towels, shower gel and hair shampoo (2 sets per cabin), hair dryer, Nespresso machine with 30 coffee pods, dinghy and outboard engine with 5L of fuel (not included with XPower, Antares 11 and Nimbus motor boats). All catamarans are provided with at least one SUP board.	Yes	per week	480,00 €
WI-FI Internet connection on boat (Payable at the base) Season: 2026. 40GB weekly included in price	Yes	per booking	0,00 €
APA (Advance Provisioning Allowance) (Payable now) Season: 2026. ***APA is obligatory if Hostess or Chef is hired. *** Should be paid with the last payment; Advance payment	No	per week	5.000,00 €
Chef (Payable now) Season: 2026. ***APA is obligatory if chef is hired. *** Advance payment	No	per week + food	1.750,00 €
Early Check in (Payable at the base) Season: 2026. VIP pack - Fast track (check in at 14:00h)	No	per booking	250,00 €
Hostess (Payable now) Season: 2026. ***APA is obligatory if hostess is hired. *** Advance payment	No	per week + food	1.575,00 €
One way (Payable at the base) Season: 2026. To Dubrovnik (disembark on Friday morning by 8.30 am) + mooring fees in Dubrovnik	No	one-way	650,00 €
Pet on board (Payable at the base) Season: 2026.	No	per booking	200,00 €
Skipper (Payable now) Season: 2026. Advance payment	No	per week + food	1.750,00 €

Transfer (Payable at the base) Season: 2026. price on request	No	one-way	0,00 €
	 WEBSITE www.plujeme.cz	 PHONE +420 720 755 085	 MOBILE +420 777 170 276
	 E-MAIL info@plujeme.cz	 PLUJEME RÁDI S.R.O. Dlouhá 730/35, 11000 Praha 1 – Staré Město, Czech Republic	

ADDITIONAL EXTRAS

EXTRA	OBLIGATORY	PAYMENT TYPE	PRICE
Donut (Payable at the base) Season: 2026. Payable at the base	No	per week	80,00 €
eFoil (Payable at the base) Season: 2026. Flite Air - Payable at the base	No	per week	1.400,00 €
eFoil (Payable at the base) Season: 2026. Lift Foil 5 - Payable at the base	No	per week	2.200,00 €
Electric scooter (Payable at the base) Season: 2026. Payable at the base	No	per week	120,00 €
Fishing equipment (Payable at the base) Season: 2026. Payable at the base	No	per week	200,00 €
Hammock (Payable at the base) Season: 2026. Water Hammock - Payable at the base	No	per week	220,00 €
JetBoard (Payable at the base) Season: 2026. Lampuga - Payable at the base	No	per week	1.800,00 €
JetBoard (Payable at the base) Season: 2026. Awake - Payable at the base	No	per week	2.000,00 €
Kayak (Payable at the base) Season: 2026. Payable at the base	No	per week	140,00 €
Railing net (Safety net) (Payable at the base) Season: 2026. Payable at the base	No	per booking	150,00 €
Sea Scooter (Payable at the base) Season: 2026. Jobe Navbow+ / Pro - Payable at the base	No	per week	300,00 €
Snorkeling equipment (Payable at the base) Season: 2026. per set - Payable at the base	No	per week	25,00 €
Stand up paddle (SUP) (Payable at the base) Season: 2026. Payable at the base	No	per week	120,00 €

Wakeboard (Payable at the base)

No

per week

120,00 €

Season: 2026. Payable at the base

Water skis (Payable at the base)

No

per week

120,00 €

Season: 2026. Payable at the base



WEBSITE

www.plujeme.cz



PHONE

+420 720 755 085



MOBILE

+420 777 170 276



E-MAIL

info@plujeme.cz



PLUJEME RÁDI S.R.O.

Dlouhá 730/35, 11000 Praha 1 – Staré Město, Czech Republic

PRICE AND AVAILABILITY

25.04. - 02.05.2026 1.495 € 2.300 €	02.05. - 09.05.2026 1.625 € 2.500 €	09.05. - 16.05.2026 1.625 € 2.500 €	16.05. - 23.05.2026 2.405 € 3.700 €
23.05. - 30.05.2026 NOT AVAILABLE	30.05. - 06.06.2026 NOT AVAILABLE	06.06. - 13.06.2026 3.780 € 5.400 €	13.06. - 20.06.2026 NOT AVAILABLE
20.06. - 27.06.2026 4.560 € 5.700 €	27.06. - 04.07.2026 NOT AVAILABLE	04.07. - 11.07.2026 ON OPTION	11.07. - 18.07.2026 5.270 € 6.200 €
18.07. - 25.07.2026 5.610 € 6.600 €	25.07. - 01.08.2026 NOT AVAILABLE	01.08. - 15.08.2026 NOT AVAILABLE	15.08. - 22.08.2026 4.675 € 5.500 €
22.08. - 29.08.2026 NOT AVAILABLE	29.08. - 05.09.2026 4.675 € 5.500 €	05.09. - 12.09.2026 NOT AVAILABLE	12.09. - 19.09.2026 ON OPTION
19.09. - 26.09.2026 3.360 € 4.200 €	26.09. - 03.10.2026 3.360 € 4.200 €	03.10. - 10.10.2026 NOT AVAILABLE	10.10. - 17.10.2026 1.955 € 2.300 €
17.10. - 24.10.2026 1.955 € 2.300 €	24.10. - 31.10.2026 1.955 € 2.300 €	31.10. - 07.11.2026 1.955 € 2.300 €	07.11. - 14.11.2026 2.125 € 2.500 €
15.11. - 31.12.2026 NOT AVAILABLE			



WEBSITE
www.plujeme.cz



E-MAIL
info@plujeme.cz



PHONE
+420 720 755 085



PLUJEME RÁDI S.R.O.
Dlouhá 730/35, 11000 Praha 1 – Staré Město, Czech Republic



MOBILE
+420 777 170 276