

# FOUNTAIN PAJOT TANNA 47 MAESTRO

Ramble On (2024)

Catamaran Fountaine Pajot Tanna 47 Maestro Ramble On, built in 2024 is anchored in the Bahamas, Abacos, Boat Harbour Marina, Abaco Islands, Bahamas. It has 3 + 1 cabins, can accommodate 6 + 1 people and has 3 toilets. Bed linen and kitchen equipment are included in the price.

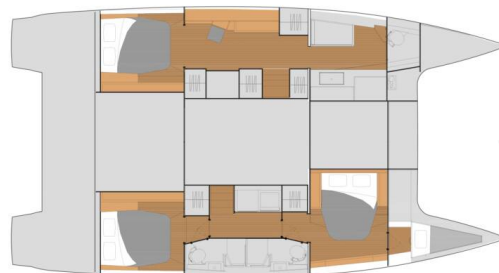

## YACHT SPECIFICATIONS

Yacht Base

**Bahamas, Abacos, Boat Harbour  
Marina, Bahamas**

Yacht ID

**10827**

Brands

**Fountaine Pajot**

Yacht name

**Ramble On**

Production year

**2024**

Length

**46 ft**

Cabins

**3 + 1**

Berths

**6 + 1**

WC

**3**

Engine

**2 x 0 HP**

Fuel tank

**940 l**



**WEBSITE**

[www.plujeme.cz](http://www.plujeme.cz)



**PHONE**

+420 720 755 085



**MOBILE**

+420 777 170 276



**E-MAIL**

[info@plujeme.cz](mailto:info@plujeme.cz)



**PLUJEME RÁDI S.R.O.**

Dlouhá 730/35, 11000 Praha 1 – Staré Město, Czech Republic

## STANDARD YACHT EQUIPMENT

Comfort	<b>Sundeck cushions</b>
Deck	<b>Bimini top, Cockpit fridge, Cockpit table, Cockpit/stern, outside shower, Davit, Dinghy with outboard engine, Electric anchor windlass, Flybridge, Grill/Barbecue/Plancha, Sprayhood</b>
Entertainment	<b>Indoor speakers, Outdoor speakers, Radio</b>
Galley	<b>Freezer, Kitchen utensils (Galley equipment, cutlery), Microwave, Oven, Refrigerator, Stove</b>
Interior	<b>Electric toilet</b>
Navigation	<b>Autopilot, GPS chart plotter - cockpit, Helm station, Wind/speed/depth instruments</b>
Safety	<b>VHF radio</b>
Sails	<b>Electric winch, Lazy bag, Lazy jacks</b>
Yacht electrics	<b>110V socket, Air Conditioning, Generator, Inverter, Shore power connection, Solar panels, USB sockets, Watermaker - desalinator</b>



**WEBSITE**

[www.plujeme.cz](http://www.plujeme.cz)



**PHONE**

+420 720 755 085



**MOBILE**

+420 777 170 276



**E-MAIL**

[info@plujeme.cz](mailto:info@plujeme.cz)



**PLUJEME RÁDI S.R.O.**

Dlouhá 730/35, 11000 Praha 1 – Staré Město, Czech Republic

## SERVICES

SELECTED SERVICES	OBLIGATORY	PAYMENT TYPE	PRICE
<b>Bahamas foreign charter tax</b> (Payable now) <b>Season: 2026.</b>	Yes	per booking	<b>0,00 €</b>
<b>Bahamas Taxes</b> (Payable now) <b>Season: 2026.</b>	Yes	per booking	<b>0,00 €</b>
<b>DRA</b> (Payable now) <b>Season: 2026.</b>	Yes	per day	<b>50,00 €</b>
<b>ASA Processing Fee</b> (Payable now) <b>Season: 2026.</b> Certificate 103	No	per person/per course	<b>150,00 €</b>
<b>ASA Processing Fee</b> (Payable now) <b>Season: 2026.</b> Certificate 101	No	per person/per course	<b>150,00 €</b>
<b>ASA Processing Fee</b> (Payable now) <b>Season: 2026.</b> Certificate 114	No	per person/per course	<b>200,00 €</b>
<b>ASA Processing Fee</b> (Payable now) <b>Season: 2026.</b> Certificate 104	No	per person/per course	<b>200,00 €</b>
<b>ASA Processing Fee</b> (Payable now) <b>Season: 2026.</b> Overnight Open Water. Available only on Flotilla Sails; Certificate 106	No	per person/per course	<b>250,00 €</b>
<b>ASA Processing Fee</b> (Payable now) <b>Season: 2026.</b> Certificate 101, 103 & 104	No	per person/per course	<b>400,00 €</b>
<b>ASA Processing Fee</b> (Payable now) <b>Season: 2026.</b> Overnight Open Water. Available only on Flotilla Sails; Certificate 105	No	per person/per course	<b>400,00 €</b>
<b>ASA Processing Fee</b> (Payable now) <b>Season: 2026.</b> Overnight Open Water. Available only on Flotilla Sails; Certificate 105 & 106	No	per person/per course	<b>550,00 €</b>
<b>Captain By Day</b> (Payable now) <b>Season: 2026.</b>	No	per day + food	<b>350,00 €</b>

<b>Captain By Night</b> (Payable now) <b>Season: 2026.</b>	No	per night	<b>450,00 €</b>
<b>Chef</b> (Payable now) <b>Season: 2026.</b> Overnight	No	per day + food	<b>400,00 €</b>
<b>Credit card surcharge</b> (Payable now) <b>Season: 2026.</b> A 3% convenience fee will be added to all credit card transactions	No	per booking	<b>0,00 €</b>
<b>Daily trips</b> (Payable now) <b>Season: 2026.</b> Trips north from Guana	No	per booking	<b>400,00 €</b>
<b>Education</b> (Payable at the base) <b>Season: 2026.</b> NauticEd skipper training hours	No	per person/per course	<b>100,00 €</b>
<b>Education</b> (Payable at the base) <b>Season: 2026.</b> NauticEd bareboat hours	No	per person/per course	<b>200,00 €</b>
<b>Extra cleaning</b> (Payable at the base) <b>Season: 2026.</b>	No	per service	<b>400,00 €</b>
<b>Fuel charge</b> (Payable now) <b>Season: 2026.</b> + 500,00\$ deposit; This is only for day trips	No	per booking	<b>300,00 €</b>
<b>Gratuity</b> (Payable now) <b>Season: 2026.</b> On Day Trips	No	per booking	<b>220,00 €</b>
<b>Hostess/Cook</b> (Payable now) <b>Season: 2026.</b>	No	per day + food	<b>350,00 €</b>
<b>Participation fee</b> (Payable at the base) <b>Season: 2026.</b> NauticEd sign up fee	No	per person/per course	<b>175,00 €</b>
<b>Rescheduling</b> (Payable now) <b>Season: 2026.</b> On Day Trips	No	per booking	<b>350,00 €</b>
<b>Sleep over after check out</b> (Payable now) <b>Season: 2026.</b>	No	per booking	<b>700,00 €</b>
<b>Sleep over before check in</b> (Payable now) <b>Season: 2026.</b> at 12:00 PM	No	per booking	<b>700,00 €</b>



**WEBSITE**  
www.plujeme.cz



**PHONE**  
+420 720 755 085



**MOBILE**  
+420 777 170 276



**E-MAIL**  
info@plujeme.cz



**PLUJEME RÁDI S.R.O.**  
Dlouhá 730/35, 11000 Praha 1 – Staré Město, Czech Republic

## ADDITIONAL EXTRAS

EXTRA	OBLIGATORY	PAYMENT TYPE	PRICE
<b>Fins</b> (Payable now) <b>Season: 2026.</b> Payable now	No	per week/ person	<b>35,00 €</b>
<b>Fishing cane/rod</b> (Payable now) <b>Season: 2026.</b> Payable now	No	per week	<b>60,00 €</b>
<b>Inflatable swimming platform</b> (Payable now) <b>Season: 2026.</b> POP-UP DOCK - Payable now	No	per week	<b>250,00 €</b>
<b>Kayak</b> (Payable now) <b>Season: 2026.</b> Tandem - Payable now	No	per week	<b>250,00 €</b>
<b>Snorkeling equipment</b> (Payable now) <b>Season: 2026.</b> Payable now	No	per week/ person	<b>50,00 €</b>
<b>Stand up paddle (SUP)</b> (Payable now) <b>Season: 2026.</b> Payable now	No	per week	<b>250,00 €</b>
<b>Starlink</b> (Payable now) <b>Season: 2026.</b> Payable now	No	per week	<b>100,00 €</b>



**WEBSITE**

[www.plujeme.cz](http://www.plujeme.cz)



**E-MAIL**

[info@plujeme.cz](mailto:info@plujeme.cz)



**PHONE**

+420 720 755 085



**MOBILE**

+420 777 170 276



**PLUJEME RÁDI S.R.O.**

Dlouhá 730/35, 11000 Praha 1 – Staré Město, Czech Republic

## PRICE AND AVAILABILITY

<b>24.04. - 03.05.2026</b> NOT AVAILABLE	<b>03.05. - 11.05.2026</b> NOT AVAILABLE	<b>13.05. - 20.05.2026</b> NOT AVAILABLE	<b>20.05. - 26.05.2026</b> NOT AVAILABLE
<b>31.05. - 08.06.2026</b> NOT AVAILABLE	<b>08.06. - 17.06.2026</b> NOT AVAILABLE	<b>19.06. - 28.06.2026</b> NOT AVAILABLE	<b>29.06. - 08.07.2026</b> NOT AVAILABLE
<b>08.07. - 14.07.2026</b> NOT AVAILABLE	<b>18.07. - 25.07.2026</b> <b>8.310 €</b>	<b>27.07. - 31.07.2026</b> NOT AVAILABLE	<b>01.08. - 04.11.2026</b> NOT AVAILABLE
<b>07.11. - 14.11.2026</b> <b>8.310 €</b>	<b>14.11. - 21.11.2026</b> <b>8.576 €</b>	<b>21.11. - 29.11.2026</b> NOT AVAILABLE	



### WEBSITE

[www.plujeme.cz](http://www.plujeme.cz)



### E-MAIL

[info@plujeme.cz](mailto:info@plujeme.cz)



### PHONE

+420 720 755 085



### MOBILE

+420 777 170 276



### PLUJEME RÁDI S.R.O.

Dlouhá 730/35, 11000 Praha 1 – Staré Město, Czech Republic

## PRICE AND AVAILABILITY

05.12. - 12.12.2026 8.310 €	12.12. - 19.12.2026 8.310 €	19.12. - 26.12.2026 8.018 €	02.01. - 09.01.2027 7.178 €
09.01. - 16.01.2027 6.350 €	16.01. - 23.01.2027 6.350 €	23.01. - 30.01.2027 6.350 €	30.01. - 06.02.2027 6.350 €
06.02. - 13.02.2027 6.350 €	13.02. - 20.02.2027 6.350 €	20.02. - 27.02.2027 6.350 €	27.02. - 06.03.2027 6.764 € 6.764 €
06.03. - 13.03.2027 7.799 €	19.03. - 28.03.2027 NOT AVAILABLE	03.04. - 10.04.2027 7.799 €	10.04. - 17.04.2027 7.799 €
17.04. - 24.04.2027 7.799 €	24.04. - 01.05.2027 8.018 €	01.05. - 08.05.2027 8.310 €	08.05. - 15.05.2027 8.310 €
15.05. - 22.05.2027 8.310 €	22.05. - 29.05.2027 8.310 €	29.05. - 05.06.2027 8.310 €	05.06. - 12.06.2027 8.310 €
12.06. - 19.06.2027 8.310 €	19.06. - 26.06.2027 8.310 €	26.06. - 03.07.2027 8.310 €	03.07. - 10.07.2027 8.310 €
10.07. - 17.07.2027 8.310 €	17.07. - 24.07.2027 8.310 €	24.07. - 31.07.2027 8.310 €	31.07. - 07.08.2027 8.310 €



WEBSITE

[www.plujeme.cz](http://www.plujeme.cz)



E-MAIL

[info@plujeme.cz](mailto:info@plujeme.cz)



PHONE

+420 720 755 085



MOBILE

+420 777 170 276



PLUJEME RÁDI S.R.O.

Dlouhá 730/35, 11000 Praha 1 – Staré Město, Czech Republic

## PRICE AND AVAILABILITY

07.08. - 14.08.2027 8.310 €	14.08. - 21.08.2027 8.310 €	21.08. - 28.08.2027 8.310 €	28.08. - 04.09.2027 8.310 €
04.09. - 11.09.2027 8.310 €	11.09. - 18.09.2027 8.310 €	18.09. - 25.09.2027 8.310 €	25.09. - 02.10.2027 8.310 €
02.10. - 09.10.2027 8.310 €	09.10. - 16.10.2027 8.310 €	16.10. - 23.10.2027 8.310 €	23.10. - 30.10.2027 8.310 €
30.10. - 06.11.2027 8.310 €	06.11. - 13.11.2027 8.310 €	13.11. - 20.11.2027 8.310 €	20.11. - 27.11.2027 8.310 €
27.11. - 04.12.2027 8.310 €	04.12. - 11.12.2027 8.310 €	11.12. - 18.12.2027 8.310 €	18.12. - 25.12.2027 8.091 €



### WEBSITE

[www.plujeme.cz](http://www.plujeme.cz)



### E-MAIL

[info@plujeme.cz](mailto:info@plujeme.cz)



### PHONE

+420 720 755 085



### MOBILE

+420 777 170 276



### PLUJEME RÁDI S.R.O.

Dlouhá 730/35, 11000 Praha 1 – Staré Město, Czech Republic