

OCEANIS 40.1

Eisner (2023)

Sailing yacht **Oceanis 40.1 Eisner**, built in **2023** is anchored in the **Marina Mandalina, Sibenik, Šibenik region, Croatia**. It has **4 + 1 cabins**, can accommodate **8 + 2 + 1 people** and has **2 + 1 toilets**. Bed linen and kitchen equipment are included in the price.

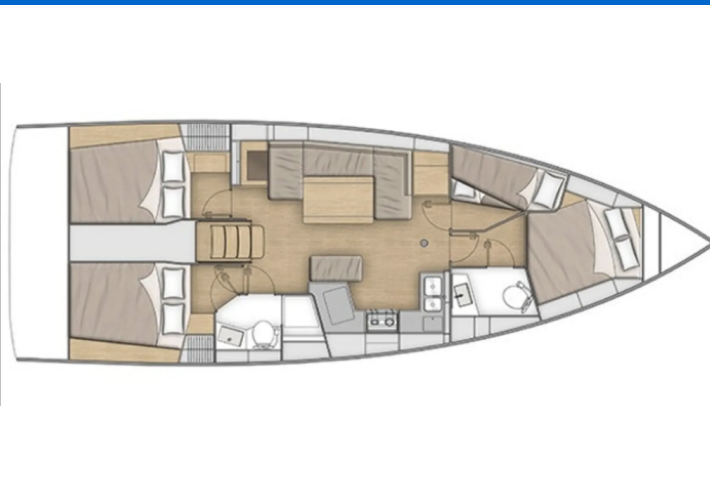

YACHT SPECIFICATIONS

Yacht Base

Marina Mandalina, Sibenik, Croatia

Yacht ID

10725

Brands

Beneteau

Yacht name

Eisner

Production year

2023

Length

42 ft

Cabins

4 + 1

Berths

8 + 2 + 1

WC

2 + 1

Engine

1 x 0 HP

Fuel tank

0 l



WEBSITE

www.plujeme.cz



PHONE

+420 720 755 085



MOBILE

+420 777 170 276



E-MAIL

info@plujeme.cz



PLUJEME RÁDI S.R.O.

Dlouhá 730/35, 11000 Praha 1 – Staré Město, Czech Republic

STANDARD YACHT EQUIPMENT

Deck	Bimini top, Cockpit/stern, outside shower, Dinghy, Electric anchor windlass, Sprayhood
Entertainment	Outdoor speakers
Galley	Hot water, Refrigerator
Interior	Electric toilet
Navigation	Autopilot, Bow thruster, Echosounder/Depthsonder, GPS chart plotter - cockpit, Wind instrument/Anemometer
Safety	Liferaft, VHF radio
Yacht electrics	Heating, Solar panels



WEBSITE

www.plujeme.cz



E-MAIL

info@plujeme.cz



PHONE

+420 720 755 085



MOBILE

+420 777 170 276



PLUJEME RÁDI S.R.O.

Dlouhá 730/35, 11000 Praha 1 – Staré Město, Czech Republic

SERVICES

SELECTED SERVICES	OBLIGATORY	PAYMENT TYPE	PRICE
Transit log (Payable at the base) Season: 2026.	Yes	per booking	250,00 €
Deposit insurance (Payable at the base) Season: 2026.	No	per booking	250,00 €
Early Check in (Payable at the base) Season: 2026. Check in from 11:00h, limited per 2 yachts	No	per booking	100,00 €
Pet on board (Payable at the base) Season: 2026.	No	per booking	80,00 €
Skipper (Payable at the base) Season: 2026.	No	per day + food	150,00 €

**WEBSITE**www.plujeme.cz**E-MAIL**info@plujeme.cz**PHONE**

+420 720 755 085

**MOBILE**

+420 777 170 276

**PLUJEME RÁDI S.R.O.**

Dlouhá 730/35, 11000 Praha 1 – Staré Město, Czech Republic

ADDITIONAL EXTRAS

EXTRA	OBLIGATORY	PAYMENT TYPE	PRICE
Gennaker (Payable at the base) Season: 2026. Deposit 300 € - Payable at the base	No	per booking	150,00 €
Outboard engine (Payable at the base) Season: 2026. Payable at the base	No	per booking	80,00 €
Paddle board (Payable at the base) Season: 2026. Payable at the base	No	per booking	100,00 €
Railing net (Safety net) (Payable at the base) Season: 2026. Payable at the base	No	per booking	50,00 €
Wi-Fi Internet (Payable at the base) Season: 2026. SIM card - Payable at the base	No	per booking	20,00 €



WEBSITE

www.plujeme.cz



E-MAIL

info@plujeme.cz



PHONE

+420 720 755 085



MOBILE

+420 777 170 276



PLUJEME RÁDI S.R.O.

Dlouhá 730/35, 11000 Praha 1 – Staré Město, Czech Republic

PRICE AND AVAILABILITY

13.06. - 20.06.2026 3.145 € 3.700 €	20.06. - 27.06.2026 NOT AVAILABLE	27.06. - 04.07.2026 NOT AVAILABLE	04.07. - 11.07.2026 NOT AVAILABLE
11.07. - 18.07.2026 NOT AVAILABLE	18.07. - 25.07.2026 NOT AVAILABLE	25.07. - 01.08.2026 NOT AVAILABLE	01.08. - 08.08.2026 NOT AVAILABLE
08.08. - 15.08.2026 NOT AVAILABLE	15.08. - 22.08.2026 NOT AVAILABLE	22.08. - 29.08.2026 NOT AVAILABLE	29.08. - 05.09.2026 NOT AVAILABLE
05.09. - 12.09.2026 3.103 € 3.650 €	12.09. - 19.09.2026 NOT AVAILABLE	19.09. - 26.09.2026 NOT AVAILABLE	26.09. - 03.10.2026 NOT AVAILABLE
03.10. - 10.10.2026 1.785 € 2.100 €	10.10. - 17.10.2026 1.785 € 2.100 €	17.10. - 24.10.2026 1.785 € 2.100 €	24.10. - 31.10.2026 1.785 € 2.100 €
31.10. - 07.11.2026 1.785 € 2.100 €	07.11. - 14.11.2026 1.785 € 2.100 €	14.11. - 21.11.2026 1.785 € 2.100 €	21.11. - 28.11.2026 1.785 € 2.100 €
28.11. - 05.12.2026 1.785 € 2.100 €	05.12. - 12.12.2026 1.785 € 2.100 €	12.12. - 19.12.2026 1.785 € 2.100 €	19.12. - 26.12.2026 1.785 € 2.100 €



WEBSITE
www.plujeme.cz



E-MAIL
info@plujeme.cz



PHONE
+420 720 755 085



PLUJEME RÁDI S.R.O.
Dlouhá 730/35, 11000 Praha 1 – Staré Město, Czech Republic



MOBILE
+420 777 170 276