

BALI 5.8

Puma (2026)

Catamaran Bali 5.8 Puma, built in 2026 is anchored in the Marina di Olbia Yachting Services, Sardinia, Italy. It has 6 + 2 cabins, can accommodate 12 people and has 8 toilets. Bed linen and kitchen equipment are included in the price.

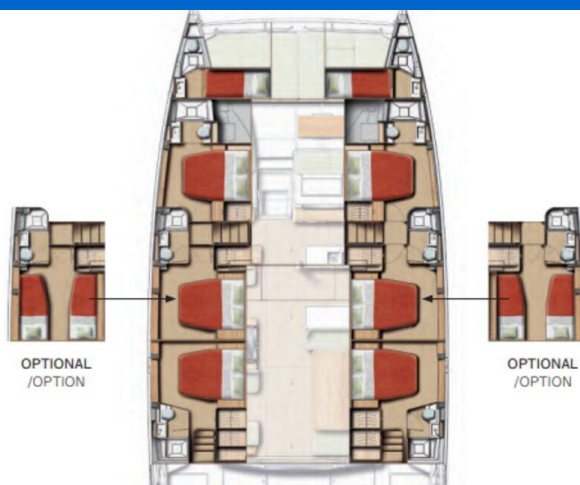

YACHT SPECIFICATIONS

Yacht Base

**Marina di Olbia Yachting Services,
Italy**

Yacht ID

10710

Brands

Catana

Yacht name

Puma

Production year

2026

Length

58 ft

Cabins

6 + 2

Berths

12

WC

8

Engine

2 x 115 HP

Fuel tank

1200 l



WEBSITE

www.plujeme.cz



PHONE

+420 720 755 085



MOBILE

+420 777 170 276



E-MAIL

info@plujeme.cz



PLUJEME RÁDI S.R.O.

Dlouhá 730/35, 11000 Praha 1 – Staré Město, Czech Republic

STANDARD YACHT EQUIPMENT

Deck	Teak cockpit
Entertainment	Underwater lights
Navigation	Radar
Yacht electrics	Air Conditioning, Generator, Inverter, Solar panels, Watermaker - desalinator



WEBSITE

www.plujeme.cz



E-MAIL

info@plujeme.cz



PHONE

+420 720 755 085



MOBILE

+420 777 170 276



PLUJEME RÁDI S.R.O.

Dlouhá 730/35, 11000 Praha 1 – Staré Město, Czech Republic

SERVICES

SELECTED SERVICES	OBLIGATORY	PAYMENT TYPE	PRICE
Charter pack (Payable at the base) Season: 2026. (including final cleaning, bed-linen & towel set, gas bottle for the kitchen)	Yes	per week	750,00 €
Crew (Payable at the base) Season: 2026. 1 skipper + 1 cook + 1 deckhand	Yes	per week + food	3.860,00 €
Dinghy with outboard engine (Payable at the base) Season: 2026.	Yes	per week	325,00 €
National parks permit (Payable at the base) Season: 2026.	Yes	per week	350,00 €
Towels (Payable at the base) Season: 2026.	Yes	per guest/week	10,00 €
Cook (Payable at the base) Season: 2026.	No	per week + food	1.400,00 €
Damage waiver (Payable at the base) Season: 2026.	No	per booking	595,00 €
Deckhand/ Marinero (Payable at the base) Season: 2026.	No	per week + food	1.200,00 €
Early boarding/check-in (Payable at the base) Season: 2026. at 15:30 pm	No	per week	395,00 €
Full board (Payable at the base) Season: 2026. including international breakfast, lunch and dinner; (excluding. Alcoholic beverages)	No	per week/ person	250,00 €
Hostess (Payable at the base) Season: 2026.	No	per week + food	1.400,00 €
Late Check in (Payable at the base) Season: 2026. after 8 pm	No	per week	155,00 €
Transfer (Payable at the base) Season: 2026. Transfer Olbia Airport / MOYS	No	one-way / person	30,00 €

WI-FI Internet connection on boat (Payable at the base)

No

per week

125,00 €

Season: 2026. Starlink WiFi, 50 GB

WI-FI Internet connection on boat (Payable at the base)

No

per week

225,00 €

Season: 2026. Starlink WiFi, unlimited GB



WEBSITE

www.plujeme.cz



E-MAIL

info@plujeme.cz



PHONE

+420 720 755 085



MOBILE

+420 777 170 276



PLUJEME RÁDI S.R.O.

Dlouhá 730/35, 11000 Praha 1 – Staré Město, Czech Republic

ADDITIONAL EXTRAS

EXTRA	OBLIGATORY	PAYMENT TYPE	PRICE
Beach towel (Payable at the base) Season: 2026. Payable at the base	No	per guest/week	10,00 €
Extra bedlinen (Payable at the base) Season: 2026. Payable at the base	No	per guest/week	10,00 €
Extra towels (Payable at the base) Season: 2026. Payable at the base	No	per guest/week	10,00 €
Grill/Barbecue/Plancha (Payable at the base) Season: 2026. including gas bottles - Payable at the base	No	per booking	165,00 €
Kayak (Payable at the base) Season: 2026. Payable at the base	No	per week	95,00 €
NESPRESSO coffee machine (Payable at the base) Season: 2026. including 40 capsules - Payable at the base	No	per week	65,00 €
Sea Scooter (Payable at the base) Season: 2026. Hagul - Payable at the base	No	per week	95,00 €
Sea Scooter (Payable at the base) Season: 2026. Tini - Payable at the base	No	per week	125,00 €
Sea Scooter (Payable at the base) Season: 2026. Navbow - Payable at the base	No	per week	275,00 €
Sea Scooter (Payable at the base) Season: 2026. Vapor SuBlue - Payable at the base	No	per week	475,00 €
Seabob (Payable at the base) Season: 2026. F5 SR top model - Payable at the base	No	per week	2.990,00 €
Snorkeling equipment (Payable at the base) Season: 2026. (mask + snorkel) - Payable at the base	No	per piece	10,00 €



WEBSITE
www.plujeme.cz



E-MAIL
info@plujeme.cz



PHONE
+420 720 755 085



PLUJEME RÁDI S.R.O.
Dlouhá 730/35, 11000 Praha 1 – Staré Město, Czech Republic



MOBILE
+420 777 170 276

PRICE AND AVAILABILITY

16.05. - 23.05.2026 17.813 € 23.750 €	23.05. - 30.05.2026 17.813 € 23.750 €	30.05. - 06.06.2026 NOT AVAILABLE	06.06. - 13.06.2026 NOT AVAILABLE
13.06. - 20.06.2026 26.560 €	20.06. - 27.06.2026 26.560 €	27.06. - 04.07.2026 33.440 €	04.07. - 11.07.2026 NOT AVAILABLE
11.07. - 18.07.2026 NOT AVAILABLE	18.07. - 25.07.2026 39.670 €	25.07. - 01.08.2026 39.670 €	01.08. - 08.08.2026 39.670 €
08.08. - 15.08.2026 39.670 €	15.08. - 22.08.2026 39.670 €	22.08. - 29.08.2026 39.670 €	29.08. - 05.09.2026 33.250 €
05.09. - 12.09.2026 24.938 € 33.250 €	12.09. - 19.09.2026 24.938 € 33.250 €	19.09. - 26.09.2026 19.995 € 26.660 €	26.09. - 03.10.2026 19.995 € 26.660 €
03.10. - 10.10.2026 18.113 € 24.150 €	10.10. - 17.10.2026 18.113 € 24.150 €	17.10. - 24.10.2026 18.113 € 24.150 €	24.10. - 31.10.2026 18.113 € 24.150 €
31.10. - 07.11.2026 18.113 € 24.150 €	07.11. - 14.11.2026 22.560 €	14.11. - 21.11.2026 22.560 €	21.11. - 28.11.2026 22.560 €
28.11. - 05.12.2026 22.560 €			



WEBSITE
www.plujeme.cz



E-MAIL
info@plujeme.cz



PHONE
+420 720 755 085



PLUJEME RÁDI S.R.O.
Dlouhá 730/35, 11000 Praha 1 – Staré Město, Czech Republic



MOBILE
+420 777 170 276

PRICE AND AVAILABILITY

05.12. - 12.12.2026

22.560 €

12.12. - 19.12.2026

22.560 €

19.12. - 26.12.2026

23.650 €



WEBSITE

www.plujeme.cz



E-MAIL

info@plujeme.cz



PHONE

+420 720 755 085



MOBILE

+420 777 170 276



PLUJEME RÁDI S.R.O.

Dlouhá 730/35, 11000 Praha 1 – Staré Město, Czech Republic