

# LEOPARD 45

La Pelosa II (2019)

Catamaran Leopard 45 La Pelosa II, built in 2019 is anchored in the **Seychelles, Eden Island Marina, Mahé, Seychelles**. It has **4 + 1 cabins**, can accommodate **8 + 1 people** and has **5 toilets**. Bed linen and kitchen equipment are included in the price.

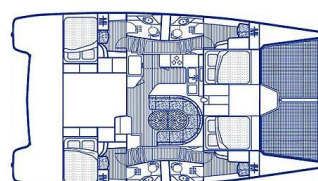

## YACHT SPECIFICATIONS

Yacht Base

**Seychelles, Eden Island Marina,  
Seychelles**

Yacht ID

**10701**

Brands

**Leopard**

Yacht name

**La Pelosa II**

Production year

**2019**

Length

**45 ft**

Cabins

**4 + 1**

Berths

**8 + 1**

WC

**5**

Engine

**2 x 45 HP**

Fuel tank

**700 l**



**WEBSITE**

[www.plujeme.cz](http://www.plujeme.cz)



**PHONE**

+420 720 755 085



**MOBILE**

+420 777 170 276



**E-MAIL**

[info@plujeme.cz](mailto:info@plujeme.cz)



**PLUJEME RÁDI S.R.O.**

Dlouhá 730/35, 11000 Praha 1 – Staré Město, Czech Republic

## STANDARD YACHT EQUIPMENT

Deck

**Teak cockpit**

Entertainment

**Snorkeling equipment**

Yacht electrics

**Air Conditioning, Generator, Inverter, Solar panels**



**WEBSITE**

[www.plujeme.cz](http://www.plujeme.cz)



**E-MAIL**

[info@plujeme.cz](mailto:info@plujeme.cz)



**PHONE**

+420 720 755 085



**MOBILE**

+420 777 170 276



**PLUJEME RÁDI S.R.O.**

Dlouhá 730/35, 11000 Praha 1 – Staré Město, Czech Republic

## SERVICES

SELECTED SERVICES	OBLIGATORY	PAYMENT TYPE	PRICE
<b>Bedlinen and towels</b> (Payable at the base) <b>Season: 2026.</b>	Yes	per guest/week	<b>25,00 €</b>
<b>Dinghy with outboard engine</b> (Payable at the base) <b>Season: 2026.</b>	Yes	per week	<b>225,00 €</b>
<b>Final cleaning</b> (Payable at the base) <b>Season: 2026.</b>	Yes	per booking	<b>250,00 €</b>
<b>Green Tax</b> (Payable at the base) <b>Season: 2026.</b> Environmental levy (tax)	Yes	per guest/night	<b>7,00 €</b>
<b>Cook</b> (Payable at the base) <b>Season: 2026.</b>	No	per week + food	<b>1.100,00 €</b>
<b>Full board</b> (Payable at the base) <b>Season: 2026.</b> including international breakfast, lunch and dinner; including mineral water still and sparkling; juices for breakfast; hot beverages) PS: this option requires to choose the cook	No	per guest/week	<b>175,00 €</b>
<b>Hostess</b> (Payable at the base) <b>Season: 2026.</b>	No	per week + food	<b>1.100,00 €</b>
<b>Skipper</b> (Payable at the base) <b>Season: 2026.</b>	No	per week + food	<b>1.200,00 €</b>
<b>WI-FI Internet connection on boat</b> (Payable at the base) <b>Season: 2026.</b> 4 GB	No	per week	<b>35,00 €</b>
<b>WI-FI Internet connection on boat</b> (Payable at the base) <b>Season: 2026.</b> 8 GB	No	per week	<b>60,00 €</b>



WEBSITE

[www.plujeme.cz](http://www.plujeme.cz)



E-MAIL

[info@plujeme.cz](mailto:info@plujeme.cz)



PHONE

+420 720 755 085



MOBILE

+420 777 170 276



PLUJEME RÁDI S.R.O.

Dlouhá 730/35, 11000 Praha 1 – Staré Město, Czech Republic

## ADDITIONAL EXTRAS

EXTRA	OBLIGATORY	PAYMENT TYPE	PRICE
<b>Beach towel</b> (Payable at the base) <b>Season: 2026.</b> Payable at the base	No	per guest/week	<b>10,00 €</b>
<b>Extra bedlinen</b> (Payable at the base) <b>Season: 2026.</b> Payable at the base	No	per guest/week	<b>10,00 €</b>
<b>Extra towels</b> (Payable at the base) <b>Season: 2026.</b> Payable at the base	No	per guest/week	<b>10,00 €</b>
<b>Kayak</b> (Payable at the base) <b>Season: 2026.</b> Payable at the base	No	per week	<b>80,00 €</b>
<b>Stand up paddle (SUP)</b> (Payable at the base) <b>Season: 2026.</b> Payable at the base	No	per week	<b>80,00 €</b>
<b>Stand up paddle (SUP)</b> (Payable at the base) <b>Season: 2026.</b> Payable at the base	No	per week	<b>95,00 €</b>

**WEBSITE**[www.plujeme.cz](http://www.plujeme.cz)**E-MAIL**[info@plujeme.cz](mailto:info@plujeme.cz)**PHONE**

+420 720 755 085

**MOBILE**

+420 777 170 276

**PLUJEME RÁDI S.R.O.**

Dlouhá 730/35, 11000 Praha 1 – Staré Město, Czech Republic

## PRICE AND AVAILABILITY

25.04. - 02.05.2026 NOT AVAILABLE	02.05. - 09.05.2026 6.280 €	09.05. - 16.05.2026 6.280 €	16.05. - 23.05.2026 5.190 €
23.05. - 30.05.2026 5.190 €	30.05. - 06.06.2026 5.190 €	06.06. - 13.06.2026 5.190 €	13.06. - 20.06.2026 5.190 €
20.06. - 27.06.2026 5.190 €	27.06. - 04.07.2026 5.190 €	04.07. - 11.07.2026 5.190 €	11.07. - 18.07.2026 5.190 €
18.07. - 25.07.2026 5.190 €	25.07. - 01.08.2026 5.190 €	01.08. - 08.08.2026 5.190 €	08.08. - 15.08.2026 5.190 €
15.08. - 22.08.2026 5.190 €	22.08. - 29.08.2026 5.190 €	29.08. - 05.09.2026 5.190 €	05.09. - 12.09.2026 5.190 €
12.09. - 19.09.2026 5.190 €	19.09. - 26.09.2026 6.380 €	26.09. - 03.10.2026 6.380 €	03.10. - 10.10.2026 6.380 €
10.10. - 17.10.2026 6.860 €	17.10. - 24.10.2026 6.860 €	24.10. - 07.11.2026 NOT AVAILABLE	07.11. - 14.11.2026 6.860 €
14.11. - 21.11.2026 6.860 €	21.11. - 28.11.2026 6.860 €	28.11. - 05.12.2026 6.380 €	



WEBSITE

[www.plujeme.cz](http://www.plujeme.cz)



E-MAIL

[info@plujeme.cz](mailto:info@plujeme.cz)



PHONE

+420 720 755 085



MOBILE

+420 777 170 276



PLUJEME RÁDI S.R.O.

Dlouhá 730/35, 11000 Praha 1 – Staré Město, Czech Republic

## PRICE AND AVAILABILITY

05.12. - 12.12.2026

6.380 €

12.12. - 19.12.2026

6.380 €

19.12. - 26.12.2026

7.980 €



### WEBSITE

[www.plujeme.cz](http://www.plujeme.cz)



### E-MAIL

[info@plujeme.cz](mailto:info@plujeme.cz)



### PHONE

+420 720 755 085



### MOBILE

+420 777 170 276



### PLUJEME RÁDI S.R.O.

Dlouhá 730/35, 11000 Praha 1 – Staré Město, Czech Republic