

FOUNTAIN PAJOT LUCIA 40

Merengue (2020)

Catamaran Fountaine Pajot Lucia 40 Merengue, built in 2020 is anchored in the **Porto Montenegro, Montenegro, Montenegro**. It has **4 cabins**, can accommodate **8 + 2 people** and has **4 toilets**. Bed linen and kitchen equipment are included in the price.

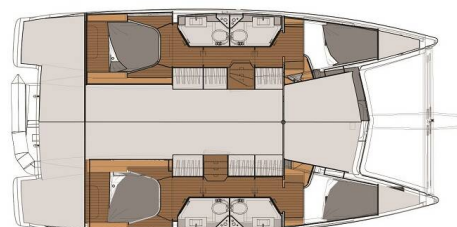

YACHT SPECIFICATIONS

Yacht Base

Porto Montenegro, Montenegro

Yacht ID

10610

Brands

Fountaine Pajot

Yacht name

Merengue

Production year

2020

Length

38 ft

Cabins

4

Berths

8 + 2

WC

4

Engine

2 x 30 HP

Fuel tank

530 l



WEBSITE

www.plujeme.cz



PHONE

+420 720 755 085



MOBILE

+420 777 170 276



E-MAIL

info@plujeme.cz



PLUJEME RÁDI S.R.O.

Dlouhá 730/35, 11000 Praha 1 – Staré Město, Czech Republic

STANDARD YACHT EQUIPMENT

Comfort	Cockpit cushions
Deck	Bimini top, Cockpit table, Cockpit/stern, outside shower, Dinghy, Electric anchor windlass, Fenders, Mooring ropes
Entertainment	Outdoor speakers, Radio, USB, Bluetooth, Snorkeling equipment, TV
Galley	Hot water, Kitchen utensils (Galley equipment, cutlery), Oven, Refrigerator, Stove
Interior	Electric fans in cabins, Electric toilet
Navigation	Autopilot, Binoculars, Depthsounder, GPS chart plotter, Navigation (Nautical) charts and nautical guide, Pilot book, Radar, Speedometer (Speed log), Windex
Safety	Black Water Tank, Fire extinguisher, First aid kit, Life jackets, Liferaft
Sails	Electric winch
Yacht electrics	220V socket, Inverter



WEBSITE

www.plujeme.cz



PHONE

+420 720 755 085



MOBILE

+420 777 170 276



E-MAIL

info@plujeme.cz



PLUJEME RÁDI S.R.O.

Dlouhá 730/35, 11000 Praha 1 – Staré Město, Czech Republic

SERVICES

SELECTED SERVICES	OBLIGATORY	PAYMENT TYPE	PRICE
Service Pack (Payable at the base) Season: 2026. Includes transit log, final cleaning, bed linen, towel and cooking gas	Yes	per booking	400,00 €
Base expenses - marina fees (Payable at the base) Season: 2026. Other Marinas booking service	No	per week	100,00 €
Concierge (Payable at the base) Season: 2026.	No	per week	450,00 €
Damage waiver (Payable at the base) Season: 2026. + €400 deposit	No	per booking	400,00 €
Early Check in (Payable at the base) Season: 2026. At 13:30h	No	per booking	200,00 €
Guide (Payable at the base) Season: 2026. Touristic guide	No	per day + food	120,00 €
Hostess (Payable at the base) Season: 2026.	No	per day + food	150,00 €
Late check out (Payable at the base) Season: 2026. Until 08:30h	No	per booking	200,00 €
Pet on board (Payable at the base) Season: 2026.	No	per booking	150,00 €
Regatta charge (Payable at the base) Season: 2026. security deposit for regatta + 2500 EUR	No	per week	400,00 €
Skipper (Payable at the base) Season: 2026.	No	per day + food	170,00 €
WI-FI Internet connection on boat (Payable at the base) Season: 2026. 512 GB	No	per week	40,00 €



WEBSITE
www.plujeme.cz



PHONE
+420 720 755 085



MOBILE
+420 777 170 276



E-MAIL
info@plujeme.cz



PLUJEME RÁDI S.R.O.
Dlouhá 730/35, 11000 Praha 1 – Staré Město, Czech Republic

ADDITIONAL EXTRAS

EXTRA	OBLIGATORY	PAYMENT TYPE	PRICE
Extra bedlinen (Payable at the base) Season: 2026. Payable at the base	No	per set	10,00 €
Extra towels (Payable at the base) Season: 2026. Payable at the base	No	per set	5,00 €
Gennaker (Payable at the base) Season: 2026. + €1500 deposit - Payable at the base	No	per week	250,00 €
Kayak tandem (Payable at the base) Season: 2026. Inflatable - Payable at the base	No	per week	200,00 €
Outboard engine (Payable at the base) Season: 2026. Payable at the base	No	per week	120,00 €
Railing net (Safety net) (Payable at the base) Season: 2026. Payable at the base	No	per booking	150,00 €
Seabike (Payable at the base) Season: 2026. Payable at the base	No	per week	100,00 €
Stand up paddle (SUP) (Payable at the base) Season: 2026. Payable at the base	No	per week	150,00 €
Towing air tube (Payable at the base) Season: 2026. For two - Payable at the base	No	per week	70,00 €



WEBSITE
www.plujeme.cz



E-MAIL
info@plujeme.cz



PHONE
+420 720 755 085



MOBILE
+420 777 170 276



PLUJEME RÁDI S.R.O.
Dlouhá 730/35, 11000 Praha 1 – Staré Město, Czech Republic

PRICE AND AVAILABILITY

06.06. - 13.06.2026 4.692 € 5.100 €	13.06. - 20.06.2026 NOT AVAILABLE	20.06. - 27.06.2026 NOT AVAILABLE	27.06. - 04.07.2026 5.152 € 5.600 €
04.07. - 11.07.2026 5.152 € 5.600 €	11.07. - 25.07.2026 NOT AVAILABLE	25.07. - 01.08.2026 5.520 € 6.000 €	01.08. - 08.08.2026 5.520 € 6.000 €
08.08. - 15.08.2026 5.520 € 6.000 €	15.08. - 22.08.2026 5.520 € 6.000 €	22.08. - 29.08.2026 NOT AVAILABLE	29.08. - 05.09.2026 5.152 € 5.600 €
05.09. - 12.09.2026 NOT AVAILABLE	12.09. - 19.09.2026 NOT AVAILABLE	19.09. - 26.09.2026 NOT AVAILABLE	26.09. - 03.10.2026 4.692 € 5.100 €
03.10. - 10.10.2026 NOT AVAILABLE	10.10. - 17.10.2026 3.450 € 3.750 €	17.10. - 24.10.2026 3.450 € 3.750 €	24.10. - 31.10.2026 3.450 € 3.750 €
31.10. - 07.11.2026 3.450 € 3.750 €	07.11. - 14.11.2026 NOT AVAILABLE	14.11. - 21.11.2026 NOT AVAILABLE	21.11. - 28.11.2026 2.300 € 2.500 €
28.11. - 05.12.2026 2.300 € 2.500 €	05.12. - 12.12.2026 2.300 € 2.500 €	12.12. - 19.12.2026 2.300 € 2.500 €	19.12. - 26.12.2026 2.300 € 2.500 €



WEBSITE

www.plujeme.cz



E-MAIL

info@plujeme.cz



PHONE

+420 720 755 085



MOBILE

+420 777 170 276



PLUJEME RÁDI S.R.O.

Dlouhá 730/35, 11000 Praha 1 – Staré Město, Czech Republic