

LAGOON 46

Shanti (2020)

Catamaran Lagoon 46 Shanti, built in 2020 is anchored in the Fethiye, Yacht Club Mai, Aegean, Turkey. It has 4 + 1 cabins, can accommodate 8 + 1 people and has 4 toilets. Bed linen and kitchen equipment are included in the price.

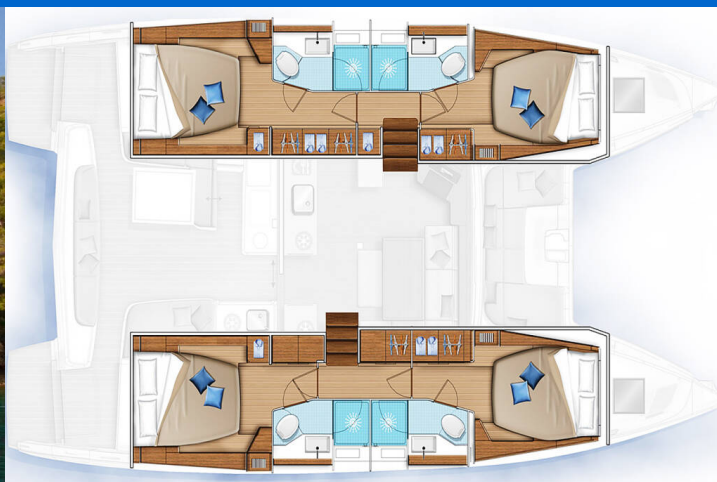

YACHT SPECIFICATIONS

Yacht Base

Fethiye, Yacht Club Mai, Turkey

Yacht ID

10588

Brands

Lagoon

Yacht name

Shanti

Production year

2020

Length

46 ft

Cabins

4 + 1

Berths

8 + 1

Max Persons

9

WC

4

Engine

2 x 0 HP

Fuel tank

1040 l



WEBSITE

www.plujeme.cz



E-MAIL

info@plujeme.cz



PHONE

+420 720 755 085



MOBILE

+420 777 170 276



PLUJEME RÁDI S.R.O.

Dlouhá 730/35, 11000 Praha 1 - Staré Město, Czech Republic

STANDARD YACHT EQUIPMENT

Comfort	Sun loungers
Deck	Bimini top, Cockpit fridge, Cockpit light, Deck lights, Dinghy, Dinghy hydraulic lifting system, Flybridge, Outboard engine
Entertainment	Fishing equipment, Fusion radio, Indoor speakers, Outdoor speakers
Galley	Dishwasher, Ice maker, Kitchen utensils (Galley equipment, cutlery), Oven, Stove
Interior	Convertible table in salon, Curtains, Electric fans, Electric toilet
Navigation	Autopilot, Navigation set
Sails	Electric winch, Lazy bag
Yacht electrics	Generator, Inverter, USB sockets, Watermaker - desalinator



WEBSITE

www.plujeme.cz



E-MAIL

info@plujeme.cz



PHONE

+420 720 755 085



MOBILE

+420 777 170 276





PLUJEME RÁDI S.R.O.

Dlouhá 730/35, 11000 Praha 1 – Staré Město, Czech Republic

SERVICES

SELECTED SERVICES	OBLIGATORY	PAYMENT TYPE	PRICE
Final cleaning (Payable at the base) Season: 2026.	Yes	per booking	250,00 €
Transit log (Payable at the base) Season: 2026. The mandatory official transitlog required by law in Turkey costs	Yes	per booking	200,00 €
Cook (Payable at the base) Season: 2026.	No	per day + food	180,00 €
Early boarding /Check in from 13:00 (Payable at the base) Season: 2026.	No	per booking	200,00 €
Hostess (Payable at the base) Season: 2026.	No	per day + food	150,00 €
One way fee (Payable at the base) Season: 2026. ONLY UPON REQUEST Surcharge for one-way trip Fethiye – Marmaris or vice versa for catamarans	No	per booking	600,00 €
Provisioning (Payable at the base) Season: 2026. on request, please contact to base	No	per booking	0,00 €
Skipper (Payable at the base) Season: 2026.	No	per day + food	200,00 €
Transfer (Payable at the base) Season: 2026. Transfer from Dalaman Airport to Fethiye / vice versa (max 6 people)	No	one-way	95,00 €
Transfer (Payable at the base) Season: 2026. Transfer from Dalaman Airport to Fethiye / vice versa (up to 14 people)	No	one-way	140,00 €
Transit log 1 (Payable at the base) Season: 2026. EXTRA, for crew change	No	per booking	100,00 €



WLAN on Board (Payable at the base)
Season: 2026. WLAN on board - UNLIMITED

 **WEBSITE**
www.plujeme.cz

 **E-MAIL**
info@plujeme.cz

 **PHONE**
 +420 720 755 089

 **MOBILE**
 +420 771 70 276

 **PLUJEME RÁDI S.R.O.**
 Dlouhá 730/35, 11000 Praha 1 – Staré Město, Czech Republic

100,00 €

ADDITIONAL EXTRAS

EXTRA	OBLIGATORY	PAYMENT TYPE	PRICE
Canoe (Payable at the base) Season: 2026. Payable at the base	No	per week	60,00 €
Extra bedlinen (Payable at the base) Season: 2026. includes: one linen, 2 pillowcases, 1 bedcover - Payable at the base	No	per set	20,00 €
Extra towels (Payable at the base) Season: 2026. includes: one head, one body towel - Payable at the base	No	per set	15,00 €
Freezer (Payable at the base) Season: 2026. Igloo - Payable at the base	No	per week	15,00 €
Hammock (Payable at the base) Season: 2026. Payable at the base	No	per week	30,00 €
NESPRESSO coffee machine (Payable at the base) Season: 2026. + 1 pac. Capsules - Payable at the base	No	per week	70,00 €
Railing net (Safety net) (Payable at the base) Season: 2026. Payable at the base	No	per booking	100,00 €
Seabob (Payable at the base) Season: 2026. please contact to base - Payable at the base	No	per week	0,00 €
Stand up paddle (SUP) (Payable at the base) Season: 2026. Payable at the base	No	per week	110,00 €
Sunshades (Payable at the base) Season: 2026. Front Cockpit Sun Shade - Payable at the base	No	per week	150,00 €
TV (Payable at the base) Season: 2026. Television 42' + WIFI - Payable at the base	No	per week	160,00 €



WEBSITE
www.plujeme.cz



PHONE
+420 720 755 085



MOBILE
+420 777 170 276



E-MAIL
info@plujeme.cz



PLUJEME RÁDI S.R.O.
Dlouhá 730/35, 11000 Praha 1 - Staré Město, Czech Republic

PRICE AND AVAILABILITY

25.04. - 02.05.2026 NOT AVAILABLE	02.05. - 09.05.2026 5.018 € 6.400 €	09.05. - 16.05.2026 NOT AVAILABLE	16.05. - 23.05.2026 5.645 € 6.400 €
23.05. - 30.05.2026 NOT AVAILABLE	30.05. - 06.06.2026 NOT AVAILABLE	06.06. - 13.06.2026 8.100 €	13.06. - 27.06.2026 NOT AVAILABLE
27.06. - 04.07.2026 NOT AVAILABLE	04.07. - 11.07.2026 8.100 €	11.07. - 18.07.2026 8.100 €	18.07. - 25.07.2026 8.100 €
25.07. - 01.08.2026 NOT AVAILABLE	01.08. - 15.08.2026 NOT AVAILABLE	15.08. - 22.08.2026 8.100 €	22.08. - 29.08.2026 NOT AVAILABLE
29.08. - 05.09.2026 8.100 €	05.09. - 12.09.2026 8.800 €	12.09. - 19.09.2026 8.800 €	19.09. - 26.09.2026 8.800 €
26.09. - 03.10.2026 8.800 €	03.10. - 10.10.2026 NOT AVAILABLE	10.10. - 17.10.2026 8.800 €	17.10. - 24.10.2026 8.800 €
24.10. - 31.10.2026 8.800 €	31.10. - 07.11.2026 8.100 €	07.11. - 14.11.2026 8.100 €	14.11. - 21.11.2026 7.400 €
21.11. - 28.11.2026 6.700 €	28.11. - 05.12.2026 5.000 €		



WEBSITE

www.plujeme.cz



E-MAIL

info@plujeme.cz



PHONE

+420 720 755 085



MOBILE

+420 777 170 276



PLUJEME RÁDI S.R.O.

Dlouhá 730/35, 11000 Praha 1 – Staré Město, Czech Republic

PRICE AND AVAILABILITY

05.12. - 12.12.2026

5.000 €

12.12. - 19.12.2026

5.000 €

19.12. - 26.12.2026

5.000 €



WEBSITE

www.plujeme.cz



E-MAIL

info@plujeme.cz



PHONE

+420 720 755 085



MOBILE

+420 777 170 276



PLUJEME RÁDI S.R.O.

Dlouhá 730/35, 11000 Praha 1 – Staré Město, Czech Republic