

# OCEANIS 37.1

Mercator (2025)

Sailing yacht **Oceanis 37.1 Mercator**, built in **2025** is anchored in the **Lefkas, Nikiana Marina, Ionian Islands, Greece**. It has **3 cabins**, can accommodate **6 people** and has **2 toilets**. Bed linen and kitchen equipment are included in the price.

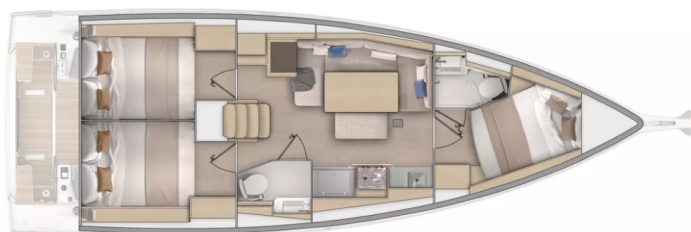

## YACHT SPECIFICATIONS

Yacht Base

**Lefkas, Nikiana Marina, Greece**

Yacht ID

**10528**

Brands

**Beneteau**

Yacht name

**Mercator**

Production year

**2025**

Length

**39 ft**

Cabins

**3**

Berths

**6**

Max Persons

**6**

WC

**2**

Engine

**1 x 0 HP**

Fuel tank

**130 l**



**WEBSITE**

[www.plujeme.cz](http://www.plujeme.cz)



**PHONE**

+420 720 755 085



**MOBILE**

+420 777 170 276



**E-MAIL**

[info@plujeme.cz](mailto:info@plujeme.cz)



**PLUJEME RÁDI S.R.O.**

Dlouhá 730/35, 11000 Praha 1 – Staré Město, Czech Republic

## STANDARD YACHT EQUIPMENT

Deck	<b>Dinghy, Sprayhood</b>
Entertainment	<b>Outdoor speakers, Radio CD player</b>
Galley	<b>Refrigerator</b>
Interior	<b>Electric toilet</b>
Navigation	<b>Autopilot, Bow thruster, GPS chart plotter</b>
Yacht electrics	<b>Solar panels</b>



#### WEBSITE

[www.plujeme.cz](http://www.plujeme.cz)



#### E-MAIL

[info@plujeme.cz](mailto:info@plujeme.cz)



#### PHONE

+420 720 755 085



#### MOBILE

+420 777 170 276



#### PLUJEME RÁDI S.R.O.

Dlouhá 730/35, 11000 Praha 1 – Staré Město, Czech Republic

## SERVICES

SELECTED SERVICES	OBLIGATORY	PAYMENT TYPE	PRICE
<b>Starter pack</b> (Payable at the base) <b>Season: 2026.</b> End cleaning, 1x Cooking gas, Water, Linen 1 set (2 sheets, 1 pillow case, 1 bath towel, 1 face towel) per person, Harbour fees for the first & last night. * If there is pet on board, then double cleaning will be applied.; Payable on the spot with cash 🎒 bag with Greek Local Products is offered to all of our charters as a welcome gift.	Yes	per booking	<b>250,00 €</b>
<b>Cook</b> (Payable at the base) <b>Season: 2026.</b> (Crew require their own cabin); Only responsible for daily cooking / provisioning and cleaning relevant to kitchen area; Payable on the spot with cash; Crew Cancellation Policy A Down payment of 25% is required upon confirmation, and the rest are payable on the spot with cash. Crew cancelled 4 weeks prior to embarkation will have 25% of total crew fee applicable. Crew cancelled less than 14 days prior to embarkation will have 100% of the total crew fee applicable.	No	per day + food	<b>200,00 €</b>
<b>Crew change</b> (Payable at the base) <b>Season: 2026.</b> Payable on the spot with cash Applicable only at one of our bases: Included : Formalities (contract, crew list, etc.) and one day of mooring fees. Not included: Yachts cleaning and laundry.	No	per booking	<b>150,00 €</b>
<b>Early boarding/check-in</b> (Payable at the base) <b>Season: 2026.</b> Access to the yacht by 14:00 In the event of delay beyond our control refunds will be made.; Payable on the spot with cash	No	per booking	<b>200,00 €</b>
<b>Hostess</b> (Payable at the base) <b>Season: 2026.</b> *crew require their own cabin; Payable on the spot with cash Crew Cancellation Policy A Down payment of 25% is required upon confirmation, and the rest are payable on the spot with cash. Crew cancelled 4 weeks prior to embarkation will have 25% of total crew fee applicable. Crew cancelled less than 14 days prior to embarkation will have 100% of the total crew fee applicable.	No	per day + food	<b>190,00 €</b>
<b>Internet pack</b> (Payable at the base) <b>Season: 2026.</b> +20 € per week after the 1st (WiFi hotspot for up to 5 devices and unlimited usage of internet); Payable on the spot with cash	No	per booking	<b>70,00 €</b>
<b>Linen Pack</b> (Payable at the base) <b>Season: 2026.</b> 1 Extra set of linen (2 sheets, 1 pillow case, 1 bath towel, 1 face towel); Payable on the spot with cash	No	per set	<b>10,00 €</b>

<p><b>Non refundable deposit/ insurance</b> (Payable at the base)</p> <p><b>Season: 2026.</b> + refundable deposit 500 EUR; non refundable payable on spot in cash and refundable payable by credit card on spot * Non-Refundable Deposit is mandatory on all skippered charters.</p>	No	per booking	<b>250,00 €</b>
<p><b>Skipper</b> (Payable at the base)</p> <p><b>Season: 2026.</b> (Crew require their own cabin); Payable on the spot with cash Crew Cancellation Policy A Down payment of 25% is required upon confirmation, and the rest are payable on the spot with cash. Crew cancelled 4 weeks prior to embarkation will have 25% of total crew fee applicable. Crew cancelled less than 14 days prior to embarkation will have 100% of the total crew fee applicable. Damage waiver is obligatory for skippered charters.</p>	No	per day + food	<b>210,00 €</b>
<p><b>Welcome package</b> (Payable at the base)</p> <p><b>Season: 2026.</b> Toilet and Kitchen rolls, matches, Plastic bags for rubbish, 1 Dish Sponge, 1 Dish, Soap, Sugar, Salt and Pepper, Coffee, 6 bottles of Water, 1 bottle of wine, 6 cans of Coke, 6 cans of Beer, Milk, Orange Juice; Payable on the spot with cash</p>	No	per booking	<b>70,00 €</b>



 **WEBSITE**  
www.plujeme.cz

 **E-MAIL**  
info@plujeme.cz

 **PHONE**  
+420 720 755 085

 **PLUJEME RÁDI S.R.O.**  
Dlouhá 730/35, 11000 Praha 1 – Staré Město, Czech Republic

 **MOBILE**  
+420 777 170 276

## ADDITIONAL EXTRAS

EXTRA	OBLIGATORY	PAYMENT TYPE	PRICE
<b>Automatic Inflatable Life Jacket</b> (Payable at the base) <b>Season: 2026.</b> Payable on the spot with cash - Payable at the base	No	per piece	<b>30,00 €</b>
<b>Beach towel</b> (Payable at the base) <b>Season: 2026.</b> Payable on the spot with cash - Payable at the base	No	per piece	<b>5,00 €</b>
<b>Bed linen</b> (Payable at the base) <b>Season: 2026.</b> Payable on the spot with cash - Payable at the base	No	per set	<b>10,00 €</b>
<b>Blister</b> (Payable at the base) <b>Season: 2026.</b> + additional security deposit 500EUR; Payable on the spot with cash - Payable at the base	No	per week	<b>200,00 €</b>
<b>Grill/Barbecue/Plancha</b> (Payable at the base) <b>Season: 2026.</b> Gas - Payable at the base	No	per week	<b>100,00 €</b>
<b>Kayak</b> (Payable at the base) <b>Season: 2026.</b> Payable on the spot with cash - Payable at the base	No	per week	<b>130,00 €</b>
<b>Life jacket (children)</b> (Payable at the base) <b>Season: 2026.</b> for children under 25 kg, one included in every yacht free of charge; Payable on the spot with cash - Payable at the base	No	per week/ person	<b>20,00 €</b>
<b>Outboard engine</b> (Payable at the base) <b>Season: 2026.</b> Payable on the spot with cash - Payable at the base	No	per week	<b>100,00 €</b>
<b>Railing net (Safety net)</b> (Payable at the base) <b>Season: 2026.</b> 200 € for yachts up to 46 ft., 300 € per week for yachts above 46ft & catamarans (Half price if the railing net is supplied uninstalled). Payable on the spot with cash - Payable at the base	No	per week	<b>200,00 €</b>
<b>SEA-D00 underwater scooter</b> (Payable at the base) <b>Season: 2026.</b> Payable on the spot with cash - Payable at the base	No	per week	<b>150,00 €</b>
<b>Snorkeling equipment</b> (Payable at the base) <b>Season: 2026.</b> The set contains mask, inhalator and flippers; Payable on the spot with cash - Payable at the base	No	per week/ person	<b>10,00 €</b>
<b>Stand up paddle (SUP)</b> (Payable at the base) <b>Season: 2026.</b> Payable on the spot with cash - Payable at the base	No	per week	<b>130,00 €</b>

 **WEBSITE**  
www.plujeme.cz

 **PHONE**  
+420 720 755 085

 **MOBILE**  
+420 777 170 276

 **E-MAIL**  
info@plujeme.cz

 **PLUJEME RÁDI S.R.O.**  
Dlouhá 730/35, 11000 Praha 1 - Staré Město, Czech Republic

## PRICE AND AVAILABILITY

<b>25.04. - 02.05.2026</b> <b>1.860 €</b> 2.550 €	<b>02.05. - 09.05.2026</b> <b>1.570 €</b> 2.550 €	<b>09.05. - 16.05.2026</b> NOT AVAILABLE	<b>16.05. - 23.05.2026</b> <b>1.720 €</b> 3.400 €
<b>23.05. - 30.05.2026</b> NOT AVAILABLE	<b>30.05. - 06.06.2026</b> NOT AVAILABLE	<b>06.06. - 20.06.2026</b> NOT AVAILABLE	<b>20.06. - 27.06.2026</b> NOT AVAILABLE
<b>27.06. - 04.07.2026</b> NOT AVAILABLE	<b>04.07. - 11.07.2026</b> NOT AVAILABLE	<b>11.07. - 18.07.2026</b> NOT AVAILABLE	<b>18.07. - 25.07.2026</b> NOT AVAILABLE
<b>25.07. - 01.08.2026</b> NOT AVAILABLE	<b>01.08. - 08.08.2026</b> NOT AVAILABLE	<b>08.08. - 15.08.2026</b> NOT AVAILABLE	<b>15.08. - 22.08.2026</b> NOT AVAILABLE
<b>22.08. - 29.08.2026</b> NOT AVAILABLE	<b>29.08. - 05.09.2026</b> NOT AVAILABLE	<b>05.09. - 12.09.2026</b> NOT AVAILABLE	<b>12.09. - 19.09.2026</b> NOT AVAILABLE
<b>19.09. - 03.10.2026</b> NOT AVAILABLE	<b>03.10. - 10.10.2026</b> <b>2.140 €</b> 2.200 €	<b>10.10. - 17.10.2026</b> <b>1.840 €</b> 2.200 €	<b>17.10. - 24.10.2026</b> <b>1.800 €</b> 2.200 €
<b>24.10. - 31.10.2026</b> <b>1.800 €</b> 2.200 €	<b>31.10. - 07.11.2026</b> <b>1.800 €</b> 2.200 €	<b>07.11. - 14.11.2026</b> <b>1.800 €</b> 2.200 €	<b>14.11. - 21.11.2026</b> <b>1.800 €</b> 2.200 €
<b>21.11. - 28.11.2026</b> <b>1.800 €</b> 2.200 €	<b>28.11. - 03.04.2027</b> NOT AVAILABLE		



**WEBSITE**

[www.plujeme.cz](http://www.plujeme.cz)



**E-MAIL**

[info@plujeme.cz](mailto:info@plujeme.cz)



**PHONE**

+420 720 755 085



**MOBILE**

+420 777 170 276



**PLUJEME RÁDI S.R.O.**

Dlouhá 730/35, 11000 Praha 1 – Staré Město, Czech Republic

## PRICE AND AVAILABILITY

03.04. - 10.04.2027 2.200 €	10.04. - 17.04.2027 2.200 €	17.04. - 24.04.2027 2.550 €	24.04. - 01.05.2027 2.550 €
01.05. - 08.05.2027 2.550 €	08.05. - 15.05.2027 2.550 €	15.05. - 22.05.2027 3.400 €	22.05. - 29.05.2027 3.400 €
29.05. - 05.06.2027 3.400 €	05.06. - 12.06.2027 3.400 €	12.06. - 19.06.2027 3.600 €	19.06. - 26.06.2027 3.600 €
26.06. - 03.07.2027 3.600 €	03.07. - 10.07.2027 3.600 €	10.07. - 17.07.2027 3.600 €	17.07. - 24.07.2027 3.600 €
24.07. - 31.07.2027 4.250 €	31.07. - 07.08.2027 4.250 €		



### WEBSITE

[www.plujeme.cz](http://www.plujeme.cz)



### E-MAIL

[info@plujeme.cz](mailto:info@plujeme.cz)



### PHONE

+420 720 755 085



### MOBILE

+420 777 170 276



### PLUJEME RÁDI S.R.O.

Dlouhá 730/35, 11000 Praha 1 – Staré Město, Czech Republic

## PRICE AND AVAILABILITY

07.08. - 14.08.2027 4.250 €	14.08. - 21.08.2027 3.600 €	21.08. - 28.08.2027 3.600 €	28.08. - 04.09.2027 3.600 €
04.09. - 11.09.2027 3.600 €	11.09. - 18.09.2027 3.400 €	18.09. - 25.09.2027 3.400 €	25.09. - 02.10.2027 2.550 €
02.10. - 09.10.2027 2.200 €	09.10. - 16.10.2027 2.200 €	16.10. - 23.10.2027 2.200 €	23.10. - 30.10.2027 2.200 €
30.10. - 06.11.2027 2.200 €	06.11. - 13.11.2027 2.200 €	13.11. - 20.11.2027 2.200 €	20.11. - 27.11.2027 2.200 €
27.11. - 04.12.2027 2.200 €	04.12. - 11.12.2027 2.200 €	11.12. - 18.12.2027 2.200 €	18.12. - 25.12.2027 2.200 €



### WEBSITE

[www.plujeme.cz](http://www.plujeme.cz)



### E-MAIL

[info@plujeme.cz](mailto:info@plujeme.cz)



### PHONE

+420 720 755 085



### MOBILE

+420 777 170 276



### PLUJEME RÁDI S.R.O.

Dlouhá 730/35, 11000 Praha 1 – Staré Město, Czech Republic