

# LAGOON 50

Echo (2023)

Catamaran **Lagoon 50 Echo**, built in **2023** is anchored in the **BVI, Tortola, Nanny Cay Marina, British Virgin Islands, British Virgin Islands**. It has **6 + 1 cabins**, can accommodate **12 + 1 people** and has **6 + 1 toilets**. Bed linen and kitchen equipment are included in the price.

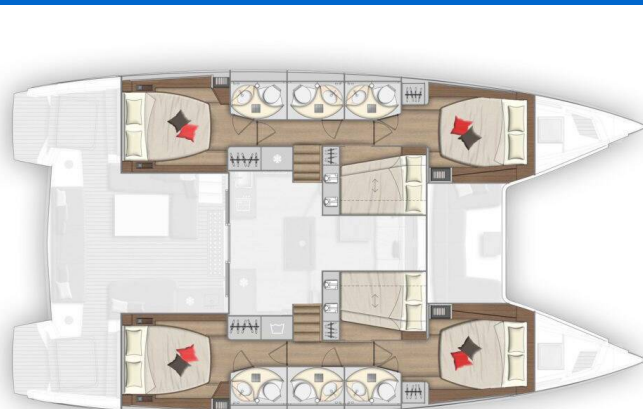

6 cabines 6 Salles de bain / 6 cabine 6 bathrooms

## YACHT SPECIFICATIONS

Yacht Base

**BVI, Tortola, Nanny Cay Marina,  
British Virgin Islands**

Yacht ID

**10509**

Brands

**Lagoon**

Yacht name

**Echo**

Production year

**2023**

Length

**48 ft**

Cabins

**6 + 1**

Berths

**12 + 1**

Max Persons

**13**

WC

**6 + 1**

Engine

**2 x 80 HP**

Fuel tank

**520 l**



**WEBSITE**

[www.plujeme.cz](http://www.plujeme.cz)



**PHONE**

+420 720 755 085



**MOBILE**

+420 777 170 276



**E-MAIL**

[info@plujeme.cz](mailto:info@plujeme.cz)



**PLUJEME RÁDI S.R.O.**

Dlouhá 730/35, 11000 Praha 1 - Staré Město, Czech Republic

## STANDARD YACHT EQUIPMENT

Comfort	<b>Cockpit cushions, Windscoops</b>
Deck	<b>Bimini top, Cockpit table, Cockpit/stern, outside shower, Dinghy ladder, Dinghy with outboard engine, Electric anchor windlass, Grill/Barbecue/Plancha, Main anchor, Spare anchor (Reserve, Auxiliary anchor), Swimming ladder</b>
Entertainment	<b>Bean Bag Chair, Outdoor speakers, Radio</b>
Galley	<b>Blender, Coffee pot, Electrical filter coffee maker, Electrical kettle, Hot water, Ice maker, Kitchen utensils (Galley equipment, cutlery), Microwave, Oven, Refrigerator, Stove, Toaster</b>
Interior	<b>Coolbox, Electric fans in cabins</b>
Navigation	<b>Autopilot, Binoculars, Compass, Depthsounder, GPS chart plotter, Navigation (Nautical) charts and nautical guide, Speedometer (Speed log), Tridata, Wind instrument/Anemometer</b>
Safety	<b>Black Water Tank, Distress flare box, Emergency tiller, Fire extinguisher, First aid kit, Flashlight, Fog horn, Horseshoe lifebuoy, Life jackets, Torch, VHF radio</b>
Sails	<b>Electric winch, Lazy bag, Lazy jacks, Self tailing (manual) winch</b>
Yacht electrics	<b>110V socket, Air Conditioning, Battery charger, Bilge pump - Electric, Generator, Inverter, Shore power connection, Watermaker - desalinator</b>



**WEBSITE**

[www.plujeme.cz](http://www.plujeme.cz)



**PHONE**

+420 720 755 085



**MOBILE**

+420 777 170 276



**E-MAIL**

[info@plujeme.cz](mailto:info@plujeme.cz)



**PLUJEME RÁDI S.R.O.**

Dlouhá 730/35, 11000 Praha 1 – Staré Město, Czech Republic

## SERVICES

SELECTED SERVICES	OBLIGATORY	PAYMENT TYPE	PRICE
<b>Cell phone</b> (Payable at the base) <b>Season: 2025-2026.</b> \$20/Rental includes \$10/top up	Yes	per booking	<b>20,00 €</b>
<b>Checkout Skipper</b> (Payable now) <b>Season: 2025-2026.</b> complimentary, to introduce you to your boat and the technical systems onboard	Yes	per service	<b>0,00 €</b>
<b>Damage waiver</b> (Payable at the base) <b>Season: 2025-2026.</b> \$70/night catamaran-\$700 max	Yes	per day	<b>70,00 €</b>
<b>National parks permit</b> (Payable at the base) <b>Season: 2025-2026.</b> 1-4 pax \$25/Week, \$5 per person per week there after	Yes	per week	<b>25,00 €</b>
<b>National parks permit</b> (Payable at the base) <b>Season: 2025-2026.</b> 5-6 pax \$35/Week, \$5 per person per week there after	Yes	per week	<b>35,00 €</b>
<b>National parks permit</b> (Payable at the base) <b>Season: 2025-2026.</b> 7-8 pax \$45/Week, \$5 per person per week there after	Yes	per week	<b>45,00 €</b>
<b>National parks permit</b> (Payable at the base) <b>Season: 2025-2026.</b> 9-10 pax \$55/Week, \$5 per person per week there after	Yes	per week	<b>55,00 €</b>
<b>National parks permit</b> (Payable at the base) <b>Season: 2025-2026.</b> 11 pax \$60/Week, \$5 per person per week there after	Yes	per week	<b>60,00 €</b>
<b>National parks permit</b> (Payable at the base) <b>Season: 2025-2026.</b> 12 pax \$60/Week, \$5 per person per week there after	Yes	per week	<b>65,00 €</b>
<b>Permit</b> (Payable at the base) <b>Season: 2025-2026.</b> Cruising Permit - \$4/ Per Person/ Per day	Yes	per guest/day	<b>4,00 €</b>
<b>Visar (Virgin Islands Search and Rescue)</b> (Payable at the base) <b>Season: 2025-2026.</b> \$5/ Per Person	Yes	per person	<b>5,00 €</b>
<b>ASA Logbook</b> (Payable at the base) <b>Season: 2025-2026.</b>	No	per piece	<b>23,00 €</b>
<b>ASA Skipper</b> (Payable now) <b>Season: 2025-2026.</b> ASA Certified Instructor - Does not include provisioning for instructor/skipper	No	per day + food	<b>325,00 €</b>

<b>Cancellation insurance</b> (Payable now)	No	per booking	<b>200,00 €</b>
<b>Season: 2025-2026.</b> The charter fee is non-refundable unless \$200 Charter Cancellation Insurance is purchased, which allows for a refund (less a \$500 fee) if cancelled more than 90 days before, or if the period is resold within 90 days, while cancellations without insurance receive no refund and weather-related interruptions only qualify for future charter credit.			
<b>Chill pack</b> (Payable at the base)	No	per day	<b>35,00 €</b>
<b>Season: 2025-2026.</b> ISLAND CHILL PACK (Hammock, Beach Shade, 2 cooler backpacks, 4 noodles and a 7ft Water Hammock)			
<b>Fun Pack</b> (Payable at the base)	No	per day	<b>85,00 €</b>
<b>Season: 2025-2026.</b> ULTRA FUN PACK (2 SUP's, 4 Floating Mats, Dinghy Ladder, 4 Noodles, Hammock and 7 ft Water Hammock)			
<b>Fun Pack</b> (Payable at the base)	No	per day	<b>96,00 €</b>
<b>Season: 2025-2026.</b> TOO MUCH FUN PACK (2 SUP's, 6 Floating Mats, Dinghy Ladder, 6 Noodles, Hammock, 2 Cooler Backpacks and 7 ft Water Hammock)			
<b>Fun Pack</b> (Payable at the base)	No	per day	<b>362,00 €</b>
<b>Season: 2025-2026.</b> TOO MUCH FUN RELOADED - SUPERTENDER OPTION (2x SUP's, 6 Floating Mats, Dinghy Ladder, 6 Noodles, Hammock, 2 Cooler Backpacks, 7 ft Water Hammock and the Super Tender)			
<b>Relax pack</b> (Payable at the base)	No	per day	<b>36,00 €</b>
<b>Season: 2025-2026.</b> MAX RELAX PACK (1 SUP, 2 floating mats, Dinghy Ladder and 4 Noodles)			
<b>Skipper</b> (Payable now)	No	per day + food	<b>275,00 €</b>
<b>Season: 2025-2026.</b> Does not include provisioning for the skipper			
<b>Sleep over before check in</b> (Payable at the base)	No	per person	<b>75,00 €</b>
<b>Season: 2025-2026.</b> 5pm boarding night prior / minimum \$200 for the night! minimum of \$200 if is used by 1 or 2 people!			
<b>Steward/Cook</b> (Payable now)	No	per day + food	<b>275,00 €</b>
<b>Season: 2025-2026.</b> Does not include provisioning			



**WEBSITE**  
www.plujeme.cz



**PHONE**  
+420 720 755 085



**MOBILE**  
+420 777 170 276



**E-MAIL**  
info@plujeme.cz



**PLUJEME RÁDI S.R.O.**  
Dlouhá 730/35, 11000 Praha 1 – Staré Město, Czech Republic

## ADDITIONAL EXTRAS

EXTRA	OBLIGATORY	PAYMENT TYPE	PRICE
<b>Beach canopy</b> (Payable at the base) <b>Season: 2025-2026.</b> Rental - Payable at the base	No	per day	<b>6,00 €</b>
<b>Cooling bag</b> (Payable at the base) <b>Season: 2025-2026.</b> Insulated Cooler Backpack - Rental - Payable at the base	No	per day	<b>3,00 €</b>
<b>Floating mats</b> (Payable at the base) <b>Season: 2025-2026.</b> Single Floating Mattress - Rental - Payable at the base	No	per day	<b>3,00 €</b>
<b>Floating mats</b> (Payable at the base) <b>Season: 2025-2026.</b> Large Floating Mattress - Rental - Payable at the base	No	per day	<b>18,00 €</b>
<b>Hammock</b> (Payable at the base) <b>Season: 2025-2026.</b> Cloth Hammock- Rental - Payable at the base	No	per day	<b>4,00 €</b>
<b>Hammock</b> (Payable at the base) <b>Season: 2025-2026.</b> water hammock 7ft - Rental - Payable at the base	No	per day	<b>20,00 €</b>
<b>Hammock</b> (Payable at the base) <b>Season: 2025-2026.</b> water hammock 10ft - Rental - Payable at the base	No	per day	<b>35,00 €</b>
<b>Kayak</b> (Payable at the base) <b>Season: 2025-2026.</b> Rental - Payable at the base	No	per day	<b>17,00 €</b>
<b>Kayak tandem</b> (Payable at the base) <b>Season: 2025-2026.</b> Rental - Payable at the base	No	per day	<b>18,00 €</b>
<b>Noodles</b> (Payable at the base) <b>Season: 2025-2026.</b> Vinyl Covered pool noodle - Rental - Payable at the base	No	per day	<b>1,00 €</b>
<b>Stand up paddle (SUP)</b> (Payable at the base) <b>Season: 2025-2026.</b> Rental - Payable at the base	No	per day	<b>25,00 €</b>
<b>Tender</b> (Payable now) <b>Season: 2025-2026.</b> Super Tender Upgrade- 15ft Rib + 60hp Yamaha Outboard- must be towed not hoisted by davits - Payable now	No	per day	<b>295,00 €</b>

**VHF headset** (Payable at the base) No per day **8,00 €**

**Season: 2025-2026.** Rental - Payable at the base

**Wi-Fi Internet** (Payable at the base) No per day **28,00 €**

**Season: 2025-2026.** Rental + \$100 Security Deposit paid at base as a pre-  
authorisation on CC. - Payable at the base



**WEBSITE**

[www.plujeme.cz](http://www.plujeme.cz)



**E-MAIL**

[info@plujeme.cz](mailto:info@plujeme.cz)



**PHONE**

+420 720 755 085



**MOBILE**

+420 777 170 276



**PLUJEME RÁDI S.R.O.**

Dlouhá 730/35, 11000 Praha 1 – Staré Město, Czech Republic

## PRICE AND AVAILABILITY

25.04. - 02.05.2026 14.885 €	02.05. - 09.05.2026 14.162 € 14.885 €	10.05. - 21.05.2026 NOT AVAILABLE	21.05. - 27.05.2026 NOT AVAILABLE
27.05. - 01.06.2026 NOT AVAILABLE	01.06. - 10.06.2026 NOT AVAILABLE	10.06. - 19.06.2026 NOT AVAILABLE	21.06. - 28.06.2026 NOT AVAILABLE
04.07. - 11.07.2026 14.800 €	11.07. - 18.07.2026 14.268 € 14.289 €	23.07. - 01.08.2026 NOT AVAILABLE	01.08. - 08.08.2026 13.595 € 14.289 €
08.08. - 15.08.2026 14.289 €	20.08. - 30.09.2026 NOT AVAILABLE	03.10. - 10.10.2026 14.289 €	10.10. - 17.10.2026 14.289 €
17.10. - 24.10.2026 14.289 €	24.10. - 31.10.2026 14.289 €	31.10. - 07.11.2026 14.800 €	07.11. - 14.11.2026 14.885 €
14.11. - 21.11.2026 14.885 €	21.11. - 28.11.2026 14.588 € 14.885 €		



**WEBSITE**  
[www.plujeme.cz](http://www.plujeme.cz)



**E-MAIL**  
[info@plujeme.cz](mailto:info@plujeme.cz)



**PHONE**  
+420 720 755 085



**PLUJEME RÁDI S.R.O.**  
Dlouhá 730/35, 11000 Praha 1 – Staré Město, Czech Republic



**MOBILE**  
+420 777 170 276

## PRICE AND AVAILABILITY

01.12. - 14.12.2026 NOT AVAILABLE	19.12. - 26.12.2026 <b>16.433 €</b> 17.272 €	27.12. - 04.01.2027 NOT AVAILABLE	09.01. - 16.01.2027 <b>16.079 €</b>
16.01. - 23.01.2027 <b>16.079 €</b>	24.01. - 01.02.2027 NOT AVAILABLE	06.02. - 13.02.2027 <b>16.707 €</b>	13.02. - 22.02.2027 NOT AVAILABLE
27.02. - 06.03.2027 <b>16.675 €</b>	06.03. - 13.03.2027 <b>16.675 €</b>	13.03. - 20.03.2027 <b>16.675 €</b>	20.03. - 27.03.2027 <b>16.675 €</b>
31.03. - 11.04.2027 NOT AVAILABLE	17.04. - 24.04.2027 <b>16.675 €</b>	24.04. - 01.05.2027 <b>14.384 €</b> 15.141 €	01.05. - 08.05.2027 <b>14.141 €</b> 14.885 €
08.05. - 15.05.2027 <b>14.141 €</b> 14.885 €	15.05. - 22.05.2027 <b>14.141 €</b> 14.885 €	22.05. - 29.05.2027 <b>14.141 €</b> 14.885 €	29.05. - 05.06.2027 <b>14.141 €</b> 14.885 €
05.06. - 12.06.2027 <b>14.141 €</b> 14.885 €	12.06. - 19.06.2027 <b>14.141 €</b> 14.885 €	19.06. - 26.06.2027 <b>14.141 €</b> 14.885 €	26.06. - 03.07.2027 <b>14.141 €</b> 14.885 €
03.07. - 10.07.2027 <b>14.141 €</b> 14.885 €			



**WEBSITE**  
[www.plujeme.cz](http://www.plujeme.cz)



**E-MAIL**  
[info@plujeme.cz](mailto:info@plujeme.cz)



**PHONE**  
+420 720 755 085



**PLUJEME RÁDI S.R.O.**  
Dlouhá 730/35, 11000 Praha 1 – Staré Město, Czech Republic



**MOBILE**  
+420 777 170 276

## PRICE AND AVAILABILITY

20.08. - 30.09.2027

NOT AVAILABLE



### WEBSITE

[www.plujeme.cz](http://www.plujeme.cz)



### E-MAIL

[info@plujeme.cz](mailto:info@plujeme.cz)



### PHONE

+420 720 755 085



### MOBILE

+420 777 170 276



### PLUJEME RÁDI S.R.O.

Dlouhá 730/35, 11000 Praha 1 – Staré Město, Czech Republic