

LAGOON 46

Southern Isle (2024)

Catamaran Lagoon 46 Southern Isle, built in 2024 is anchored in the BVI, Tortola, Nanny Cay Marina, British Virgin Islands, British Virgin Islands. It has 4 + 1 cabins, can accommodate 8 + 1 people and has 5 toilets. Bed linen and kitchen equipment are included in the price.

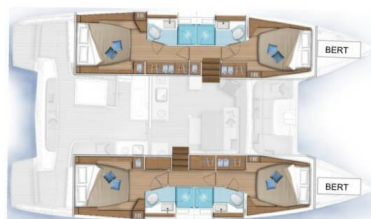

YACHT SPECIFICATIONS

Yacht Base

**BVI, Tortola, Nanny Cay Marina,
British Virgin Islands**

Yacht ID

10508

Brands

Lagoon

Yacht name

Southern Isle

Production year

2024

Length

46 ft

Cabins

4 + 1

Berths

8 + 1

Max Persons

9

WC

5

Engine

2 x 57 HP

Fuel tank

520 l



WEBSITE

www.plujeme.cz



PHONE

+420 720 755 085



MOBILE

+420 777 170 276



E-MAIL

info@plujeme.cz



PLUJEME RÁDI S.R.O.

Dlouhá 730/35, 11000 Praha 1 – Staré Město, Czech Republic

STANDARD YACHT EQUIPMENT

Comfort	Cockpit cushions, Windscoops
Deck	Bimini top, Cockpit table, Cockpit/stern, outside shower, Dinghy with outboard engine, Electric anchor windlass, Grill/Barbecue/Plancha, Main anchor, Spare anchor (Reserve, Auxiliary anchor), Swimming ladder
Entertainment	Outdoor speakers, Radio
Galley	Blender, Coffee pot, Electrical filter coffee maker, Electrical kettle, Hot water, Ice maker, Kitchen utensils (Galley equipment, cutlery), Microwave, Oven, Refrigerator, Stove, Toaster
Interior	Coolbox, Electric fans in cabins
Navigation	Autopilot, Binoculars, Compass, Depthsounder, GPS chart plotter, Navigation (Nautical) charts and nautical guide, Speedometer (Speed log), Tridata, Wind instrument/Anemometer
Safety	Black Water Tank, Distress flare box, Emergency tiller, Fire extinguisher, First aid kit, Flashlight, Fog horn, Horseshoe lifebuoy, Life jackets, Torch, VHF radio
Sails	Electric winch, Lazy bag, Lazy jacks, Self tailing (manual) winch
Yacht electrics	110V socket, Air Conditioning, Battery charger, Bilge pump - Electric, Generator, Inverter, Shore power connection, Watermaker - desalinator



WEBSITE

www.plujeme.cz



E-MAIL

info@plujeme.cz



PHONE

+420 720 755 085



MOBILE

+420 777 170 276



PLUJEME RÁDI S.R.O.

Dlouhá 730/35, 11000 Praha 1 – Staré Město, Czech Republic

SERVICES

SELECTED SERVICES	OBLIGATORY	PAYMENT TYPE	PRICE
Cell phone (Payable at the base) Season: 2025-2026. \$20/Rental includes \$10/top up	Yes	per booking	20,00 €
Damage waiver (Payable at the base) Season: 2025-2026. \$70/night catamaran-\$700 max	Yes	per day	70,00 €
National parks permit (Payable at the base) Season: 2025-2026. 1-4 pax \$25/Week, \$5 per person per week there after	Yes	per week	25,00 €
National parks permit (Payable at the base) Season: 2025-2026. 5-6 pax \$35/Week, \$5 per person per week there after	Yes	per week	35,00 €
National parks permit (Payable at the base) Season: 2025-2026. 7-8 pax \$45/Week, \$5 per person per week there after	Yes	per week	45,00 €
National parks permit (Payable at the base) Season: 2025-2026. 9-10 pax \$55/Week, \$5 per person per week there after	Yes	per week	55,00 €
National parks permit (Payable at the base) Season: 2025-2026. 11 pax \$60/Week, \$5 per person per week there after	Yes	per week	60,00 €
National parks permit (Payable at the base) Season: 2025-2026. 12 pax \$60/Week, \$5 per person per week there after	Yes	per week	65,00 €
Permit (Payable at the base) Season: 2025-2026. Cruising Permit - \$4/ Per Person/ Per day	Yes	per guest/day	4,00 €
Visar (Virgin Islands Search and Rescue) (Payable at the base) Season: 2025-2026. \$5/ Per Person	Yes	per person	5,00 €
ASA Logbook (Payable at the base) Season: 2025-2026.	No	per piece	23,00 €
ASA Skipper (Payable now) Season: 2025-2026. ASA Certified Instructor - Does not include provisioning for instructor/skipper	No	per day + food	325,00 €

Cancellation insurance (Payable now)	No	per booking	200,00 €
Season: 2025-2026. The charter fee is non-refundable unless \$200 Charter Cancellation Insurance is purchased, which allows for a refund (less a \$500 fee) if cancelled more than 90 days before, or if the period is resold within 90 days, while cancellations without insurance receive no refund and weather-related interruptions only qualify for future charter credit.			
Checkout Skipper (Payable now)	No	per service	275,00 €
Season: 2025-2026. Include this crew member to help introduce you to your boat and refresh your sailing knowledge.			
Chill pack (Payable at the base)	No	per day	35,00 €
Season: 2025-2026. ISLAND CHILL PACK (Hammock, Beach Shade, 2 cooler backpacks, 4 noodles and a 7ft Water Hammock)			
Fun Pack (Payable at the base)	No	per day	85,00 €
Season: 2025-2026. ULTRA FUN PACK (2 SUP's, 4 Floating Mats, Dinghy Ladder, 4 Noodles, Hammock and 7 ft Water Hammock)			
Fun Pack (Payable at the base)	No	per day	96,00 €
Season: 2025-2026. TOO MUCH FUN PACK (2 SUP's, 6 Floating Mats, Dinghy Ladder, 6 Noodles, Hammock, 2 Cooler Backpacks and 7 ft Water Hammock)			
Fun Pack (Payable at the base)	No	per day	362,00 €
Season: 2025-2026. TOO MUCH FUN RELOADED - SUPERTENDER OPTION (2x SUP's, 6 Floating Mats, Dinghy Ladder, 6 Noodles, Hammock, 2 Cooler Backpacks, 7 ft Water Hammock and the Super Tender)			
Relax pack (Payable at the base)	No	per day	36,00 €
Season: 2025-2026. MAX RELAX PACK (1 SUP, 2 floating mats, Dinghy Ladder and 4 Noodles)			
Skipper (Payable now)	No	per day + food	275,00 €
Season: 2025-2026. Does not include provisioning for the skipper			
Sleep over before check in (Payable at the base)	No	per person	75,00 €
Season: 2025-2026. 5pm boarding night prior / minimum \$200 for the night! minimum of \$200 if is used by 1 or 2 people!			
Steward/Cook (Payable now)	No	per day + food	275,00 €
Season: 2025-2026. Does not include provisioning			



WEBSITE
www.plujeme.cz



PHONE
+420 720 755 085



MOBILE
+420 777 170 276



E-MAIL
info@plujeme.cz



PLUJEME RÁDI S.R.O.
Dlouhá 730/35, 11000 Praha 1 – Staré Město, Czech Republic

ADDITIONAL EXTRAS

EXTRA	OBLIGATORY	PAYMENT TYPE	PRICE
Beach canopy (Payable at the base) Season: 2025-2026. Rental - Payable at the base	No	per day	6,00 €
Bean Bag Chair (Payable at the base) Season: 2025-2026. Rental - Payable at the base	No	per day	10,00 €
Cooling bag (Payable at the base) Season: 2025-2026. Insulated Cooler Backpack - Rental - Payable at the base	No	per day	3,00 €
Dinghy ladder (Payable at the base) Season: 2025-2026. Boarding ladder to ease entry and exit of tender - Rental - Payable at the base	No	per day	6,00 €
Floating mats (Payable at the base) Season: 2025-2026. Single Floating Mattress - Rental - Payable at the base	No	per day	3,00 €
Floating mats (Payable at the base) Season: 2025-2026. Large Floating Mattress - Rental - Payable at the base	No	per day	18,00 €
Hammock (Payable at the base) Season: 2025-2026. Cloth Hammock- Rental - Payable at the base	No	per day	4,00 €
Hammock (Payable at the base) Season: 2025-2026. water hammock 7ft - Rental - Payable at the base	No	per day	20,00 €
Hammock (Payable at the base) Season: 2025-2026. water hammock 10ft - Rental - Payable at the base	No	per day	35,00 €
Kayak (Payable at the base) Season: 2025-2026. Rental - Payable at the base	No	per day	17,00 €
Kayak tandem (Payable at the base) Season: 2025-2026. Rental - Payable at the base	No	per day	18,00 €
Noodles (Payable at the base) Season: 2025-2026. Vinyl Covered pool noodle - Rental - Payable at the base	No	per day	1,00 €

Stand up paddle (SUP) (Payable at the base)	No	per day	25,00 €
Season: 2025-2026. Rental - Payable at the base			
Tender (Payable now)	No	per day	295,00 €
Season: 2025-2026. Super Tender Upgrade- 15ft Rib + 60hp Yamaha Outboard- must be towed not hoisted by davits - Payable now			
VHF headset (Payable at the base)	No	per day	8,00 €
Season: 2025-2026. Rental - Payable at the base			
Wi-Fi Internet (Payable at the base)	No	per day	28,00 €
Season: 2025-2026. Rental + \$100 Security Deposit paid at base as a pre- authorisation on CC. - Payable at the base			



WEBSITE
www.plujeme.cz



PHONE
+420 720 755 085



MOBILE
+420 777 170 276



E-MAIL
info@plujeme.cz



PLUJEME RÁDI S.R.O.
Dlouhá 730/35, 11000 Praha 1 – Staré Město, Czech Republic

PRICE AND AVAILABILITY

25.04. - 03.05.2026 NOT AVAILABLE	04.05. - 12.05.2026 NOT AVAILABLE	16.05. - 31.05.2026 NOT AVAILABLE	01.06. - 10.06.2026 NOT AVAILABLE
16.06. - 28.06.2026 NOT AVAILABLE	04.07. - 11.07.2026 10.440 € 10.648 €	14.07. - 23.07.2026 NOT AVAILABLE	25.07. - 01.08.2026 9.934 € 10.136 €
01.08. - 08.08.2026 10.136 €	08.08. - 15.08.2026 10.136 €	20.08. - 30.09.2026 NOT AVAILABLE	03.10. - 10.10.2026 10.136 €
10.10. - 17.10.2026 10.136 €	17.10. - 24.10.2026 10.136 €	24.10. - 31.10.2026 10.136 €	31.10. - 07.11.2026 10.648 €
07.11. - 14.11.2026 10.733 €	14.11. - 21.11.2026 10.733 €	21.11. - 28.11.2026 10.733 €	28.11. - 05.12.2026 10.733 €



WEBSITE

www.plujeme.cz



E-MAIL

info@plujeme.cz



PHONE

+420 720 755 085



MOBILE

+420 777 170 276



PLUJEME RÁDI S.R.O.

Dlouhá 730/35, 11000 Praha 1 – Staré Město, Czech Republic

PRICE AND AVAILABILITY

05.12. - 12.12.2026 10.733 €	12.12. - 19.12.2026 11.202 €	19.12. - 26.12.2026 14.014 €	02.01. - 09.01.2027 12.821 €
09.01. - 16.01.2027 11.926 €	16.01. - 23.01.2027 11.926 €	24.01. - 01.02.2027 NOT AVAILABLE	10.02. - 20.02.2027 NOT AVAILABLE
21.02. - 01.03.2027 NOT AVAILABLE	03.03. - 11.03.2027 NOT AVAILABLE	13.03. - 20.03.2027 13.418 €	20.03. - 27.03.2027 13.418 €
27.03. - 03.04.2027 13.418 €	03.04. - 10.04.2027 13.418 €	10.04. - 17.04.2027 13.418 €	17.04. - 24.04.2027 13.418 €
24.04. - 01.05.2027 10.561 € 11.117 €	01.05. - 08.05.2027 10.196 € 10.733 €	08.05. - 15.05.2027 10.196 € 10.733 €	15.05. - 22.05.2027 10.196 € 10.733 €
22.05. - 29.05.2027 10.196 € 10.733 €	29.05. - 05.06.2027 10.196 € 10.733 €	05.06. - 12.06.2027 10.196 € 10.733 €	12.06. - 19.06.2027 10.196 € 10.733 €
19.06. - 26.06.2027 10.196 € 10.733 €	26.06. - 03.07.2027 10.196 € 10.733 €	03.07. - 10.07.2027 10.196 € 10.733 €	



WEBSITE

www.plujeme.cz



E-MAIL

info@plujeme.cz



PHONE

+420 720 755 085



MOBILE

+420 777 170 276



PLUJEME RÁDI S.R.O.

Dlouhá 730/35, 11000 Praha 1 – Staré Město, Czech Republic

PRICE AND AVAILABILITY

20.08. - 30.09.2027

NOT AVAILABLE



WEBSITE

www.plujeme.cz



E-MAIL

info@plujeme.cz



PHONE

+420 720 755 085



MOBILE

+420 777 170 276



PLUJEME RÁDI S.R.O.

Dlouhá 730/35, 11000 Praha 1 – Staré Město, Czech Republic