

# LAGOON 46

Rope The Wind (2023)

Catamaran Lagoon 46 Rope The Wind, built in 2023 is anchored in the BVI, Tortola, Nanny Cay Marina, British Virgin Islands, British Virgin Islands. It has 4 + 1 cabins, can accommodate 8 + 1 people and has 5 toilets. Bed linen and kitchen equipment are included in the price.

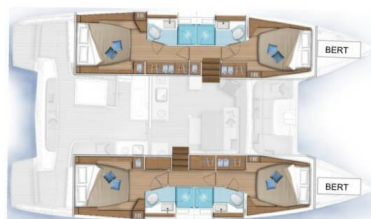

## YACHT SPECIFICATIONS

Yacht Base

**BVI, Tortola, Nanny Cay Marina,  
British Virgin Islands**

Yacht ID

**10506**

Brands

**Lagoon**

Yacht name

**Rope The Wind**

Production year

**2023**

Length

**46 ft**

Cabins

**4 + 1**

Berths

**8 + 1**

Max Persons

**9**

WC

**5**

Engine

**2 x 57 HP**

Fuel tank

**520 l**



**WEBSITE**

[www.plujeme.cz](http://www.plujeme.cz)



**PHONE**

+420 720 755 085



**MOBILE**

+420 777 170 276



**E-MAIL**

[info@plujeme.cz](mailto:info@plujeme.cz)



**PLUJEME RÁDI S.R.O.**

Dlouhá 730/35, 11000 Praha 1 – Staré Město, Czech Republic

## STANDARD YACHT EQUIPMENT

Comfort	<b>Cockpit cushions, Windscoops</b>
Deck	<b>Bimini top, Cockpit table, Cockpit/stern, outside shower, Dinghy with outboard engine, Electric anchor windlass, Grill/Barbecue/Plancha, Main anchor, Spare anchor (Reserve, Auxiliary anchor), Swimming ladder</b>
Entertainment	<b>Outdoor speakers, Radio</b>
Galley	<b>Blender, Coffee pot, Electrical filter coffee maker, Electrical kettle, Hot water, Ice maker, Kitchen utensils (Galley equipment, cutlery), Microwave, Oven, Refrigerator, Stove, Toaster</b>
Interior	<b>Coolbox, Electric fans in cabins</b>
Navigation	<b>Autopilot, Binoculars, Compass, Depthsounder, GPS chart plotter, Navigation (Nautical) charts and nautical guide, Speedometer (Speed log), Tridata, Wind instrument/Anemometer</b>
Safety	<b>Black Water Tank, Distress flare box, Emergency tiller, Fire extinguisher, First aid kit, Flashlight, Fog horn, Horseshoe lifebuoy, Life jackets, Torch, VHF radio</b>
Sails	<b>Electric winch, Lazy bag, Lazy jacks, Self tailing (manual) winch</b>
Yacht electrics	<b>110V socket, Air Conditioning, Battery charger, Bilge pump - Electric, Generator, Inverter, Shore power connection, Watermaker - desalinator</b>



**WEBSITE**

[www.plujeme.cz](http://www.plujeme.cz)



**PHONE**

+420 720 755 085



**MOBILE**

+420 777 170 276



**E-MAIL**

[info@plujeme.cz](mailto:info@plujeme.cz)



**PLUJEME RÁDI S.R.O.**

Dlouhá 730/35, 11000 Praha 1 – Staré Město, Czech Republic

## SERVICES

SELECTED SERVICES	OBLIGATORY	PAYMENT TYPE	PRICE
<b>Cell phone</b> (Payable at the base) <b>Season: 2025-2026.</b> \$20/Rental includes \$10/top up	Yes	per booking	<b>20,00 €</b>
<b>Damage waiver</b> (Payable at the base) <b>Season: 2025-2026.</b> \$70/night catamaran-\$700 max	Yes	per day	<b>70,00 €</b>
<b>National parks permit</b> (Payable at the base) <b>Season: 2025-2026.</b> 1-4 pax \$25/Week, \$5 per person per week there after	Yes	per week	<b>25,00 €</b>
<b>National parks permit</b> (Payable at the base) <b>Season: 2025-2026.</b> 5-6 pax \$35/Week, \$5 per person per week there after	Yes	per week	<b>35,00 €</b>
<b>National parks permit</b> (Payable at the base) <b>Season: 2025-2026.</b> 7-8 pax \$45/Week, \$5 per person per week there after	Yes	per week	<b>45,00 €</b>
<b>National parks permit</b> (Payable at the base) <b>Season: 2025-2026.</b> 9-10 pax \$55/Week, \$5 per person per week there after	Yes	per week	<b>55,00 €</b>
<b>National parks permit</b> (Payable at the base) <b>Season: 2025-2026.</b> 11 pax \$60/Week, \$5 per person per week there after	Yes	per week	<b>60,00 €</b>
<b>National parks permit</b> (Payable at the base) <b>Season: 2025-2026.</b> 12 pax \$60/Week, \$5 per person per week there after	Yes	per week	<b>65,00 €</b>
<b>Permit</b> (Payable at the base) <b>Season: 2025-2026.</b> Cruising Permit - \$4/ Per Person/ Per day	Yes	per guest/day	<b>4,00 €</b>
<b>Visar (Virgin Islands Search and Rescue)</b> (Payable at the base) <b>Season: 2025-2026.</b> \$5/ Per Person	Yes	per person	<b>5,00 €</b>
<b>ASA Logbook</b> (Payable at the base) <b>Season: 2025-2026.</b>	No	per piece	<b>23,00 €</b>
<b>ASA Skipper</b> (Payable now) <b>Season: 2025-2026.</b> ASA Certified Instructor - Does not include provisioning for instructor/skipper	No	per day + food	<b>325,00 €</b>

<b>Cancellation insurance</b> (Payable now)	No	per booking	<b>200,00 €</b>
<b>Season: 2025-2026.</b> The charter fee is non-refundable unless \$200 Charter Cancellation Insurance is purchased, which allows for a refund (less a \$500 fee) if cancelled more than 90 days before, or if the period is resold within 90 days, while cancellations without insurance receive no refund and weather-related interruptions only qualify for future charter credit.			
<b>Checkout Skipper</b> (Payable now)	No	per service	<b>275,00 €</b>
<b>Season: 2025-2026.</b> Include this crew member to help introduce you to your boat and refresh your sailing knowledge.			
<b>Chill pack</b> (Payable at the base)	No	per day	<b>35,00 €</b>
<b>Season: 2025-2026.</b> ISLAND CHILL PACK (Hammock, Beach Shade, 2 cooler backpacks, 4 noodles and a 7ft Water Hammock)			
<b>Fun Pack</b> (Payable at the base)	No	per day	<b>85,00 €</b>
<b>Season: 2025-2026.</b> ULTRA FUN PACK (2 SUP's, 4 Floating Mats, Dinghy Ladder, 4 Noodles, Hammock and 7 ft Water Hammock)			
<b>Fun Pack</b> (Payable at the base)	No	per day	<b>96,00 €</b>
<b>Season: 2025-2026.</b> TOO MUCH FUN PACK (2 SUP's, 6 Floating Mats, Dinghy Ladder, 6 Noodles, Hammock, 2 Cooler Backpacks and 7 ft Water Hammock)			
<b>Fun Pack</b> (Payable at the base)	No	per day	<b>362,00 €</b>
<b>Season: 2025-2026.</b> TOO MUCH FUN RELOADED - SUPERTENDER OPTION (2x SUP's, 6 Floating Mats, Dinghy Ladder, 6 Noodles, Hammock, 2 Cooler Backpacks, 7 ft Water Hammock and the Super Tender)			
<b>Relax pack</b> (Payable at the base)	No	per day	<b>36,00 €</b>
<b>Season: 2025-2026.</b> MAX RELAX PACK (1 SUP, 2 floating mats, Dinghy Ladder and 4 Noodles)			
<b>Skipper</b> (Payable now)	No	per day + food	<b>275,00 €</b>
<b>Season: 2025-2026.</b> Does not include provisioning for the skipper			
<b>Sleep over before check in</b> (Payable at the base)	No	per person	<b>75,00 €</b>
<b>Season: 2025-2026.</b> 5pm boarding night prior / minimum \$200 for the night! minimum of \$200 if is used by 1 or 2 people!			
<b>Steward/Cook</b> (Payable now)	No	per day + food	<b>275,00 €</b>
<b>Season: 2025-2026.</b> Does not include provisioning			



**WEBSITE**  
www.plujeme.cz



**PHONE**  
+420 720 755 085



**MOBILE**  
+420 777 170 276



**E-MAIL**  
info@plujeme.cz



**PLUJEME RÁDI S.R.O.**  
Dlouhá 730/35, 11000 Praha 1 – Staré Město, Czech Republic

## ADDITIONAL EXTRAS

EXTRA	OBLIGATORY	PAYMENT TYPE	PRICE
<b>Beach canopy</b> (Payable at the base) <b>Season: 2025-2026.</b> Rental - Payable at the base	No	per day	<b>6,00 €</b>
<b>Bean Bag Chair</b> (Payable at the base) <b>Season: 2025-2026.</b> Rental - Payable at the base	No	per day	<b>10,00 €</b>
<b>Cooling bag</b> (Payable at the base) <b>Season: 2025-2026.</b> Insulated Cooler Backpack - Rental - Payable at the base	No	per day	<b>3,00 €</b>
<b>Dinghy ladder</b> (Payable at the base) <b>Season: 2025-2026.</b> Boarding ladder to ease entry and exit of tender - Rental - Payable at the base	No	per day	<b>6,00 €</b>
<b>Floating mats</b> (Payable at the base) <b>Season: 2025-2026.</b> Single Floating Mattress - Rental - Payable at the base	No	per day	<b>3,00 €</b>
<b>Floating mats</b> (Payable at the base) <b>Season: 2025-2026.</b> Large Floating Mattress - Rental - Payable at the base	No	per day	<b>18,00 €</b>
<b>Hammock</b> (Payable at the base) <b>Season: 2025-2026.</b> Cloth Hammock- Rental - Payable at the base	No	per day	<b>4,00 €</b>
<b>Hammock</b> (Payable at the base) <b>Season: 2025-2026.</b> water hammock 7ft - Rental - Payable at the base	No	per day	<b>20,00 €</b>
<b>Hammock</b> (Payable at the base) <b>Season: 2025-2026.</b> water hammock 10ft - Rental - Payable at the base	No	per day	<b>35,00 €</b>
<b>Kayak</b> (Payable at the base) <b>Season: 2025-2026.</b> Rental - Payable at the base	No	per day	<b>17,00 €</b>
<b>Kayak tandem</b> (Payable at the base) <b>Season: 2025-2026.</b> Rental - Payable at the base	No	per day	<b>18,00 €</b>
<b>Noodles</b> (Payable at the base) <b>Season: 2025-2026.</b> Vinyl Covered pool noodle - Rental - Payable at the base	No	per day	<b>1,00 €</b>

<b>Stand up paddle (SUP)</b> (Payable at the base)	No	per day	<b>25,00 €</b>
<b>Season: 2025-2026.</b> Rental - Payable at the base			
<b>Tender</b> (Payable now)	No	per day	<b>295,00 €</b>
<b>Season: 2025-2026.</b> Super Tender Upgrade- 15ft Rib + 60hp Yamaha Outboard- must be towed not hoisted by davits - Payable now			
<b>VHF headset</b> (Payable at the base)	No	per day	<b>8,00 €</b>
<b>Season: 2025-2026.</b> Rental - Payable at the base			
<b>Wi-Fi Internet</b> (Payable at the base)	No	per day	<b>28,00 €</b>
<b>Season: 2025-2026.</b> Rental + \$100 Security Deposit paid at base as a pre- authorisation on CC. - Payable at the base			



**WEBSITE**

[www.plujeme.cz](http://www.plujeme.cz)



**E-MAIL**

[info@plujeme.cz](mailto:info@plujeme.cz)



**PHONE**

+420 720 755 085



**MOBILE**

+420 777 170 276



**PLUJEME RÁDI S.R.O.**

Dlouhá 730/35, 11000 Praha 1 – Staré Město, Czech Republic

## PRICE AND AVAILABILITY

25.04. - 03.05.2026 NOT AVAILABLE	09.05. - 16.05.2026 10.733 €	16.05. - 23.05.2026 10.733 €	23.05. - 30.05.2026 10.733 €
30.05. - 06.06.2026 10.733 €	06.06. - 13.06.2026 10.733 €	13.06. - 20.06.2026 10.212 € 10.733 €	21.06. - 28.06.2026 NOT AVAILABLE
30.06. - 12.07.2026 NOT AVAILABLE	18.07. - 27.07.2026 NOT AVAILABLE	01.08. - 08.08.2026 10.136 €	08.08. - 15.08.2026 10.136 €
20.08. - 30.09.2026 NOT AVAILABLE	03.10. - 10.10.2026 10.136 €	10.10. - 17.10.2026 10.136 €	17.10. - 24.10.2026 10.136 €
24.10. - 31.10.2026 10.136 €	31.10. - 07.11.2026 10.648 €	07.11. - 14.11.2026 10.733 €	14.11. - 21.11.2026 10.733 €
21.11. - 28.11.2026 10.733 €	28.11. - 05.12.2026 10.733 €		



### WEBSITE

[www.plujeme.cz](http://www.plujeme.cz)



### E-MAIL

[info@plujeme.cz](mailto:info@plujeme.cz)



### PHONE

+420 720 755 085



### MOBILE

+420 777 170 276



### PLUJEME RÁDI S.R.O.

Dlouhá 730/35, 11000 Praha 1 – Staré Město, Czech Republic

## PRICE AND AVAILABILITY

05.12. - 12.12.2026 10.733 €	12.12. - 19.12.2026 11.202 €	19.12. - 26.12.2026 14.014 €	02.01. - 09.01.2027 12.821 €
09.01. - 16.01.2027 11.926 €	16.01. - 23.01.2027 11.926 €	23.01. - 30.01.2027 11.926 €	30.01. - 06.02.2027 13.205 €
06.02. - 13.02.2027 13.418 €	13.02. - 20.02.2027 13.418 €	20.02. - 27.02.2027 13.418 €	27.02. - 06.03.2027 13.418 €
06.03. - 13.03.2027 13.418 €	13.03. - 20.03.2027 13.418 €	20.03. - 27.03.2027 13.418 €	27.03. - 03.04.2027 13.418 €
03.04. - 10.04.2027 13.418 €	10.04. - 17.04.2027 13.418 €	17.04. - 24.04.2027 13.418 €	24.04. - 01.05.2027 10.561 € 11.117 €
01.05. - 08.05.2027 10.196 € 10.733 €	08.05. - 15.05.2027 10.196 € 10.733 €	15.05. - 22.05.2027 10.196 € 10.733 €	22.05. - 29.05.2027 10.196 € 10.733 €
29.05. - 05.06.2027 10.196 € 10.733 €	05.06. - 12.06.2027 10.196 € 10.733 €	12.06. - 19.06.2027 10.196 € 10.733 €	19.06. - 26.06.2027 10.196 € 10.733 €
26.06. - 03.07.2027 10.196 € 10.733 €	03.07. - 10.07.2027 10.196 € 10.733 €		



WEBSITE

[www.plujeme.cz](http://www.plujeme.cz)



E-MAIL

[info@plujeme.cz](mailto:info@plujeme.cz)



PHONE

+420 720 755 085



MOBILE

+420 777 170 276



PLUJEME RÁDI S.R.O.

Dlouhá 730/35, 11000 Praha 1 – Staré Město, Czech Republic

## PRICE AND AVAILABILITY

20.08. - 30.09.2027

NOT AVAILABLE



### WEBSITE

[www.plujeme.cz](http://www.plujeme.cz)



### E-MAIL

[info@plujeme.cz](mailto:info@plujeme.cz)



### PHONE

+420 720 755 085



### MOBILE

+420 777 170 276



### PLUJEME RÁDI S.R.O.

Dlouhá 730/35, 11000 Praha 1 – Staré Město, Czech Republic