

# DUFOUR 41

Poppy (2024)

Sailing yacht Dufour 41 Poppy, built in 2024 is anchored in the ACI Marina Trogir, Split region, Croatia. It has 3 cabins, can accommodate 6 + 2 people and has 2 toilets. Bed linen and kitchen equipment are included in the price.

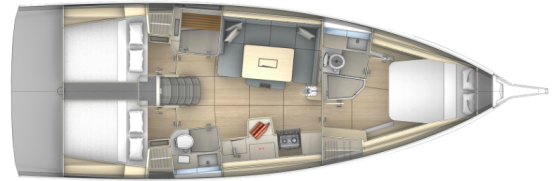

## YACHT SPECIFICATIONS

Yacht Base

**ACI Marina Trogir, Croatia**

Yacht ID

**10365**

Brands

**Dufour**

Yacht name

**Poppy**

Production year

**2024**

Length

**42 ft**

Cabins

**3**

Berths

**6 + 2**

WC

**2**

Engine

**1 x 50 HP**

Fuel tank

**250 l**



**WEBSITE**

[www.plujeme.cz](http://www.plujeme.cz)



**PHONE**

+420 720 755 085



**MOBILE**

+420 777 170 276



**E-MAIL**

[info@plujeme.cz](mailto:info@plujeme.cz)



**PLUJEME RÁDI S.R.O.**

Dlouhá 730/35, 11000 Praha 1 – Staré Město, Czech Republic

## STANDARD YACHT EQUIPMENT

|                 |   |
|-----------------|---|
| Comfort         | <b>Cockpit cushions, Mosquito nets</b>  |
| Deck            | <b>Anchor, Bathing platform, Bilge pump - Mechanic, Bimini top, Boat hook, Cockpit grill, Cockpit table, Cockpit/stern, outside shower, Dinghy, Electric anchor windlass, Fenders, Gangway, Mooring ropes, Sink in cockpit, Spare anchor (Reserve, Auxiliary anchor), Sprayhood, Teak seats in cockpit, Water hose, Winch handles</b> |
| Entertainment   | <b>Outdoor speakers, Radio, Wi-Fi Internet</b>  |
| Galley          | <b>Gas bottles, Refrigerator</b>  |
| Interior        | <b>Electric toilet</b>  |
| Navigation      | <b>Autopilot, Binoculars, Bow thruster, Compass, GPS chart plotter - cockpit, Hand bearing compass, Navigation (Nautical) charts and nautical guide, Navigation set, Pilot book, Radar reflector, Tridata, Wind instrument/Anemometer</b>   |
| Safety          | <b>Distress flare box, Fire extinguisher, First aid kit, Flashlight, Fog horn, Horseshoe lifebuoy, Life belts (Safety harness), Life jackets, Repair kit, VHF radio</b>   |
| Sails           | <b>Winch</b>  |
| Yacht electrics | <b>220V socket, Air Conditioning, Battery charger, Bilge pump - Electric, Heating, Inverter, Pump, Service batteries, Solar panels</b>  |



**WEBSITE**  
[www.plujeme.cz](http://www.plujeme.cz)



**PHONE**  
+420 720 755 085



**MOBILE**  
+420 777 170 276



**E-MAIL**  
[info@plujeme.cz](mailto:info@plujeme.cz)



**PLUJEME RÁDI S.R.O.**  
Dlouhá 730/35, 11000 Praha 1 – Staré Město, Czech Republic

## SERVICES

| SELECTED SERVICES  | OBLIGATORY | PAYMENT TYPE | PRICE           |
|--|------------|--------------|-----------------|
| <b>Charter package</b> (Payable at the base)<br><b>Season: 2026 - Angelina Yachtcharter.</b> Charter package includes final cleaning, gas, check-in and out services, package for toilets (toilet paper and soap /per each toilet) and kitchen (1 kitchen paper towels, a sponge and a cleaning cloth, a small package of dish detergent, 1 waste bag, 2 kitchen towels, 2x 1l bottle of water), bed linen/bath towels (2 sets per cabin - do not include saloon and skipper cabin). | Yes        | per booking  | <b>310,00 €</b> |
| <b>WiFi GRATIS ON BOAT</b> (Payable now)<br><b>Season: 2026 - Angelina Yachtcharter.</b> GRATIS  | Yes        | per booking  | <b>0,00 €</b>   |
| <b>Assisted Sailing</b> (Payable at the base)<br><b>Season: 2026 - Angelina Yachtcharter.</b> Valovie - remote sailing assistance; Our skipper will help and assist you remotely during your charter, and provide you advices when it comes to berths, restaurant recommendations, weather forecasts etc.  | No         | per booking  | <b>270,00 €</b> |
| <b>Deposit insurance</b> (Payable at the base)<br><b>Season: 2026 - Angelina Yachtcharter.</b> + refundable deposit 180,00 EUR   | No         | per booking  | <b>215,00 €</b> |
| <b>Pet on board</b> (Payable at the base)<br><b>Season: 2026 - Angelina Yachtcharter.</b> maximum 2 pets allowed   | No         | per booking  | <b>200,00 €</b> |



WEBSITE

[www.plujeme.cz](http://www.plujeme.cz)



PHONE

+420 720 755 085



MOBILE

+420 777 170 276



E-MAIL

[info@plujeme.cz](mailto:info@plujeme.cz)



PLUJEME RÁDI S.R.O.

Dlouhá 730/35, 11000 Praha 1 – Staré Město, Czech Republic

## ADDITIONAL EXTRAS

| EXTRA  | OBLIGATORY | PAYMENT TYPE | PRICE           |
|--|------------|--------------|-----------------|
| <b>Beach towel</b> (Payable at the base)<br><b>Season: 2026 - Angelina Yachtcharter.</b> Payable at the base   | No         | per piece    | <b>10,00 €</b>  |
| <b>Outboard engine 2,3 HP</b> (Payable at the base)<br><b>Season: 2026 - Angelina Yachtcharter.</b> Special promotion, free of charge for charter periods until 29.08.2026. and from 03.10.2026. - Payable at the base             | No         | per booking  | <b>0,00 €</b>   |
| <b>Outboard engine 2,3 HP</b> (Payable at the base)<br><b>Season: 2026 - Angelina Yachtcharter.</b> Special promotion, free of charge for charter periods until 29.08.2026. and from 03.10.2026. - Payable at the base             | No         | per booking  | <b>0,00 €</b>   |
| <b>Outboard engine 2,3 HP</b> (Payable at the base)<br><b>Season: 2026 - Angelina Yachtcharter.</b> Payable at the base  | No         | per week     | <b>110,00 €</b> |
| <b>Stand up paddle (SUP)</b> (Payable at the base)<br><b>Season: 2026 - Angelina Yachtcharter.</b> *additional deposit 200 EUR with deposit insurance, order in advance due to limited quantity of equipment - Payable at the base | No         | per week     | <b>100,00 €</b> |
| <b>Towels</b> (Payable at the base)<br><b>Season: 2026 - Angelina Yachtcharter.</b> Payable at the base  | No         | per set      | <b>10,00 €</b>  |



**WEBSITE**  
www.plujeme.cz



**PHONE**  
+420 720 755 085



**MOBILE**  
+420 777 170 276



**E-MAIL**  
info@plujeme.cz



**PLUJEME RÁDI S.R.O.**  
Dlouhá 730/35, 11000 Praha 1 - Staré Město, Czech Republic

## PRICE AND AVAILABILITY

|  |  |  |  |
|--|--|--|--|
| <b>27.06. - 11.07.2026</b><br>NOT AVAILABLE          | <b>11.07. - 18.07.2026</b><br>NOT AVAILABLE          | <b>18.07. - 01.08.2026</b><br>NOT AVAILABLE          | <b>01.08. - 15.08.2026</b><br>NOT AVAILABLE          |
| <b>15.08. - 29.08.2026</b><br>NOT AVAILABLE          | <b>29.08. - 12.09.2026</b><br>NOT AVAILABLE          | <b>12.09. - 19.09.2026</b><br>NOT AVAILABLE          | <b>19.09. - 03.10.2026</b><br>NOT AVAILABLE          |
| <b>03.10. - 10.10.2026</b><br>NOT AVAILABLE          | <b>10.10. - 17.10.2026</b><br>NOT AVAILABLE          | <b>17.10. - 24.10.2026</b><br><b>1.050 €</b> 1.750 € | <b>24.10. - 31.10.2026</b><br><b>1.020 €</b> 1.700 € |
| <b>31.10. - 07.11.2026</b><br><b>1.080 €</b> 1.800 € | <b>07.11. - 14.11.2026</b><br><b>1.710 €</b> 1.800 € | <b>15.11. - 31.12.2026</b><br>NOT AVAILABLE          | <b>01.01. - 05.03.2027</b><br>NOT AVAILABLE          |



### WEBSITE

[www.plujeme.cz](http://www.plujeme.cz)



### E-MAIL

[info@plujeme.cz](mailto:info@plujeme.cz)



### PHONE

+420 720 755 085



### MOBILE

+420 777 170 276



### PLUJEME RÁDI S.R.O.

Dlouhá 730/35, 11000 Praha 1 – Staré Město, Czech Republic

## PRICE AND AVAILABILITY

|   |   |   |   |
|---|---|---|---|
| 06.03. - 13.03.2027<br><b>1.890 €</b> 2.700 € | 13.03. - 20.03.2027<br><b>1.890 €</b> 2.700 € | 20.03. - 27.03.2027<br><b>1.400 €</b> 2.000 € | 27.03. - 03.04.2027<br><b>1.400 €</b> 2.000 € |
| 03.04. - 10.04.2027<br><b>1.470 €</b> 2.100 € | 10.04. - 17.04.2027<br><b>1.505 €</b> 2.150 € | 17.04. - 24.04.2027<br><b>1.890 €</b> 2.700 € | 24.04. - 01.05.2027<br><b>1.890 €</b> 2.700 € |
| 01.05. - 08.05.2027<br><b>1.925 €</b> 2.750 € | 08.05. - 15.05.2027<br><b>2.135 €</b> 3.050 € | 15.05. - 22.05.2027<br><b>2.310 €</b> 3.300 € | 22.05. - 29.05.2027<br><b>2.310 €</b> 3.300 € |
| 29.05. - 05.06.2027<br><b>2.555 €</b> 3.650 € | 05.06. - 12.06.2027<br><b>2.870 €</b> 4.100 € | 12.06. - 19.06.2027<br><b>2.940 €</b> 4.200 € | 19.06. - 26.06.2027<br><b>2.975 €</b> 4.250 € |
| 26.06. - 03.07.2027<br><b>3.220 €</b> 4.600 € | 03.07. - 10.07.2027<br><b>3.325 €</b> 4.750 € | 10.07. - 17.07.2027<br><b>3.255 €</b> 4.650 € | 17.07. - 24.07.2027<br><b>3.500 €</b> 5.000 € |
| 24.07. - 31.07.2027<br><b>3.710 €</b> 5.300 € | 31.07. - 07.08.2027<br><b>3.710 €</b> 5.300 € | 07.08. - 14.08.2027<br><b>3.605 €</b> 5.150 € | 14.08. - 21.08.2027<br><b>3.430 €</b> 4.900 € |
| 21.08. - 28.08.2027<br><b>3.395 €</b> 4.850 € | 28.08. - 04.09.2027<br><b>3.395 €</b> 4.850 € | 04.09. - 11.09.2027<br><b>3.290 €</b> 4.700 € | 11.09. - 18.09.2027<br><b>3.080 €</b> 4.400 € |
| 18.09. - 25.09.2027<br><b>3.010 €</b> 4.300 € | 25.09. - 02.10.2027<br><b>2.835 €</b> 4.050 € |   |   |



WEBSITE

[www.plujeme.cz](http://www.plujeme.cz)



E-MAIL

[info@plujeme.cz](mailto:info@plujeme.cz)



PHONE

+420 720 755 085



MOBILE

+420 777 170 276



PLUJEME RÁDI S.R.O.

Dlouhá 730/35, 11000 Praha 1 – Staré Město, Czech Republic

## PRICE AND AVAILABILITY

02.10. - 09.10.2027

**2.625 €** 3.750 €

09.10. - 16.10.2027

**2.135 €** 3.050 €

16.10. - 23.10.2027

**1.995 €** 2.850 €

23.10. - 30.10.2027

**1.890 €** 2.700 €

30.10. - 06.11.2027

**1.890 €** 2.700 €

07.11. - 31.12.2027

NOT AVAILABLE



**WEBSITE**

[www.plujeme.cz](http://www.plujeme.cz)



**E-MAIL**

[info@plujeme.cz](mailto:info@plujeme.cz)



**PHONE**

+420 720 755 085



**MOBILE**

+420 777 170 276



**PLUJEME RÁDI S.R.O.**

Dlouhá 730/35, 11000 Praha 1 – Staré Město, Czech Republic