

HANSE 548

Joy (2018)

Sailing yacht Hanse 548 Joy, built in 2018 is anchored in the Lefkas, D-Marin, Ionian Islands, Greece. It has 4 + 1 cabins, can accommodate 8 + 1 people and has 4 + 1 toilets. Bed linen and kitchen equipment are included in the price.

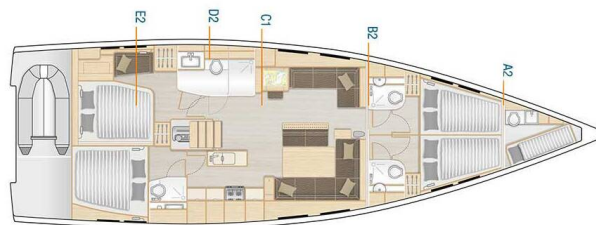

YACHT SPECIFICATIONS

Yacht Base

Lefkas, D-Marin, Greece

Yacht ID

1028

Brands

Hanse Yachts

Yacht name

Joy

Production year

2018

Length

53 ft

Cabins

4 + 1

Berths

8 + 1

Max Persons

10

WC

4 + 1

Engine

1 x 0 HP

Fuel tank

0 l



WEBSITE

www.plujeme.cz



PHONE

+420 720 755 085



MOBILE

+420 777 170 276



E-MAIL

info@plujeme.cz



PLUJEME RÁDI S.R.O.

Dlouhá 730/35, 11000 Praha 1 – Staré Město, Czech Republic

STANDARD YACHT EQUIPMENT

Comfort	Blankets, Pillows, Sheets, Towels
Deck	Anchor with chain, Bimini top, Boat hook, Dinghy with outboard engine, Gangway, Hydraulic gangway, Spare anchor (Reserve, Auxiliary anchor), Sprayhood, Swimming ladder, Water hose, Winch handles
Entertainment	Snorkeling equipment
Galley	Gas cookers, Hot water, Kitchen utensils (Galley equipment, cutlery), Refrigerator
Interior	Barometer, Electric toilet
Navigation	Autopilot, Binoculars, Bow thruster, Echosounder/Depthsounder, GPS chart plotter - cockpit, Hand bearing compass, Log/speed instrument, Nautical charts, Wind instrument/Anemometer
Safety	Distress flare box, Emergency tiller, Fire extinguisher, First aid kit, Fog horn, Life belts (Safety harness), Life jackets, Liferaft, Torch, VHF radio, Wire (shroud) cutter
Sails	Electric winch
Yacht electrics	Air Conditioning, Battery charger, Generator, Shore connection 220 V, USB sockets



WEBSITE

www.plujeme.cz



E-MAIL

info@plujeme.cz



PHONE

+420 720 755 085



MOBILE

+420 777 170 276



PLUJEME RÁDI S.R.O.

Dlouhá 730/35, 11000 Praha 1 – Staré Město, Czech Republic

SERVICES

SELECTED SERVICES	OBLIGATORY	PAYMENT TYPE	PRICE
Security Deposit Waiver (Payable at the base) Season: 2026. 250 EUR credit voucher for the next charter in case of no damage/loss upon redelivery. No cash refund.	Yes	per booking	500,00 €
Standard Charter Pack (Payable at the base) Season: 2026. Welcome kit	Yes	per booking	320,00 €
Beach towel (Payable at the base) Season: 2026.	No	per booking	10,00 €
Berth cost (Payable at the base) Season: 2026. Berthing fees for first & last night at the marina/port	No	per booking	0,00 €
Cabin conversion (Payable at the base) Season: 2026. If possible on yacht. Contact fleet operator for more information.	No	per booking	150,00 €
Cook (Payable at the base) Season: 2026. Crew provisioning to be provided by Charterer in arrangement with crew. If monetary compensation shall be agreed, then it shall be of no less than €30 per crew member per day. Charterer shall provide crew with sleeping cabin/berth and shower/toilet use to be designated to them onboard.	No	per day + food	215,00 €
Family pack (Payable at the base) Season: 2026. Safety net, SUP, junior life jackets, normal foam type	No	per booking	350,00 €
Fast Track pack (Payable at the base) Season: 2026. Access to the yacht by 14:00h on embarkation day, only IF feasible	No	per booking	200,00 €
Hostess (Payable at the base) Season: 2026. Crew provisioning to be provided by Charterer in arrangement with crew. If monetary compensation shall be agreed, then it shall be of no less than €30 per crew member per day. Charterer shall provide crew with sleeping cabin/berth and shower/toilet use to be designated to them onboard.	No	per day + food	180,00 €

Internet pack (Payable at the base) Season: 2026. Wi-Fi router for Internet aboard (subject to GSM coverage up to 10GB/week)	No	per week	50,00 €
One way fee (Payable at the base) Season: 2026. Volos-Skiathos	No	per booking	300,00 €
One way fee (Payable at the base) Season: 2026. Preveza-Lefkas	No	per booking	300,00 €
One way fee (Payable at the base) Season: 2026. Athens-Lavrion	No	per booking	500,00 €
One way fee (Payable at the base) Season: 2026. Athens-Cyclades/Sporades	No	per booking	1.000,00 €
One way fee (Payable at the base) Season: 2026. Athens-Dodecanese	No	per booking	1.200,00 €
One way fee (Payable at the base) Season: 2026. Kos-Rhodos	No	per booking	600,00 €
One way fee (Payable at the base) Season: 2026. Lefkas/Preveza-Corfu	No	per booking	600,00 €
One way fee (Payable at the base) Season: 2026. Athens-Lefkas-Preveza	No	per booking	1.200,00 €
One way fee (Payable at the base) Season: 2026. Athens-Corfu	No	per booking	1.400,00 €
Overnight on board (Payable at the base) Season: 2026. Embarkation on yacht & overnight stay the day before charter starts, check-in by 13:00h on charter start day. Subject to last minute availability of yacht on previous day.	No	per booking	180,00 €
Pet on board (Payable at the base) Season: 2026. up to 7 kg	No	per booking	200,00 €
Skipper (Payable at the base) Season: 2026. Crew provisioning to be provided by Charterer in arrangement with crew. If monetary compensation shall be agreed, then it shall be of no less than €30 per crew member per day. Charterer shall provide crew with sleeping cabin/berth and shower/toilet use to be designated to them onboard. Skippered charters come obligatorily with: Security deposit waiver, non refundable, EUR 400	No	per day + food	215,00 €

Stand up paddle (SUP) (Payable at the base)

No

per week

100,00 €

Season: 2026.

VIP Pack (Payable at the base)

No

per booking

300,00 €

Season: 2026. Airport/Local Base welcome & pickup, transfer to the yacht, welcome pack with sparkling wine & fruits, departure transfer to the local airport



WEBSITE

www.plujeme.cz



PHONE

+420 720 755 085



MOBILE

+420 777 170 276



E-MAIL

info@plujeme.cz



PLUJEME RÁDI S.R.O.

Dlouhá 730/35, 11000 Praha 1 – Staré Město, Czech Republic

ADDITIONAL EXTRAS

EXTRA	OBLIGATORY	PAYMENT TYPE	PRICE
Automatic Inflatable Life Jacket (Payable at the base) <i>Season: 2026. Payable at the base</i>	No	per week/ person	20,00 €
Beach towel (Payable at the base) <i>Season: 2026. Payable at the base</i>	No	per piece	10,00 €
Extra bedlinen (Payable at the base) <i>Season: 2026. Payable at the base</i>	No	per set	10,00 €
Gennaker (Payable at the base) <i>Season: 2026. + extra security deposit 500 EUR (refundable) - Payable at the base</i>	No	per week	200,00 €
Grill/Barbecue/Plancha (Payable at the base) <i>Season: 2026. portable, 1x gas bottle included - Payable at the base</i>	No	per week	80,00 €
Kayak (Payable at the base) <i>Season: 2026. Payable at the base</i>	No	per week	100,00 €
Railing net (Safety net) (Payable at the base) <i>Season: 2026. installed - Payable at the base</i>	No	per booking	200,00 €
Stand up paddle (SUP) (Payable at the base) <i>Season: 2026. Payable at the base</i>	No	per week	100,00 €



WEBSITE

www.plujeme.cz



E-MAIL

info@plujeme.cz



PHONE

+420 720 755 085



MOBILE

+420 777 170 276



PLUJEME RÁDI S.R.O.

Dlouhá 730/35, 11000 Praha 1 – Staré Město, Czech Republic

PRICE AND AVAILABILITY

25.04. - 02.05.2026 3.000 € 4.000 €	02.05. - 09.05.2026 3.000 € 4.000 €	09.05. - 16.05.2026 3.000 € 4.000 €	16.05. - 23.05.2026 4.080 € 5.100 €
23.05. - 06.06.2026 NOT AVAILABLE	06.06. - 13.06.2026 NOT AVAILABLE	13.06. - 20.06.2026 6.035 € 7.100 €	20.06. - 27.06.2026 NOT AVAILABLE
27.06. - 04.07.2026 6.800 € 8.000 €	04.07. - 11.07.2026 NOT AVAILABLE	11.07. - 18.07.2026 NOT AVAILABLE	18.07. - 25.07.2026 NOT AVAILABLE
25.07. - 01.08.2026 7.565 € 8.900 €	01.08. - 08.08.2026 8.670 € 10.200 €	08.08. - 15.08.2026 8.670 € 10.200 €	15.08. - 22.08.2026 NOT AVAILABLE
22.08. - 29.08.2026 7.310 € 8.600 €	29.08. - 05.09.2026 7.740 € 8.600 €	05.09. - 12.09.2026 NOT AVAILABLE	12.09. - 19.09.2026 7.290 € 8.100 €
19.09. - 26.09.2026 7.290 € 8.100 €	26.09. - 03.10.2026 5.850 € 6.500 €	03.10. - 10.10.2026 5.310 € 5.900 €	10.10. - 17.10.2026 5.310 € 5.900 €
17.10. - 24.10.2026 3.960 € 4.400 €	24.10. - 31.10.2026 3.960 € 4.400 €	31.10. - 07.11.2026 3.960 € 4.400 €	07.11. - 14.11.2026 3.960 € 4.400 €
14.11. - 21.11.2026 3.960 € 4.400 €	21.11. - 31.12.2026 NOT AVAILABLE		



WEBSITE
www.plujeme.cz



E-MAIL
info@plujeme.cz



PHONE
+420 720 755 085



MOBILE
+420 777 170 276



PLUJEME RÁDI S.R.O.
Dlouhá 730/35, 11000 Praha 1 – Staré Město, Czech Republic

PRICE AND AVAILABILITY

02.01. - 09.01.2027 3.150 € 3.500 €	09.01. - 16.01.2027 3.150 € 3.500 €	16.01. - 23.01.2027 3.150 € 3.500 €	23.01. - 30.01.2027 3.150 € 3.500 €
30.01. - 06.02.2027 3.150 € 3.500 €	06.02. - 13.02.2027 3.150 € 3.500 €	13.02. - 20.02.2027 3.150 € 3.500 €	20.02. - 27.02.2027 3.150 € 3.500 €
27.02. - 06.03.2027 3.150 € 3.500 €	06.03. - 13.03.2027 3.150 € 3.500 €	13.03. - 20.03.2027 3.150 € 3.500 €	20.03. - 27.03.2027 3.150 € 3.500 €
27.03. - 03.04.2027 3.150 € 3.500 €	03.04. - 10.04.2027 3.150 € 3.500 €	10.04. - 17.04.2027 3.150 € 3.500 €	17.04. - 24.04.2027 3.150 € 3.500 €
24.04. - 01.05.2027 3.600 € 4.000 €	01.05. - 08.05.2027 3.600 € 4.000 €	08.05. - 15.05.2027 3.600 € 4.000 €	15.05. - 22.05.2027 4.590 € 5.100 €
22.05. - 29.05.2027 6.030 € 6.700 €	29.05. - 05.06.2027 6.030 € 6.700 €	05.06. - 12.06.2027 6.390 € 7.100 €	12.06. - 19.06.2027 6.390 € 7.100 €
19.06. - 26.06.2027 7.200 € 8.000 €	26.06. - 03.07.2027 7.200 € 8.000 €	03.07. - 10.07.2027 7.650 € 8.500 €	10.07. - 17.07.2027 8.010 € 8.900 €
17.07. - 24.07.2027 8.010 € 8.900 €	24.07. - 31.07.2027 8.010 € 8.900 €	31.07. - 07.08.2027 9.180 € 10.200 €	



WEBSITE

www.plujeme.cz



E-MAIL

info@plujeme.cz



PHONE

+420 720 755 085



MOBILE

+420 777 170 276



PLUJEME RÁDI S.R.O.

Dlouhá 730/35, 11000 Praha 1 – Staré Město, Czech Republic

PRICE AND AVAILABILITY

07.08. - 14.08.2027 9.180 € 10.200 €	14.08. - 21.08.2027 9.180 € 10.200 €	21.08. - 28.08.2027 7.740 € 8.600 €	28.08. - 04.09.2027 7.740 € 8.600 €
04.09. - 11.09.2027 7.740 € 8.600 €	11.09. - 18.09.2027 7.290 € 8.100 €	18.09. - 25.09.2027 7.290 € 8.100 €	25.09. - 02.10.2027 5.850 € 6.500 €
02.10. - 09.10.2027 5.310 € 5.900 €	09.10. - 16.10.2027 5.310 € 5.900 €	16.10. - 23.10.2027 3.960 € 4.400 €	23.10. - 30.10.2027 3.960 € 4.400 €
30.10. - 06.11.2027 3.960 € 4.400 €	06.11. - 13.11.2027 3.960 € 4.400 €	13.11. - 20.11.2027 3.960 € 4.400 €	20.11. - 27.11.2027 3.960 € 4.400 €
27.11. - 04.12.2027 3.960 € 4.400 €	04.12. - 11.12.2027 3.960 € 4.400 €	11.12. - 18.12.2027 3.960 € 4.400 €	18.12. - 25.12.2027 3.960 € 4.400 €



WEBSITE

www.plujeme.cz



E-MAIL

info@plujeme.cz



PHONE

+420 720 755 085



MOBILE

+420 777 170 276



PLUJEME RÁDI S.R.O.

Dlouhá 730/35, 11000 Praha 1 – Staré Město, Czech Republic