

# MOTOR YACHT 4.S

MY ANGEL (2022)

Motorový katamarán Motor Yacht 4.S MY ANGEL, rok spuštění na vodu 2022 kotví v marině Athens, Alimos marina, Athens area/Saronic/Peloponese, Řecko. Počet kajut: 4, může ubytovat celkem: 8 a má toalet: 2. Povlečení a kuchyňské vybavení jsou zahrnuty v ceně.

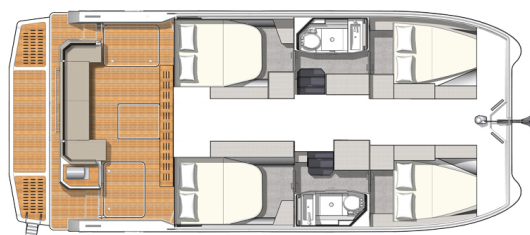

## YACHT SPECIFICATIONS

Marína	Jachta ID	Značka
<b>Athens, Alimos marina, Řecko</b>	<b>9316</b>	<b>Fountain Pajot</b>
Název jachty	Rok výroby	Délka
<b>MY ANGEL</b>	<b>2022</b>	<b>36 ft</b>
Kabiny	Lůžka	Maximální počet osob
<b>4</b>	<b>8</b>	<b>8</b>
WC	Motor	Palivová nádrž
<b>2</b>	<b>2 x 220 HP</b>	<b>1200 l</b>



**WEBSITE**  
www.plujeme.cz



**TELEFON**  
+420 720 755 085



**MOBILE**  
+420 777 170 276



**E-MAIL**  
info@plujeme.cz



**PLUJEME RÁDI S.R.O.**  
Dlouhá 730/35, 11000 Praha 1 – Staré Město, Česká republika

## STANDARDNÍ VYBAVENÍ JACHTY

Bezpečnost	<b>VHF rádio</b>
Elektronika	<b>Generátor, Invertor, Klimatizace, Solární panely, USB sockets</b>
Interiér	<b>Elektrické WC, Ventilátory v kajutách</b>
Kuchyňka	<b>Lednička, Mrazák, Trouba</b>
Navigace	<b>Autopilot, GPS mapový plotter - kokpit, Hloubkoměr, Rychloměr (Speed log)</b>
Paluba	<b>Elektrický kotevní vrátek, Grill/Barbecue/Plancha, Koupací žebřík, Nafukovací člun s přívěsným motorem, Ovladač kotevního vrátku s počítadlem délky řetězu u kormidla, Střešní okno, Venkovní sprcha na zádi</b>
Pohodlí	<b>Lehátka na opalování</b>
Zábava	<b>FUSION sound system, LCD TV</b>



#### WEBSITE

[www.plujeme.cz](http://www.plujeme.cz)



#### E-MAIL

[info@plujeme.cz](mailto:info@plujeme.cz)



#### TELEFON

+420 720 755 085



#### MOBILE

+420 777 170 276



#### PLUJEME RÁDI S.R.O.

Dlouhá 730/35, 11000 Praha 1 – Staré Město, Česká republika

## SLUŽBY

VYBRANÉ SLUŽBY	POVINNÉ	TYP PLATBY	CENA
<b>Manipulační poplatky (Platba předem)</b> <b>Sezóna: 2026.</b>	Ano	za rezervaci	<b>20,00 €</b>
<b>Poplatek za přípravu jachty (Platba předem)</b> <b>Sezóna: 2026.</b> INCLUDED: starter pack – (1 gallon water or 4 bottles of 1.5L, 1 bottle of disinfectant, 1 small bottle of washing up liquid, 1 dish cloth, 1 sponge, garbage bags, 1 roll of paper towels, 1 box of matches, 1 roll of toilet paper in each head) // final cleaning // 1 set of bed sheets / cabin & 1 set of towels / pax, dinghy, outboard engine & initial supply of fuel, gas and water tanks // DYC assistance guarantee // 1st & last night in the marina // NOT INCLUDED: refuelling, gas & water consumption at end of charter, taxes if any, handling fees & additional equipment deposit.	Ano	za rezervaci	<b>330,00 €</b>
<b>Dřívější nalodění (Platba předem)</b> <b>Sezóna: 2026.</b> EB (boat only) - 13:00h, starting time of boat's delivery // limited number of early boardings on same departure day	Ne	za rezervaci	<b>340,00 €</b>
<b>Dřívější nalodění (Platba předem)</b> <b>Sezóna: 2026.</b> EB + extra fee skipper - 13:00h, starting time of boat's delivery // limited number of early boardings on same departure day	Ne	za rezervaci	<b>470,00 €</b>
<b>Dřívější nalodění (Platba předem)</b> <b>Sezóna: 2026.</b> EB + extra fee Skipper & Hostess - 13:00h, starting time of boat's delivery // limited number of early boardings on same departure day	Ne	za rezervaci	<b>580,00 €</b>
<b>Extra sada prádla (vyberte si kolik) (Platba předem)</b> <b>Sezóna: 2026.</b> Extra set of linen : 15 € 1 extra set of linen (2 sheets & 2 pillow case) - to be updated manually	Ne	za rezervaci	<b>15,00 €</b>
<b>Extra set of towels (choose how many) (Platba předem)</b> <b>Sezóna: 2026.</b> Extra set of towels: 10 € 1 extra set of towels (1 face & 1 bath towel) - to be updated manually	Ne	za rezervaci	<b>10,00 €</b>
<b>extra úklid (Platba předem)</b> <b>Sezóna: 2026.</b> Optional Additional cleaning	Ne	za rezervaci	<b>285,00 €</b>
<b>Full board 1-4 (number of guests to update manually) (Platba předem)</b> <b>Sezóna: 2026.</b> only available if cook is booked on board as the cook will do the provisioning based on client's preference. Includes breakfast, lunch & dinner + the crew's food. Does not included alcoholic drinks	Ne	per guest/day	<b>60,00 €</b>

<p><b>Full board 5-12 pax (number of guests to update manually)</b> (Platba předem)</p> <p><b>Sezóna: 2026.</b> only available if cook is booked on board as the cook will do the provisioning based on client's preference. Includes breakfast, lunch &amp; dinner + the crew's food. Does not included alcoholic drinks</p>	Ne	per guest/day	<b>55,00 €</b>
<p><b>Half board 1-4 (number of guests to update manually)</b> (Platba předem)</p> <p><b>Sezóna: 2026.</b> only available if cook is booked on board as the cook will do the provisioning based on client's preference. Includes breakfast &amp; lunch OR dinner + the crew's food. Does not included alcoholic drinks</p>	Ne	per guest/day	<b>50,00 €</b>
<p><b>Half board 5-12 pax (number of guests to update manually)</b> (Platba předem)</p> <p><b>Sezóna: 2026.</b> only available if cook is booked on board as the cook will do the provisioning based on client's preference. Includes breakfast &amp; lunch OR dinner + the crew's food. Does not included alcoholic drinks</p>	Ne	per guest/day	<b>45,00 €</b>
<p><b>Hosteska/kuchař</b> (Platba předem)</p> <p><b>Sezóna: 2026.</b> + provisioning, Crew on board must have their own toilets/ showers. If either a skipper or a hostess/cook is on board, 1 double cabin will be required for him/her. If both a skipper and a hostess/cook are on board, 1 double cabin and 1 forepeak cabin will be required for them. Exceptions exists for specific layouts, Sales Agents will provide more details about the different boat models</p>	Ne	za noc	<b>195,00 €</b>
<p><b>Hosteska/kuchař</b> (Platba předem)</p> <p><b>Sezóna: 2026.</b> + provisioning, Crew on board must have their own toilets/ showers. If either a skipper or a hostess/cook is on board, 1 double cabin will be required for him/her. If both a skipper and a hostess/cook are on board, 1 double cabin and 1 forepeak cabin will be required for them. Exceptions exists for specific layouts, Sales Agents will provide more details about the different boat models</p>	Ne	za noc	<b>195,00 €</b>
<p><b>Hosteska/kuchař</b> (Platba předem)</p> <p><b>Sezóna: 2026.</b> + provisioning, Crew on board must have their own toilets/ showers. If either a skipper or a hostess/cook is on board, 1 double cabin will be required for him/her. If both a skipper and a hostess/cook are on board, 1 double cabin and 1 forepeak cabin will be required for them. Exceptions exists for specific layouts, Sales Agents will provide more details about the different boat models</p>	Ne	za noc	<b>215,00 €</b>
<p><b>Kapitán</b> (Platba předem)</p> <p><b>Sezóna: 2026.</b> + provisioning, Crew on board must have their own toilets/ showers. If either a skipper or a hostess/cook is on board, 1 double cabin will be required for him/her. If both a skipper and a hostess/cook are on board, 1 double cabin and 1 forepeak cabin will be required for them. Exceptions exists for specific layouts, Sales Agents will provide more details about the different boat models</p>	Ne	za noc	<b>210,00 €</b>

**Kapitán (Platba předem)** Ne za noc **210,00 €**  
**Sezóna: 2026.** + provisioning, Crew on board must have their own toilets/ showers. If either a skipper or a hostess/cook is on board, 1 double cabin will be required for him/her. If both a skipper and a hostess/cook are on board, 1 double cabin and 1 forepeak cabin will be required for them. Exceptions exists for specific layouts, Sales Agents will provide more details about the different boat models

**Kapitán (Platba předem)** Ne za noc **230,00 €**  
**Sezóna: 2026.** + provisioning, Crew on board must have their own toilets/ showers. If either a skipper or a hostess/cook is on board, 1 double cabin will be required for him/her. If both a skipper and a hostess/cook are on board, 1 double cabin and 1 forepeak cabin will be required for them. Exceptions exists for specific layouts, Sales Agents will provide more details about the different boat models

**Příplatek za regatu (Platba předem)** Ne za rezervaci **0,00 €**  
**Sezóna: 2026.** A special race deposit need to be doubled manually once the regatta surcharge is added.

**Spotřeba elektřiny a vody v přístavech (Platba na základně)** Ne za rezervaci **28,00 €**  
**Sezóna: 2026.** Electric & Water consumption based on 2 nights on our dock (base will confirm the amount to pay locally depending on nights spent on dock)

**Transfer (Platba předem)** Ne one-way **81,00 €**  
**Sezóna: 2026.** OW - Athens airport / Base 1 to 3 Pax - For transfers during hours 21:00-06:00h and bank holidays price should be raised by 30€ one-way, or 60€ round trip

**Transfer (Platba předem)** Ne one-way **147,00 €**  
**Sezóna: 2026.** OW - Athens airport / Base 4 to 8 Pax - For transfers during hours 21:00-06:00h and bank holidays price should be raised by 30€ one-way, or 60€ round trip

**Transfer (Platba předem)** Ne one-way **162,00 €**  
**Sezóna: 2026.** OW - Athens airport / Base 9 to 17 Pax - For transfers during hours 21:00-06:00h and bank holidays price should be raised by 30€ one-way, or 60€ round trip

**WI-FI Internet na lodi (Platba předem)** Ne za týden **50,00 €**  
**Sezóna: 2026.** unlimited data

**Změna posádky (Platba předem)** Ne za rezervaci **250,00 €**  
**Sezóna: 2026.** Any crew change during the charter is subject to € 250.- additional cost. The charge includes administration cost, change of bed linen and towels and cleaning of the cabin (marina fee included only if the same base than start base). It doesn't include cleaning, nor new transit log where applicable.

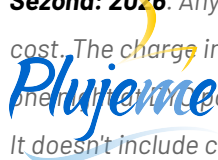

WEBSITE

www.plujeme.cz



TELEFON

+420 777 085 085



MOBILE

+420 777 170 276



E-MAIL

info@plujeme.cz



PLUJEME RÁDI S.R.O.

Dlouhá 730/35, 11000 Praha 1 - Staré Město, Česká republika

## DODATEČNÉ DOPLŇKY

DOPLŇKY	POVINNÉ	TYP PLATBY	CENA
<b>Outboard engine 8 &amp; 9,8 HP</b> (Platba předem) <b>Sezóna: 2026.</b> Subject to Availability ; 8 & 9.8hp. Dinghy not suitable in any case for waterski or wakeboard. - Platba předem	Ne	za den	<b>35,00 €</b>
<b>Stand up paddle (SUP)</b> (Platba předem) <b>Sezóna: 2026.</b> Price per day - Platba předem	Ne	za noc	<b>15,00 €</b>

**WEBSITE**[www.plujeme.cz](http://www.plujeme.cz)**E-MAIL**[info@plujeme.cz](mailto:info@plujeme.cz)**TELEFON**

+420 720 755 085

**MOBILE**

+420 777 170 276

**PLUJEME RÁDI S.R.O.**

Dlouhá 730/35, 11000 Praha 1 – Staré Město, Česká republika