

# LAGOON 40

SEA YOU (2020)

Katamarán Lagoon 40 SEA YOU, rok spuštění na vodu 2020  
kotví v marině Cote D'Azur, Port Pin Rolland, Provence-Alpes-  
Côte d'Azur, Francie. Počet kajut: 4 + 2 , může ubytovat  
celkem: 8 + 2 + 2 a má toalet: 4 . Povlečení a kuchyňské  
vybavení jsou zahrnuty v ceně.

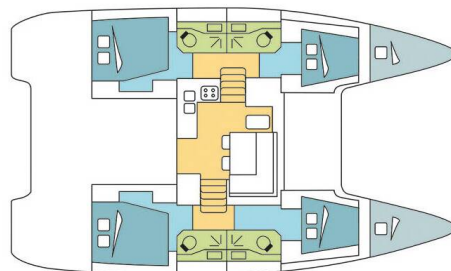

## YACHT SPECIFICATIONS

Marína	Jachta ID	Značky
<b>Cote D'Azur, Port Pin Rolland, Francie</b>	<b>9279</b>	<b>Lagoon</b>
Název jachty	Rok výroby	Délka
<b>SEA YOU</b>	<b>2020</b>	<b>39 ft</b>
Kabiny	Lůžka	Maximální počet osob
<b>4 + 2</b>	<b>8 + 2 + 2</b>	<b>12</b>
WC	Motor	Palivová nádrž
<b>4</b>	<b>2 x 45 HP</b>	<b>400 l</b>



**WEBSITE**  
[www.plujeme.cz](http://www.plujeme.cz)



**TELEFON**  
+420 720 755 085



**MOBILE**  
+420 777 170 276



**E-MAIL**  
[info@plujeme.cz](mailto:info@plujeme.cz)



**PLUJEME RÁDI S.R.O.**  
Dlouhá 730/35, 11000 Praha 1 – Staré Město, Česká republika

## STANDARDNÍ VYBAVENÍ JACHTY

Bezpečnost	<b>VHF rádio</b>
Elektronika	<b>Invertor, Solární panely, USB sockets, WC pumpa</b>
Interiér	<b>Convertible table in salon, Ventilátory v kajutách</b>
Kuchyňka	<b>Kuchyňské potřeby ( kuchyňské zařízení, příbory, Lednička, Trouba, Trouba</b>
Navigace	<b>Autopilot, GPS mapový plotter, Wind/speed/depth instruments</b>
Paluba	<b>Bimini, Elektrický kotevní vrátek, Koupací žebřík, Nafukovací člun, Přívěsný motor, Stoleček v kokpitu, Venkovní sprcha na zádi</b>
Plachty	<b>Elektrické navijáky/vinšny, Lazy bag, Lazy jacks</b>
Pohodlí	<b>Polštáře do kokpitu</b>
Zábava	<b>Fusion radio, Venkovní reproduktory</b>



#### WEBSITE

[www.plujeme.cz](http://www.plujeme.cz)



#### E-MAIL

[info@plujeme.cz](mailto:info@plujeme.cz)



#### TELEFON

+420 720 755 085



#### MOBILE

+420 777 170 276



#### PLUJEME RÁDI S.R.O.

Dlouhá 730/35, 11000 Praha 1 – Staré Město, Česká republika

## SLUŽBY

VYBRANÉ SLUŽBY	POVINNÉ	TYP PLATBY	CENA
<b>Manipulační poplatky (Platba předem)</b> <b>Sezóna: 2026.</b>	Ano	za rezervaci	<b>25,00 €</b>
<b>Poplatek za přípravu jachty (Platba předem)</b> <b>Sezóna: 2026.</b> INCLUDED: starter pack – (1 gallon water or 4 bottles of 1.5L, 1 bottle of disinfectant, 1 small bottle of washing up liquid, 1 dish cloth, 1 sponge, garbage bags, 1 roll of paper towels, 1 box of matches, 1 roll of toilet paper in each head) // final cleaning // 1 set of bed sheets / cabin & 1 set of towels / pax, dinghy, outboard engine & initial supply of fuel, gas and water tanks // DYC assistance guarantee // 1st & last night in the marina // NOT INCLUDED: refuelling, gas & water consumption at end of charter, taxes if any, handling fees & additional equipment deposit.	Ano	za rezervaci	<b>380,00 €</b>
<b>Dřívější nalodění (Platba předem)</b> <b>Sezóna: 2026.</b> EB (boat only) - 13:00h, starting time of boat's delivery // limited number of early boardings on same departure day	Ne	za rezervaci	<b>300,00 €</b>
<b>Dřívější nalodění (Platba předem)</b> <b>Sezóna: 2026.</b> EB + extra fee skipper - 13:00h, starting time of boat's delivery // limited number of early boardings on same departure day	Ne	za rezervaci	<b>430,00 €</b>
<b>Dřívější nalodění (Platba předem)</b> <b>Sezóna: 2026.</b> EB + extra fee Skipper & Hostess - 13:00h, starting time of boat's delivery // limited number of early boardings on same departure day	Ne	za rezervaci	<b>530,00 €</b>
<b>Extra sada prádla (vyberte si kolik) (Platba předem)</b> <b>Sezóna: 2026.</b> Extra set of linen : 15 € 1 extra set of linen (2 sheets & 2 pillow case) - to be updated manually	Ne	za rezervaci	<b>15,00 €</b>
<b>Extra set of towels (choose how many) (Platba předem)</b> <b>Sezóna: 2026.</b> Extra set of towels: 10 € 1 extra set of towels (1 face & 1 bath towel) - to be updated manually	Ne	za rezervaci	<b>10,00 €</b>
<b>extra úklid (Platba předem)</b> <b>Sezóna: 2026.</b> Optional Additional cleaning	Ne	za rezervaci	<b>320,00 €</b>
<b>Full board 1-4 (number of guests to update manually) (Platba předem)</b> <b>Sezóna: 2026.</b> only available if cook is booked on board as the cook will do the provisioning based on client's preference. Includes breakfast, lunch & dinner + the crew's food. Does not included alcoholic drinks	Ne	per guest/day	<b>60,00 €</b>

<p><b>Full board 5-12 pax (number of guests to update manually)</b> (Platba předem)</p> <p><b>Sezóna: 2026.</b> only available if cook is booked on board as the cook will do the provisioning based on client's preference. Includes breakfast, lunch &amp; dinner + the crew's food. Does not included alcoholic drinks</p>	Ne	per guest/day	<b>55,00 €</b>
<p><b>Half board 1-4 (number of guests to update manually)</b> (Platba předem)</p> <p><b>Sezóna: 2026.</b> only available if cook is booked on board as the cook will do the provisioning based on client's preference. Includes breakfast &amp; lunch OR dinner + the crew's food. Does not included alcoholic drinks</p>	Ne	per guest/day	<b>50,00 €</b>
<p><b>Half board 5-12 pax (number of guests to update manually)</b> (Platba předem)</p> <p><b>Sezóna: 2026.</b> only available if cook is booked on board as the cook will do the provisioning based on client's preference. Includes breakfast &amp; lunch OR dinner + the crew's food. Does not included alcoholic drinks</p>	Ne	per guest/day	<b>45,00 €</b>
<p><b>Hosteska/kuchař</b> (Platba předem)</p> <p><b>Sezóna: 2026.</b> + provisioning, Crew on board must have their own toilets/ showers. If either a skipper or a hostess/cook is on board, 1 double cabin will be required for him/her. If both a skipper and a hostess/cook are on board, 1 double cabin and 1 forepeak cabin will be required for them. Exceptions exists for specific layouts, Sales Agents will provide more details about the different boat models</p>	Ne	za noc	<b>200,00 €</b>
<p><b>Hosteska/kuchař</b> (Platba předem)</p> <p><b>Sezóna: 2026.</b> + provisioning, Crew on board must have their own toilets/ showers. If either a skipper or a hostess/cook is on board, 1 double cabin will be required for him/her. If both a skipper and a hostess/cook are on board, 1 double cabin and 1 forepeak cabin will be required for them. Exceptions exists for specific layouts, Sales Agents will provide more details about the different boat models</p>	Ne	za noc	<b>200,00 €</b>
<p><b>Hosteska/kuchař</b> (Platba předem)</p> <p><b>Sezóna: 2026.</b> + provisioning, Crew on board must have their own toilets/ showers. If either a skipper or a hostess/cook is on board, 1 double cabin will be required for him/her. If both a skipper and a hostess/cook are on board, 1 double cabin and 1 forepeak cabin will be required for them. Exceptions exists for specific layouts, Sales Agents will provide more details about the different boat models</p>	Ne	za noc	<b>220,00 €</b>
<p><b>Kapitán</b> (Platba předem)</p> <p><b>Sezóna: 2026.</b> + provisioning, Crew on board must have their own toilets/ showers. If either a skipper or a hostess/cook is on board, 1 double cabin will be required for him/her. If both a skipper and a hostess/cook are on board, 1 double cabin and 1 forepeak cabin will be required for them. Exceptions exists for specific layouts, Sales Agents will provide more details about the different boat models</p>	Ne	za noc	<b>270,00 €</b>

<b>Kapitán (Platba předem)</b>	Ne	za noc	<b>270,00 €</b>
<b>Sezóna: 2026.</b> + provisioning, Crew on board must have their own toilets/ showers. If either a skipper or a hostess/cook is on board, 1 double cabin will be required for him/her. If both a skipper and a hostess/cook are on board, 1 double cabin and 1 forepeak cabin will be required for them. Exceptions exists for specific layouts, Sales Agents will provide more details about the different boat models			
<b>Kapitán (Platba předem)</b>	Ne	za noc	<b>300,00 €</b>
<b>Sezóna: 2026.</b> + provisioning, Crew on board must have their own toilets/ showers. If either a skipper or a hostess/cook is on board, 1 double cabin will be required for him/her. If both a skipper and a hostess/cook are on board, 1 double cabin and 1 forepeak cabin will be required for them. Exceptions exists for specific layouts, Sales Agents will provide more details about the different boat models			
<b>Pojištění kauce (Platba předem)</b>	Ne	za noc	<b>50,00 €</b>
<b>Sezóna: 2026.</b> Damage waiver limits your liability to the reduced Security Deposit . Mandatory when skipper is added. Price is per night of the charter ( minimum value of 7 nights & a maximum value of 21 nights). Not applicable for 4+ weeks charters , nor Regattas/Races.			
<b>Příplatek za regatu (Platba předem)</b>	Ne	za rezervaci	<b>0,00 €</b>
<b>Sezóna: 2026.</b> A special race deposit need to be doubled manually once the regatta surcharge is added.			
<b>Spotřeba elektřiny a vody v přístavech (Platba na základně)</b>	Ne	za rezervaci	<b>28,00 €</b>
<b>Sezóna: 2026.</b> Electric & Water consumption based on 2 nights on our dock (base will confirm the amount to pay locally depending on nights spent on dock)			
<b>Transfer (Platba předem)</b>	Ne	one-way	<b>52,00 €</b>
<b>Sezóna: 2026.</b> OW - 1-4pax ,Day rate ,Train station SNCF of Toulon from/to Port Pin Rolland base			
<b>Transfer (Platba předem)</b>	Ne	one-way	<b>52,00 €</b>
<b>Sezóna: 2026.</b> OW - 1-4pax ,Day rate , Ferry terminal of Toulon from/to Port Pin Rolland base			
<b>Transfer (Platba předem)</b>	Ne	one-way	<b>65,00 €</b>
<b>Sezóna: 2026.</b> OW - 5-7 pax ,Day rate ,Train station SNCF of Toulon from/to Port Pin Rolland			
<b>Transfer (Platba předem)</b>	Ne	one-way	<b>65,00 €</b>
<b>Sezóna: 2026.</b> OW - 1-4pax ,Night rate(19:00 – 07:00) Train station SNCF of Toulon from/to Port Pin Rolland			

<b>Transfer</b> (Platba předem)	Ne	one-way	<b>65,00 €</b>
<b>Sezóna: 2026.</b> OW - 5-7 pax ,Day rate, Ferry terminal of Toulon from/to Port Pin Rolland base			
<b>Transfer</b> (Platba předem)	Ne	one-way	<b>65,00 €</b>
<b>Sezóna: 2026.</b> OW - 1-4 pax ,Night rate(19:00-07:00), Ferry terminal of Toulon from/to Port Pin Rolland			
<b>Transfer</b> (Platba předem)	Ne	one-way	<b>78,00 €</b>
<b>Sezóna: 2026.</b> OW -5-7 pax ,Holidays,Sundays,Night rate(19:00-07:00), Train station SNCF of Toulon from/to Port Pin Rolland			
<b>Transfer</b> (Platba předem)	Ne	one-way	<b>78,00 €</b>
<b>Sezóna: 2026.</b> OW-5-7 pax ,Bank Holidays,Sundays,Night rate(19:00-07:00), Ferry terminal of Toulon from/to Port Pin Rolland base			
<b>Transfer</b> (Platba předem)	Ne	one-way	<b>247,00 €</b>
<b>Sezóna: 2026.</b> OW - 1-4 pax ,Day rate ,Airport Marseille from/to Port Pin Rolland			
<b>Transfer</b> (Platba předem)	Ne	one-way	<b>270,00 €</b>
<b>Sezóna: 2026.</b> OW - 1-4 pax ,Night rate(19:00 - 07:00), Airport Marseille from/to Port Pin Rolland base			
<b>Transfer</b> (Platba předem)	Ne	one-way	<b>290,00 €</b>
<b>Sezóna: 2026.</b> OW - 5-7 pax ,Day rate , Airport Marseille from/to Port Pin Rolland			
<b>Transfer</b> (Platba předem)	Ne	one-way	<b>340,00 €</b>
<b>Sezóna: 2026.</b> OW -5-7 pax,Holidays ,Sundays,Night rate(19:00-07:00), Airport Marseille from/to Port Pin Rolland base			
<b>Změna posádky</b> (Platba předem)	Ne	za rezervaci	<b>250,00 €</b>
<b>Sezóna: 2026.</b> Any crew change during the charter is subject to € 250.- additional cost. The charge includes administration cost, change of bed linen and towels and one night at DYC ponton (marina fee included only if the same base than start base). It doesn't include cleaning, nor new transit log where applicable.			



**WEBSITE**  
www.plujeme.cz



**TELEFON**  
+420 720 755 085



**MOBILE**  
+420 777 170 276



**E-MAIL**  
info@plujeme.cz



**PLUJEME RÁDI S.R.O.**  
Dlouhá 730/35, 11000 Praha 1 – Staré Město, Česká republika

## DODATEČNÉ DOPLŇKY

DOPLŇKY	POVINNÉ	TYP PLATBY	CENA
<b>Bezpečnostní síť</b> (Platba předem) <b>Sezóna: 2026.</b> net is supplied but not installed - Platba předem	Ne	za rezervaci	<b>250,00 €</b>
<b>Kayak single</b> (Platba předem) <b>Sezóna: 2026.</b> Price per day - Platba předem	Ne	za noc	<b>15,00 €</b>
<b>Outboard engine 8 &amp; 9,8 HP</b> (Platba předem) <b>Sezóna: 2026.</b> Subject to Availability ; 8 & 9.8hp. Dinghy not suitable in any case for waterski or wakeboard. "a powerboat licence is mandatory in French territories to drive a dinghy with an outboard more powerful than 6hp. It's client responsibility to ensure to have the right powerboat licence when renting a more powerful outboard. In case the needed licence is not presented at base, it will not be possible to use this larger outboard which will not be refunded" - Platba předem	Ne	za den	<b>35,00 €</b>
<b>Stand up paddle (SUP)</b> (Platba předem) <b>Sezóna: 2026.</b> Price per day - Platba předem	Ne	za noc	<b>15,00 €</b>



**WEBSITE**

[www.plujeme.cz](http://www.plujeme.cz)



**E-MAIL**

[info@plujeme.cz](mailto:info@plujeme.cz)



**TELEFON**

+420 720 755 085



**MOBILE**

+420 777 170 276



**PLUJEME RÁDI S.R.O.**

Dlouhá 730/35, 11000 Praha 1 – Staré Město, Česká republika

## CENA A DOSTUPNOST

25.04. - 02.05.2026 NEDOSTUPNÉ	02.05. - 09.05.2026 NEDOSTUPNÉ	09.05. - 16.05.2026 NEDOSTUPNÉ	16.05. - 23.05.2026 NEDOSTUPNÉ
23.05. - 30.05.2026 NEDOSTUPNÉ	30.05. - 06.06.2026 NEDOSTUPNÉ	06.06. - 13.06.2026 NEDOSTUPNÉ	13.06. - 20.06.2026 NEDOSTUPNÉ
20.06. - 27.06.2026 NEDOSTUPNÉ	27.06. - 04.07.2026 NEDOSTUPNÉ	04.07. - 11.07.2026 4.815 €	11.07. - 18.07.2026 NEDOSTUPNÉ
18.07. - 01.08.2026 NEDOSTUPNÉ	01.08. - 08.08.2026 NEDOSTUPNÉ	08.08. - 22.08.2026 NEDOSTUPNÉ	22.08. - 29.08.2026 NEDOSTUPNÉ
29.08. - 05.09.2026 4.285 €	05.09. - 12.09.2026 NEDOSTUPNÉ	12.09. - 19.09.2026 NEDOSTUPNÉ	19.09. - 26.09.2026 NEDOSTUPNÉ
26.09. - 03.10.2026 NEDOSTUPNÉ	03.10. - 10.10.2026 2.910 €	10.10. - 17.10.2026 2.315 €	17.10. - 24.10.2026 NEDOSTUPNÉ
24.10. - 31.10.2026 1.679 € 1.865 €	01.11. - 31.12.2098 NEDOSTUPNÉ		



### WEBSITE

[www.plujeme.cz](http://www.plujeme.cz)



### E-MAIL

[info@plujeme.cz](mailto:info@plujeme.cz)



### TELEFON

+420 720 755 085



### MOBILE

+420 777 170 276



### PLUJEME RÁDI S.R.O.

Dlouhá 730/35, 11000 Praha 1 – Staré Město, Česká republika