

# FOUNTAINÉ PAJOT ISLA 40

Barnacle (2023)

Katamarán Fountaine Pajot Isla 40 Barnacle, rok spuštění na vodu 2023 kotví v marině Seychelles, Eden Island Marina, Mahé (Seychely), Seychely . Počet kajut: 4 + 1 , může ubytovat celkem: 8 + 1 a má toalet: 2 . Povlečení a kuchyňské vybavení jsou zahrnuty v ceně.

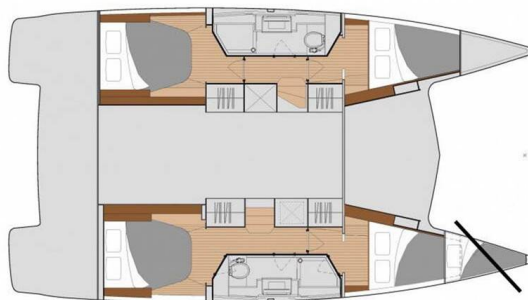

## YACHT SPECIFICATIONS

Marína <b>Seychelles, Eden Island Marina, Seychely</b>	Jachta ID <b>4777</b>	Značky <b>Fountaine Pajot</b>
Název jachty <b>Barnacle</b>	Rok výroby <b>2023</b>	Délka <b>39 ft</b>
Kabiny <b>4 + 1</b>	Lůžka <b>8 + 1</b>	Maximální počet osob <b>9</b>
WC <b>2</b>	Motor <b>2 x 30 HP</b>	Palivová nádrž <b>470 l</b>



**WEBSITE**  
www.plujeme.cz



**TELEFON**  
+420 720 755 085



**MOBILE**  
+420 777 170 276



**E-MAIL**  
info@plujeme.cz



**PLUJEME RÁDI S.R.O.**  
Dlouhá 730/35, 11000 Praha 1 – Staré Město, Česká republika

## STANDARDNÍ VYBAVENÍ JACHTY

Bezpečnost	<b>Odpadní vodní nádrž, VHF rádio</b>
Elektronika	<b>Bojler, El. přípojka 220 V, Generátor, Invertor, Klimatizace, Nabíječka baterií, Servisní baterie, Stanice DSC, Startovací baterie, Watermaker – Odsolovač vody, Zásuvka 220V, 12V</b>
Interiér	<b>Ventilátory</b>
Kuchyňka	<b>Kuchyňské potřeby ( kuchyňské zařízení, přístroje, Lednička, Trouba</b>
Navigace	<b>Autopilot, GPS mapový plotter – kokpit, Kompas, Tridata, Wind instrument/Anemometer</b>
Paluba	<b>Bimini, Elektrický kotevní vrátek, Kotva s řetězem, Koupací žebřík, Lednička v kokpitě, Nafukovací člun s přívěsným motorem, Otevírání zábradlí na obou stranách, Spring cleats, Stoleček v kokpitě, Teak cockpit table with folding leaves, Venkovní sprcha na zádi</b>
Plachty	<b>Elektrické navijáky/vinšny, Lazy bag, Lazy jacks, Vinšna</b>
Pohodlí	<b>Polštáře do kokpitu, Ručníky</b>
Zábava	<b>Podvodní světlo, Rádio CD přehrávač, Venkovní reproduktory, Vnitřní reproduktory</b>

**WEBSITE**[www.plujeme.cz](http://www.plujeme.cz)**TELEFON**

+420 720 755 085

**MOBILE**

+420 777 170 276

**E-MAIL**[info@plujeme.cz](mailto:info@plujeme.cz)**PLUJEME RÁDI S.R.O.**

Dlouhá 730/35, 11000 Praha 1 – Staré Město, Česká republika

## SLUŽBY

VYBRANÉ SLUŽBY	POVINNÉ	TYP PLATBY	CENA
<b>Comfort Pack</b> (Platba předem) <b>Sezóna: 2026 Exotic</b> . To be added upon client's price - OBLIGATORY - SEY Welcome package, final cleaning, bed sheets & towels, dinghy, outboard engine & fuel, propane gas, full water tanks, snorkelling equipment, WIFI with unlimited use. However, if the limit of 20GB per day is crossed, the internet speed is reduced for the rest of that day. Yacht Fuel is not included - the fuel tank will be full when your charter starts and you are responsible for topping off the fuel tank at the end of your charter. Security deposit is obligatory and is paid on spot in the base.	Ano	za rezervaci	<b>540,00 €</b>
<b>Manipulační poplatky</b> (Platba předem) <b>Sezóna: 2026 Exotic</b> .	Ano	za rezervaci	<b>35,00 €</b>
<b>Poplatek za přípravu jachty</b> (Platba předem) <b>Sezóna: 2026 Exotic</b> . LUDED: Welcome pack // final cleaning // 1 set of bed sheets / cabin & 1 set of towels / pax, dinghy, outboard engine & initial supply of fuel, gas and water tanks // 1st & last night in the marina // NOT INCLUDED: refuelling, gas & water consumption at end of charter, taxes if any, handling fees & additional equipment deposit.	Ano	za rezervaci	<b>395,00 €</b>
<b>Turistický poplatek</b> (Platba na základně) <b>Sezóna: 2026 Exotic</b> . According to S.I. 52 of 2023 ENVIRONMENT PROTECTION ACT (ext. of Act 18 of 2016), a Seychelles compulsory tourist tax of 100SCR per person/day (or equivalent Currency as per daily rate is applied), payable at base. NOT applicable to citizens and residents of Seychelles, children of 12 years and below (visitors), and Navigare Yacht crew. (Price will be adjusted according to the crew list)	Ano	per guest/day	<b>7,00 €</b>
<b>Extra sada prádla (vyberte si kolik)</b> (Platba předem) <b>Sezóna: 2026 Exotic</b> . Extra set of linen : 15 € 1 set of linen (2 sheets & 2 pillow case) - to be updated manually	Ne	za rezervaci	<b>15,00 €</b>
<b>Extra set of towels (choose how many)</b> (Platba předem) <b>Sezóna: 2026 Exotic</b> . Extra set of towels: 10 € 1 set of towels (1 face & 1 bath towel) - to be updated manually	Ne	za rezervaci	<b>10,00 €</b>
<b>extra úklid</b> (Platba předem) <b>Sezóna: 2026 Exotic</b> . Optional Additional cleaning	Ne	za rezervaci	<b>285,00 €</b>

<p><b>Full board 1-4 (number of guests to update manually)</b> (Platba předem)</p> <p><b>Sezóna: 2026 Exotic</b> . Only available if cook is booked on board as the cook will do the provisioning based on client's preference. Includes breakfast, lunch &amp; dinner + the crew's food. Does not include fuel, alcoholic drinks, moorings park or landing fees.</p>	Ne	per guest/day	<b>60,00 €</b>
<p><b>Full board 5-12 pax (number of guests to update manually)</b> (Platba předem)</p> <p><b>Sezóna: 2026 Exotic</b> . Only available if cook is booked on board as the cook will do the provisioning based on client's preference. Includes breakfast, lunch &amp; dinner + the crew's food. Does not include fuel, alcoholic drinks, moorings park or landing fees.</p>	Ne	per guest/day	<b>55,00 €</b>
<p><b>Gritchen pojištění storna</b> (Platba předem)</p> <p><b>Sezóna: 2026 Exotic</b> . with Covid coverage (4% of client's Total price) - European clients Only</p>	Ne	za rezervaci	<b>0,00 €</b>
<p><b>Half board 1-4 (number of guests to update manually)</b> (Platba předem)</p> <p><b>Sezóna: 2026 Exotic</b> . only available if cook is booked on board as the cook will do the provisioning based on client's preference. Includes breakfast &amp; lunch OR dinner + the crew's food. Does not included alcoholic drinks</p>	Ne	per guest/day	<b>50,00 €</b>
<p><b>Half board 5-12 pax (number of guests to update manually)</b> (Platba předem)</p> <p><b>Sezóna: 2026 Exotic</b> . only available if cook is booked on board as the cook will do the provisioning based on client's preference. Includes breakfast &amp; lunch OR dinner + the crew's food. Does not included alcoholic drinks</p>	Ne	per guest/day	<b>45,00 €</b>
<p><b>Kapitán</b> (Platba předem)</p> <p><b>Sezóna: 2026 Exotic</b> . +provisioning ; Crew on board must have their own toilets/showers. If either a skipper or a hostess/cook is on board, 1 double cabin will be required for him/her. If both a skipper and a hostess/cook are on board, 1 double cabin and 1 forepeak cabin will be required for them. Exceptions exists for specific layouts, Sales Agents will provide more details about the different boat models. ***NOTE: Skipper details will be available 3 days before the charter.</p>	Ne	za den + strava	<b>170,00 €</b>
<p><b>Kapitán</b> (Platba předem)</p> <p><b>Sezóna: 2026 Exotic</b> . +provisioning ; Crew on board must have their own toilets/showers. If either a skipper or a hostess/cook is on board, 1 double cabin will be required for him/her. If both a skipper and a hostess/cook are on board, 1 double cabin and 1 forepeak cabin will be required for them. Exceptions exists for specific layouts, Sales Agents will provide more details about the different boat models. ***NOTE: Skipper details will be available 3 days before the charter.</p>	Ne	za den + strava	<b>170,00 €</b>

**Kapitán** (Platba předem)Ne za den + strava **190,00 €**

**Sezóna: 2026 Exotic** . +provisioning ; Crew on board must have their own toilets/showers. If either a skipper or a hostess/cook is on board, 1 double cabin will be required for him/her. If both a skipper and a hostess/cook are on board, 1 double cabin and 1 forepeak cabin will be required for them. Exceptions exists for specific layouts, Sales Agents will provide more details about the different boat models.

\*\*\*NOTE: Skipper details will be available 3 days before the charter.

---

**Kapitán+kuchař** (Platba předem)Ne za den + strava **220,00 €**

**Sezóna: 2026 Exotic** . (for charters up to max 3 guests, one person works as a skipper and cook) + provisioning, Crew on board must have their own toilets/showers. If either a skipper or a hostess/cook is on board, 1 double cabin will be required for him/her. If both a skipper and a hostess/cook are on board, 1 double cabin and 1 forepeak cabin will be required for them. Exceptions exists for specific layouts, Sales Agents will provide more details about the different boat models

---

**Kapitán+kuchař** (Platba předem)Ne za den + strava **220,00 €**

**Sezóna: 2026 Exotic** . (for charters up to max 3 guests, one person works as a skipper and cook) + provisioning, Crew on board must have their own toilets/showers. If either a skipper or a hostess/cook is on board, 1 double cabin will be required for him/her. If both a skipper and a hostess/cook are on board, 1 double cabin and 1 forepeak cabin will be required for them. Exceptions exists for specific layouts, Sales Agents will provide more details about the different boat models

---

**Kapitán+kuchař** (Platba předem)Ne za den + strava **245,00 €**

**Sezóna: 2026 Exotic** . (for charters up to max 3 guests, one person works as a skipper and cook) + provisioning, Crew on board must have their own toilets/showers. If either a skipper or a hostess/cook is on board, 1 double cabin will be required for him/her. If both a skipper and a hostess/cook are on board, 1 double cabin and 1 forepeak cabin will be required for them. Exceptions exists for specific layouts, Sales Agents will provide more details about the different boat models

---

**Kuchař** (Platba předem)Ne za den + strava **145,00 €**

**Sezóna: 2026 Exotic** . +provisioning ; Crew on board must have their own toilets/showers. If either a skipper or a hostess/cook is on board, 1 double cabin will be required for him/her. If both a skipper and a hostess/cook are on board, 1 double cabin and 1 forepeak cabin will be required for them. Exceptions exists for specific layouts, Sales Agents will provide more details about the different boat models. Cooking breakfast, lunch, 5 dinners a week, supply, keeping the kitchen clean (not the rest of the boat, not the cabins).

---

**Kuchař** (Platba předem)Ne za den + strava **145,00 €**

**Sezóna: 2026 Exotic** . +provisioning ; Crew on board must have their own toilets/showers. If either a skipper or a hostess/cook is on board, 1 double cabin will be required for him/her. If both a skipper and a hostess/cook are on board, 1 double cabin and 1 forepeak cabin will be required for them. Exceptions exists for specific layouts, Sales Agents will provide more details about the different boat models. Cooking breakfast, lunch, 5 dinners a week, supply, keeping the kitchen clean (not the rest of the boat, not the cabins).

**Kuchař** (Platba předem)Ne za den + strava **160,00 €**

**Sezóna: 2026 Exotic** . +provisioning ; Crew on board must have their own toilets/showers. If either a skipper or a hostess/cook is on board, 1 double cabin will be required for him/her. If both a skipper and a hostess/cook are on board, 1 double cabin and 1 forepeak cabin will be required for them. Exceptions exists for specific layouts, Sales Agents will provide more details about the different boat models. A gratuity of 15–20% of the crew fee is customary for excellent service. Cooking breakfast, lunch, dinners, keeping the kitchen clean (not the rest of the boat, not the cabins). NOTE: Cook details will be available 3 days before the charter.

**Pojištění kauce** (Platba předem)Ne za noc **60,00 €**

**Sezóna: 2026 Exotic** . Damage waiver limits your liability to the reduced Security Deposit . Mandatory when skipper is added. Price is per night of the charter ( minimum value of 7 nights & a maximum value of 21 nights) Not applicable for 4+ weeks charters , nor Regattas/Races.

**WI-FI Internet na lodi** (Platba předem)Ne za noc **12,00 €**

**Sezóna: 2026 Exotic** . Unlimited GigaBytes included in the price

**WEBSITE**[www.plujeme.cz](http://www.plujeme.cz)**TELEFON**

+420 720 755 085

**MOBILE**

+420 777 170 276

**E-MAIL**[info@plujeme.cz](mailto:info@plujeme.cz)**PLUJEME RÁDI S.R.O.**

Dlouhá 730/35, 11000 Praha 1 – Staré Město, Česká republika

## DODATEČNÉ DOPLŇKY

DOPLŇKY	POVINNÉ	TYP PLATBY	CENA
<b>Extra povlečení a ručníky</b> (Platba předem) <i>Sezóna: 2026 Exotic . Platba předem</i>	Ne	za osobu	<b>20,00 €</b>
<b>Stand up paddle (SUP)</b> (Platba předem) <i>Sezóna: 2026 Exotic . Price per day - Platba předem</i>	Ne	za noc	<b>15,00 €</b>

**WEBSITE**

[www.plujeme.cz](http://www.plujeme.cz)

**E-MAIL**

[info@plujeme.cz](mailto:info@plujeme.cz)

**TELEFON**

+420 720 755 085

**MOBILE**

+420 777 170 276

**PLUJEME RÁDI S.R.O.**

Dlouhá 730/35, 11000 Praha 1 – Staré Město, Česká republika

## CENA A DOSTUPNOST

25.04. - 02.05.2026 5.485 €	02.05. - 09.05.2026 5.915 €	09.05. - 16.05.2026 NEDOSTUPNÉ	16.05. - 13.06.2026 NEDOSTUPNÉ
13.06. - 20.06.2026 3.636 € 4.545 €	20.06. - 27.06.2026 3.636 € 4.545 €	27.06. - 04.07.2026 3.636 € 4.545 €	04.07. - 11.07.2026 3.612 € 4.515 €
11.07. - 18.07.2026 NEDOSTUPNÉ	20.07. - 27.07.2026 NEDOSTUPNÉ	05.08. - 19.08.2026 NEDOSTUPNÉ	24.08. - 31.08.2026 NEDOSTUPNÉ
05.09. - 26.09.2026 NEDOSTUPNÉ	26.09. - 03.10.2026 4.000 € 5.000 €	08.10. - 15.10.2026 NEDOSTUPNÉ	17.10. - 24.10.2026 7.290 €
24.10. - 31.10.2026 6.422 € 6.760 €	31.10. - 14.11.2026 NEDOSTUPNÉ	14.11. - 21.11.2026 7.125 € 7.500 €	21.11. - 28.11.2026 7.125 € 7.500 €
28.11. - 12.12.2026 NEDOSTUPNÉ			



WEBSITE

[www.plujeme.cz](http://www.plujeme.cz)



E-MAIL

[info@plujeme.cz](mailto:info@plujeme.cz)



TELEFON

+420 720 755 085



MOBILE

+420 777 170 276



PLUJEME RÁDI S.R.O.

Dlouhá 730/35, 11000 Praha 1 – Staré Město, Česká republika

## CENA A DOSTUPNOST

12.12. - 19.12.2026 4.099 € 4.315 €	19.12. - 26.12.2026 5.710 € 6.010 €	02.01. - 09.01.2027 6.208 € 6.535 €	09.01. - 16.01.2027 5.201 € 5.475 €
16.01. - 23.01.2027 5.201 € 5.475 €	23.01. - 30.01.2027 5.201 € 5.475 €	30.01. - 06.02.2027 5.947 € 6.260 €	06.02. - 13.02.2027 6.693 € 7.045 €
13.02. - 20.02.2027 6.878 € 7.240 €	20.02. - 27.02.2027 7.063 € 7.435 €	27.02. - 06.03.2027 7.063 € 7.435 €	06.03. - 13.03.2027 7.429 € 7.820 €
13.03. - 20.03.2027 7.429 € 7.820 €	20.03. - 27.03.2027 7.429 € 7.820 €	27.03. - 03.04.2027 7.676 € 8.080 €	03.04. - 10.04.2027 7.676 € 8.080 €
10.04. - 17.04.2027 7.676 € 8.080 €	17.04. - 24.04.2027 7.676 € 8.080 €	24.04. - 01.05.2027 6.769 € 7.125 €	01.05. - 08.05.2027 5.472 € 5.760 €
08.05. - 15.05.2027 4.646 € 4.890 €	15.05. - 22.05.2027 4.646 € 4.890 €	22.05. - 29.05.2027 4.646 € 4.890 €	29.05. - 05.06.2027 4.403 € 4.635 €
05.06. - 12.06.2027 4.403 € 4.635 €	12.06. - 19.06.2027 4.403 € 4.635 €	19.06. - 26.06.2027 4.403 € 4.635 €	26.06. - 03.07.2027 4.403 € 4.635 €
03.07. - 10.07.2027 4.660 € 4.905 €	10.07. - 17.07.2027 4.660 € 4.905 €	17.07. - 24.07.2027 4.660 € 4.905 €	24.07. - 31.07.2027 4.660 € 4.905 €
31.07. - 07.08.2027 4.992 € 5.255 €			



WEBSITE  
[www.plujeme.cz](http://www.plujeme.cz)



E-MAIL  
[info@plujeme.cz](mailto:info@plujeme.cz)



TELEFON  
+420 720 755 085



PLUJEME RÁDI S.R.O.  
Dlouhá 730/35, 11000 Praha 1 – Staré Město, Česká republika



MOBILE  
+420 777 170 276

## CENA A DOSTUPNOST

07.08. - 14.08.2027 <b>4.992 €</b> 5.255 €	14.08. - 21.08.2027 <b>4.660 €</b> 4.905 €	21.08. - 28.08.2027 <b>4.308 €</b> 4.535 €	28.08. - 04.09.2027 <b>4.308 €</b> 4.535 €
04.09. - 11.09.2027 <b>4.308 €</b> 4.535 €	11.09. - 18.09.2027 <b>4.308 €</b> 4.535 €	18.09. - 25.09.2027 <b>4.527 €</b> 4.765 €	25.09. - 02.10.2027 <b>4.750 €</b> 5.000 €
02.10. - 09.10.2027 <b>5.035 €</b> 5.300 €	09.10. - 16.10.2027 <b>5.339 €</b> 5.620 €	16.10. - 23.10.2027 <b>5.710 €</b> 6.010 €	23.10. - 30.10.2027 <b>6.156 €</b> 6.480 €
30.10. - 06.11.2027 <b>6.156 €</b> 6.480 €	06.11. - 13.11.2027 <b>6.156 €</b> 6.480 €	13.11. - 20.11.2027 <b>6.156 €</b> 6.480 €	20.11. - 27.11.2027 <b>6.156 €</b> 6.480 €
27.11. - 04.12.2027 <b>6.156 €</b> 6.480 €	04.12. - 11.12.2027 <b>4.304 €</b> 4.530 €	11.12. - 18.12.2027 <b>4.099 €</b> 4.315 €	18.12. - 25.12.2027 <b>5.710 €</b> 6.010 €



WEBSITE

[www.plujeme.cz](http://www.plujeme.cz)



E-MAIL

[info@plujeme.cz](mailto:info@plujeme.cz)



TELEFON

+420 720 755 085



MOBILE

+420 777 170 276



PLUJEME RÁDI S.R.O.

Dlouhá 730/35, 11000 Praha 1 – Staré Město, Česká republika