

# BALI CATSPACE OW

NANCYE IV (2023)

Katamarán Bali Catspace OW NANCYE IV, rok spuštění na vodu 2023 kotví v marině BVI, Hodge's Creek Marina, Britské Panenské Ostrovy (BVI), Britské Panenské ostrovy. Počet kajut: 3, může ubytovat celkem: 6 a má toalet: 3. Povlečení a kuchyňské vybavení jsou zahrnuté v ceně.

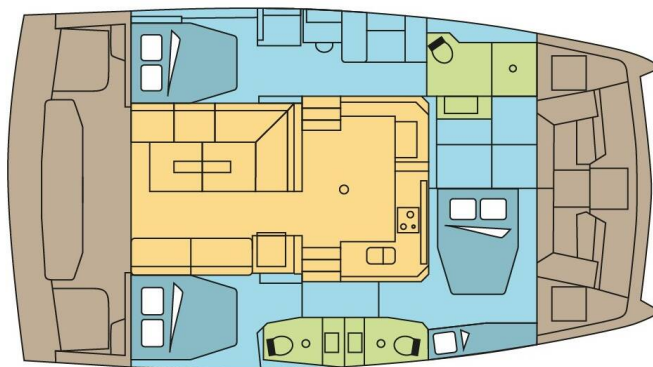

## YACHT SPECIFICATIONS

Marína <b>BVI, Hodge's Creek Marina, Britské Panenské ostrovy</b>	Jachta ID <b>14145</b>	Značka <b>Catana</b>
Název jachty <b>NANCYE IV</b>	Rok výroby <b>2023</b>	Délka <b>40 ft</b>
Kabiny <b>3</b>	Lůžka <b>6</b>	Maximální počet osob <b>7</b>
WC <b>3</b>	Motor <b>2 x 40 HP</b>	Palivová nádrž <b>400 l</b>



**WEBSITE**  
[www.plujeme.cz](http://www.plujeme.cz)



**TELEFON**  
+420 720 755 085



**MOBILE**  
+420 777 170 276



**E-MAIL**  
[info@plujeme.cz](mailto:info@plujeme.cz)



**PLUJEME RÁDI S.R.O.**  
Dlouhá 730/35, 11000 Praha 1 – Staré Město, Česká republika

## STANDARDNÍ VYBAVENÍ JACHTY

Bezpečnost	<b>Bezpečnostní vybavení, Extra vodní nádrž, VHF rádio</b>
Elektronika	<b>110V zásuvka, Generátor, Invertor, Klimatizace, Nabíječka baterií, Pripojka břehového napájení, Servisní baterie, Solární panely, Watermaker – Odsolovač vody</b>
Interiér	<b>Curtains, Elektrické WC, Ventilátory v kajutách</b>
Kuchyňka	<b>Mrazák, Trouba</b>
Navigace	<b>AIS, Autopilot, GPS mapový plotter, Hloubkoměr, Wind instrument/Anemometer</b>
Paluba	<b>Bimini, Davit, Elektrický kotevní vrátek, Flybridge, Foredeck sunbathing area, Kotva s řetězem, Koupací žebřík, Nafukovací člun, Ovladač kotevního vrátku s počítadlem délky řetězu u kormidla, Přívěsný motor, Spring cleats, Stoleček v kokpitu, Sun awning (forward cockpit), Světlo v kokpitu, Venkovní sprcha na zádi</b>
Plachty	<b>Elektrické navijáky/vinšny, Lazy bag, Lazy jacks</b>
Pohodlí	<b>Polštáře do kokpitu, Sítko proti komárům</b>
Zábava	<b>Fusion radio</b>



**WEBSITE**

[www.plujeme.cz](http://www.plujeme.cz)



**TELEFON**

+420 720 755 085



**MOBILE**

+420 777 170 276



**E-MAIL**

[info@plujeme.cz](mailto:info@plujeme.cz)



**PLUJEME RÁDI S.R.O.**

Dlouhá 730/35, 11000 Praha 1 – Staré Město, Česká republika

# SLUŽBY

VYBRANÉ SLUŽBY	POVINNÉ	TYP PLATBY	CENA
<b>Essentials pack</b> (Platba předem) <b>Sezóna: 2026 Exotic.</b> INCLUDED: Damage waiver (covering damages) with reduced security deposit addressed specifically to blocked toilets, unpaid fuel, lost equipment, unpaid fees & fines, and returning the boat in an extremely dirty state. // starter pack – (1 gallon water or 4 bottles of 1.5L, 1 bottle of disinfectant, 1 small bottle of washing up liquid, 1 dish cloth, 1 sponge, garbage bags, 1 roll of paper towels, 1 box of matches, 1 roll of toilet paper in each head)// final cleaning // 1 set of bed sheets & towels, dinghy, outboard engine & initial supply of fuel, gas and water tanks // DYC assistance guarantee // 1st & last night in the marina /// NOT INCLUDED: refuelling, gas & water consumption at end of charter, taxes if any, handling fees & additional equipment deposit.	Ano	za rezervaci	<b>810,00 €</b>
<b>Manipulační poplatky</b> (Platba předem) <b>Sezóna: 2026 Exotic.</b>	Ano	za rezervaci	<b>35,00 €</b>
<b>Poplatek za plavbu v BVI</b> (Platba na základně) <b>Sezóna: 2026 Exotic.</b> Payment in cash only	Ano	per guest/day	<b>3,64 €</b>
<b>Poplatek za přípravu jachty</b> (Platba předem) <b>Sezóna: 2026 Exotic.</b> INCLUDED: starter pack – (1 gallon water or 4 bottles of 1.5L, 1 bottle of disinfectant, 1 small bottle of washing up liquid, 1 dish cloth, 1 sponge, garbage bags, 1 roll of paper towels, 1 box of matches, 1 roll of toilet paper in each head)// final cleaning // 1 set of bed sheets / cabin & 1 set of towels / pax, dinghy, outboard engine & initial supply of fuel, gas and water tanks // DYC assistance guarantee // 1st & last night in the marina // NOT INCLUDED: refuelling, gas & water consumption at end of charter, taxes if any, handling fees & additional equipment deposit.	Ano	za rezervaci	<b>415,00 €</b>
<b>Search &amp; Sea rescue</b> (Platba na základně) <b>Sezóna: 2026 Exotic.</b> 5 US \$ per person / Payment in cash only	Ano	za osobu	<b>4,55 €</b>
<b>Vstup do národních parků</b> (Platba na základně) <b>Sezóna: 2026 Exotic.</b> US \$ 25.-/boat/week/up to 4 persons US \$ 35.-/boat/week/up to 6 persons US \$ 45.-/boat/week/up to 8 persons US \$ 55.-/boat/week/up to 10 persons US \$ 5.-/week for any additional person Payment in cash only / Foreign based boats pay twice those amounts All above taxes and fees are payable on spot and subject to change without notice	Ano	za týden	<b>0,00 €</b>

<b>Charge for last minute change</b> (Platba na základně)	Ne	za rezervaci	<b>80,00 €</b>
<b>Sezóna: 2026 Exotic.</b> Any last minute change 3 days or less of passenger information will be charged: 80 € per booking			
<b>Extra sada prádla (vyberte si kolik)</b> (Platba předem)	Ne	za rezervaci	<b>15,00 €</b>
<b>Sezóna: 2026 Exotic.</b> Extra set of linen : 15 € 1 set of linen (2 sheets & 2 pillow case) - to be updated manually			
<b>Extra set of towels (choose how many)</b> (Platba předem)	Ne	za rezervaci	<b>10,00 €</b>
<b>Sezóna: 2026 Exotic.</b> Extra set of towels: 10 € 1 set of towels (1 face & 1 bath towel) - to be updated manually			
<b>extra úklid</b> (Platba předem)	Ne	za rezervaci	<b>285,00 €</b>
<b>Sezóna: 2026 Exotic.</b> Optional Additional cleaning			
<b>Hosteska/kuchař</b> (Platba předem)	Ne	za noc	<b>230,00 €</b>
<b>Sezóna: 2026 Exotic.</b> + provisioning, Crew on board must have their own toilets/showers. If either a skipper or a hostess/cook is on board, 1 double cabin will be required for him/her. If both a skipper and a hostess/cook are on board, 1 double cabin and 1 forepeak cabin will be required for them. Exceptions exists for specific layouts, Sales Agents will provide more details about the different boat models			
<b>Hosteska/kuchař</b> (Platba předem)	Ne	za noc	<b>230,00 €</b>
<b>Sezóna: 2026 Exotic.</b> + provisioning, Crew on board must have their own toilets/showers. If either a skipper or a hostess/cook is on board, 1 double cabin will be required for him/her. If both a skipper and a hostess/cook are on board, 1 double cabin and 1 forepeak cabin will be required for them. Exceptions exists for specific layouts, Sales Agents will provide more details about the different boat models			
<b>Hosteska/kuchař</b> (Platba předem)	Ne	za noc	<b>230,00 €</b>
<b>Sezóna: 2026 Exotic.</b> + provisioning, Crew on board must have their own toilets/showers. If either a skipper or a hostess/cook is on board, 1 double cabin will be required for him/her. If both a skipper and a hostess/cook are on board, 1 double cabin and 1 forepeak cabin will be required for them. Exceptions exists for specific layouts, Sales Agents will provide more details about the different boat models			
<b>Hosteska/kuchař</b> (Platba předem)	Ne	za noc	<b>255,00 €</b>
<b>Sezóna: 2026 Exotic.</b> + provisioning, Crew on board must have their own toilets/showers. If either a skipper or a hostess/cook is on board, 1 double cabin will be required for him/her. If both a skipper and a hostess/cook are on board, 1 double cabin and 1 forepeak cabin will be required for them. Exceptions exists for specific layouts, Sales Agents will provide more details about the different boat models			

<b>Hosteska/kuchař (Platba předem)</b> <b>Sezóna: 2026 Exotic.</b> + provisioning, Crew on board must have their own toilets/showers. If either a skipper or a hostess/cook is on board, 1 double cabin will be required for him/her. If both a skipper and a hostess/cook are on board, 1 double cabin and 1 forepeak cabin will be required for them. Exceptions exists for specific layouts, Sales Agents will provide more details about the different boat models	Ne	za noc	<b>255,00 €</b>
<b>Kapitán (Platba předem)</b> <b>Sezóna: 2026 Exotic.</b> + provisioning, Crew on board must have their own toilets/showers. If either a skipper or a hostess/cook is on board, 1 double cabin will be required for him/her. If both a skipper and a hostess/cook are on board, 1 double cabin and 1 forepeak cabin will be required for them. Exceptions exists for specific layouts, Sales Agents will provide more details about the different boat models	Ne	za noc	<b>270,00 €</b>
<b>Kapitán (Platba předem)</b> <b>Sezóna: 2026 Exotic.</b> + provisioning, Crew on board must have their own toilets/showers. If either a skipper or a hostess/cook is on board, 1 double cabin will be required for him/her. If both a skipper and a hostess/cook are on board, 1 double cabin and 1 forepeak cabin will be required for them. Exceptions exists for specific layouts, Sales Agents will provide more details about the different boat models	Ne	za noc	<b>270,00 €</b>
<b>Kapitán (Platba předem)</b> <b>Sezóna: 2026 Exotic.</b> + provisioning, Crew on board must have their own toilets/showers. If either a skipper or a hostess/cook is on board, 1 double cabin will be required for him/her. If both a skipper and a hostess/cook are on board, 1 double cabin and 1 forepeak cabin will be required for them. Exceptions exists for specific layouts, Sales Agents will provide more details about the different boat models	Ne	za noc	<b>270,00 €</b>
<b>Kapitán (Platba předem)</b> <b>Sezóna: 2026 Exotic.</b> + provisioning, Crew on board must have their own toilets/showers. If either a skipper or a hostess/cook is on board, 1 double cabin will be required for him/her. If both a skipper and a hostess/cook are on board, 1 double cabin and 1 forepeak cabin will be required for them. Exceptions exists for specific layouts, Sales Agents will provide more details about the different boat models	Ne	za noc	<b>295,00 €</b>
<b>Kapitán (Platba předem)</b> <b>Sezóna: 2026 Exotic.</b> + provisioning, Crew on board must have their own toilets/showers. If either a skipper or a hostess/cook is on board, 1 double cabin will be required for him/her. If both a skipper and a hostess/cook are on board, 1 double cabin and 1 forepeak cabin will be required for them. Exceptions exists for specific layouts, Sales Agents will provide more details about the different boat models	Ne	za noc	<b>295,00 €</b>
<b>Plná penze 1-3 osoby (počet hostů aktualizujte ručně) (Platba předem)</b> <b>Sezóna: 2026 Exotic.</b> only available if cook is booked on board as the cook will do the provisioning based on client's preference. Includes breakfast, lunch & dinner + the crew's food. Does not included alcoholic drinks	Ne	per guest/day	<b>90,00 €</b>

<b>Plná penze 4-6 osob (počet hostů aktualizujte ručně)</b> (Platba předem) <b>Sezóna: 2026 Exotic.</b> only available if cook is booked on board as the cook will do the provisioning based on client's preference. Includes breakfast, lunch & dinner + the crew's food. Does not included alcoholic drinks	Ne	per guest/day	<b>75,00 €</b>
<b>Plná penze 7-12 osob (počet hostů bude aktualizován ručně)</b> (Platba předem) <b>Sezóna: 2026 Exotic.</b> only available if cook is booked on board as the cook will do the provisioning based on client's preference. Includes breakfast, lunch & dinner + the crew's food. Does not included alcoholic drinks	Ne	per guest/day	<b>70,00 €</b>
<b>Pojištění kauce</b> (Platba předem) <b>Sezóna: 2026 Exotic.</b> Damage waiver limits your liability to the reduced Security Deposit . Mandatory when skipper is added. Price is per night of the charter ( minimum value of 7 nights & a maximum value of 21 nights) Not applicable for 4+ weeks charters , nor Regattas/Races.	Ne	za noc	<b>70,00 €</b>
<b>Polopenze 1-3 osoby (počet hostů aktualizovat ručně)</b> (Platba předem) <b>Sezóna: 2026 Exotic.</b> only available if cook is booked on board as the cook will do the provisioning based on client's preference. Includes breakfast & lunch OR dinner + the crew's food. Does not included alcoholic drinks	Ne	per guest/day	<b>75,00 €</b>
<b>Polopenze 4-6 osob (počet hostů aktualizujte ručně)</b> (Platba předem) <b>Sezóna: 2026 Exotic.</b> only available if cook is booked on board as the cook will do the provisioning based on client's preference. Includes breakfast & lunch OR dinner + the crew's food. Does not included alcoholic drinks	Ne	per guest/day	<b>60,00 €</b>
<b>Polopenze 7-12 osob (počet hostů aktualizujte ručně)</b> (Platba předem) <b>Sezóna: 2026 Exotic.</b> only available if cook is booked on board as the cook will do the provisioning based on client's preference. Includes breakfast & lunch OR dinner + the crew's food. Does not included alcoholic drinks	Ne	per guest/day	<b>55,00 €</b>
<b>Příplatek za regatu</b> (Platba předem) <b>Sezóna: 2026 Exotic.</b> valid for ASW regatta only // A special race deposit need to be doubled manually once the regatta surcharge is added.	Ne	za rezervaci	<b>1.850,00 €</b>
<b>Příplatek za regatu</b> (Platba předem) <b>Sezóna: 2026 Exotic.</b> all the regattas apart of ASW (different regatta surcharge for ASW) // A special race deposit need to be doubled manually once the regatta surcharge is added.	Ne	za rezervaci	<b>0,00 €</b>
<b>Race pack</b> (Platba předem) <b>Sezóna: 2026 Exotic.</b> BVI Spring Regatta, Briefing before the race, preparation and gauging of sails, registration of th eyacht (not of the passengers), technical assistance during the race *** technical assistance during the race not valid for RORC Caribbean 600 // A special race deposit need to be doubled manually once the race fee is added.	Ne	za rezervaci	<b>1.320,00 €</b>

<b>Race pack</b> (Platba předem)	Ne	za rezervaci	<b>1.650,00 €</b>
<b>Sezóna: 2026 Exotic.</b> Antigua, Briefing before the race, preparation and gauging of sails, registration of the yacht (not of the passengers), technical assistance during the race *** technical assistance during the race not valid for RORC Caribbean 600 // A special race deposit need to be doubled manually once the race fee is added.			
<b>Race pack</b> (Platba předem)	Ne	za rezervaci	<b>1.650,00 €</b>
<b>Sezóna: 2026 Exotic.</b> RORC caribbean 600, Briefing before the race, preparation and gauging of sails, registration of the yacht (not of the passengers), technical assistance during the race *** technical assistance during the race not valid for RORC Caribbean 600 // A special race deposit need to be doubled manually once the race fee is added.			
<b>Same day briefing</b> (Platba předem)	Ne	za rezervaci	<b>195,00 €</b>
<b>Sezóna: 2026 Exotic.</b> Same day briefing starting between 5 & 5.30pm (departure following morning)			
<b>Spotřeba elektřiny a vody v přístavech</b> (Platba na základně)	Ne	za rezervaci	<b>28,00 €</b>
<b>Sezóna: 2026 Exotic.</b> Electric & Water consumption based on 2 nights on our dock (base will confirm the amount to pay locally depending on nights spent on dock)			
<b>Starter pack</b> (Platba předem)	Ne	za rezervaci	<b>50,00 €</b>
<b>Sezóna: 2026 Exotic.</b> included in Essentials pack (The pack includes: 1 gallon water (or 4 bottles of 1.5L), 1 bottle of disinfectant, 1 small bottle of washing up liquid, 1 dish cloth, 1 sponge, garbage bags, 1 roll of paper towels, 1 box of matches, 1 roll of toilet paper in each head)			
<b>Transfer</b> (Platba předem)	Ne	one-way	<b>14,55 €</b>
<b>Sezóna: 2026 Exotic.</b> OW - each additional pax from Road Town ferry or Tortola airport			
<b>Transfer</b> (Platba předem)	Ne	okružní plavba	<b>29,09 €</b>
<b>Sezóna: 2026 Exotic.</b> RT - each additional pax from Road Town ferry or Tortola airport			
<b>Transfer</b> (Platba předem)	Ne	one-way	<b>29,09 €</b>
<b>Sezóna: 2026 Exotic.</b> OW - 1-2pax from Road Town ferry or Tortola airport.			
<b>Transfer</b> (Platba předem)	Ne	okružní plavba	<b>58,18 €</b>
<b>Sezóna: 2026 Exotic.</b> RT - 1-2pax from Road Town ferry or Tortola airport.			
<b>Závěrečný úklid</b> (Platba předem)	Ne	za rezervaci	<b>285,00 €</b>
<b>Sezóna: 2026 Exotic.</b> included in Essentials pack			
<b>Závěrečný úklid</b> (Platba předem)	Ne	za rezervaci	<b>285,00 €</b>
<b>Sezóna: 2026 Exotic.</b> included in Essentials pack			

**Sezóna: 2026 Exotic.** Any crew change during the charter is subject to € 250.- additional cost. The charge includes administration cost, change of bed linen and towels and one night at NYC ponton (marina fee included only if the same base than start base). It doesn't include cleaning, nor new transit log where applicable.



**WEBSITE**

[www.plujeme.cz](http://www.plujeme.cz)



**E-MAIL**

[info@plujeme.cz](mailto:info@plujeme.cz)



**TELEFON**

+420 720 755 085



**MOBILE**

+420 777 170 276



**PLUJEME RÁDI S.R.O.**

Dlouhá 730/35, 11000 Praha 1 – Staré Město, Česká republika

## DODATEČNÉ DOPLŇKY

DOPLŇKY	POVINNÉ	TYP PLATBY	CENA
<b>Bezpečnostní síť</b> (Platba předem) <b>Sezóna: 2026 Exotic.</b> net is supplied but not installed - Platba předem	Ne	za rezervaci	<b>250,00 €</b>
<b>Kayak single</b> (Platba předem) <b>Sezóna: 2026 Exotic.</b> price per day - Platba předem	Ne	za noc	<b>15,00 €</b>
<b>Kayak tandem</b> (Platba předem) <b>Sezóna: 2026 Exotic.</b> price per day - Platba předem	Ne	za noc	<b>15,00 €</b>
<b>Outboard engine 8 &amp; 9,8 HP</b> (Platba předem) <b>Sezóna: 2026 Exotic.</b> Dinghy not suitable in any case for waterski or wakeboard. Additional security deposit of 500 € on outboard engines. - Platba předem	Ne	za den	<b>35,00 €</b>
<b>Stand up paddle (SUP)</b> (Platba předem) <b>Sezóna: 2026 Exotic.</b> Price per day - Platba předem	Ne	za noc	<b>15,00 €</b>



**WEBSITE**

[www.plujeme.cz](http://www.plujeme.cz)



**TELEFON**

+420 720 755 085



**MOBILE**

+420 777 170 276



**E-MAIL**

[info@plujeme.cz](mailto:info@plujeme.cz)



**PLUJEME RÁDI S.R.O.**

Dlouhá 730/35, 11000 Praha 1 – Staré Město, Česká republika

## CENA A DOSTUPNOST

20.07. - 27.07.2026 NEDOSTUPNÉ	04.08. - 09.10.2026 NEDOSTUPNÉ	10.10. - 17.10.2026 2.865 € 3.370 €	17.10. - 24.10.2026 3.047 € 3.585 €
24.10. - 31.10.2026 3.387 € 3.985 €	31.10. - 07.11.2026 3.387 € 3.985 €	13.11. - 22.11.2026 NEDOSTUPNÉ	03.12. - 13.12.2026 NEDOSTUPNÉ
22.12. - 29.12.2026 NEDOSTUPNÉ	02.01. - 09.01.2027 6.246 € 6.575 €	09.01. - 16.01.2027 6.246 € 6.575 €	16.01. - 23.01.2027 6.246 € 6.575 €
23.01. - 30.01.2027 6.246 € 6.575 €	30.01. - 06.02.2027 NEDOSTUPNÉ	06.02. - 16.02.2027 NEDOSTUPNÉ	20.02. - 27.02.2027 6.869 € 7.230 €
27.02. - 06.03.2027 6.869 € 7.230 €			



**WEBSITE**  
www.plujeme.cz



**E-MAIL**  
info@plujeme.cz



**TELEFON**  
+420 720 755 085



**PLUJEME RÁDI S.R.O.**  
Dlouhá 730/35, 11000 Praha 1 – Staré Město, Česká republika



**MOBILE**  
+420 777 170 276

## CENA A DOSTUPNOST

06.03. - 13.03.2027 7.325 € 7.710 €	13.03. - 20.03.2027 7.771 € 8.180 €	20.03. - 27.03.2027 7.771 € 8.180 €	27.03. - 03.04.2027 7.771 € 8.180 €
04.04. - 11.04.2027 NEDOSTUPNÉ	17.04. - 01.05.2027 NEDOSTUPNÉ	01.05. - 08.05.2027 5.097 € 5.365 €	08.05. - 15.05.2027 4.589 € 4.830 €
15.05. - 22.05.2027 4.589 € 4.830 €	22.05. - 29.05.2027 4.589 € 4.830 €	29.05. - 05.06.2027 4.408 € 4.640 €	05.06. - 12.06.2027 4.228 € 4.450 €
12.06. - 19.06.2027 4.057 € 4.270 €	19.06. - 26.06.2027 4.057 € 4.270 €	26.06. - 03.07.2027 4.057 € 4.270 €	03.07. - 10.07.2027 4.057 € 4.270 €
10.07. - 17.07.2027 4.057 € 4.270 €	17.07. - 24.07.2027 4.057 € 4.270 €	24.07. - 31.07.2027 4.057 € 4.270 €	31.07. - 07.08.2027 3.738 € 3.935 €
07.08. - 14.08.2027 3.406 € 3.585 €	14.08. - 21.08.2027 3.406 € 3.585 €	21.08. - 28.08.2027 3.406 € 3.585 €	28.08. - 04.09.2027 3.406 € 3.585 €
04.09. - 11.09.2027 3.406 € 3.585 €	11.09. - 18.09.2027 3.406 € 3.585 €	18.09. - 25.09.2027 3.406 € 3.585 €	25.09. - 02.10.2027 3.416 € 3.596 €
02.10. - 09.10.2027 3.477 € 3.660 €	09.10. - 16.10.2027 3.477 € 3.660 €	16.10. - 23.10.2027 3.477 € 3.660 €	23.10. - 30.10.2027 3.477 € 3.660 €
30.10. - 06.11.2027 3.862 € 4.065 €			



WEBSITE  
[www.plujeme.cz](http://www.plujeme.cz)



E-MAIL  
[info@plujeme.cz](mailto:info@plujeme.cz)



TELEFON  
+420 720 755 085



MOBILE  
+420 777 170 276



PLUJEME RÁDI S.R.O.  
Dlouhá 730/35, 11000 Praha 1 – Staré Město, Česká republika

## CENA A DOSTUPNOST

06.11. - 13.11.2027

**4.152 €** 4.370 €

13.11. - 20.11.2027

**4.698 €** 4.945 €

20.11. - 27.11.2027

**5.254 €** 5.530 €

27.11. - 04.12.2027

**4.218 €** 4.440 €

04.12. - 11.12.2027

**3.900 €** 4.105 €

11.12. - 18.12.2027

**3.900 €** 4.105 €

18.12. - 25.12.2027

**4.992 €** 5.255 €



**WEBSITE**

[www.plujeme.cz](http://www.plujeme.cz)



**TELEFON**

+420 720 755 085



**MOBILE**

+420 777 170 276



**E-MAIL**

[info@plujeme.cz](mailto:info@plujeme.cz)



**PLUJEME RÁDI S.R.O.**

Dlouhá 730/35, 11000 Praha 1 – Staré Město, Česká republika