

LAGOON 52 F

ASKELA (2018)

Katamarán Lagoon 52 F ASKELA, rok spuštění na vodu 2018 kotví v marině La Paz, Costa Baja Marina, Baja California Sur, Mexiko. Počet kajut: 6 + 2, může ubytovat celkem: 12 + 2 a má toalet: 6. Povlečení a kuchyňské vybavení jsou zahrnuty v ceně.

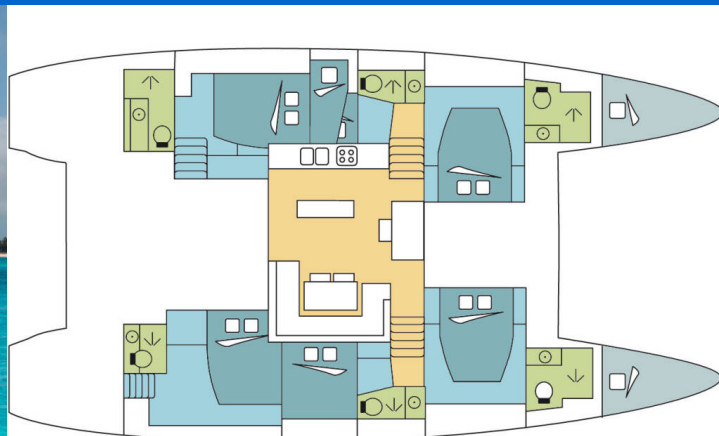

YACHT SPECIFICATIONS

Marína	Jachta ID	Značka
La Paz, Costa Baja Marina, Mexiko	13947	Lagoon
Název jachty	Rok výroby	Délka
ASKELA	2018	52 ft
Kabiny	Lůžka	Maximální počet osob
6 + 2	12 + 2	14
WC	Motor	Palivová nádrž
6	2 x 80 HP	992 l



WEBSITE
www.plujeme.cz



TELEFON
+420 720 755 085



MOBILE
+420 777 170 276



E-MAIL
info@plujeme.cz



PLUJEME RÁDI S.R.O.
Dlouhá 730/35, 11000 Praha 1 - Staré Město, Česká republika

STANDARDNÍ VYBAVENÍ JACHTY

Bezpečnost	VHF rádio
Elektronika	110V zásuvka, Generátor, Invertor, Klimatizace, Watermaker – Odsolovač vody
Interiér	Elektrické WC, Ventilátory v kajutách
Kuchyňka	Coffee pot, Lednička, Mikrovlnná trouba, Mixér, Mrazák, Toaster, Trouba, Trouba
Navigace	Autopilot, GPS mapový plotter, Hloubkoměr, Rychloměr (Speed log), Wind instrument/Anemometer
Paluba	Davit, Elektrický kotevní vrátek, Flybridge, Grill/Barbecue/Plancha, Koupací žebřík, Lednička v kokpitě, Nafukovací člun, Přivěsný motor, Stoleček v kokpitě, Venkovní sprcha na zádi
Plachty	Electric main sail winch, Lazy bag, Lazy jacks, Self tailing vinšna
Pohodlí	Polštáře do kokpitu
Zábava	Fusion radio, MP3 Jack - Ipod, Venkovní reproduktory



WEBSITE

www.plujeme.cz



E-MAIL

info@plujeme.cz



TELEFON

+420 720 755 085



MOBILE

+420 777 170 276



PLUJEME RÁDI S.R.O.

Dlouhá 730/35, 11000 Praha 1 – Staré Město, Česká republika

SLUŽBY

VYBRANÉ SLUŽBY	POVINNÉ	TYP PLATBY	CENA
Essentials pack (Platba předem) Sezóna: 2026 Exotic. INCLUDED: Damage waiver (covering damages) with reduced security deposit addressed specifically to blocked toilets, unpaid fuel, lost equipment, unpaid fees & fines, and returning the boat in an extremely dirty state. // starter pack – (1 gallon water or 4 bottles of 1.5L, 1 bottle of disinfectant, 1 small bottle of washing up liquid, 1 dish cloth, 1 sponge, garbage bags, 1 roll of paper towels, 1 box of matches, 1 roll of toilet paper in each head)// final cleaning // 1 set of bed sheets & towels, dinghy, outboard engine & initial supply of fuel, gas and water tanks // DYC assistance guarantee // 1st & last night in the marina /// NOT INCLUDED: refuelling, gas & water consumption at end of charter, taxes if any, handling fees & additional equipment deposit.	Ano	za rezervaci	1.080,00 €
Manipulační poplatky (Platba předem) Sezóna: 2026 Exotic.	Ano	za rezervaci	35,00 €
Poplatek za hygienu životního prostředí (Platba na základně) Sezóna: 2026 Exotic. Municipal fee since January 1, 2026, created to finance environmental protection actions, waste managements & conservation of the municipality's natural environment. It applies to recreational or sports boat rental services operating within the municipality of La Paz	Ano	za den	3,04 €
Poplatek za přípravu jachty (Platba předem) Sezóna: 2026 Exotic. INCLUDED: starter pack – (1 gallon water or 4 bottles of 1.5L, 1 bottle of disinfectant, 1 small bottle of washing up liquid, 1 dish cloth, 1 sponge, garbage bags, 1 roll of paper towels, 1 box of matches, 1 roll of toilet paper in each head)// final cleaning // 1 set of bed sheets / cabin & 1 set of towels / pax, dinghy, outboard engine & initial supply of fuel, gas and water tanks // DYC assistance guarantee // 1st & last night in the marina // NOT INCLUDED: refuelling, gas & water consumption at end of charter, taxes if any, handling fees & additional equipment deposit.	Ano	za rezervaci	490,00 €
Vstup do národních parků (Platba na základně) Sezóna: 2026 Exotic. Required for access to Balandra Bay and Espiritu Santo Island, as mandated by CONANP. Each guest must wear a wristband daily to comply with regulations.	Ano	per guest/night	8,00 €
Dřívější nalodění (Platba předem) Sezóna: 2026 Exotic. EB (boat only) - 14:00 h / 2 PM starting time of boat's delivery // limited number of early boardings on same departure day	Ne	za rezervaci	540,00 €

Dřívější nalodění (Platba předem)	Ne	za rezervaci	750,00 €
Sezóna: 2026 Exotic. EB boat + extra fee skipper - 14:00 h / 2 PM starting time of boat's delivery // limited number of early boardings on same departure day			
Dřívější nalodění (Platba předem)	Ne	za rezervaci	925,00 €
Sezóna: 2026 Exotic. EB + extra fee Skipper & Hostes - 14:00 h / 2 PM starting time of boat's delivery // limited number of early boardings on same departure day			
Extra sada prádla (vyberte si kolik) (Platba předem)	Ne	za rezervaci	15,00 €
Sezóna: 2026 Exotic. Extra set of linen : 15 € 1 set of linen (2 sheets & 2 pillow case) - to be updated manually			
Extra set of towels (choose how many) (Platba předem)	Ne	za rezervaci	10,00 €
Sezóna: 2026 Exotic. Extra set of towels: 10 € 1 set of towels (1 face & 1 bath towel) - to be updated manually			
extra úklid (Platba předem)	Ne	za rezervaci	375,00 €
Sezóna: 2026 Exotic. Optional Additional cleaning			
Hosteska/kuchař (Platba předem)	Ne	za noc	175,00 €
Sezóna: 2026 Exotic. + provisioning, Crew on board must have their own toilets/showers. If either a skipper or a hostess/cook is on board, 1 double cabin will be required for him/her. If both a skipper and a hostess/cook are on board, 1 double cabin and 1 forepeak cabin will be required for them. Exceptions exists for specific layouts, Sales Agents will provide more details about the different boat models			
Hosteska/kuchař (Platba předem)	Ne	za noc	175,00 €
Sezóna: 2026 Exotic. + provisioning, Crew on board must have their own toilets/showers. If either a skipper or a hostess/cook is on board, 1 double cabin will be required for him/her. If both a skipper and a hostess/cook are on board, 1 double cabin and 1 forepeak cabin will be required for them. Exceptions exists for specific layouts, Sales Agents will provide more details about the different boat models			
Hosteska/kuchař (Platba předem)	Ne	za noc	195,00 €
Sezóna: 2026 Exotic. + provisioning, Crew on board must have their own toilets/showers. If either a skipper or a hostess/cook is on board, 1 double cabin will be required for him/her. If both a skipper and a hostess/cook are on board, 1 double cabin and 1 forepeak cabin will be required for them. Exceptions exists for specific layouts, Sales Agents will provide more details about the different boat models			
Kapitán (Platba předem)	Ne	za noc	210,00 €
Sezóna: 2026 Exotic. + provisioning, Crew on board must have their own toilets/showers. If either a skipper or a hostess/cook is on board, 1 double cabin will be required for him/her. If both a skipper and a hostess/cook are on board, 1 double cabin and 1 forepeak cabin will be required for them. Exceptions exists for specific layouts, Sales Agents will provide more details about the different boat models			

Kapitán (Platba předem)	Ne	za noc	210,00 €
Sezóna: 2026 Exotic. + provisioning, Crew on board must have their own toilets/showers. If either a skipper or a hostess/cook is on board, 1 double cabin will be required for him/her. If both a skipper and a hostess/cook are on board, 1 double cabin and 1 forepeak cabin will be required for them. Exceptions exists for specific layouts, Sales Agents will provide more details about the different boat models			
Kapitán (Platba předem)	Ne	za noc	230,00 €
Sezóna: 2026 Exotic. + provisioning, Crew on board must have their own toilets/showers. If either a skipper or a hostess/cook is on board, 1 double cabin will be required for him/her. If both a skipper and a hostess/cook are on board, 1 double cabin and 1 forepeak cabin will be required for them. Exceptions exists for specific layouts, Sales Agents will provide more details about the different boat models			
Plná penze 1-3 osoby (počet hostů aktualizujte ručně) (Platba předem)	Ne	per guest/day	75,00 €
Sezóna: 2026 Exotic. only available if cook is booked on board as the cook will do the provisioning based on client's preference. Includes breakfast, lunch & dinner + the crew's food. Does not included alcoholic drinks			
Plná penze 4-6 osob (počet hostů aktualizujte ručně) (Platba předem)	Ne	per guest/day	60,00 €
Sezóna: 2026 Exotic. only available if cook is booked on board as the cook will do the provisioning based on client's preference. Includes breakfast, lunch & dinner + the crew's food. Does not included alcoholic drinks			
Plná penze 7-12 osob (počet hostů bude aktualizován ručně) (Platba předem)	Ne	per guest/day	55,00 €
Sezóna: 2026 Exotic. only available if cook is booked on board as the cook will do the provisioning based on client's preference. Includes breakfast, lunch & dinner + the crew's food. Does not included alcoholic drinks			
Pojištění kauce (Platba předem)	Ne	za noc	95,00 €
Sezóna: 2026 Exotic. Damage waiver limits your liability to the reduced Security Deposit . Mandatory when skipper is added. Price is per night of the charter (minimum value of 7 nights & a maximum value of 21 nights) Not applicable for 4+ weeks charters , nor Regattas/Races.			
Příplatek za regatu (Platba předem)	Ne	za rezervaci	0,00 €
Sezóna: 2026 Exotic. all the regattas apart of ASW (different regatta surcharge for ASW) // A special race deposit need to be doubled manually once the regatta surcharge is added.			
Same day briefing (Platba předem)	Ne	za rezervaci	180,00 €
Sezóna: 2026 Exotic. Same day briefing starting between 5 & 5.30pm (departure following morning)			

Spotřeba elektřiny a vody v přístavech (Platba na základně)	Ne	za rezervaci	52,00 €
Sezóna: 2026 Exotic. Electric & Water consumption based on 2 nights on our dock (base will confirm the amount to pay locally depending on nights spent on dock)			
Starter pack (Platba předem)	Ne	za rezervaci	50,00 €
Sezóna: 2026 Exotic. included in Essentials pack (The pack includes: 1 gallon water (or 4 bottles of 1.5L), 1 bottle of disinfectant, 1 small bottle of washing up liquid, 1 dish cloth, 1 sponge, garbage bags, 1 roll of paper towels, 1 box of matches, 1 roll of toilet paper in each head)			
Transfer (Platba předem)	Ne	one-way	40,00 €
Sezóna: 2026 Exotic. OW La Paz airport /base TAXI 1-4 pax			
Transfer (Platba předem)	Ne	okružní plavba	80,00 €
Sezóna: 2026 Exotic. RT- La Paz airport /base TAXI 1-4 pax			
Transfer (Platba předem)	Ne	one-way	118,00 €
Sezóna: 2026 Exotic. OW La Paz airport /base VAN 1-10 pax			
Transfer (Platba předem)	Ne	okružní plavba	236,00 €
Sezóna: 2026 Exotic. RT - La Paz airport /base VAN 1-10 pax			
Transfer (Platba předem)	Ne	okružní plavba	796,00 €
Sezóna: 2026 Exotic. RT Los cabos airport / base VAN 1-10 pax			
Závěrečný úklid (Platba předem)	Ne	za rezervaci	375,00 €
Sezóna: 2026 Exotic. included in Essentials pack			
Závěrečný úklid (Platba předem)	Ne	za rezervaci	375,00 €
Sezóna: 2026 Exotic. included in Essentials pack			
Změna posádky (Platba předem)	Ne	za rezervaci	250,00 €
Sezóna: 2026 Exotic. Any crew change during the charter is subject to € 250.- additional cost. The charge includes administration cost, change of bed linen and towels and one night at DYC ponton (marina fee included only if the same base than start base). It doesn't include cleaning, nor new transit log where applicable.			



WEBSITE
www.plujeme.cz



TELEFON
+420 720 755 085



MOBILE
+420 777 170 276



E-MAIL
info@plujeme.cz



PLUJEME RÁDI S.R.O.
Dlouhá 730/35, 11000 Praha 1 – Staré Město, Česká republika

DODATEČNÉ DOPLŇKY

DOPLŇKY	POVINNÉ	TYP PLATBY	CENA
Bezpečnostní síť (Platba předem) Sezóna: 2026 Exotic. net is supplied but not installed - Platba předem	Ne	za rezervaci	300,00 €
Kayak single (Platba předem) Sezóna: 2026 Exotic. price per day - Platba předem	Ne	za noc	15,00 €
Kayak tandem (Platba předem) Sezóna: 2026 Exotic. price per day - Platba předem	Ne	za noc	15,00 €
Outboard engine 15 HP (Platba předem) Sezóna: 2026 Exotic. Dinghy not suitable in any case for waterski or wakeboard. - Platba předem	Ne	za den	50,00 €
Outboard engine 8 & 9,8 HP (Platba předem) Sezóna: 2026 Exotic. Dinghy not suitable in any case for waterski or wakeboard. Additional security deposit of 500 € on outboard engines. - Platba předem	Ne	za den	35,00 €
Stand up paddle (SUP) (Platba předem) Sezóna: 2026 Exotic. price per day - Platba předem	Ne	za noc	15,00 €



WEBSITE

www.plujeme.cz



E-MAIL

info@plujeme.cz



TELEFON

+420 720 755 085



MOBILE

+420 777 170 276



PLUJEME RÁDI S.R.O.

Dlouhá 730/35, 11000 Praha 1 – Staré Město, Česká republika