

# LAGOON 46

Dafni (2026)

Katamarán Lagoon 46 Dafni, rok spuštění na vodu 2026 kotví v marině Corfu, Benitses Port Yacht Marina, Jónské ostrovy (Řecko), Řecko. Počet kajut: 4 + 2 , může ubytovat celkem: 8 + 2 a má toalet: 4 + 2 . Povlečení a kuchyňské vybavení jsou zahrnuty v ceně.

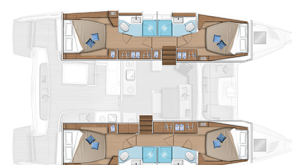

## YACHT SPECIFICATIONS

Marína  
**Corfu, Benitses Port Yacht Marina,  
Řecko**

Jachta ID  
**12587**

Značky  
**Lagoon**

Název jachty  
**Dafni**

Rok výroby  
**2026**

Délka  
**46 ft**

Kabiny  
**4 + 2**

Lůžka  
**8 + 2**

WC  
**4 + 2**

Motor  
**2 x 57 HP**

Palivová nádrž  
**10040 l**



**WEBSITE**  
[www.plujeme.cz](http://www.plujeme.cz)



**TELEFON**  
+420 720 755 085



**MOBILE**  
+420 777 170 276



**E-MAIL**  
[info@plujeme.cz](mailto:info@plujeme.cz)



**PLUJEME RÁDI S.R.O.**  
Dlouhá 730/35, 11000 Praha 1 – Staré Město, Česká republika

## STANDARDNÍ VYBAVENÍ JACHTY

Bezpečnost	<b>EPIRB-Distress radio beacons, Odpadní vodní nádrž, VHF rádio, Záchranná podkova, Záchranné pásy (bezpečnostní harnessy), Záchranné vesty, Záchranný člun</b>
Elektronika	<b>Generátor, Klimatizace, Nabíječka baterií, USB sockets, Watermaker – Odsolovač vody, Zásuvka 220V</b>
Interiér	<b>Elektrické WC, Ventilátory</b>
Kuchyňka	<b>Kávovar NESPRESSO, Lednička, Mrazák, Teplá voda, Trouba, Trouba, Výrobník ledu</b>
Navigace	<b>Autopilot, GPS mapový plotter, Hloubkoměr, Rychloměr (Speed log), Wind instrument/Anemometer</b>
Paluba	<b>Bimini, Dinghy hydraulic lifting system, Elektrický kotevní vrátek, Hydraulická lávka, Lednička v kokpitě, Nafukovací člun, Přívěsný motor, Stoleček v kokpitě, Týkový kokpit, Umyvadlo v kokpitu, Venkovní sprcha na zádi</b>
Plachty	<b>Lazy jacks</b>
Pohodlí	<b>Polštáře do kokpitu</b>
Zábava	<b>mp3 player, Šnorchlovací vybavení, Venkovní reproduktory</b>



**WEBSITE**

[www.plujeme.cz](http://www.plujeme.cz)



**TELEFON**

+420 720 755 085



**MOBILE**

+420 777 170 276



**E-MAIL**

[info@plujeme.cz](mailto:info@plujeme.cz)



**PLUJEME RÁDI S.R.O.**

Dlouhá 730/35, 11000 Praha 1 – Staré Město, Česká republika

## SLUŽBY

VYBRANÉ SLUŽBY	POVINNÉ	TYP PLATBY	CENA
<b>Charter pack</b> (Platba na základně) <b>Sezóna: 2026.</b> Included: End Cleaning, 2 bottles of water, soap and head paper (1 x per head); Bed Linen (per double cabin/week): 2 top sheets, 1 bottom sheet, 2 pillowcases, 2 quilts; Towels (per person/per week): 1 face towel, 1 bath towel; 2 Gas Bottles (one in full); Mooring fees (first and last day at Athenian's Pier); Snorkeling equipment (one set per cabin); Electricity consumption at the base, water refilling, outboard gasoline	Ano	za rezervaci	<b>370,00 €</b>
<b>Kapitán</b> (Platba na základně) <b>Sezóna: 2026.</b> Require their own cabin/head & payable on the spot; Provisions for crew must include an allowance of up to €30/day/crew for meals. If the crew joins guests for meals ashore, the allowance does not apply The Charterer may cancel the crew service up to 31 days before embarkation without incurring any penalty. Athenian Yachts solely provides facilitation services to help the Charterer directly hire local freelance crew, without any additional fees or charges. The Company does not act as a crew agency or employer and assumes no responsibility for the performance of the crew's services. No warranties or representations are made regarding the quality or reliability of the crew's services, and Athenian Yachts shall not be liable for any act, omission, or negligence of the crew members.	Ano	za den + strava	<b>210,00 €</b>
<b>Pojištění kauce</b> (Platba na základně) <b>Sezóna: 2026.</b> + Refundable Security Deposit 1000 €/per charter. DAMAGE WAIVER plus REFUNDABLE SECURITY DEPOSIT (must be paid on the spot) up to 2 weeks' charter. The Damage Waiver reduces your financial liability in the event of damage to the yacht, loss or damage to ancillary equipment, or damage caused by a third party during your charter. Non-refundable: The Damage Waiver is not refundable under any circumstances. The refundable deposit covers any damage or loss over the damage waiver amount, and the customer's total financial liability will not exceed the amount of the damage waiver and the refundable deposit. Coverage: It covers any loss or accident involving the yacht, its equipment, or a third party, including all risks of damage or theft, whether due to negligence or malicious intent by the skipper or clients. Indemnification: It indemnifies all parties involved in all cases. Additional Weeks: For any additional week of the charter, an extra Damage Waiver charge will apply, amounting to half of the standard Damage Waiver cost. The payment of either the Refundable Security Deposit or the Damage Waiver applies solely to one major incident at a time. Suppose there is a loss or damage to high-value equipment (such as an outboard engine or dinghy, sails, mast). In that case, the Charterer has the right to a replacement or repair, on the condition that a new Refundable Security Deposit is paid promptly upon receiving the replacement or completion of the repair.	Ano	za rezervaci	<b>600,00 €</b>

<b>Domáci mazlíček na palubě</b> (Platba na základně)	Ne	za rezervaci	<b>200,00 €</b>
<b>Sezóna: 2026.</b> Pets allowed (up to 7 kg)			
<b>Hosteska</b> (Platba na základně)	Ne	za den + strava	<b>190,00 €</b>
<b>Sezóna: 2026.</b> Require their own cabin/head & payable on the spot; Provisions for crew must include an allowance of up to €30/day/crew for meals. If the crew joins guests for meals ashore, the allowance does not apply The Charterer may cancel the crew service up to 31 days before embarkation without incurring any penalty. Athenian Yachts solely provides facilitation services to help the Charterer directly hire local freelance crew, without any additional fees or charges. The Company does not act as a crew agency or employer and assumes no responsibility for the performance of the crew's services. No warranties or representations are made regarding the quality or reliability of the crew's services, and Athenian Yachts shall not be liable for any act, omission, or negligence of the crew members.			

<b>Kuchař</b> (Platba na základně)	Ne	za den + strava	<b>230,00 €</b>
<b>Sezóna: 2026.</b> Require their own cabin/head & payable on the spot; Provisions for crew must include an allowance of up to €30/day/crew for meals. If the crew joins guests for meals ashore, the allowance does not apply The Charterer may cancel the crew service up to 31 days before embarkation without incurring any penalty. Athenian Yachts solely provides facilitation services to help the Charterer directly hire local freelance crew, without any additional fees or charges. The Company does not act as a crew agency or employer and assumes no responsibility for the performance of the crew's services. No warranties or representations are made regarding the quality or reliability of the crew's services, and Athenian Yachts shall not be liable for any act, omission, or negligence of the crew members.			

<b>Transfer</b> (Platba na základně)	Ne	za rezervaci	<b>0,00 €</b>
<b>Sezóna: 2026.</b> Kindly contact charter company for the transfer cost. Transfer service upon request (can only be arranged the latest 7 days before embarkation)			

<b>Změna posádky</b> (Platba na základně)	Ne	za změnu posádky	<b>120,00 €</b>
<b>Sezóna: 2026.</b> Crew Change (only on our bases) is allowed up to 75% during the charter. If it is over 75%, it is considered a new charter; The skipper remains the same; Includes: water, electricity, and marina fees/services; Charter Pack, for crew changes as per our Price List.			



**WEBSITE**  
www.plujeme.cz



**TELEFON**  
+420 720 755 085



**MOBILE**  
+420 777 170 276



**E-MAIL**  
info@plujeme.cz



**PLUJEME RÁDI S.R.O.**  
Dlouhá 730/35, 11000 Praha 1 – Staré Město, Česká republika

## DODATEČNÉ DOPLŇKY

DOPLŇKY	POVINNÉ	TYP PLATBY	CENA
<b>Bezpečnostní síť</b> (Platba na základně) <b>Sezóna: 2026.</b> Platba na základně	Ne	za rezervaci	<b>200,00 €</b>
<b>Extra povlečení a ručníky</b> (Platba na základně) <b>Sezóna: 2026.</b> 1 set = 2 sheets, 1 pillow case, 1 face towel, 1 bath towel - Platba na základně	Ne	za set	<b>12,00 €</b>
<b>Stand up paddle (SUP)</b> (Platba na základně) <b>Sezóna: 2026.</b> + €300 refundable security deposit (by credit card) - subject to availability - Platba na základně	Ne	za týden	<b>100,00 €</b>



#### WEBSITE

[www.plujeme.cz](http://www.plujeme.cz)



#### E-MAIL

[info@plujeme.cz](mailto:info@plujeme.cz)



#### TELEFON

+420 720 755 085



#### MOBILE

+420 777 170 276



#### PLUJEME RÁDI S.R.O.

Dlouhá 730/35, 11000 Praha 1 – Staré Město, Česká republika

## CENA A DOSTUPNOST

24.05. - 06.06.2026 NEDOSTUPNÉ	06.06. - 13.06.2026 9.000 € 10.000 €	14.06. - 20.06.2026 NEDOSTUPNÉ	20.06. - 27.06.2026 NEDOSTUPNÉ
27.06. - 04.07.2026 10.890 € 12.100 €	04.07. - 11.07.2026 NEDOSTUPNÉ	12.07. - 25.07.2026 NEDOSTUPNÉ	25.07. - 01.08.2026 12.150 € 13.500 €
02.08. - 08.08.2026 NEDOSTUPNÉ	08.08. - 15.08.2026 PŘEDREZEROVÁNO	16.08. - 22.08.2026 NEDOSTUPNÉ	22.08. - 29.08.2026 NEDOSTUPNÉ
29.08. - 05.09.2026 NEDOSTUPNÉ	05.09. - 12.09.2026 NEDOSTUPNÉ	12.09. - 19.09.2026 NEDOSTUPNÉ	22.09. - 13.10.2026 NEDOSTUPNÉ
17.10. - 24.10.2026 5.400 € 6.000 €	24.10. - 31.10.2026 5.400 € 6.000 €	31.10. - 07.11.2026 5.400 € 6.000 €	07.11. - 14.11.2026 5.400 € 6.000 €
14.11. - 21.11.2026 5.400 € 6.000 €	21.11. - 28.11.2026 5.400 € 6.000 €	28.11. - 05.12.2026 5.400 € 6.000 €	



WEBSITE

[www.plujeme.cz](http://www.plujeme.cz)



E-MAIL

[info@plujeme.cz](mailto:info@plujeme.cz)



TELEFON

+420 720 755 085



MOBILE

+420 777 170 276



PLUJEME RÁDI S.R.O.

Dlouhá 730/35, 11000 Praha 1 – Staré Město, Česká republika

## CENA A DOSTUPNOST

05.12. - 12.12.2026

6.000 €

12.12. - 19.12.2026

6.000 €

19.12. - 26.12.2026

6.000 €



### WEBSITE

[www.plujeme.cz](http://www.plujeme.cz)



### E-MAIL

[info@plujeme.cz](mailto:info@plujeme.cz)



### TELEFON

+420 720 755 085



### MOBILE

+420 777 170 276



### PLUJEME RÁDI S.R.O.

Dlouhá 730/35, 11000 Praha 1 – Staré Město, Česká republika