

BALI 4.6

GYPSOPHILA (2024)

Katamarán Bali 4.6 GYPSOPHILA, rok spuštění na vodu 2024 kotví v marině Polynesia, Raiatea, Francouzská Polynésie , Francouzská Polynésie. Počet kajut: 5 + 2 , může ubytovat celkem: 10 + 2 a má toalet: 4 . Povlečení a kuchyňské vybavení jsou zahrnuty v ceně.

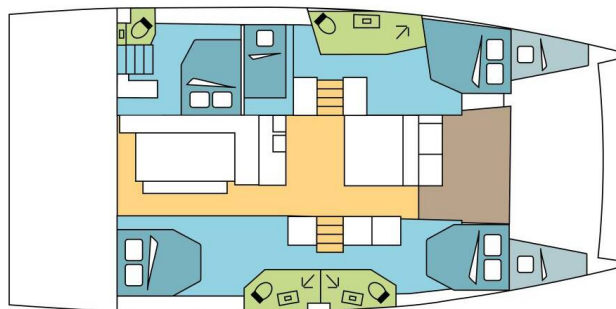

YACHT SPECIFICATIONS

Marína Polynesia, Raiatea, Francouzská Polynésie	Jachta ID 12255	Značky Catana
Název jachty GYPSOPHILA	Rok výroby 2024	Délka 47 ft
Kabiny 5 + 2	Lůžka 10 + 2	Maximální počet osob 12
WC 4	Motor 2 x 57 HP	Palivová nádrž 800 l



WEBSITE
www.plujeme.cz



TELEFON
+420 720 755 085



MOBILE
+420 777 170 276



E-MAIL
info@plujeme.cz



PLUJEME RÁDI S.R.O.
Dlouhá 730/35, 11000 Praha 1 – Staré Město, Česká republika

STANDARDNÍ VYBAVENÍ JACHTY

Bezpečnost	VHF rádio
Elektronika	Alternator, Generátor, Invertor, Klimatizace, Nabíječka baterií, Servisní baterie, Solární panely, Watermaker – Odsolovač vody
Interiér	Elektrické WC, Ventilátory v kajutách
Kuchyňka	Lednička, Trouba
Navigace	AIS, Autopilot, GPS mapový plotter, Hloubkoměr, Rychloměr (Speed log), Wind instrument/Anemometer
Paluba	Elektrický kotevní vrátek, Fly sunbathing area, Flybridge, Grill/Barbecue/Plancha, Koupací žebřík, Nafukovací člun, Spring cleats, Stoleček v kokpitu, Venkovní sprcha na zádi
Plachty	Electric main sail winch, Lazy bag, Lazy jacks
Pohodlí	Lehátka na opalování, Polštáře do kokpitu, Síťka proti komárům
Zábava	Fusion radio



WEBSITE

www.plujeme.cz



E-MAIL

info@plujeme.cz



TELEFON

+420 720 755 085



MOBILE

+420 777 170 276



PLUJEME RÁDI S.R.O.

Dlouhá 730/35, 11000 Praha 1 – Staré Město, Česká republika

SLUŽBY

VYBRANÉ SLUŽBY	POVINNÉ	TYP PLATBY	CENA
Essentials pack (Platba předem) Sezóna: 2026 Exotic. INCLUDED: Damage waiver (covering damages) with reduced security deposit addressed specifically to blocked toilets, unpaid fuel, lost equipment, unpaid fees & fines, and returning the boat in an extremely dirty state. // starter pack – (1 gallon water or 4 bottles of 1.5L, 1 bottle of disinfectant, 1 small bottle of washing up liquid, 1 dish cloth, 1 sponge, garbage bags, 1 roll of paper towels, 1 box of matches, 1 roll of toilet paper in each head)// final cleaning // 1 set of bed sheets & towels, dinghy, outboard engine & initial supply of fuel, gas and water tanks // DYC assistance guarantee // 1st & last night in the marina /// NOT INCLUDED: refuelling, gas & water consumption at end of charter, taxes if any, handling fees & additional equipment deposit.	Ano	za rezervaci	815,00 €
Manipulační poplatky (Platba předem) Sezóna: 2026 Exotic.	Ano	za rezervaci	35,00 €
Poplatek za přípravu jachty (Platba předem) Sezóna: 2026 Exotic. INCLUDED: starter pack – (1 gallon water or 4 bottles of 1.5L, 1 bottle of disinfectant, 1 small bottle of washing up liquid, 1 dish cloth, 1 sponge, garbage bags, 1 roll of paper towels, 1 box of matches, 1 roll of toilet paper in each head)// final cleaning // 1 set of bed sheets / cabin & 1 set of towels / pax, dinghy, outboard engine & initial supply of fuel, gas and water tanks // DYC assistance guarantee // 1st & last night in the marina // NOT INCLUDED: refuelling, gas & water consumption at end of charter, taxes if any, handling fees & additional equipment deposit.	Ano	za rezervaci	450,00 €
Dodatečný příplatek (Platba předem) Sezóna: 2026 Exotic. Lost lure	Ne	za kus	50,00 €
Extra sada prádla (vyberte si kolik) (Platba předem) Sezóna: 2026 Exotic. Extra set of linen : 15 € 1 set of linen (2 sheets & 2 pillow case) – to be updated manually	Ne	za rezervaci	15,00 €
Extra set of towels (choose how many) (Platba předem) Sezóna: 2026 Exotic. Extra set of towels: 10 € 1 set of towels (1 face & 1 bath towel) – to be updated manually	Ne	za rezervaci	10,00 €
extra úklid (Platba předem) Sezóna: 2026 Exotic. Optional Additional cleaning	Ne	za rezervaci	340,00 €

<p>Full board 1-4 (number of guests to update manually) (Platba předem)</p> <p>Sezóna: 2026 Exotic. only available if cook is booked on board as the cook will do the provisioning based on client's preference. Includes breakfast, lunch & dinner + the crew's food. Does not included alcoholic drinks</p>	Ne	per guest/day	65,00 €
<p>Full board 5-12 pax (number of guests to update manually) (Platba předem)</p> <p>Sezóna: 2026 Exotic. only available if cook is booked on board as the cook will do the provisioning based on client's preference. Includes breakfast, lunch & dinner + the crew's food. Does not included alcoholic drinks</p>	Ne	per guest/day	60,00 €
<p>Half board 1-4 (number of guests to update manually) (Platba předem)</p> <p>Sezóna: 2026 Exotic. only available if cook is booked on board as the cook will do the provisioning based on client's preference. Includes breakfast & lunch OR dinner + the crew's food. Does not included alcoholic drinks</p>	Ne	per guest/day	55,00 €
<p>Half board 5-12 pax (number of guests to update manually) (Platba předem)</p> <p>Sezóna: 2026 Exotic. only available if cook is booked on board as the cook will do the provisioning based on client's preference. Includes breakfast & lunch OR dinner + the crew's food. Does not included alcoholic drinks</p>	Ne	per guest/day	50,00 €
<p>Hosteska/kuchař (Platba předem)</p> <p>Sezóna: 2026 Exotic. + provisioning, Crew on board must have their own toilets/showers. If either a skipper or a hostess/cook is on board, 1 double cabin will be required for him/her. If both a skipper and a hostess/cook are on board, 1 double cabin and 1 forepeak cabin will be required for them. Exceptions exists for specific layouts, Sales Agents will provide more details about the different boat models</p>	Ne	za noc	215,00 €
<p>Hosteska/kuchař (Platba předem)</p> <p>Sezóna: 2026 Exotic. + provisioning, Crew on board must have their own toilets/showers. If either a skipper or a hostess/cook is on board, 1 double cabin will be required for him/her. If both a skipper and a hostess/cook are on board, 1 double cabin and 1 forepeak cabin will be required for them. Exceptions exists for specific layouts, Sales Agents will provide more details about the different boat models</p>	Ne	za noc	215,00 €
<p>Hosteska/kuchař (Platba předem)</p> <p>Sezóna: 2026 Exotic. + provisioning, Crew on board must have their own toilets/showers. If either a skipper or a hostess/cook is on board, 1 double cabin will be required for him/her. If both a skipper and a hostess/cook are on board, 1 double cabin and 1 forepeak cabin will be required for them. Exceptions exists for specific layouts, Sales Agents will provide more details about the different boat models</p>	Ne	za noc	235,00 €

Kapitán (Platba předem)	Ne	za noc	250,00 €
Sezóna: 2026 Exotic. + provisioning, Crew on board must have their own toilets/showers. If either a skipper or a hostess/cook is on board, 1 double cabin will be required for him/her. If both a skipper and a hostess/cook are on board, 1 double cabin and 1 forepeak cabin will be required for them. Exceptions exists for specific layouts, Sales Agents will provide more details about the different boat models			
Kapitán (Platba předem)	Ne	za noc	250,00 €
Sezóna: 2026 Exotic. + provisioning, Crew on board must have their own toilets/showers. If either a skipper or a hostess/cook is on board, 1 double cabin will be required for him/her. If both a skipper and a hostess/cook are on board, 1 double cabin and 1 forepeak cabin will be required for them. Exceptions exists for specific layouts, Sales Agents will provide more details about the different boat models			
Kapitán (Platba předem)	Ne	za noc	275,00 €
Sezóna: 2026 Exotic. + provisioning, Crew on board must have their own toilets/showers. If either a skipper or a hostess/cook is on board, 1 double cabin will be required for him/her. If both a skipper and a hostess/cook are on board, 1 double cabin and 1 forepeak cabin will be required for them. Exceptions exists for specific layouts, Sales Agents will provide more details about the different boat models			
Pojištění kauce (Platba předem)	Ne	za noc	85,00 €
Sezóna: 2026 Exotic. Damage waiver limits your liability to the reduced Security Deposit . Mandatory when skipper is added. Price is per night of the charter (minimum value of 7 nights & a maximum value of 21 nights) Not applicable for 4+ weeks charters , nor Regattas/Races.			
Příplatek za regatu (Platba předem)	Ne	za rezervaci	0,00 €
Sezóna: 2026 Exotic. all the regattas apart of ASW (different regatta surcharge for ASW) // A special race deposit need to be doubled manually once the regatta surcharge is added.			
Race pack (Platba předem)	Ne	za rezervaci	350,00 €
Sezóna: 2026 Exotic. Tahiti Pearl Regatta / The Regatta Package includes - Briefing before the race, preparation and gauging of sails, registration of the yacht. // A special race deposit need to be doubled manually once the race fee is added.			
Spotřeba elektřiny a vody v přístavech (Platba na základně)	Ne	za rezervaci	36,00 €
Sezóna: 2026 Exotic. Electric & Water consumption based on 2 nights on our dock (base will confirm the amount to pay locally depending on nights spent on dock)			
Starter pack (Platba předem)	Ne	za rezervaci	50,00 €
Sezóna: 2026 Exotic. included in Essentials pack (The pack includes: 1 gallon water (or 4 bottles of 1.5L), 1 bottle of disinfectant, 1 small bottle of washing up liquid, 1 dish cloth, 1 sponge, garbage bags, 1 roll of paper towels, 1 box of matches, 1 roll of toilet paper in each head			

Transfer (Platba předem)	Ne	one-way	12,00 €
Sezóna: 2026 Exotic. OW - Airport/Base - per pax			
Transfer (Platba předem)	Ne	okružní plavba	20,00 €
Sezóna: 2026 Exotic. RT - Airport/Base / per pax			
Závěrečný úklid (Platba předem)	Ne	za rezervaci	340,00 €
Sezóna: 2026 Exotic. included in Essentials pack			
Závěrečný úklid (Platba předem)	Ne	za rezervaci	340,00 €
Sezóna: 2026 Exotic. included in Essentials pack			
Změna posádky (Platba předem)	Ne	za rezervaci	250,00 €
Sezóna: 2026 Exotic. Any crew change during the charter is subject to € 250.- additional cost. The charge includes administration cost, change of bed linen and towels and one night at DYC ponton (marina fee included only if the same base than start base). It doesn't include cleaning, nor new transit log where applicable.			



WEBSITE

www.plujeme.cz



E-MAIL

info@plujeme.cz



TELEFON

+420 720 755 085



MOBILE

+420 777 170 276



PLUJEME RÁDI S.R.O.

Dlouhá 730/35, 11000 Praha 1 – Staré Město, Česká republika

DODATEČNÉ DOPLŇKY

DOPLŇKY	POVINNÉ	TYP PLATBY	CENA
Bezpečnostní síť (Platba předem) Sezóna: 2026 Exotic. net is supplied but not installed - Platba předem	Ne	za rezervaci	300,00 €
Kayak single (Platba předem) Sezóna: 2026 Exotic. price per day - Platba předem	Ne	za noc	15,00 €
Kayak tandem (Platba předem) Sezóna: 2026 Exotic. price per day - Platba předem	Ne	za noc	15,00 €
Outboard engine 8 & 9,8 HP (Platba předem) Sezóna: 2026 Exotic. Dinghy not suitable in any case for waterski or wakeboard. Additional security deposit of 500 € - Platba předem	Ne	za den	35,00 €
Rybářské vybavení (Platba předem) Sezóna: 2026 Exotic. Additional deposit 100 EUR (subject to availability) - Platba předem	Ne	za den	15,00 €
Stand up paddle (SUP) (Platba předem) Sezóna: 2026 Exotic. Price per day - Platba předem	Ne	za noc	15,00 €



WEBSITE
www.plujeme.cz



TELEFON
+420 720 755 085



MOBILE
+420 777 170 276



E-MAIL
info@plujeme.cz



PLUJEME RÁDI S.R.O.
Dlouhá 730/35, 11000 Praha 1 – Staré Město, Česká republika

CENA A DOSTUPNOST

29.04. - 05.05.2026 NEDOSTUPNÉ	06.05. - 12.05.2026 NEDOSTUPNÉ	16.05. - 23.05.2026 15.160 €	23.05. - 30.05.2026 NEDOSTUPNÉ
30.05. - 09.06.2026 NEDOSTUPNÉ	13.06. - 20.06.2026 NEDOSTUPNÉ	20.06. - 27.06.2026 NEDOSTUPNÉ	28.06. - 08.07.2026 NEDOSTUPNÉ
10.07. - 17.07.2026 NEDOSTUPNÉ	17.07. - 23.07.2026 NEDOSTUPNÉ	29.07. - 05.08.2026 NEDOSTUPNÉ	07.08. - 15.08.2026 NEDOSTUPNÉ
15.08. - 21.08.2026 NEDOSTUPNÉ	21.08. - 31.08.2026 NEDOSTUPNÉ	01.09. - 17.09.2026 NEDOSTUPNÉ	19.09. - 26.09.2026 14.205 €
26.09. - 03.10.2026 15.911 €	03.10. - 10.10.2026 PŘEDREZERVOVÁNO	10.10. - 17.10.2026 NEDOSTUPNÉ	17.10. - 28.10.2026 NEDOSTUPNÉ
31.10. - 07.11.2026 10.502 € 11.055 €	07.11. - 14.11.2026 10.004 € 10.530 €	14.11. - 21.11.2026 9.096 € 9.575 €	21.11. - 28.11.2026 8.184 € 8.615 €
30.11. - 09.12.2026 NEDOSTUPNÉ			



WEBSITE
www.plujeme.cz



E-MAIL
info@plujeme.cz



TELEFON
+420 720 755 085



PLUJEME RÁDI S.R.O.
Dlouhá 730/35, 11000 Praha 1 – Staré Město, Česká republika



MOBILE
+420 777 170 276

CENA A DOSTUPNOST

12.12. - 19.12.2026 6.622 € 6.970 €	19.12. - 26.12.2026 6.294 € 6.625 €	26.12. - 04.01.2027 NEDOSTUPNÉ	09.01. - 16.01.2027 7.135 € 7.510 €
16.01. - 23.01.2027 7.135 € 7.510 €	23.01. - 30.01.2027 7.135 € 7.510 €	30.01. - 06.02.2027 7.135 € 7.510 €	06.02. - 13.02.2027 7.135 € 7.510 €
13.02. - 20.02.2027 7.462 € 7.855 €	20.02. - 27.02.2027 7.985 € 8.405 €	27.02. - 06.03.2027 8.541 € 8.990 €	06.03. - 13.03.2027 7.990 € 8.410 €
13.03. - 20.03.2027 9.334 € 9.825 €	20.03. - 27.03.2027 10.165 € 10.700 €	27.03. - 03.04.2027 10.878 € 11.450 €	03.04. - 10.04.2027 11.638 € 12.250 €
10.04. - 17.04.2027 13.029 € 13.715 €	17.04. - 24.04.2027 13.029 € 13.715 €	24.04. - 01.05.2027 12.032 € 12.665 €	01.05. - 15.05.2027 NEDOSTUPNÉ
15.05. - 29.05.2027 NEDOSTUPNÉ	29.05. - 05.06.2027 12.032 € 12.665 €	05.06. - 12.06.2027 12.032 € 12.665 €	12.06. - 19.06.2027 12.032 € 12.665 €
19.06. - 26.06.2027 12.032 € 12.665 €	26.06. - 03.07.2027 12.032 € 12.665 €	03.07. - 10.07.2027 14.355 € 15.110 €	10.07. - 17.07.2027 15.115 € 15.910 €
17.07. - 24.07.2027 15.955 € 16.795 €	24.07. - 31.07.2027 16.791 € 17.675 €	31.07. - 07.08.2027 17.917 € 18.860 €	



WEBSITE

www.plujeme.cz



E-MAIL

info@plujeme.cz



TELEFON

+420 720 755 085



MOBILE

+420 777 170 276



PLUJEME RÁDI S.R.O.

Dlouhá 730/35, 11000 Praha 1 – Staré Město, Česká republika

CENA A DOSTUPNOST

07.08. - 17.08.2027 NEDOSTUPNÉ	21.08. - 28.08.2027 14.055 € 14.795 €	28.08. - 04.09.2027 14.055 € 14.795 €	04.09. - 11.09.2027 14.055 € 14.795 €
11.09. - 18.09.2027 14.055 € 14.795 €	18.09. - 25.09.2027 14.055 € 14.795 €	25.09. - 02.10.2027 14.906 € 15.691 €	02.10. - 09.10.2027 14.464 € 15.225 €
09.10. - 16.10.2027 12.782 € 13.455 €	16.10. - 23.10.2027 12.782 € 13.455 €	23.10. - 30.10.2027 11.595 € 12.205 €	30.10. - 06.11.2027 10.004 € 10.530 €
06.11. - 13.11.2027 10.004 € 10.530 €	13.11. - 20.11.2027 9.096 € 9.575 €	20.11. - 27.11.2027 8.184 € 8.615 €	27.11. - 04.12.2027 6.987 € 7.355 €
04.12. - 11.12.2027 6.622 € 6.970 €	11.12. - 18.12.2027 6.622 € 6.970 €	18.12. - 25.12.2027 6.294 € 6.625 €	



WEBSITE

www.plujeme.cz



E-MAIL

info@plujeme.cz



TELEFON

+420 720 755 085



MOBILE

+420 777 170 276



PLUJEME RÁDI S.R.O.

Dlouhá 730/35, 11000 Praha 1 – Staré Město, Česká republika