

# BALI 4.6

CROCUS (2024)

Katamarán Bali 4.6 CROCUS, rok spuštění na vodu 2024 kotví v marině St. Martin, Marina de L'Anse Marcel, Svatý Martin (Karibské Nizozemsko), Karibské Nizozemsko. Počet kajut: 5 + 2, může ubytovat celkem: 10 + 2 a má toalet: 4. Povlečení a kuchyňské vybavení jsou zahrnuty v ceně.

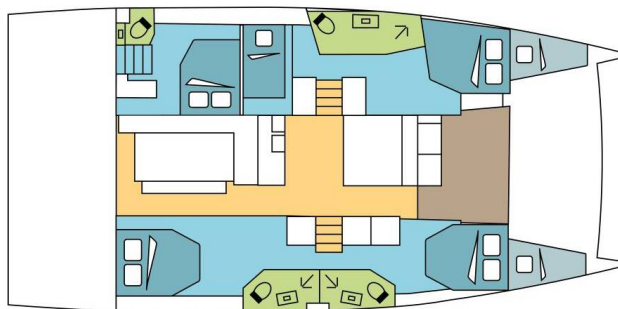

## YACHT SPECIFICATIONS

|   |                           |                                   |
|---|---------------------------|-----------------------------------|
| Marína<br><b>St. Martin, Marina de L'Anse Marcel,<br/>Karibské Nizozemsko</b> | Jachta ID<br><b>12246</b> | Značka<br><b>Catana</b>           |
| Název jachty<br><b>CROCUS</b>   | Rok výroby<br><b>2024</b> | Délka<br><b>47 ft</b>             |
| Kabiny<br><b>5 + 2</b>  | Lůžka<br><b>10 + 2</b>    | Maximální počet osob<br><b>12</b> |
| WC<br><b>4</b>  | Motor<br><b>2 x 57 HP</b> | Palivová nádrž<br><b>800 l</b>    |



**WEBSITE**  
[www.plujeme.cz](http://www.plujeme.cz)



**TELEFON**  
+420 720 755 085



**MOBILE**  
+420 777 170 276



**E-MAIL**  
[info@plujeme.cz](mailto:info@plujeme.cz)



**PLUJEME RÁDI S.R.O.**  
Dlouhá 730/35, 11000 Praha 1 – Staré Město, Česká republika

## STANDARDNÍ VYBAVENÍ JACHTY

|             |  |
|-------------|--|
| Bezpečnost  | VHF rádio  |
| Elektronika | El. přípojka 220 V, Generátor, Invertor, Klimatizace, Nabíječka baterií, Servisní baterie, Solární panely, Watermaker – Odsolovač vody                 |
| Interiér    | Čalounění, Elektrické WC, Ventilátory v kajutách   |
| Kuchyňka    | Lednička, Přídavná lednice, Trouba   |
| Navigace    | AIS, Autopilot, GPS mapový plotter   |
| Paluba      | Bimini, Elektrický kotevní vrátek, Fly sunbathing area, Flybridge, Grill/Barbecue/Plancha, Koupací žebřík, Stoleček v kokpitu, Venkovní sprcha na zádi |
| Plachty     | Electric main sail winch, Lazy bag, Lazy jacks   |
| Pohodlí     | Polštáře do kokpitu, Sedáky Helmstation, Sítko proti komárům   |
| Zábava      | Fusion radio   |



#### WEBSITE

[www.plujeme.cz](http://www.plujeme.cz)



#### E-MAIL

[info@plujeme.cz](mailto:info@plujeme.cz)



#### TELEFON

+420 720 755 085



#### MOBILE

+420 777 170 276



#### PLUJEME RÁDI S.R.O.

Dlouhá 730/35, 11000 Praha 1 – Staré Město, Česká republika

## SLUŽBY

| VYBRANÉ SLUŽBY   | POVINNÉ | TYP PLATBY   | CENA            |
|--|---------|--------------|-----------------|
| <b>Essentials pack</b> (Platba předem)<br><b>Sezóna: 2026 Exotic.</b> INCLUDED: Damage waiver (covering damages) with reduced security deposit addressed specifically to blocked toilets, unpaid fuel, lost equipment, unpaid fees & fines, and returning the boat in an extremely dirty state. // starter pack – (1 gallon water or 4 bottles of 1.5L, 1 bottle of disinfectant, 1 small bottle of washing up liquid, 1 dish cloth, 1 sponge, garbage bags, 1 roll of paper towels, 1 box of matches, 1 roll of toilet paper in each head)// final cleaning // 1 set of bed sheets & towels, dinghy, outboard engine & initial supply of fuel, gas and water tanks // DYC assistance guarantee // 1st & last night in the marina /// NOT INCLUDED: refuelling, gas & water consumption at end of charter, taxes if any, handling fees & additional equipment deposit. | Ano     | za rezervaci | <b>815,00 €</b> |
| <b>Manipulační poplatky</b> (Platba předem)<br><b>Sezóna: 2026 Exotic.</b>   | Ano     | za rezervaci | <b>35,00 €</b>  |
| <b>Nature reserve tax</b> (Platba na základně)<br><b>Sezóna: 2026 Exotic.</b> payable at base  | Ano     | za osobu     | <b>5,00 €</b>   |
| <b>Poplatek za přípravu jachty</b> (Platba předem)<br><b>Sezóna: 2026 Exotic.</b> INCLUDED: starter pack – (1 gallon water or 4 bottles of 1.5L, 1 bottle of disinfectant, 1 small bottle of washing up liquid, 1 dish cloth, 1 sponge, garbage bags, 1 roll of paper towels, 1 box of matches, 1 roll of toilet paper in each head)// final cleaning // 1 set of bed sheets / cabin & 1 set of towels / pax, dinghy, outboard engine & initial supply of fuel, gas and water tanks // DYC assistance guarantee // 1st & last night in the marina // NOT INCLUDED: refuelling, gas & water consumption at end of charter, taxes if any, handling fees & additional equipment deposit.  | Ano     | za rezervaci | <b>430,00 €</b> |
| <b>Dřívější nalodění</b> (Platba předem)<br><b>Sezóna: 2026 Exotic.</b> EB (boat only) - 14:00 h / 2 PM starting time of boat's delivery // limited number of early boardings on same departure day  | Ne      | za rezervaci | <b>480,00 €</b> |
| <b>Dřívější nalodění</b> (Platba předem)<br><b>Sezóna: 2026 Exotic.</b> EB boat + extra fee skipper - 14:00 h / 2 PM starting time of boat's delivery // limited number of early boardings on same departure day   | Ne      | za rezervaci | <b>700,00 €</b> |
| <b>Dřívější nalodění</b> (Platba předem)<br><b>Sezóna: 2026 Exotic.</b> EB + extra fee Skipper & Hostes - 14:00 h / 2 PM starting time of boat's delivery // limited number of early boardings on same departure day   | Ne      | za rezervaci | <b>885,00 €</b> |

|  |    |               |                 |
|--|----|---------------|-----------------|
| <b>Extra sada prádla (vyberte si kolik) (Platba předem)</b>  | Ne | za rezervaci  | <b>15,00 €</b>  |
| <b>Sezóna: 2026 Exotic.</b> Extra set of linen : 15 € 1 set of linen (2 sheets & 2 pillow case) -<br>to be updated manually  |    |               |                 |
| <b>Extra set of towels (choose how many) (Platba předem)</b>   | Ne | za rezervaci  | <b>10,00 €</b>  |
| <b>Sezóna: 2026 Exotic.</b> Extra set of towels: 10 € 1 set of towels (1 face & 1 bath towel) -<br>to be updated manually  |    |               |                 |
| <b>extra úklid (Platba předem)</b>   | Ne | za rezervaci  | <b>340,00 €</b> |
| <b>Sezóna: 2026 Exotic.</b> Optional Additional cleaning   |    |               |                 |
| <b>Full board 1-4 (number of guests to update manually) (Platba předem)</b>  | Ne | per guest/day | <b>65,00 €</b>  |
| <b>Sezóna: 2026 Exotic.</b> only available if cook is booked on board as the cook will do<br>the provisioning based on client's preference. Includes breakfast, lunch & dinner +<br>the crew's food. Does not included alcoholic drinks  |    |               |                 |
| <b>Full board 5-12 pax (number of guests to update manually) (Platba předem)</b>   | Ne | per guest/day | <b>60,00 €</b>  |
| <b>Sezóna: 2026 Exotic.</b> only available if cook is booked on board as the cook will do<br>the provisioning based on client's preference. Includes breakfast, lunch & dinner +<br>the crew's food. Does not included alcoholic drinks  |    |               |                 |
| <b>Half board 1-4 (number of guests to update manually) (Platba předem)</b>  | Ne | per guest/day | <b>55,00 €</b>  |
| <b>Sezóna: 2026 Exotic.</b> only available if cook is booked on board as the cook will do<br>the provisioning based on client's preference. Includes breakfast & lunch OR dinner +<br>the crew's food. Does not included alcoholic drinks  |    |               |                 |
| <b>Half board 5-12 pax (number of guests to update manually) (Platba předem)</b>   | Ne | per guest/day | <b>50,00 €</b>  |
| <b>Sezóna: 2026 Exotic.</b> only available if cook is booked on board as the cook will do<br>the provisioning based on client's preference. Includes breakfast & lunch OR dinner +<br>the crew's food. Does not included alcoholic drinks  |    |               |                 |
| <b>Hosteska/kuchař (Platba předem)</b>   | Ne | za noc        | <b>230,00 €</b> |
| <b>Sezóna: 2026 Exotic.</b> + provisioning, Crew on board must have their own toilets/<br>showers. If either a skipper or a hostess/cook is on board, 1 double cabin will be<br>required for him/her. If both a skipper and a hostess/cook are on board, 1 double<br>cabin and 1 forepeak cabin will be required for them. Exceptions exists for specific<br>layouts, Sales Agents will provide more details about the different boat models |    |               |                 |
| <b>Hosteska/kuchař (Platba předem)</b>   | Ne | za noc        | <b>230,00 €</b> |
| <b>Sezóna: 2026 Exotic.</b> + provisioning, Crew on board must have their own toilets/<br>showers. If either a skipper or a hostess/cook is on board, 1 double cabin will be<br>required for him/her. If both a skipper and a hostess/cook are on board, 1 double<br>cabin and 1 forepeak cabin will be required for them. Exceptions exists for specific<br>layouts, Sales Agents will provide more details about the different boat models |    |               |                 |

|   |    |              |                   |
|---|----|--------------|-------------------|
| <b>Hosteska/kuchař</b> (Platba předem)  | Ne | za noc       | <b>255,00 €</b>   |
| <b>Sezóna: 2026 Exotic.</b> + provisioning, Crew on board must have their own toilets/showers. If either a skipper or a hostess/cook is on board, 1 double cabin will be required for him/her. If both a skipper and a hostess/cook are on board, 1 double cabin and 1 forepeak cabin will be required for them. Exceptions exists for specific layouts, Sales Agents will provide more details about the different boat models |    |              |                   |
| <b>Kapitán</b> (Platba předem)  | Ne | za noc       | <b>300,00 €</b>   |
| <b>Sezóna: 2026 Exotic.</b> + provisioning, Crew on board must have their own toilets/showers. If either a skipper or a hostess/cook is on board, 1 double cabin will be required for him/her. If both a skipper and a hostess/cook are on board, 1 double cabin and 1 forepeak cabin will be required for them. Exceptions exists for specific layouts, Sales Agents will provide more details about the different boat models |    |              |                   |
| <b>Kapitán</b> (Platba předem)  | Ne | za noc       | <b>300,00 €</b>   |
| <b>Sezóna: 2026 Exotic.</b> + provisioning, Crew on board must have their own toilets/showers. If either a skipper or a hostess/cook is on board, 1 double cabin will be required for him/her. If both a skipper and a hostess/cook are on board, 1 double cabin and 1 forepeak cabin will be required for them. Exceptions exists for specific layouts, Sales Agents will provide more details about the different boat models |    |              |                   |
| <b>Kapitán</b> (Platba předem)  | Ne | za noc       | <b>330,00 €</b>   |
| <b>Sezóna: 2026 Exotic.</b> + provisioning, Crew on board must have their own toilets/showers. If either a skipper or a hostess/cook is on board, 1 double cabin will be required for him/her. If both a skipper and a hostess/cook are on board, 1 double cabin and 1 forepeak cabin will be required for them. Exceptions exists for specific layouts, Sales Agents will provide more details about the different boat models |    |              |                   |
| <b>Pojištění kauce</b> (Platba předem)  | Ne | za noc       | <b>70,00 €</b>    |
| <b>Sezóna: 2026 Exotic.</b> Damage waiver limits your liability to the reduced Security Deposit . Mandatory when skipper is added. Price is per night of the charter ( minimum value of 7 nights & a maximum value of 21 nights) Not applicable for 4+ weeks charters , nor Regattas/Races.   |    |              |                   |
| <b>Příplatek za regatu</b> (Platba předem)  | Ne | za rezervaci | <b>1.950,00 €</b> |
| <b>Sezóna: 2026 Exotic.</b> valid for ASW regatta only // A special race deposit need to be doubled manually once the regatta surcharge is added.   |    |              |                   |
| <b>Příplatek za regatu</b> (Platba předem)  | Ne | za rezervaci | <b>0,00 €</b>     |
| <b>Sezóna: 2026 Exotic.</b> all the regattas apart of ASW (different regatta surcharge for ASW)// A special race deposit need to be doubled manually once the regatta surcharge is added.   |    |              |                   |

|   |    |                |                      |
|---|----|----------------|----------------------|
| <b>Race pack</b> (Platba předem)  | Ne | za rezervaci   | <b>1.320,00</b><br>€ |
| <b>Sezóna: 2026 Exotic.</b> BVI Spring Regatta, Briefing before the race, preparation and gauging of sails, registration of the yacht (not of the passengers), technical assistance during the race *** technical assistance during the race not valid for RORC Caribbean 600 // A special race deposit need to be doubled manually once the race fee is added. |    |                |                      |
| <b>Race pack</b> (Platba předem)  | Ne | za rezervaci   | <b>1.650,00</b><br>€ |
| <b>Sezóna: 2026 Exotic.</b> Antigua, Briefing before the race, preparation and gauging of sails, registration of the yacht (not of the passengers), technical assistance during the race *** technical assistance during the race not valid for RORC Caribbean 600 // A special race deposit need to be doubled manually once the race fee is added.            |    |                |                      |
| <b>Race pack</b> (Platba předem)  | Ne | za rezervaci   | <b>1.650,00</b><br>€ |
| <b>Sezóna: 2026 Exotic.</b> RORC caribbean 600, Briefing before the race, preparation and gauging of sails, registration of the yacht (not of the passengers), technical assistance during the race *** technical assistance during the race not valid for RORC Caribbean 600 // A special race deposit need to be doubled manually once the race fee is added. |    |                |                      |
| <b>Same day briefing</b> (Platba předem)  | Ne | za rezervaci   | <b>150,00</b> €      |
| <b>Sezóna: 2026 Exotic.</b> Same day briefing starting between 5 & 5.30pm (departure following morning)   |    |                |                      |
| <b>Spotřeba elektřiny a vody v přístavech</b> (Platba na základně)  | Ne | za rezervaci   | <b>36,00</b> €       |
| <b>Sezóna: 2026 Exotic.</b> Electric & Water consumption based on 2 nights on our dock (base will confirm the amount to pay locally depending on nights spent on dock)  |    |                |                      |
| <b>Starter pack</b> (Platba předem)   | Ne | za rezervaci   | <b>50,00</b> €       |
| <b>Sezóna: 2026 Exotic.</b> included in Essentials pack (The pack includes: 1 gallon water (or 4 bottles of 1.5L), 1 bottle of disinfectant, 1 small bottle of washing up liquid, 1 dish cloth, 1 sponge, garbage bags, 1 roll of paper towels, 1 box of matches, 1 roll of toilet paper in each head)  |    |                |                      |
| <b>Transfer</b> (Platba předem)   | Ne | okružní plavba | <b>26,00</b> €       |
| <b>Sezóna: 2026 Exotic.</b> RT - Grand Case airport/base - additional pax   |    |                |                      |
| <b>Transfer</b> (Platba předem)   | Ne | okružní plavba | <b>65,00</b> €       |
| <b>Sezóna: 2026 Exotic.</b> RT - Juliana airport/base additional pax  |    |                |                      |
| <b>Transfer</b> (Platba předem)   | Ne | okružní plavba | <b>78,00</b> €       |
| <b>Sezóna: 2026 Exotic.</b> RT -Grand Case airport - St Martin base 1-3 pax   |    |                |                      |
| <b>Transfer</b> (Platba předem)   | Ne | okružní plavba | <b>195,00</b> €      |
| <b>Sezóna: 2026 Exotic.</b> RT - Juliana airport - St Martin base 1-3 pax   |    |                |                      |

**Závěrečný úklid** (Platba předem)

Ne

za rezervaci

**340,00 €**

**Sezóna: 2026 Exotic.** included in Essentials pack

---

**Závěrečný úklid** (Platba předem)

Ne

za rezervaci

**340,00 €**

**Sezóna: 2026 Exotic.** included in Essentials pack

---

**Změna posádky** (Platba předem)

Ne

za rezervaci

**250,00 €**

**Sezóna: 2026 Exotic.** Any crew change during the charter is subject to € 250.- additional cost. The charge includes administration cost, change of bed linen and towels and one night at DYC ponton (marina fee included only if the same base than start base). It doesn't include cleaning, nor new transit log where applicable.



**WEBSITE**

[www.plujeme.cz](http://www.plujeme.cz)



**TELEFON**

+420 720 755 085



**MOBILE**

+420 777 170 276



**E-MAIL**

[info@plujeme.cz](mailto:info@plujeme.cz)



**PLUJEME RÁDI S.R.O.**

Dlouhá 730/35, 11000 Praha 1 – Staré Město, Česká republika

## DODATEČNÉ DOPLŇKY

| DOPLŇKY  | POVINNÉ | TYP PLATBY   | CENA            |
|--|---------|--------------|-----------------|
| <b>Bezpečnostní síť</b> (Platba předem)<br><b>Sezóna: 2026 Exotic.</b> net is supplied but not installed - Platba předem   | Ne      | za rezervaci | <b>300,00 €</b> |
| <b>Kayak single</b> (Platba předem)<br><b>Sezóna: 2026 Exotic.</b> price per day - Platba předem   | Ne      | za noc       | <b>15,00 €</b>  |
| <b>Kayak tandem</b> (Platba předem)<br><b>Sezóna: 2026 Exotic.</b> price per day - Platba předem   | Ne      | za noc       | <b>15,00 €</b>  |
| <b>Outboard engine 8 &amp; 9,8 HP</b> (Platba předem)<br><b>Sezóna: 2026 Exotic.</b> Dinghy not suitable in any case for waterski or wakeboard.<br>Additional security deposit of 500 € on outboard engines. A powerboat licence is mandatory in French territories to drive a dinghy with an outboard more powerful than 6hp. It's client responsibility to ensure to have the right powerboat licence when renting a more powerful outboard. In case the needed licence is not presented at base, it will not be possible to use this larger outboard which will not be refunded - Platba předem | Ne      | za den       | <b>35,00 €</b>  |
| <b>Rybářské vybavení</b> (Platba předem)<br><b>Sezóna: 2026 Exotic.</b> Additional deposit 100 EUR (subject to availability) - Platba předem   | Ne      | za den       | <b>15,00 €</b>  |
| <b>Stand up paddle (SUP)</b> (Platba předem)<br><b>Sezóna: 2026 Exotic.</b> Price per day - Platba předem  | Ne      | za noc       | <b>15,00 €</b>  |



WEBSITE

[www.plujeme.cz](http://www.plujeme.cz)



E-MAIL

[info@plujeme.cz](mailto:info@plujeme.cz)



TELEFON

+420 720 755 085



PLUJEME RÁDI S.R.O.

Dlouhá 730/35, 11000 Praha 1 – Staré Město, Česká republika



MOBILE

+420 777 170 276

## CENA A DOSTUPNOST

|  |                                   |                                   |  |
|--|-----------------------------------|-----------------------------------|--|
| 25.04. - 02.05.2026<br>7.920 €         | 03.05. - 11.05.2026<br>NEDOSTUPNÉ | 18.05. - 01.06.2026<br>NEDOSTUPNÉ | 06.06. - 13.06.2026<br>7.150 €         |
| 13.06. - 20.06.2026<br>6.955 €         | 20.06. - 27.06.2026<br>7.610 €    | 27.06. - 04.07.2026<br>7.600 €    | 04.07. - 11.07.2026<br>NEDOSTUPNÉ      |
| 11.07. - 18.07.2026<br>6.155 €         | 18.07. - 25.07.2026<br>5.540 €    | 31.07. - 08.08.2026<br>NEDOSTUPNÉ | 08.08. - 15.08.2026<br>5.590 €         |
| 15.08. - 22.08.2026<br>5.590 €         | 22.08. - 29.08.2026<br>5.590 €    | 31.08. - 17.09.2026<br>NEDOSTUPNÉ | 19.09. - 26.09.2026<br>5.590 €         |
| 26.09. - 03.10.2026<br>5.690 €         | 03.10. - 10.10.2026<br>5.940 €    | 10.10. - 17.10.2026<br>5.940 €    | 17.10. - 24.10.2026<br>5.940 €         |
| 24.10. - 31.10.2026<br>6.631 € 6.980 € | 01.11. - 09.11.2026<br>NEDOSTUPNÉ | 14.11. - 28.11.2026<br>NEDOSTUPNÉ | 28.11. - 05.12.2026<br>8.251 € 8.685 € |



WEBSITE

[www.plujeme.cz](http://www.plujeme.cz)



E-MAIL

[info@plujeme.cz](mailto:info@plujeme.cz)



TELEFON

+420 720 755 085



MOBILE

+420 777 170 276



PLUJEME RÁDI S.R.O.

Dlouhá 730/35, 11000 Praha 1 – Staré Město, Česká republika

## CENA A DOSTUPNOST

|  |  |  |  |
|--|--|--|--|
| 05.12. - 12.12.2026<br>7.614 € 8.015 €   | 13.12. - 20.12.2026<br>NEDOSTUPNÉ        | 20.12. - 30.12.2026<br>PŘEDREZERVOVÁNO   | 02.01. - 09.01.2027<br>10.559 € 11.115 € |
| 09.01. - 16.01.2027<br>10.559 € 11.115 € | 16.01. - 23.01.2027<br>10.559 € 11.115 € | 23.01. - 30.01.2027<br>11.011 € 11.590 € | 30.01. - 06.02.2027<br>11.467 € 12.070 € |
| 06.02. - 13.02.2027<br>11.623 € 12.235 € | 13.02. - 20.02.2027<br>12.203 € 12.845 € | 20.02. - 27.02.2027<br>12.203 € 12.845 € | 27.02. - 06.03.2027<br>12.203 € 12.845 € |
| 06.03. - 13.03.2027<br>12.203 € 12.845 € | 13.03. - 20.03.2027<br>10.987 € 11.565 € | 20.03. - 27.03.2027<br>10.987 € 11.565 € | 27.03. - 03.04.2027<br>10.987 € 11.565 € |
| 03.04. - 10.04.2027<br>10.987 € 11.565 € | 10.04. - 17.04.2027<br>12.203 € 12.845 € | 17.04. - 24.04.2027<br>12.203 € 12.845 € | 24.04. - 01.05.2027<br>9.980 € 10.505 €  |
| 01.05. - 08.05.2027<br>8.412 € 8.855 €   | 08.05. - 15.05.2027<br>8.412 € 8.855 €   | 15.05. - 22.05.2027<br>8.412 € 8.855 €   | 22.05. - 29.05.2027<br>8.412 € 8.855 €   |
| 29.05. - 05.06.2027<br>8.412 € 8.855 €   | 05.06. - 12.06.2027<br>8.412 € 8.855 €   | 12.06. - 19.06.2027<br>8.412 € 8.855 €   | 19.06. - 26.06.2027<br>8.412 € 8.855 €   |
| 26.06. - 03.07.2027<br>8.412 € 8.855 €   | 03.07. - 10.07.2027<br>9.904 € 10.425 €  | 10.07. - 17.07.2027<br>9.904 € 10.425 €  | 17.07. - 24.07.2027<br>9.904 € 10.425 €  |
| 24.07. - 31.07.2027<br>9.904 € 10.425 €  | 31.07. - 07.08.2027<br>8.422 € 8.865 €   |  |  |



WEBSITE  
[www.plujeme.cz](http://www.plujeme.cz)



E-MAIL  
[info@plujeme.cz](mailto:info@plujeme.cz)



TELEFON  
+420 720 755 085



MOBILE  
+420 777 170 276



PLUJEME RÁDI S.R.O.  
Dlouhá 730/35, 11000 Praha 1 – Staré Město, Česká republika

## CENA A DOSTUPNOST

|   |   |   |   |
|---|---|---|---|
| 07.08. - 14.08.2027<br><b>6.270 €</b> 6.600 € | 14.08. - 21.08.2027<br><b>6.270 €</b> 6.600 € | 21.08. - 28.08.2027<br><b>5.643 €</b> 5.940 € | 28.08. - 04.09.2027<br><b>5.643 €</b> 5.940 €   |
| 04.09. - 11.09.2027<br><b>5.643 €</b> 5.940 € | 11.09. - 18.09.2027<br><b>5.643 €</b> 5.940 € | 18.09. - 25.09.2027<br><b>5.643 €</b> 5.940 € | 25.09. - 02.10.2027<br><b>5.643 €</b> 5.940 €   |
| 02.10. - 09.10.2027<br><b>5.643 €</b> 5.940 € | 09.10. - 16.10.2027<br><b>5.643 €</b> 5.940 € | 16.10. - 23.10.2027<br><b>5.643 €</b> 5.940 € | 23.10. - 30.10.2027<br><b>6.631 €</b> 6.980 €   |
| 30.10. - 06.11.2027<br><b>7.301 €</b> 7.685 € | 06.11. - 13.11.2027<br><b>8.227 €</b> 8.660 € | 13.11. - 20.11.2027<br><b>8.227 €</b> 8.660 € | 20.11. - 27.11.2027<br><b>8.227 €</b> 8.660 €   |
| 27.11. - 04.12.2027<br><b>8.251 €</b> 8.685 € | 04.12. - 11.12.2027<br><b>7.614 €</b> 8.015 € | 11.12. - 18.12.2027<br><b>7.614 €</b> 8.015 € | 18.12. - 25.12.2027<br><b>12.545 €</b> 13.205 € |



WEBSITE

[www.plujeme.cz](http://www.plujeme.cz)



E-MAIL

[info@plujeme.cz](mailto:info@plujeme.cz)



TELEFON

+420 720 755 085



MOBILE

+420 777 170 276



PLUJEME RÁDI S.R.O.

Dlouhá 730/35, 11000 Praha 1 – Staré Město, Česká republika