

BALI 4.6

THONIC DREAM (2022)

Katamarán Bali 4.6 THONIC DREAM, rok spuštění na vodu 2022 kotví v marině La Paz, Costa Baja Marina, Baja California Sur, Mexiko. Počet kajut: 5 + 2 , může ubytovat celkem: 10 + 2 a má toalet: 4 . Povlečení a kuchyňské vybavení jsou zahrnuty v ceně.

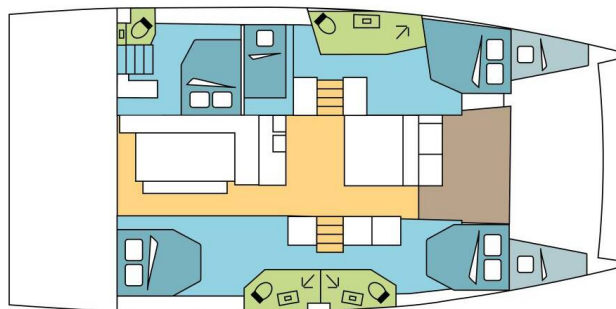

YACHT SPECIFICATIONS

Marína	Jachta ID	Značky
La Paz, Costa Baja Marina, Mexiko	12188	Catana
Název jachty	Rok výroby	Délka
THONIC DREAM	2022	47 ft
Kabiny	Lůžka	Maximální počet osob
5 + 2	10 + 2	12
WC	Motor	Palivová nádrž
4	2 x 57 HP	800 l



WEBSITE
www.plujeme.cz



E-MAIL
info@plujeme.cz



TELEFON
+420 720 755 085



MOBILE
+420 777 170 276



PLUJEME RÁDI S.R.O.
Dlouhá 730/35, 11000 Praha 1 – Staré Město, Česká republika

STANDARDNÍ VYBAVENÍ JACHTY

Bezpečnost	VHF rádio
Elektronika	Invertor, Solární panely, Watermaker – Odsolovač vody
Interiér	Elektrické WC, Ventilátory
Kuchyňka	Lednička, Teplá voda, Trouba, Trouba
Navigace	Autopilot, GPS mapový plotter, Log, Speed, Depth- echo sounder, Wind instrument/Anemometer
Paluba	Bimini, Elektrický kotevní vrátek, Flybridge, Koupací žebřík, Přivěsný motor, Stoleček v kokpitu, Sun awning (aft and forward), Venkovní sprcha na zádi
Plachty	Elektrické navijáky/vinšny, Lazy bag, Lazy jacks
Pohodlí	Polštáře do kokpitu, Síťka proti komárům
Zábava	Fusion radio, Venkovní reproduktory, Vnitřní reproduktory



WEBSITE

www.plujeme.cz



E-MAIL

info@plujeme.cz



TELEFON

+420 720 755 085



MOBILE

+420 777 170 276



PLUJEME RÁDI S.R.O.

Dlouhá 730/35, 11000 Praha 1 – Staré Město, Česká republika

SLUŽBY

VYBRANÉ SLUŽBY	POVINNÉ	TYP PLATBY	CENA
Essentials pack (Platba předem) Sezóna: 2026 Exotic. INCLUDED: Damage waiver (covering damages) with reduced security deposit addressed specifically to blocked toilets, unpaid fuel, lost equipment, unpaid fees & fines, and returning the boat in an extremely dirty state. // starter pack – (1 gallon water or 4 bottles of 1.5L, 1 bottle of disinfectant, 1 small bottle of washing up liquid, 1 dish cloth, 1 sponge, garbage bags, 1 roll of paper towels, 1 box of matches, 1 roll of toilet paper in each head)// final cleaning // 1 set of bed sheets & towels, dinghy, outboard engine & initial supply of fuel, gas and water tanks // DYC assistance guarantee // 1st & last night in the marina /// NOT INCLUDED: refuelling, gas & water consumption at end of charter, taxes if any, handling fees & additional equipment deposit.	Ano	za rezervaci	945,00 €
Manipulační poplatky (Platba předem) Sezóna: 2026 Exotic.	Ano	za rezervaci	35,00 €
Poplatek za hygienu životního prostředí (Platba na základně) Sezóna: 2026 Exotic. Municipal fee since January 1, 2026, created to finance environmental protection actions, waste managements & conservation of the municipality's natural environment. It applies to recreational or sports boat rental services operating within the municipality of La Paz	Ano	za den	3,04 €
Poplatek za přípravu jachty (Platba předem) Sezóna: 2026 Exotic. INCLUDED: starter pack – (1 gallon water or 4 bottles of 1.5L, 1 bottle of disinfectant, 1 small bottle of washing up liquid, 1 dish cloth, 1 sponge, garbage bags, 1 roll of paper towels, 1 box of matches, 1 roll of toilet paper in each head)// final cleaning // 1 set of bed sheets / cabin & 1 set of towels / pax, dinghy, outboard engine & initial supply of fuel, gas and water tanks // DYC assistance guarantee // 1st & last night in the marina // NOT INCLUDED: refuelling, gas & water consumption at end of charter, taxes if any, handling fees & additional equipment deposit.	Ano	za rezervaci	450,00 €
Vstup do národních parků (Platba na základně) Sezóna: 2026 Exotic. Required for access to Balandra Bay and Espiritu Santo Island, as mandated by CONANP. Each guest must wear a wristband daily to comply with regulations.	Ano	per guest/night	8,00 €
Dřívější nalodění (Platba předem) Sezóna: 2026 Exotic. EB (boat only)- 14:00 h / 2 PM starting time of boat's delivery // limited number of early boardings on same departure day	Ne	za rezervaci	480,00 €

Dřívější nalodění (Platba předem)	Ne	za rezervaci	650,00 €
Sezóna: 2026 Exotic. EB boat + extra fee skipper - 14:00 h / 2 PM starting time of boat's delivery // limited number of early boardings on same departure day			
Dřívější nalodění (Platba předem)	Ne	za rezervaci	785,00 €
Sezóna: 2026 Exotic. EB + extra fee Skipper & Hostes - 14:00 h / 2 PM starting time of boat's delivery // limited number of early boardings on same departure day			
Extra sada prádla (vyberte si kolik) (Platba předem)	Ne	za rezervaci	15,00 €
Sezóna: 2026 Exotic. Extra set of linen : 15 € 1 set of linen (2 sheets & 2 pillow case) - to be updated manually			
Extra set of towels (choose how many) (Platba předem)	Ne	za rezervaci	10,00 €
Sezóna: 2026 Exotic. Extra set of towels: 10 € 1 set of towels (1 face & 1 bath towel) - to be updated manually			
extra úklid (Platba předem)	Ne	za rezervaci	340,00 €
Sezóna: 2026 Exotic. Optional Additional cleaning			
Full board 1-4 (number of guests to update manually) (Platba předem)	Ne	per guest/day	60,00 €
Sezóna: 2026 Exotic. only available if cook is booked on board as the cook will do the provisioning based on client's preference. Includes breakfast, lunch & dinner + the crew's food. Does not included alcoholic drinks			
Full board 5-12 pax (number of guests to update manually) (Platba předem)	Ne	per guest/day	55,00 €
Sezóna: 2026 Exotic. only available if cook is booked on board as the cook will do the provisioning based on client's preference. Includes breakfast, lunch & dinner + the crew's food. Does not included alcoholic drinks			
Hosteska/kuchař (Platba předem)	Ne	za noc	135,00 €
Sezóna: 2026 Exotic. + provisioning, Crew on board must have their own toilets/showers. If either a skipper or a hostess/cook is on board, 1 double cabin will be required for him/her. If both a skipper and a hostess/cook are on board, 1 double cabin and 1 forepeak cabin will be required for them. Exceptions exists for specific layouts, Sales Agents will provide more details about the different boat models			
Hosteska/kuchař (Platba předem)	Ne	za noc	135,00 €
Sezóna: 2026 Exotic. + provisioning, Crew on board must have their own toilets/showers. If either a skipper or a hostess/cook is on board, 1 double cabin will be required for him/her. If both a skipper and a hostess/cook are on board, 1 double cabin and 1 forepeak cabin will be required for them. Exceptions exists for specific layouts, Sales Agents will provide more details about the different boat models			

Hosteska/kuchař (Platba předem)	Ne	za noc	150,00 €
Sezóna: 2026 Exotic. + provisioning, Crew on board must have their own toilets/showers. If either a skipper or a hostess/cook is on board, 1 double cabin will be required for him/her. If both a skipper and a hostess/cook are on board, 1 double cabin and 1 forepeak cabin will be required for them. Exceptions exists for specific layouts, Sales Agents will provide more details about the different boat models			
Kapitán (Platba předem)	Ne	za noc	170,00 €
Sezóna: 2026 Exotic. + provisioning, Crew on board must have their own toilets/showers. If either a skipper or a hostess/cook is on board, 1 double cabin will be required for him/her. If both a skipper and a hostess/cook are on board, 1 double cabin and 1 forepeak cabin will be required for them. Exceptions exists for specific layouts, Sales Agents will provide more details about the different boat models			
Kapitán (Platba předem)	Ne	za noc	170,00 €
Sezóna: 2026 Exotic. + provisioning, Crew on board must have their own toilets/showers. If either a skipper or a hostess/cook is on board, 1 double cabin will be required for him/her. If both a skipper and a hostess/cook are on board, 1 double cabin and 1 forepeak cabin will be required for them. Exceptions exists for specific layouts, Sales Agents will provide more details about the different boat models			
Kapitán (Platba předem)	Ne	za noc	185,00 €
Sezóna: 2026 Exotic. + provisioning, Crew on board must have their own toilets/showers. If either a skipper or a hostess/cook is on board, 1 double cabin will be required for him/her. If both a skipper and a hostess/cook are on board, 1 double cabin and 1 forepeak cabin will be required for them. Exceptions exists for specific layouts, Sales Agents will provide more details about the different boat models			
Pojištění kauce (Platba předem)	Ne	za noc	85,00 €
Sezóna: 2026 Exotic. Damage waiver limits your liability to the reduced Security Deposit . Mandatory when skipper is added. Price is per night of the charter (minimum value of 7 nights & a maximum value of 21 nights) Not applicable for 4+ weeks charters , nor Regattas/Races.			
Příplatek za regatu (Platba předem)	Ne	za rezervaci	0,00 €
Sezóna: 2026 Exotic. all the regattas apart of ASW (different regatta surcharge for ASW) // A special race deposit need to be doubled manually once the regatta surcharge is added.			
Same day briefing (Platba předem)	Ne	za rezervaci	150,00 €
Sezóna: 2026 Exotic. Same day briefing starting between 5 & 5.30pm (departure following morning)			
Spotřeba elektřiny a vody v přístavech (Platba na základně)	Ne	za rezervaci	36,00 €
Sezóna: 2026 Exotic. Electric & Water consumption based on 2 nights on our dock (base will confirm the amount to pay locally depending on nights spent on dock)			

Starter pack (Platba předem)	Ne	za rezervaci	50,00 €
Sezóna: 2026 Exotic. included in Essentials pack (The pack includes: 1 gallon water (or 4 bottles of 1.5L), 1 bottle of disinfectant, 1 small bottle of washing up liquid, 1 dish cloth, 1 sponge, garbage bags, 1 roll of paper towels, 1 box of matches, 1 roll of toilet paper in each head)			
Transfer (Platba předem)	Ne	one-way	40,00 €
Sezóna: 2026 Exotic. OW La Paz airport /base TAXI 1-4 pax			
Transfer (Platba předem)	Ne	okružní plavba	80,00 €
Sezóna: 2026 Exotic. RT- La Paz airport /base TAXI 1-4 pax			
Transfer (Platba předem)	Ne	one-way	118,00 €
Sezóna: 2026 Exotic. OW La Paz airport /base VAN 1-10 pax			
Transfer (Platba předem)	Ne	okružní plavba	236,00 €
Sezóna: 2026 Exotic. RT - La Paz airport /base VAN 1-10 pax			
Transfer (Platba předem)	Ne	okružní plavba	796,00 €
Sezóna: 2026 Exotic. RT Los cabos airport / base VAN 1-10 pax			
Závěrečný úklid (Platba předem)	Ne	za rezervaci	340,00 €
Sezóna: 2026 Exotic. included in Essentials pack			
Závěrečný úklid (Platba předem)	Ne	za rezervaci	340,00 €
Sezóna: 2026 Exotic. included in Essentials pack			
Změna posádky (Platba předem)	Ne	za rezervaci	250,00 €
Sezóna: 2026 Exotic. Any crew change during the charter is subject to € 250.- additional cost. The charge includes administration cost, change of bed linen and towels and one night at DYC ponton (marina fee included only if the same base than start base). It doesn't include cleaning, nor new transit log where applicable.			



WEBSITE

www.plujeme.cz



TELEFON

+420 720 755 085



MOBILE

+420 777 170 276



E-MAIL

info@plujeme.cz



PLUJEME RÁDI S.R.O.

Dlouhá 730/35, 11000 Praha 1 – Staré Město, Česká republika

DODATEČNÉ DOPLŇKY

DOPLŇKY	POVINNÉ	TYP PLATBY	CENA
Bezpečnostní síť (Platba předem) Sezóna: 2026 Exotic. net is supplied but not installed - Platba předem	Ne	za rezervaci	300,00 €
Kayak single (Platba předem) Sezóna: 2026 Exotic. price per day - Platba předem	Ne	za noc	15,00 €
Kayak tandem (Platba předem) Sezóna: 2026 Exotic. price per day - Platba předem	Ne	za noc	15,00 €
Outboard engine 8 & 9,8 HP (Platba předem) Sezóna: 2026 Exotic. Dinghy not suitable in any case for waterski or wakeboard. Additional security deposit of 500 € on outboard engines. - Platba předem	Ne	za den	35,00 €
Stand up paddle (SUP) (Platba předem) Sezóna: 2026 Exotic. price per day - Platba předem	Ne	za noc	15,00 €



WEBSITE

www.plujeme.cz



E-MAIL

info@plujeme.cz



TELEFON

+420 720 755 085



MOBILE

+420 777 170 276



PLUJEME RÁDI S.R.O.

Dlouhá 730/35, 11000 Praha 1 – Staré Město, Česká republika

CENA A DOSTUPNOST

08.05. - 18.05.2026 NEDOSTUPNÉ	20.05. - 26.05.2026 NEDOSTUPNÉ	30.05. - 06.06.2026 4.920 €	06.06. - 13.06.2026 3.305 €
13.06. - 20.06.2026 2.815 €	20.06. - 27.06.2026 4.075 €	27.06. - 04.07.2026 4.075 €	04.07. - 11.07.2026 4.055 €
11.07. - 18.07.2026 4.055 €	22.07. - 05.08.2026 NEDOSTUPNÉ	05.08. - 19.09.2026 NEDOSTUPNÉ	19.09. - 26.09.2026 7.050 €
26.09. - 03.10.2026 7.050 €	03.10. - 10.10.2026 6.698 € 7.050 €	10.10. - 17.10.2026 7.348 € 7.735 €	17.10. - 24.10.2026 7.852 € 8.265 €
24.10. - 31.10.2026 7.852 € 8.265 €	31.10. - 07.11.2026 9.714 € 10.225 €	07.11. - 14.11.2026 9.747 € 10.260 €	14.11. - 21.11.2026 10.260 € 10.800 €
21.11. - 28.11.2026 10.711 € 11.275 €	28.11. - 05.12.2026 9.543 € 10.045 €	05.12. - 12.12.2026 10.023 € 10.550 €	12.12. - 19.12.2026 8.199 € 8.630 €
19.12. - 26.12.2026 11.310 € 11.905 €			



WEBSITE
www.plujeme.cz



E-MAIL
info@plujeme.cz



TELEFON
+420 720 755 085



PLUJEME RÁDI S.R.O.
Dlouhá 730/35, 11000 Praha 1 – Staré Město, Česká republika



MOBILE
+420 777 170 276

CENA A DOSTUPNOST

02.01. - 09.01.2027 6.498 € 6.840 €	09.01. - 16.01.2027 6.498 € 6.840 €	16.01. - 23.01.2027 6.498 € 6.840 €	23.01. - 30.01.2027 6.498 € 6.840 €
30.01. - 06.02.2027 6.066 € 6.385 €	06.02. - 13.02.2027 6.992 € 7.360 €	13.02. - 20.02.2027 8.322 € 8.760 €	20.02. - 27.02.2027 7.923 € 8.340 €
27.02. - 06.03.2027 8.484 € 8.930 €	06.03. - 13.03.2027 9.291 € 9.780 €	13.03. - 20.03.2027 10.574 € 11.130 €	20.03. - 27.03.2027 10.070 € 10.600 €
27.03. - 03.04.2027 10.070 € 10.600 €	03.04. - 10.04.2027 10.070 € 10.600 €	10.04. - 17.04.2027 10.317 € 10.860 €	17.04. - 24.04.2027 9.633 € 10.140 €
24.04. - 01.05.2027 9.191 € 9.675 €	01.05. - 08.05.2027 9.196 € 9.680 €	08.05. - 15.05.2027 8.911 € 9.380 €	15.05. - 22.05.2027 8.911 € 9.380 €
22.05. - 29.05.2027 8.911 € 9.380 €	29.05. - 05.06.2027 7.714 € 8.120 €	05.06. - 12.06.2027 7.329 € 7.715 €	12.06. - 19.06.2027 6.764 € 7.120 €
19.06. - 26.06.2027 6.669 € 7.020 €	26.06. - 03.07.2027 6.698 € 7.050 €	03.07. - 10.07.2027 6.698 € 7.050 €	10.07. - 17.07.2027 6.698 € 7.050 €
17.07. - 24.07.2027 6.698 € 7.050 €	24.07. - 31.07.2027 6.698 € 7.050 €	31.07. - 07.08.2027 6.698 € 7.050 €	07.08. - 14.08.2027 6.698 € 7.050 €
14.08. - 21.08.2027 6.698 € 7.050 €	21.08. - 28.08.2027 6.698 € 7.050 €	28.08. - 04.09.2027 6.698 € 7.050 €	



WEBSITE

www.plujeme.cz



E-MAIL

info@plujeme.cz



TELEFON

+420 720 755 085



MOBILE

+420 777 170 276



PLUJEME RÁDI S.R.O.

Dlouhá 730/35, 11000 Praha 1 – Staré Město, Česká republika

CENA A DOSTUPNOST

04.09. - 11.09.2027 6.698 € 7.050 €	11.09. - 18.09.2027 6.698 € 7.050 €	18.09. - 25.09.2027 6.698 € 7.050 €	25.09. - 02.10.2027 6.698 € 7.050 €
02.10. - 09.10.2027 6.698 € 7.050 €	09.10. - 16.10.2027 7.348 € 7.735 €	16.10. - 23.10.2027 7.852 € 8.265 €	23.10. - 30.10.2027 7.852 € 8.265 €
30.10. - 06.11.2027 9.714 € 10.225 €	06.11. - 13.11.2027 10.260 € 10.800 €	13.11. - 20.11.2027 10.260 € 10.800 €	20.11. - 27.11.2027 10.711 € 11.275 €
27.11. - 04.12.2027 9.543 € 10.045 €	04.12. - 11.12.2027 9.543 € 10.045 €	11.12. - 18.12.2027 8.199 € 8.630 €	18.12. - 25.12.2027 11.310 € 11.905 €



WEBSITE

www.plujeme.cz



E-MAIL

info@plujeme.cz



TELEFON

+420 720 755 085



MOBILE

+420 777 170 276



PLUJEME RÁDI S.R.O.

Dlouhá 730/35, 11000 Praha 1 – Staré Město, Česká republika