

# BALI 4.1

NIELTHI (2020)

Katamarán Bali 4.1 NIELTHI, rok spuštění na vodu 2020 kotví v marině La Paz, Costa Baja Marina, Baja California Sur, Mexiko . Počet kajut: 4 + 2 , může ubytovat celkem: 8 + 2 + 2 a má toalet: 4 . Povlečení a kuchyňské vybavení jsou zahrnuty v ceně.

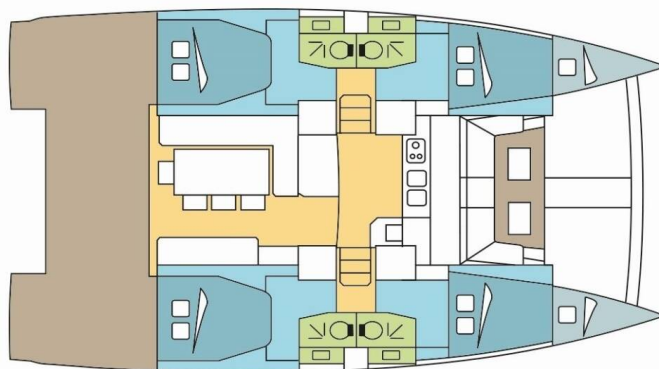

## YACHT SPECIFICATIONS

Marína	Jachta ID	Značka
<b>La Paz, Costa Baja Marina, Mexiko</b>	<b>12133</b>	<b>Catana</b>
Název jachty	Rok výroby	Délka
<b>NIELTHI</b>	<b>2020</b>	<b>41 ft</b>
Kabiny	Lůžka	Maximální počet osob
<b>4 + 2</b>	<b>8 + 2 + 2</b>	<b>12</b>
WC	Motor	Palivová nádrž
<b>4</b>	<b>2 x 40 HP</b>	<b>400 l</b>



**WEBSITE**  
[www.plujeme.cz](http://www.plujeme.cz)



**TELEFON**  
+420 720 755 085



**MOBILE**  
+420 777 170 276



**E-MAIL**  
[info@plujeme.cz](mailto:info@plujeme.cz)



**PLUJEME RÁDI S.R.O.**  
Dlouhá 730/35, 11000 Praha 1 – Staré Město, Česká republika

## STANDARDNÍ VYBAVENÍ JACHTY

Bezpečnost	<b>VHF rádio</b>
Elektronika	<b>Invertor, Konvertor 220V/12V, Solární panely, Watermaker – Odsolovač vody, WC pumpa, Zásuvky 12V</b>
Interiér	<b>Convertible table in salon, Ventilátory v kajutách</b>
Kuchyňka	<b>Lednička, Mrazák, Trouba, Trouba</b>
Navigace	<b>Autopilot, GPS mapový plotter, Hloubkoměr, Rychloměr (Speed log), Wind instrument/Anemometer</b>
Paluba	<b>Bimini, Davit, Elektrický kotevní vrátek, Koupací žebřík, Nafukovací člun, Stoleček v kokpité, Venkovní sprcha na zádi</b>
Plachty	<b>Elektrické navijáky/vinšny, Lazy bag, Lazy jacks</b>
Pohodlí	<b>Polštáře do kokpitu</b>
Zábava	<b>Fusion radio, Venkovní reproduktory</b>

**WEBSITE**[www.plujeme.cz](http://www.plujeme.cz)**E-MAIL**[info@plujeme.cz](mailto:info@plujeme.cz)**TELEFON**

+420 720 755 085

**MOBILE**

+420 777 170 276

**PLUJEME RÁDI S.R.O.**

Dlouhá 730/35, 11000 Praha 1 – Staré Město, Česká republika

## SLUŽBY

VYBRANÉ SLUŽBY	POVINNÉ	TYP PLATBY	CENA
<b>Essentials pack</b> (Platba předem) <b>Sezóna: 2026 Exotic.</b> INCLUDED: Damage waiver (covering damages) with reduced security deposit addressed specifically to blocked toilets, unpaid fuel, lost equipment, unpaid fees & fines, and returning the boat in an extremely dirty state. // starter pack – (1 gallon water or 4 bottles of 1.5L, 1 bottle of disinfectant, 1 small bottle of washing up liquid, 1 dish cloth, 1 sponge, garbage bags, 1 roll of paper towels, 1 box of matches, 1 roll of toilet paper in each head)// final cleaning // 1 set of bed sheets & towels, dinghy, outboard engine & initial supply of fuel, gas and water tanks // DYC assistance guarantee // 1st & last night in the marina /// NOT INCLUDED: refuelling, gas & water consumption at end of charter, taxes if any, handling fees & additional equipment deposit.	Ano	za rezervaci	<b>915,00 €</b>
<b>Manipulační poplatky</b> (Platba předem) <b>Sezóna: 2026 Exotic.</b>	Ano	za rezervaci	<b>35,00 €</b>
<b>Poplatek za hygienu životního prostředí</b> (Platba na základně) <b>Sezóna: 2026 Exotic.</b> Municipal fee since January 1, 2026, created to finance environmental protection actions, waste managements & conservation of the municipality's natural environment. It applies to recreational or sports boat rental services operating within the municipality of La Paz	Ano	za den	<b>3,04 €</b>
<b>Poplatek za přípravu jachty</b> (Platba předem) <b>Sezóna: 2026 Exotic.</b> INCLUDED: starter pack – (1 gallon water or 4 bottles of 1.5L, 1 bottle of disinfectant, 1 small bottle of washing up liquid, 1 dish cloth, 1 sponge, garbage bags, 1 roll of paper towels, 1 box of matches, 1 roll of toilet paper in each head)// final cleaning // 1 set of bed sheets / cabin & 1 set of towels / pax, dinghy, outboard engine & initial supply of fuel, gas and water tanks // DYC assistance guarantee // 1st & last night in the marina // NOT INCLUDED: refuelling, gas & water consumption at end of charter, taxes if any, handling fees & additional equipment deposit.	Ano	za rezervaci	<b>415,00 €</b>
<b>Vstup do národních parků</b> (Platba na základně) <b>Sezóna: 2026 Exotic.</b> Required for access to Balandra Bay and Espiritu Santo Island, as mandated by CONANP. Each guest must wear a wristband daily to comply with regulations.	Ano	per guest/night	<b>8,00 €</b>
<b>Dřívější nalodění</b> (Platba předem) <b>Sezóna: 2026 Exotic.</b> EB (boat only) -14:00 h / 2 PM starting time of boat's delivery // limited number of early boardings on same departure day	Ne	za rezervaci	<b>450,00 €</b>

<b>Dřívější nalodění</b> (Platba předem)	Ne	za rezervaci	<b>620,00 €</b>
<b>Sezóna: 2026 Exotic.</b> EB boat + extra fee skipper -14:00 h / 2 PM starting time of boat's delivery // limited number of early boardings on same departure day			
<b>Dřívější nalodění</b> (Platba předem)	Ne	za rezervaci	<b>755,00 €</b>
<b>Sezóna: 2026 Exotic.</b> EB + extra fee Skipper & Hostes - 14:00 h / 2 PM starting time of boat's delivery // limited number of early boardings on same departure day			
<b>Extra sada prádla (vyberte si kolik)</b> (Platba předem)	Ne	za rezervaci	<b>15,00 €</b>
<b>Sezóna: 2026 Exotic.</b> Extra set of linen : 15 € 1 set of linen (2 sheets & 2 pillow case) - to be updated manually			
<b>Extra set of towels (choose how many)</b> (Platba předem)	Ne	za rezervaci	<b>10,00 €</b>
<b>Sezóna: 2026 Exotic.</b> Extra set of towels: 10 € 1 set of towels (1 face & 1 bath towel) - to be updated manually			
<b>Hosteska/kuchař</b> (Platba předem)	Ne	za noc	<b>135,00 €</b>
<b>Sezóna: 2026 Exotic.</b> + provisioning, Crew on board must have their own toilets/showers. If either a skipper or a hostess/cook is on board, 1 double cabin will be required for him/her. If both a skipper and a hostess/cook are on board, 1 double cabin and 1 forepeak cabin will be required for them. Exceptions exists for specific layouts, Sales Agents will provide more details about the different boat models			
<b>Hosteska/kuchař</b> (Platba předem)	Ne	za noc	<b>135,00 €</b>
<b>Sezóna: 2026 Exotic.</b> + provisioning, Crew on board must have their own toilets/showers. If either a skipper or a hostess/cook is on board, 1 double cabin will be required for him/her. If both a skipper and a hostess/cook are on board, 1 double cabin and 1 forepeak cabin will be required for them. Exceptions exists for specific layouts, Sales Agents will provide more details about the different boat models			
<b>Hosteska/kuchař</b> (Platba předem)	Ne	za noc	<b>150,00 €</b>
<b>Sezóna: 2026 Exotic.</b> + provisioning, Crew on board must have their own toilets/showers. If either a skipper or a hostess/cook is on board, 1 double cabin will be required for him/her. If both a skipper and a hostess/cook are on board, 1 double cabin and 1 forepeak cabin will be required for them. Exceptions exists for specific layouts, Sales Agents will provide more details about the different boat models			
<b>Kapitán</b> (Platba předem)	Ne	za noc	<b>170,00 €</b>
<b>Sezóna: 2026 Exotic.</b> + provisioning, Crew on board must have their own toilets/showers. If either a skipper or a hostess/cook is on board, 1 double cabin will be required for him/her. If both a skipper and a hostess/cook are on board, 1 double cabin and 1 forepeak cabin will be required for them. Exceptions exists for specific layouts, Sales Agents will provide more details about the different boat models			

<b>Kapitán (Platba předem)</b>	Ne	za noc	<b>170,00 €</b>
<b>Sezóna: 2026 Exotic.</b> + provisioning, Crew on board must have their own toilets/showers. If either a skipper or a hostess/cook is on board, 1 double cabin will be required for him/her. If both a skipper and a hostess/cook are on board, 1 double cabin and 1 forepeak cabin will be required for them. Exceptions exists for specific layouts, Sales Agents will provide more details about the different boat models			
<b>Kapitán (Platba předem)</b>	Ne	za noc	<b>185,00 €</b>
<b>Sezóna: 2026 Exotic.</b> + provisioning, Crew on board must have their own toilets/showers. If either a skipper or a hostess/cook is on board, 1 double cabin will be required for him/her. If both a skipper and a hostess/cook are on board, 1 double cabin and 1 forepeak cabin will be required for them. Exceptions exists for specific layouts, Sales Agents will provide more details about the different boat models			
<b>Plná penze 1-3 osoby (počet hostů aktualizujte ručně) (Platba předem)</b>	Ne	per guest/day	<b>75,00 €</b>
<b>Sezóna: 2026 Exotic.</b> only available if cook is booked on board as the cook will do the provisioning based on client's preference. Includes breakfast, lunch & dinner + the crew's food. Does not included alcoholic drinks			
<b>Plná penze 4-6 osob (počet hostů aktualizujte ručně) (Platba předem)</b>	Ne	per guest/day	<b>60,00 €</b>
<b>Sezóna: 2026 Exotic.</b> only available if cook is booked on board as the cook will do the provisioning based on client's preference. Includes breakfast, lunch & dinner + the crew's food. Does not included alcoholic drinks			
<b>Plná penze 7-12 osob (počet hostů bude aktualizován ručně) (Platba předem)</b>	Ne	per guest/day	<b>55,00 €</b>
<b>Sezóna: 2026 Exotic.</b> only available if cook is booked on board as the cook will do the provisioning based on client's preference. Includes breakfast, lunch & dinner + the crew's food. Does not included alcoholic drinks			
<b>Pojištění kauce (Platba předem)</b>	Ne	za noc	<b>70,00 €</b>
<b>Sezóna: 2026 Exotic.</b> Damage waiver limits your liability to the reduced Security Deposit . Mandatory when skipper is added. Price is per night of the charter ( minimum value of 7 nights & a maximum value of 21 nights) Not applicable for 4+ weeks charters , nor Regattas/Races.			
<b>Příplatek za regatu (Platba předem)</b>	Ne	za rezervaci	<b>0,00 €</b>
<b>Sezóna: 2026 Exotic.</b> all the regattas apart of ASW (different regatta surcharge for ASW)// A special race deposit need to be doubled manually once the regatta surcharge is added.			
<b>Same day briefing (Platba předem)</b>	Ne	za rezervaci	<b>150,00 €</b>
<b>Sezóna: 2026 Exotic.</b> Same day briefing starting between 5 & 5.30pm (departure following morning)			

<b>Spotřeba elektřiny a vody v přístavech</b> (Platba na základně)	Ne	za rezervaci	<b>28,00 €</b>
<b>Sezóna: 2026 Exotic.</b> Electric & Water consumption based on 2 nights on our dock (base will confirm the amount to pay locally depending on nights spent on dock)			
<b>Starter pack</b> (Platba předem)	Ne	za rezervaci	<b>50,00 €</b>
<b>Sezóna: 2026 Exotic.</b> included in Essentials pack (The pack includes: 1 gallon water (or 4 bottles of 1.5L), 1 bottle of disinfectant, 1 small bottle of washing up liquid, 1 dish cloth, 1 sponge, garbage bags, 1 roll of paper towels, 1 box of matches, 1 roll of toilet paper in each head)			
<b>Transfer</b> (Platba předem)	Ne	one-way	<b>40,00 €</b>
<b>Sezóna: 2026 Exotic.</b> OW La Paz airport /base TAXI 1-4 pax			
<b>Transfer</b> (Platba předem)	Ne	okružní plavba	<b>80,00 €</b>
<b>Sezóna: 2026 Exotic.</b> RT- La Paz airport /base TAXI 1-4 pax			
<b>Transfer</b> (Platba předem)	Ne	one-way	<b>118,00 €</b>
<b>Sezóna: 2026 Exotic.</b> OW La Paz airport /base VAN 1-10 pax			
<b>Transfer</b> (Platba předem)	Ne	okružní plavba	<b>236,00 €</b>
<b>Sezóna: 2026 Exotic.</b> RT - La Paz airport /base VAN 1-10 pax			
<b>Transfer</b> (Platba předem)	Ne	okružní plavba	<b>796,00 €</b>
<b>Sezóna: 2026 Exotic.</b> RT Los cabos airport / base VAN 1-10 pax			
<b>Závěrečný úklid</b> (Platba předem)	Ne	za rezervaci	<b>310,00 €</b>
<b>Sezóna: 2026 Exotic.</b> included in Essentials pack			
<b>Závěrečný úklid</b> (Platba předem)	Ne	za rezervaci	<b>310,00 €</b>
<b>Sezóna: 2026 Exotic.</b> included in Essentials pack			
<b>Změna posádky</b> (Platba předem)	Ne	za rezervaci	<b>250,00 €</b>
<b>Sezóna: 2026 Exotic.</b> Any crew change during the charter is subject to € 250.- additional cost. The charge includes administration cost, change of bed linen and towels and one night at DYC ponton (marina fee included only if the same base than start base). It doesn't include cleaning, nor new transit log where applicable.			



**WEBSITE**  
www.plujeme.cz



**TELEFON**  
+420 720 755 085



**MOBILE**  
+420 777 170 276



**E-MAIL**  
info@plujeme.cz



**PLUJEME RÁDI S.R.O.**  
Dlouhá 730/35, 11000 Praha 1 – Staré Město, Česká republika

## DODATEČNÉ DOPLŇKY

DOPLŇKY	POVINNÉ	TYP PLATBY	CENA
<b>Bezpečnostní síť</b> (Platba předem) <b>Sezóna: 2026 Exotic.</b> net is supplied but not installed - Platba předem	Ne	za rezervaci	<b>250,00 €</b>
<b>Kayak single</b> (Platba předem) <b>Sezóna: 2026 Exotic.</b> price per day - Platba předem	Ne	za noc	<b>15,00 €</b>
<b>Kayak tandem</b> (Platba předem) <b>Sezóna: 2026 Exotic.</b> price per day - Platba předem	Ne	za noc	<b>15,00 €</b>
<b>Outboard engine 8 &amp; 9,8 HP</b> (Platba předem) <b>Sezóna: 2026 Exotic.</b> Dinghy not suitable in any case for waterski or wakeboard. Additional security deposit of 500 € on outboard engines. - Platba předem	Ne	za den	<b>35,00 €</b>
<b>Stand up paddle (SUP)</b> (Platba předem) <b>Sezóna: 2026 Exotic.</b> price per day - Platba předem	Ne	za noc	<b>15,00 €</b>



**WEBSITE**

[www.plujeme.cz](http://www.plujeme.cz)



**TELEFON**

+420 720 755 085



**MOBILE**

+420 777 170 276



**E-MAIL**

[info@plujeme.cz](mailto:info@plujeme.cz)



**PLUJEME RÁDI S.R.O.**

Dlouhá 730/35, 11000 Praha 1 – Staré Město, Česká republika

## CENA A DOSTUPNOST

13.06. - 20.06.2026 <b>3.736 €</b> 4.395 €	20.06. - 30.06.2026 NEDOSTUPNÉ	30.06. - 07.07.2026 NEDOSTUPNÉ	11.07. - 18.07.2026 <b>3.324 €</b> 3.910 €
18.07. - 25.07.2026 <b>3.324 €</b> 3.910 €	25.07. - 01.08.2026 <b>3.324 €</b> 3.910 €	01.08. - 08.08.2026 <b>3.324 €</b> 3.910 €	08.08. - 15.08.2026 <b>3.324 €</b> 3.910 €
15.08. - 22.08.2026 <b>3.324 €</b> 3.910 €	22.08. - 29.08.2026 <b>3.324 €</b> 3.910 €	29.08. - 05.09.2026 <b>3.910 €</b>	05.09. - 12.09.2026 <b>3.910 €</b>
12.09. - 19.09.2026 <b>3.910 €</b>	19.09. - 26.09.2026 <b>3.910 €</b>	26.09. - 03.10.2026 <b>3.974 €</b>	03.10. - 10.10.2026 <b>4.239 €</b> 4.710 €
10.10. - 17.10.2026 <b>4.757 €</b> 5.285 €	17.10. - 24.10.2026 <b>5.409 €</b> 6.010 €	24.10. - 31.10.2026 <b>6.062 €</b> 6.735 €	31.10. - 07.11.2026 <b>6.386 €</b> 7.095 €
07.11. - 14.11.2026 <b>6.399 €</b> 7.110 €	14.11. - 21.11.2026 <b>7.088 €</b> 7.875 €	21.11. - 28.11.2026 <b>7.182 €</b> 7.980 €	28.11. - 05.12.2026 <b>6.777 €</b> 7.530 €
05.12. - 12.12.2026 <b>5.765 €</b> 6.405 €	12.12. - 19.12.2026 <b>5.765 €</b> 6.405 €	19.12. - 02.01.2027 NEDOSTUPNÉ	02.01. - 09.01.2027 <b>5.027 €</b> 5.585 €
09.01. - 16.01.2027 <b>5.027 €</b> 5.585 €	16.01. - 23.01.2027 <b>4.788 €</b> 5.320 €	23.01. - 30.01.2027 <b>5.027 €</b> 5.585 €	30.01. - 06.02.2027 <b>5.666 €</b> 6.295 €



WEBSITE  
[www.plujeme.cz](http://www.plujeme.cz)



E-MAIL  
[info@plujeme.cz](mailto:info@plujeme.cz)



TELEFON  
+420 720 755 085



PLUJEME RÁDI S.R.O.  
Dlouhá 730/35, 11000 Praha 1 – Staré Město, Česká republika



MOBILE  
+420 777 170 276

## CENA A DOSTUPNOST

06.02. - 13.02.2027 <b>6.300 €</b> 7.000 €	13.02. - 20.02.2027 <b>6.300 €</b> 7.000 €	20.02. - 27.02.2027 <b>6.615 €</b> 7.350 €	27.02. - 06.03.2027 <b>7.079 €</b> 7.865 €
06.03. - 13.03.2027 <b>7.677 €</b> 8.530 €	13.03. - 20.03.2027 <b>8.096 €</b> 8.995 €	20.03. - 27.03.2027 <b>8.096 €</b> 8.995 €	27.03. - 03.04.2027 <b>8.096 €</b> 8.995 €
03.04. - 10.04.2027 <b>7.731 €</b> 8.590 €	10.04. - 17.04.2027 <b>7.533 €</b> 8.370 €	17.04. - 24.04.2027 <b>7.043 €</b> 7.825 €	24.04. - 01.05.2027 <b>6.597 €</b> 7.330 €
01.05. - 08.05.2027 <b>5.373 €</b> 5.970 €	08.05. - 15.05.2027 <b>5.180 €</b> 5.755 €	15.05. - 22.05.2027 <b>5.180 €</b> 5.755 €	22.05. - 29.05.2027 <b>4.838 €</b> 5.375 €
29.05. - 05.06.2027 <b>4.496 €</b> 4.995 €	05.06. - 12.06.2027 <b>4.271 €</b> 4.745 €	12.06. - 19.06.2027 <b>4.037 €</b> 4.485 €	19.06. - 26.06.2027 <b>3.875 €</b> 4.305 €
26.06. - 03.07.2027 <b>3.722 €</b> 4.135 €	03.07. - 10.07.2027 <b>3.722 €</b> 4.135 €	10.07. - 17.07.2027 <b>3.722 €</b> 4.135 €	17.07. - 24.07.2027 <b>3.722 €</b> 4.135 €
24.07. - 31.07.2027 <b>3.722 €</b> 4.135 €	31.07. - 07.08.2027 <b>3.722 €</b> 4.135 €	07.08. - 14.08.2027 <b>3.722 €</b> 4.135 €	14.08. - 21.08.2027 <b>3.722 €</b> 4.135 €
21.08. - 28.08.2027 <b>3.722 €</b> 4.135 €	28.08. - 04.09.2027 <b>3.722 €</b> 4.135 €	04.09. - 11.09.2027 <b>3.722 €</b> 4.135 €	11.09. - 18.09.2027 <b>3.722 €</b> 4.135 €
18.09. - 25.09.2027 <b>3.722 €</b> 4.135 €	25.09. - 02.10.2027 <b>3.732 €</b> 4.147 €		



WEBSITE  
[www.plujeme.cz](http://www.plujeme.cz)



E-MAIL  
[info@plujeme.cz](mailto:info@plujeme.cz)



TELEFON  
+420 720 755 085



PLUJEME RÁDI S.R.O.  
Dlouhá 730/35, 11000 Praha 1 – Staré Město, Česká republika



MOBILE  
+420 777 170 276

## CENA A DOSTUPNOST

02.10. - 09.10.2027 <b>4.325 €</b> 4.805 €	09.10. - 16.10.2027 <b>4.851 €</b> 5.390 €	16.10. - 23.10.2027 <b>5.517 €</b> 6.130 €	23.10. - 30.10.2027 <b>6.183 €</b> 6.870 €
30.10. - 06.11.2027 <b>6.512 €</b> 7.235 €	06.11. - 13.11.2027 <b>6.525 €</b> 7.250 €	13.11. - 20.11.2027 <b>7.232 €</b> 8.035 €	20.11. - 27.11.2027 <b>7.326 €</b> 8.140 €
27.11. - 04.12.2027 <b>6.912 €</b> 7.680 €	04.12. - 11.12.2027 <b>5.882 €</b> 6.535 €	11.12. - 18.12.2027 <b>5.882 €</b> 6.535 €	18.12. - 25.12.2027 <b>6.107 €</b> 6.785 €



### WEBSITE

[www.plujeme.cz](http://www.plujeme.cz)



### E-MAIL

[info@plujeme.cz](mailto:info@plujeme.cz)



### TELEFON

+420 720 755 085



### MOBILE

+420 777 170 276



### PLUJEME RÁDI S.R.O.

Dlouhá 730/35, 11000 Praha 1 – Staré Město, Česká republika